

# '66 Penske Racing Corvette®

What is now generally known as the first L88 Corvette to come off the production line was a red coupe built in late December, 1965. Through special arrangements, this car was to be funneled to Pennsylvania dealer Roger Penske, who had been active in Chevy racing activities for a number of years. At the recommendation of the patron saint of Corvette performance, the late Zora Arkus-Duntov, Penske hired race driver Dick Guldstrand who picked up the red L88 from the St. Louis assembly plant in January, 1966 and drove it straight to Penske's facilities using a blanket to stay warm in the heaterless car.

Preparations immediately began to get the car ready for the 24 hour Daytona endurance race the following month to be piloted by Guldstrand, Ben Moore and George Wintersteen. During the race, Wintersteen suffered a minor crash, damaging the front end and taking out the headlamps. Taping flashlights to the front of the car to get around the lighting requirements, the car not only finished, but took first place in the GT class.

Prior to the running of the car in the 12 Hours of Sebring in March, 1966, Penske's sponsor Sunoco Oil requested that the car be repainted in their trademark blue color and the freshly repainted Vette finished first in class once again. It is in the colors and markings for the Sebring race that Revell is proud to release our new kit replica of the 427 powered Roger Penske #9 Corvette race car.



\* REPEAT SEVERAL TIMES  
\* A REPETER PLUSIEURS FOIS



\* OPTIONAL PARTS  
\* PIECES EN OPTION



\* DECAL  
\* DECAL COMANIE



\* ALTERNATIVE ASSEMBLY  
\* ENSEMBLAGE ALTERNATIVE



\* CEMENT TOGETHER  
\* A COLLER



\* REMOVE AND THROW AWAY  
\* A RETIRER ET JETER



\* DO NOT CEMENT  
\* NE PAS COLLER

### READ THIS BEFORE YOU BEGIN

- \* Study the assembly drawings.
- \* Each plastic part is identified by a number.
- \* In the assembly drawings, some parts will be marked by a star (★) to indicate chrome plated plastic.
- \* For better paint and decal adhesion, wash the plastic parts in a mild detergent solution. Rinse and let air dry.
- \* Check the fit of each piece before cementing in place.
- \* Use only cement for polystyrene plastic.
- \* Scrape plating and paint from areas to be cemented.
- \* Allow paint to dry thoroughly before handling parts.
- \* Any unused parts may be discarded.

### DECAL APPLICATION INSTRUCTIONS

1. Cut desired decal from sheet.
2. Dip decal in water for a few seconds.
3. Place wet decal on paper towel.
4. Wait until decal is movable on paper backing.
5. Place decal in position on model, face up and slide backing away.
6. Press out air bubbles with a soft damp cloth.
7. Milkiness that may appear is for better decal adhesion and will dry clear. Wipe away any excess adhesive.
8. Do not touch decal until fully dry.
9. Allow the decals 48 hours to dry before applying clear coat.

**NOTE:** Decals are compatible with setting solutions or solvents.

### LIRE CE QUI SUIV AVANT DE COMMENCER

- \* Etudier les schémas de montage.
- \* Chaque pièce en plastique est identifiée par un numéro.
- \* Sur les schémas de montage, certaines pièces sont marquées d'une étoile (★) pour indiquer qu'elles sont en plastique chromé.
- \* Pour une meilleure prise de la peinture et des autocollants, laver les pièces en plastique avec une solution détergente peu concentrée. Les rincer et les laisser sécher à l'air.
- \* Vérifier que chaque pièce s'ajuste bien avant de la coller en place.
- \* N'utiliser que de la colle pour polystyrène.
- \* Gratter les parties à coller pour enlever le chrome et la peinture.
- \* Laisser la peinture bien sécher avant de manipuler les pièces.
- \* Toute pièce inutilisée peut être jetée.

### DIRECTIVES D'APPLICATION DES AUTOCOLLANTS

1. Découper l'autocollant désiré de la feuille.
2. Tremper l'autocollant dans de l'eau pendant quelques secondes.
3. Placer l'autocollant mouillé sur une serviette en papier.
4. Attendez que l'autocollant puisse être déplacé sur son support en papier.
5. Mettre l'autocollant en position sur le modèle face sur le dessus et faire glisser le support pour l'enlever.
6. Appuyer avec un chiffon doux humide pour éliminer les bulles d'air.
7. La substance laiteuse qui peut apparaître est destinée à améliorer l'adhésion de l'autocollant et devient incolore au séchage. Essuyer pour enlever tout excédent d'adhésif.
8. Ne pas toucher l'autocollant tant qu'il n'est pas bien sec.
9. Laisser l'autocollant sécher pendant 48 heures avant d'appliquer une couche transparente.

**REMARQUE:** Les autocollants sont compatibles avec les solutions de fixation ou les solvants.

This paint guide is provided to complete this kit as shown on the box.

Ce guide de peinture est fourni pour reproduire le modèle réduit qui apparaît sur la boîte.

FLAT BLACK	NOIR TERNE
AMBER	AMBRE
SEMI GLOSS BLACK	NOIR MAT
GLOSS LIGHT GRAY	GRIS CLAIR LUSTRE
GLOSS BLUE	BLEU LUSTRE
SILVER	ARGENT
ALUMINUM	ALUMINIUM
WOOD GRAIN	KONSSITTRA
GLOSS YELLOW	JAUNE LUSTRE

If you have any questions or comments, call our hotline at: **(800) 833-3570**  
or, please write to:

Revell-Monogram Consumer Service Department, 725 Landwehr Road, Northbrook, Illinois 60062

Be sure to include the plan number (85286300200), part number, description, your return address and phone number.

Visit our website: [www.revellmonogram.com](http://www.revellmonogram.com)

# 1

# SUSPENSION ASSEMBLY

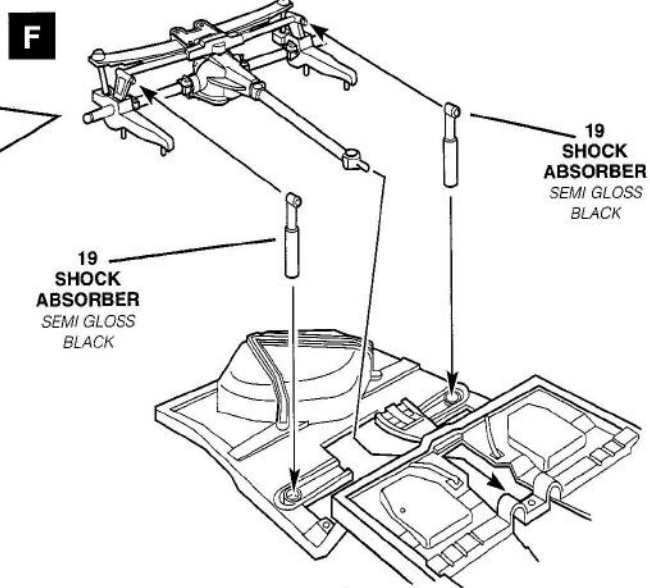
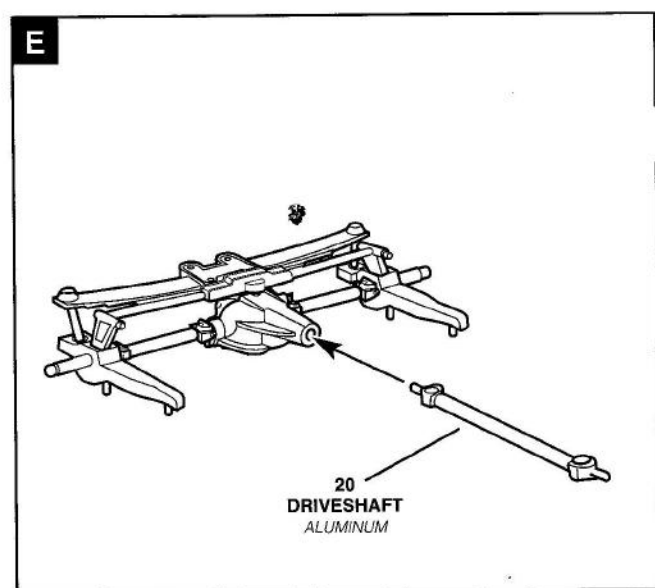
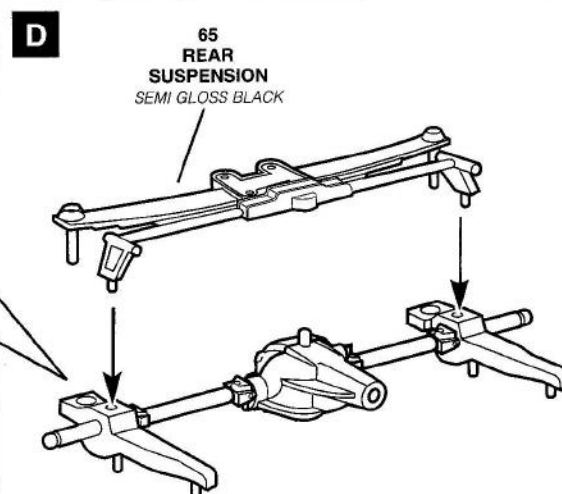
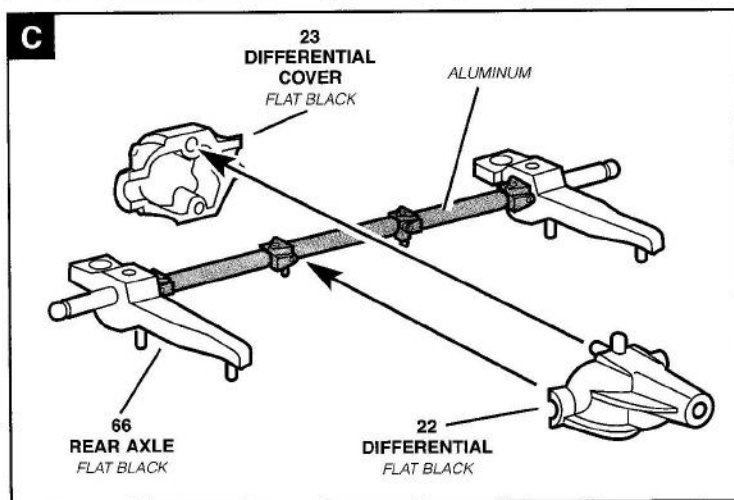
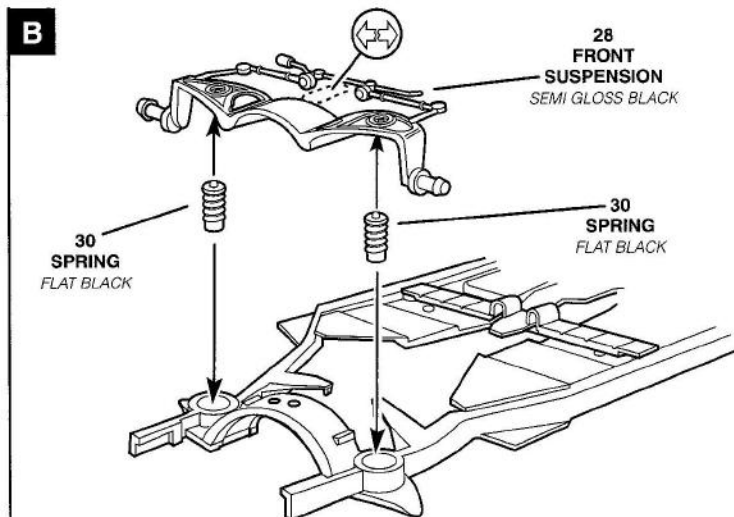
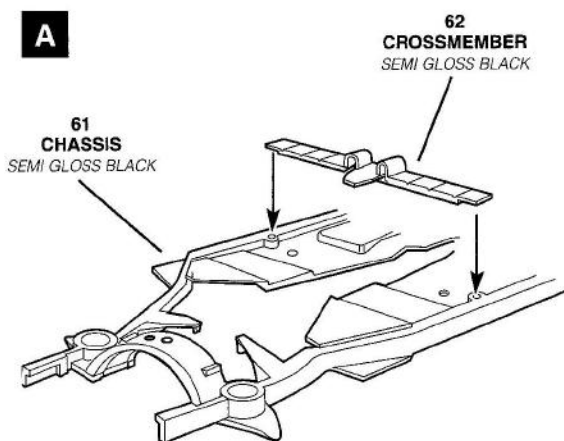

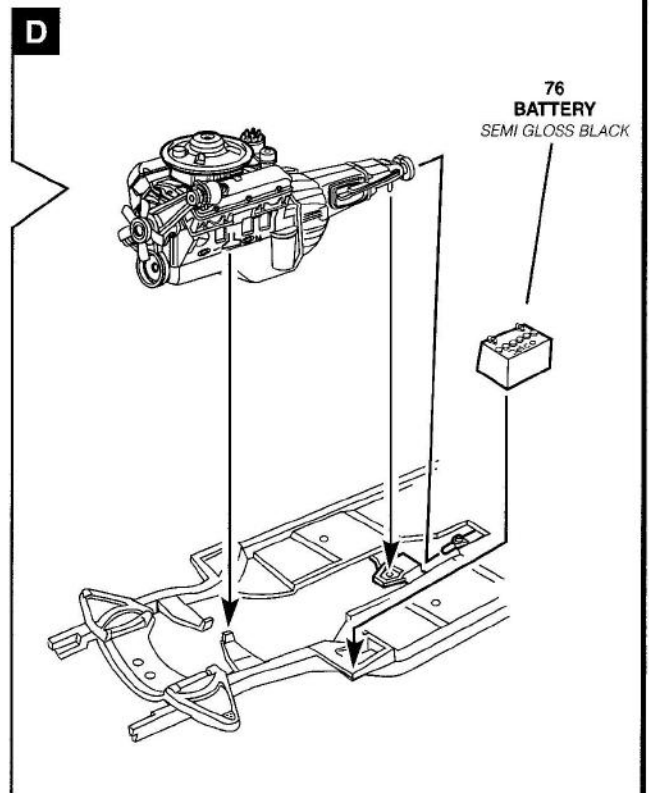
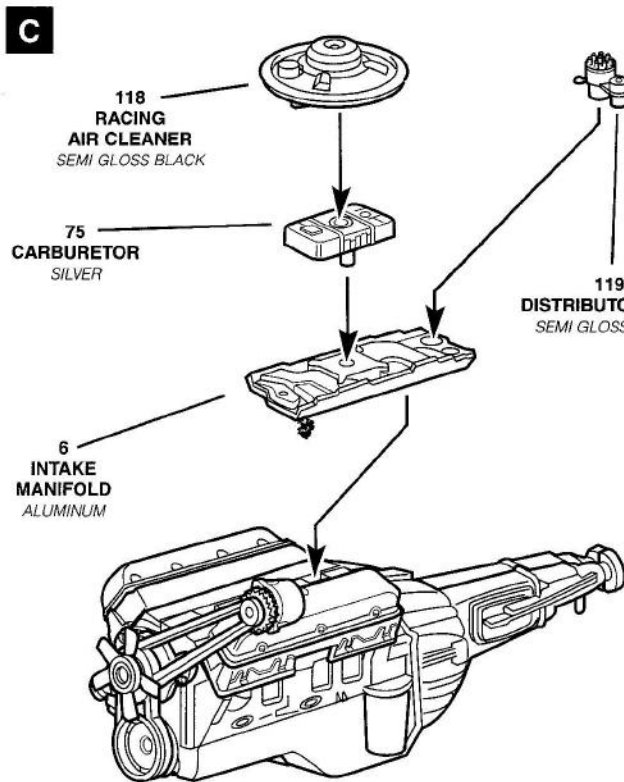
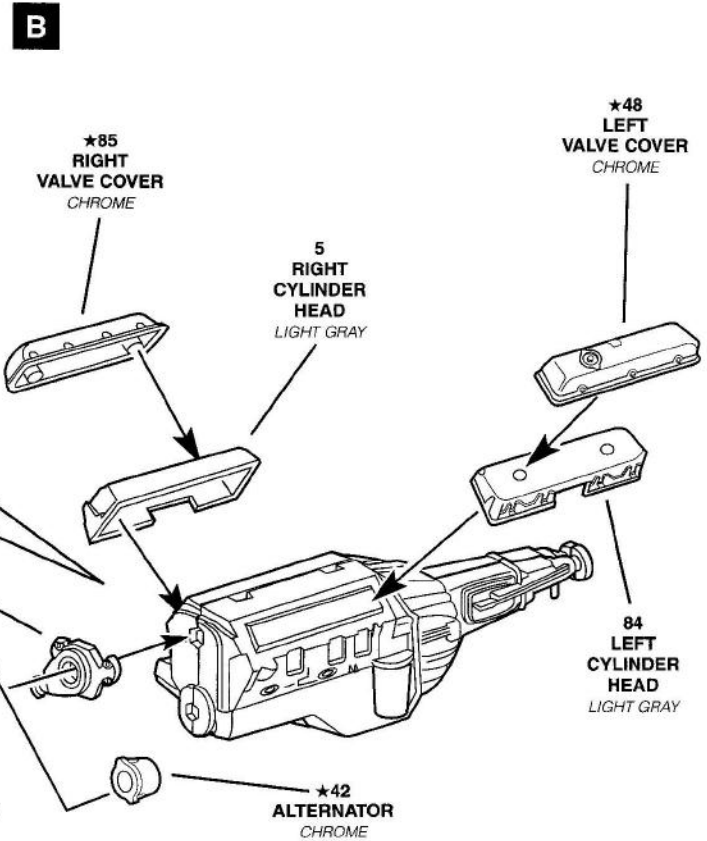
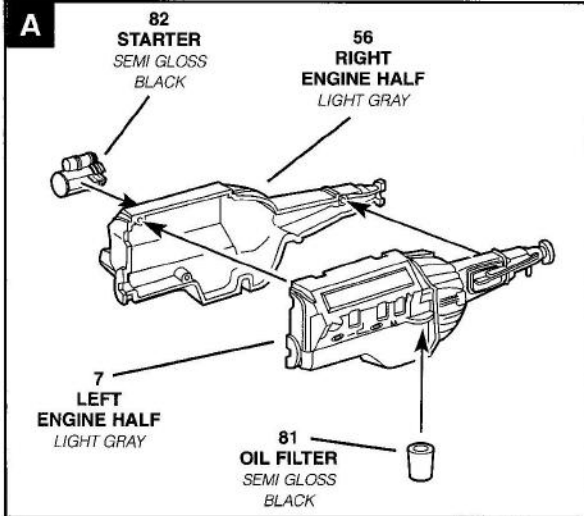

# 3

# EXHAUST ASSEMBLY

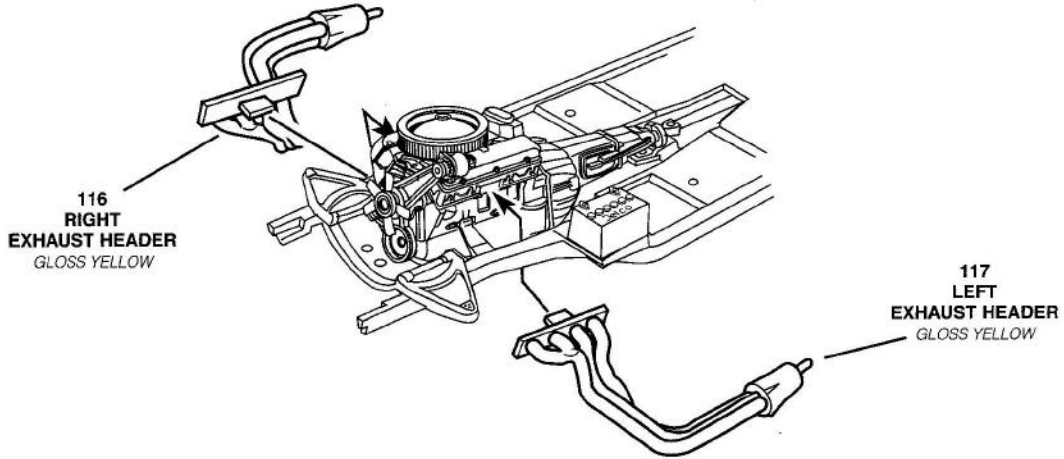

# 4

# INTERIOR ASSEMBLY

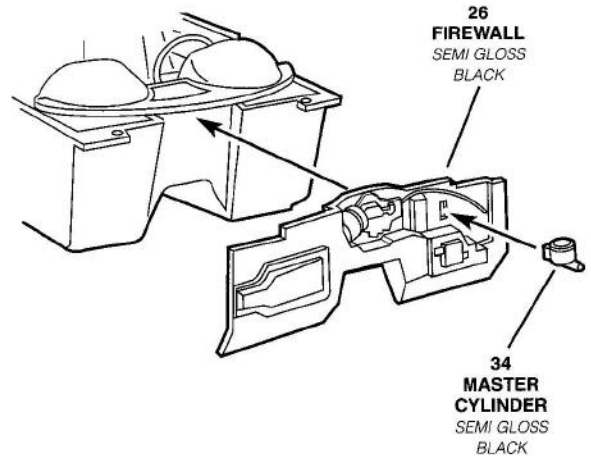
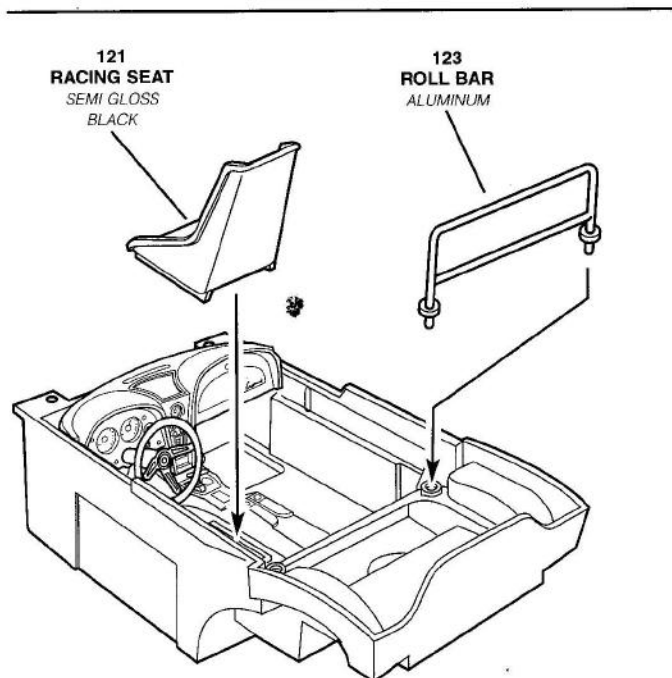
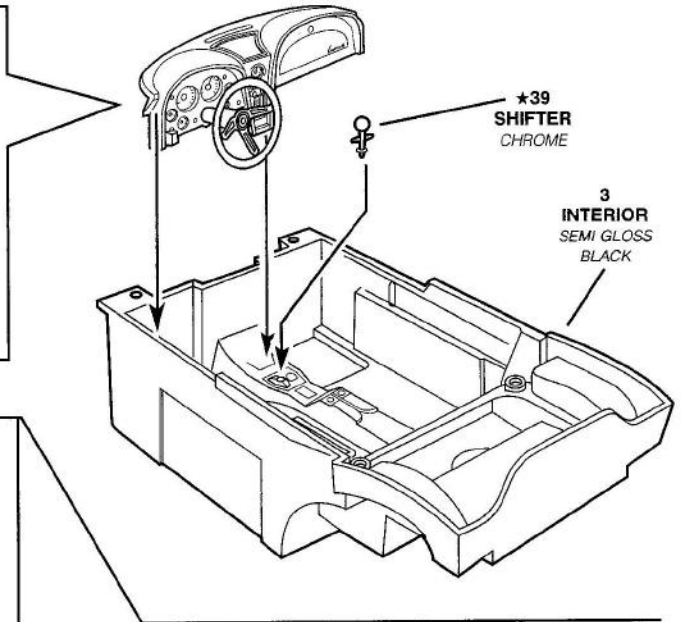
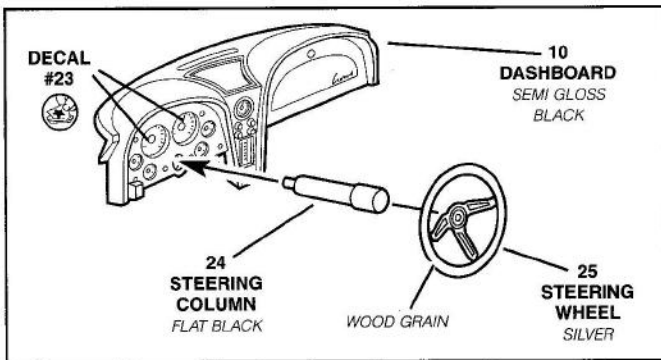

# 5

## HOOD ASSEMBLY

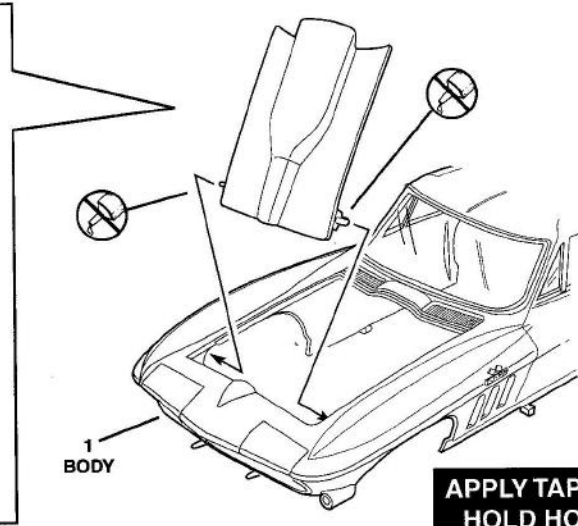
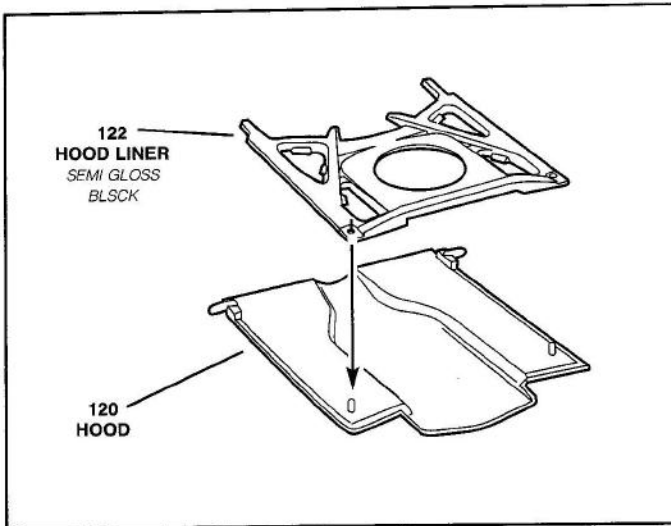

# 6

## WHEEL WELL ASSEMBLY

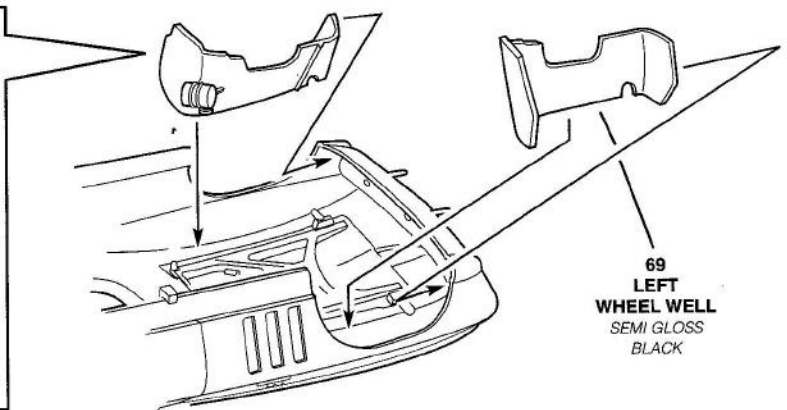
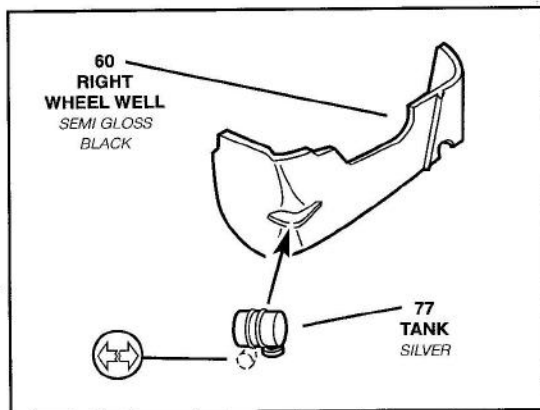

# 7

## FRONT ASSEMBLY

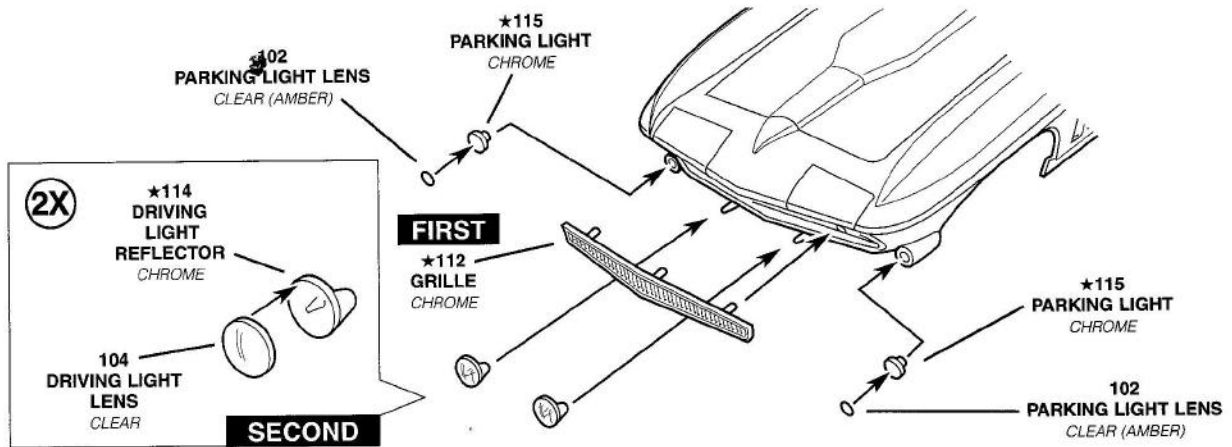

# 8

## REAR ASSEMBLY

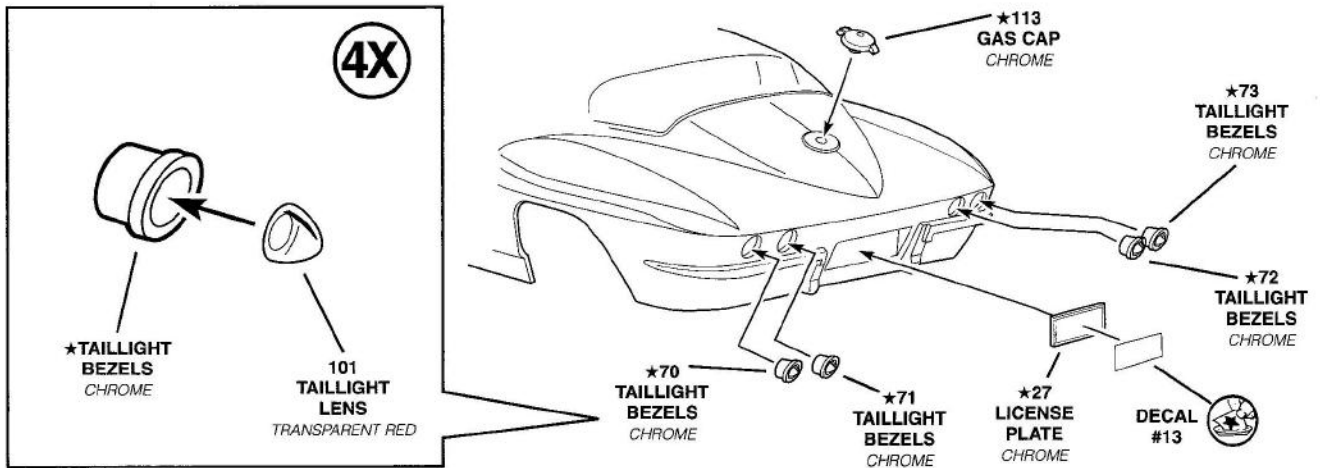

# 9

## WINDOW / INTERIOR ASSEMBLY

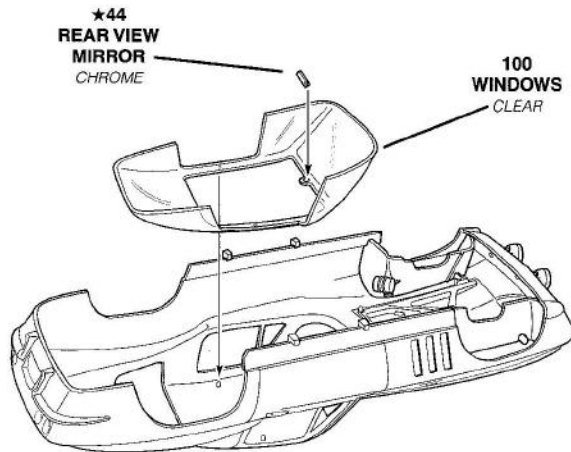

INTERIOR TO BODY

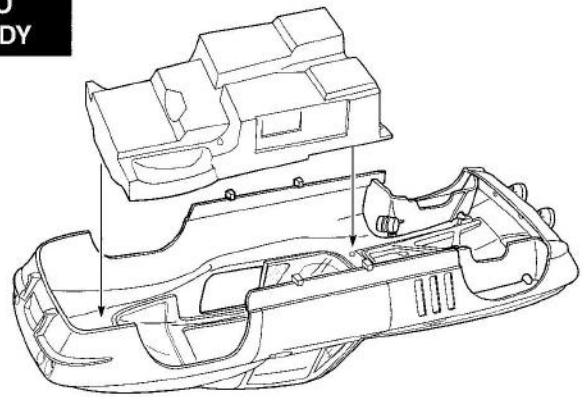

# 10

## RADIATOR ASSEMBLY

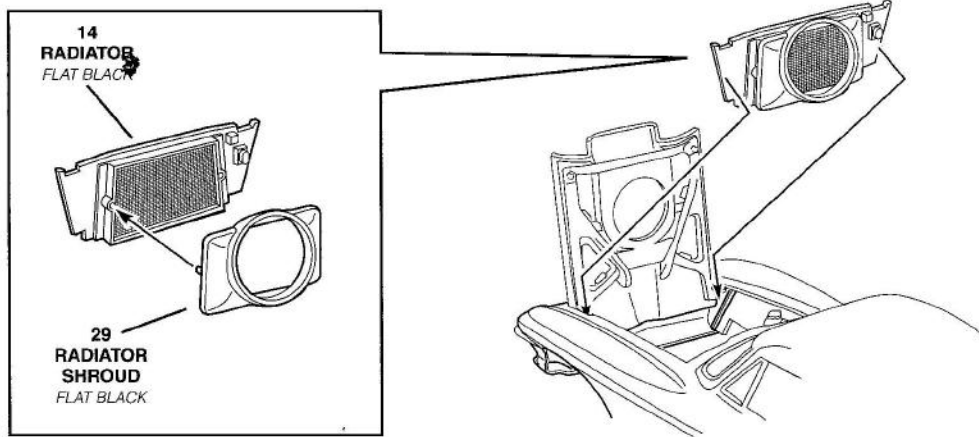

# 11

# WHEEL ASSEMBLY

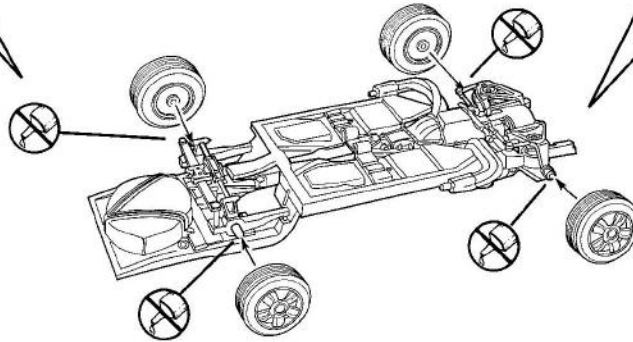
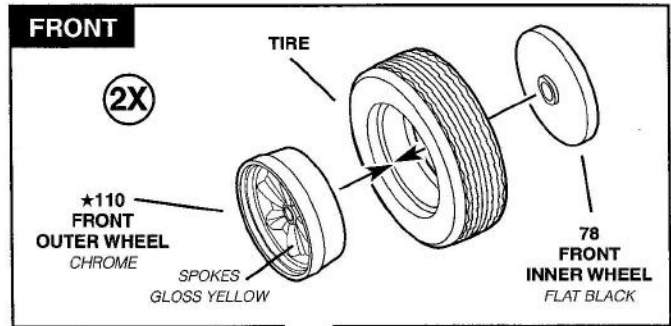
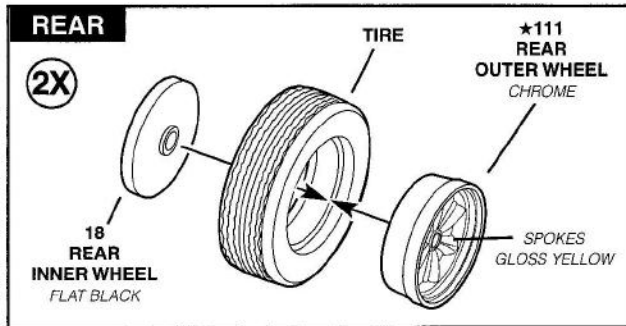

# 12

# CHASSIS / SIDE PIPES ASSEMBLY

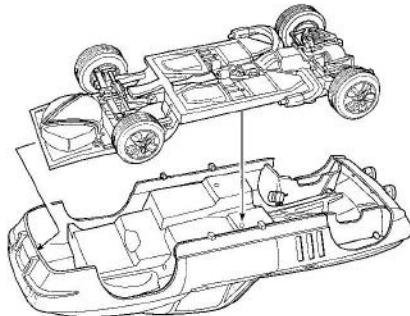

125 RIGHT EXHAUST PIPE GLOSS YELLOW

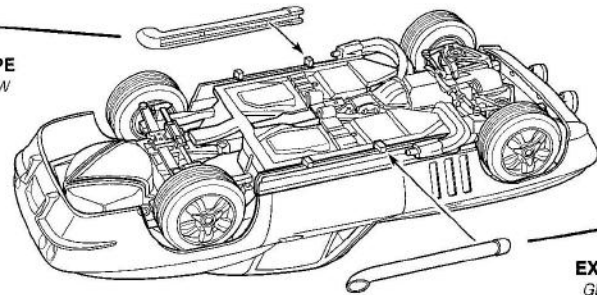

124 LEFT EXHAUST PIPE GLOSS YELLOW

# 13

# FINAL ASSEMBLY

