

eduard

LIBRARY EDITION 2018

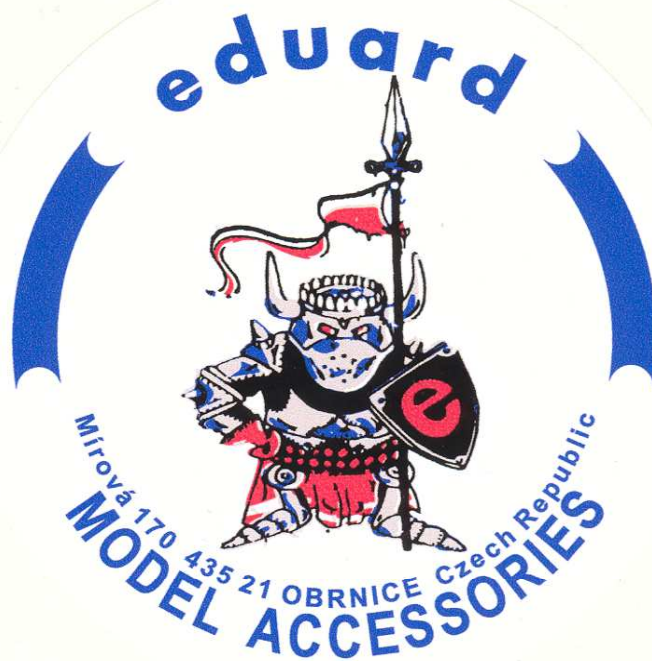

1/72 MiG-21MF



SOVIET SUPERSONIC FIGHTER

1/72 SCALE PLASTIC KIT

#2124

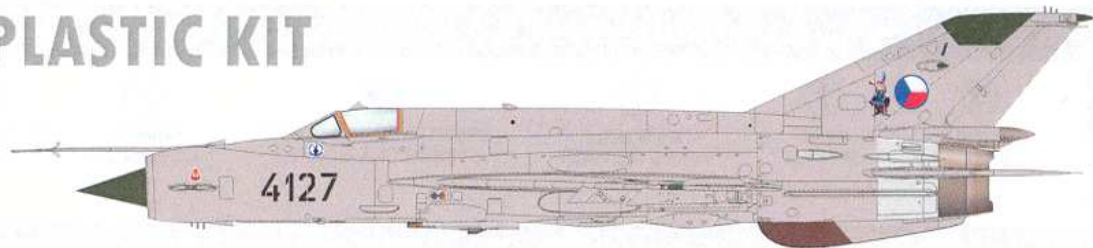

INTRO

The MiG-21 was one of a long list of Mikoyan-Gurevich products to be integrated into the armed forces of the Soviet Union, the Warsaw Pact, and allied client states. Its predecessors included such notable types as the MiG-15, MiG-17 and the supersonic MiG-19. The roots of this project reach back to the first half of the fifties. In 1954, the Ye-1 project came to an end, and was quickly picked up by the Ye-2. Both had a swept wing. The first machine to feature the delta wing was the Ye-4, which first took to the air on June 16th, 1955. It was also demonstrated a year later at the Moscow airfield Tushino. The first of the new line to enter production was the MiG-21F, which together with the MiG-21P and F-13 represented the first generation of the MiG-21, and was in production through the end of the fifties and the beginning of the sixties. Subsequent versions included the PF, FL, PFM, R the production of which peaked at the end of the sixties. The third generation started production in 1968, which included such versions as M, SM, MF, SMT, bis among others. Simultaneously, two-seat training versions were also produced designated MiG-21U, UM and US. Production of the MiG-21 ended in 1985, and was put into service with some fifty nations. Over the course of the cold war, the opponents of the MiG-21 included the likes of the Northrop F-5 Freedom Fighter and the Dassault Mirage III. NATO assigned it the reporting name 'Fishbed'. It became the most produced supersonic fighter in terms of quantity. The new machines came off Soviet production lines in Moscow, Gorky and Tbilisi. The MiG-21F-13 was also built under license in Czechoslovakia and the MiG-21FL, M and bis in India by Hindustan Aeronautics Ltd. The Soviet Union produced 10,645 examples of all versions, 194 were built in Czechoslovakia and 657 in India. Outside of the Soviet Union, the type flew with a long list of nations on all continents with the exception of Australia. The MiG-21 participated in combat in Vietnam, the Indo-Pakistan wars, the Cuban participation in Angola and in the Arab world's attempt to eliminate Israel. Thanks to the high volume of use, the highest number of aces produced on the type was in Vietnam. The top of the ladder is occupied by Nguyen Van Coc with nine kills. The type serving as an interceptor served with the Soviet Union and other nations of the Warsaw Pact into the eighties, when it began to be displaced by the MiG-29 Fulcrum.

This kit presents an opportunity for you to build a model of a MiG-21MF supersonic jet fighter in a way it was produced in Gorky factory, where the production of the MF variant was moved from Moscow factory after their start with MiG-23s. The design of the fighter planes made in Gorky differed in several details from the Moscow design. The first reason for that was the unification of some features with the previously made aircraft in Gorky, the MiG-21bis, and the second reason was the use of former technological procedures followed by Gorky factory. These fighter jets were exported to German Democratic Republic, Poland, Czechoslovakia, Romania and Bulgaria. Production of this version finished after two years.

MiG-21MFs were powered by Tumanskij R-13-300 turbojet engine with additional combustion chamber and carried an RP-21 radar. The armament constituted of a twin-barreled GSch-23-2L 23mm autocannon with 200 rounds of ammunition. The racks carried a combination of FAB bombs with 500kg warhead, UB-16-57U launchers and R-3S rockets, Ch-66, S-24, including R-60 air-to-air missile and its infrared homing variant R-60M. The NATO code for MiG-21MFs was "Fishbed-J".



Carefully read instruction sheet before assembling. When you use glue or paint, do not use near open flame and use in well ventilated room. Keep out of reach of small children. Children must not be allowed to suck any part, or pull vinyl bag over the head.



Před započatím stavby si pečlivě prostudujte stavební návod. Při používání barev a lepidel pracujte v době větrané místnosti. Lepidla ani barvy nepoužívejte v blízkosti otevřeného ohně. Model není určen malým dětem, mohlo by dojít k požití drobných dílů.

INSTRUCTION SIGNS * INSTR. SYMBOLS * INSTRUKTION SINNBILDEN * SYMBOLES * 記号の説明

- 
 OPTIONAL
VOLBA
- 
 BEND
OHNOU
- 
 OPEN HOLE
VYVRTAT OTVOR
- 
 SYMETRICAL ASSEMBLY
SYMETRICKÁ MONTÁŽ
- 
 REMOVE
ODŘÍZNOUT
- 
 REVERSE SIDE
OTOČIT
- 
 APPLY EDUARD MASK
AND PAINT
POUŽIT EDUARD MASK
NABARVIT

PARTS * DÍLY * TEILE * PIÈCES * 部品

PLASTIC PARTS

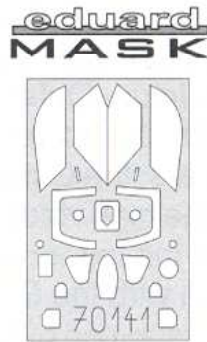
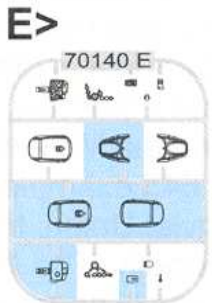
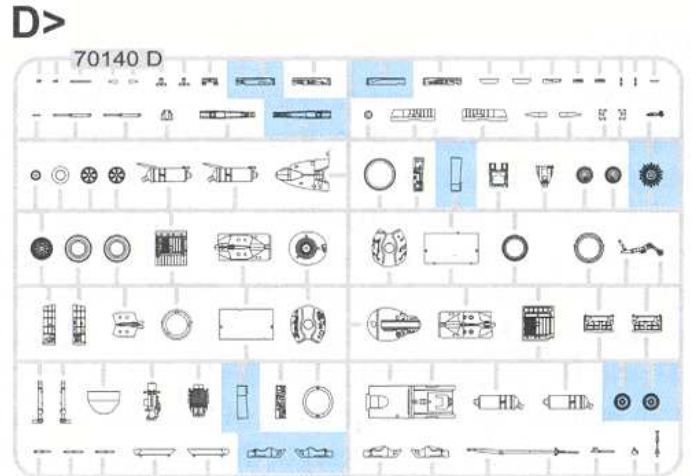
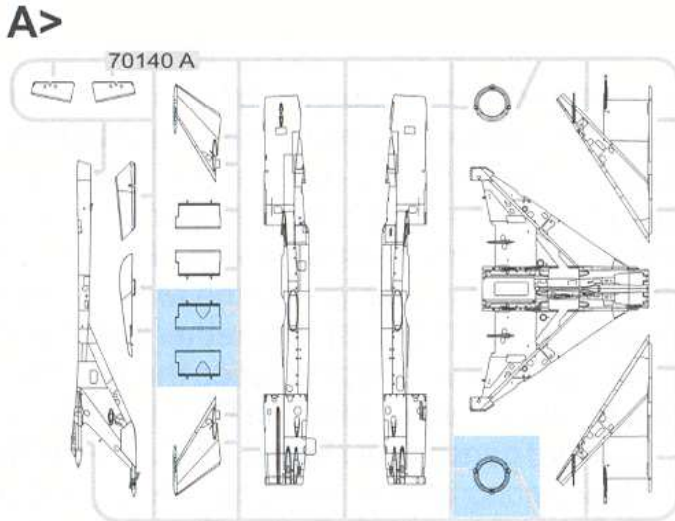

PE - PHOTO ETCHED
DETAIL PARTS

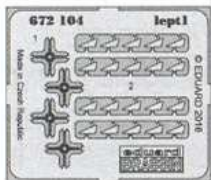

eduard BRASSIN RP- RESIN PARTS

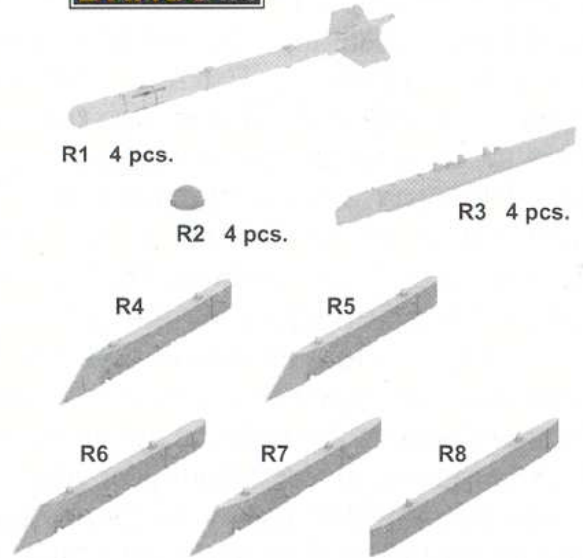

 -Parts not for use. -Teile werden nicht verwendet. -Pièces à ne pas utiliser. -Tyto díly nepoužívejte při stavbě. - 使用しない部品

COLOURS * BARVY * FARBEN * PEINTURE * 色

GSI Creos (GUNZE)		
AQUEOUS	Mr.COLOR	
H1	C1	WHITE
H2	C2	BLACK
H3	C3	RED
H4	C4	YELLOW
H5	C5	BLUE
H11	C62	FLAT WHITE
H12	C33	BLACK
H15	C65	BRIGHT BLUE
H25	C34	SKY BLUE

AQUEOUS	Mr.COLOR	
H26	C66	BRIGHT GREEN
H35	C80	COBALT BLUE
H47	C41	RED BROWN
H51	C11	LIGHT GULL GRAY
H53	C13	NEUTRAL GRAY
H70	C60	GRAY
H77	C137	TIRE BLACK
H84	C42	MAHOGANY
H90	C47	CLEAR RED

AQUEOUS	Mr.COLOR	
H94	C138	CLEAR GREEN
H332	C332	LIGHT GRAY
	C35	L/N GRAY
Mr.METAL COLOR		
	MC213	STAINLESS
	MC214	DARK IRON
Mr.COLOR SUPER METALLIC		
	SM01	SUPER FINE SILVER

INTERIOR COLOUR BARVA INTERIÉRU

INTERIOR

60% C34 SKY BLUE + 20% C66 BRIGHT GREEN + 20% C80 COBALT BLUE

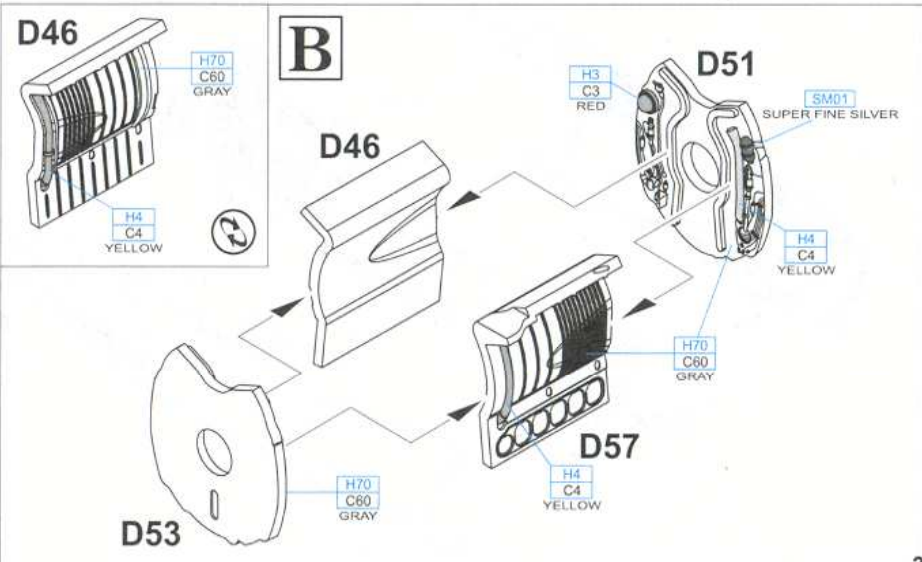
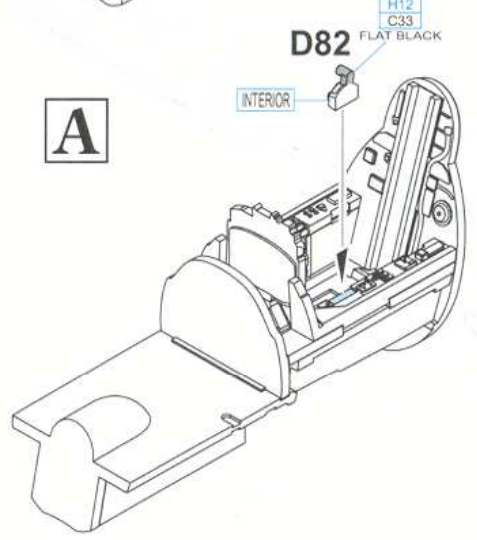
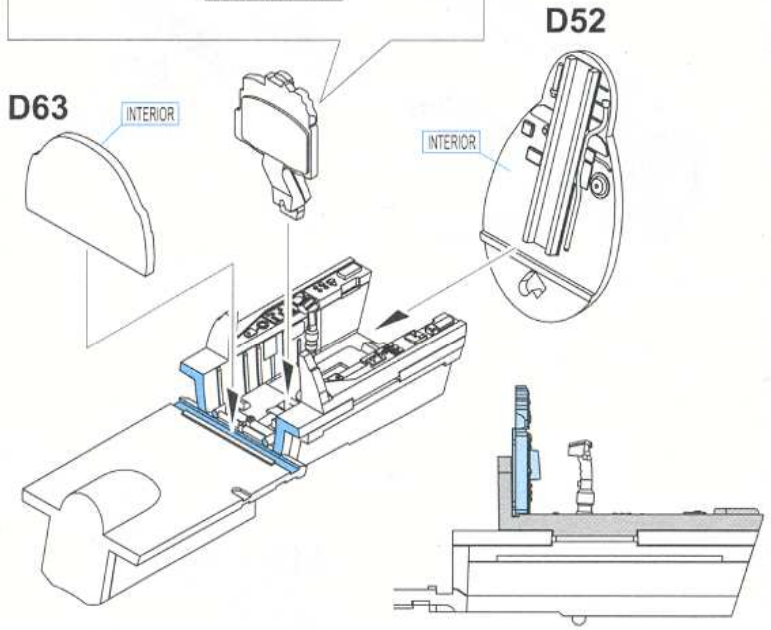
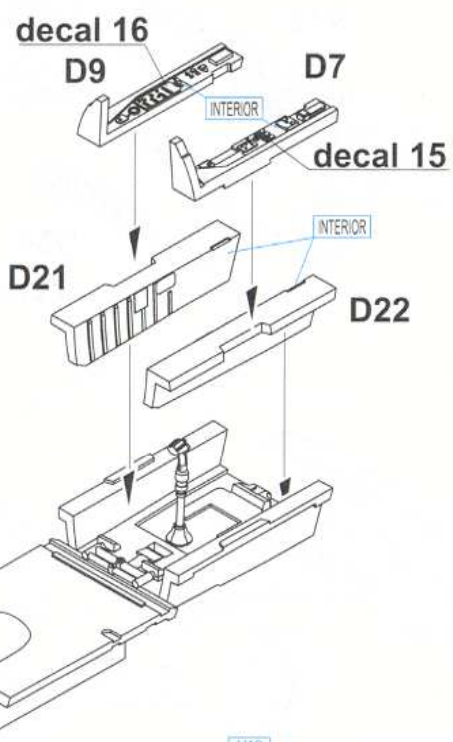
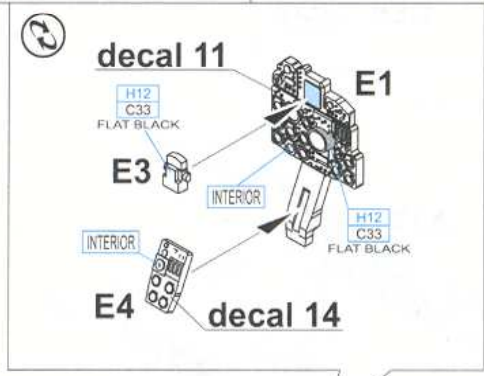
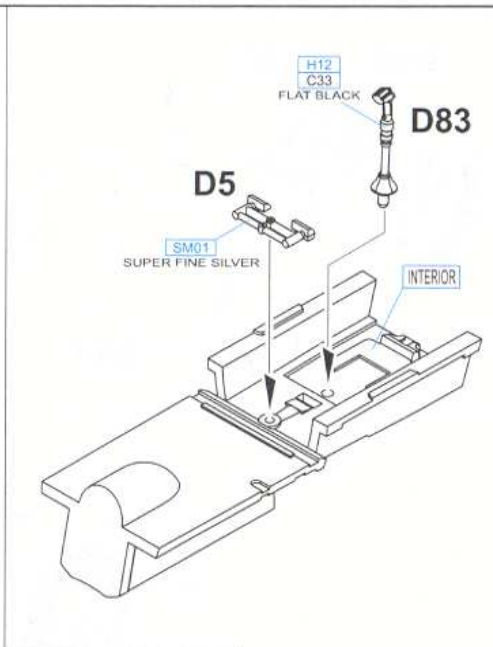
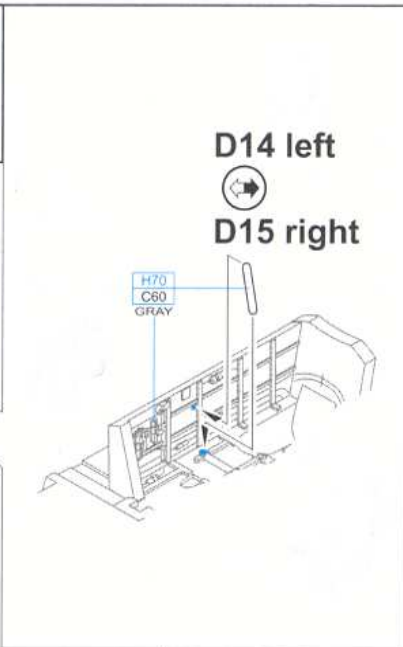
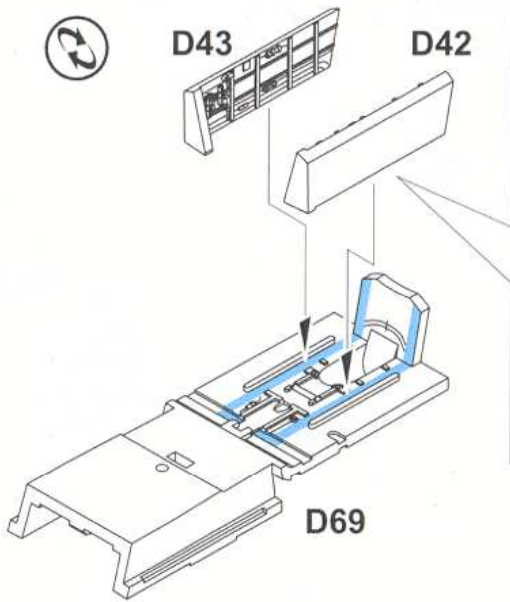

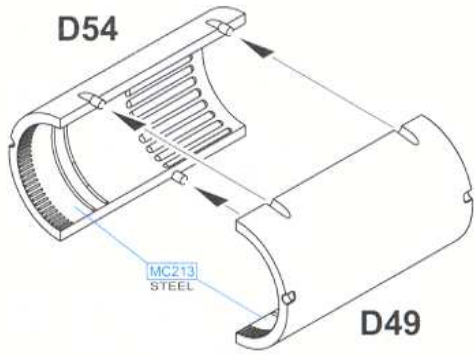

C

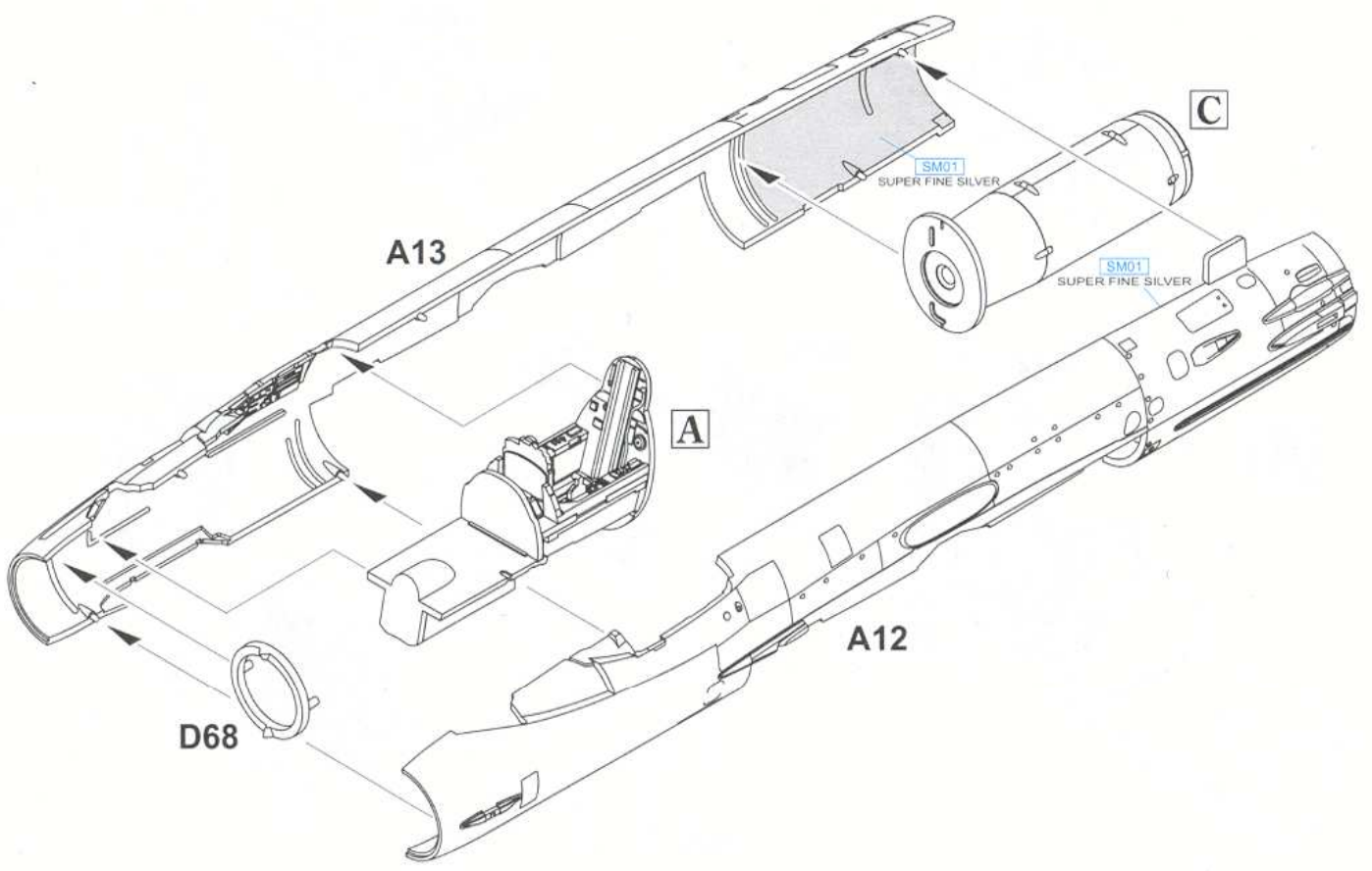
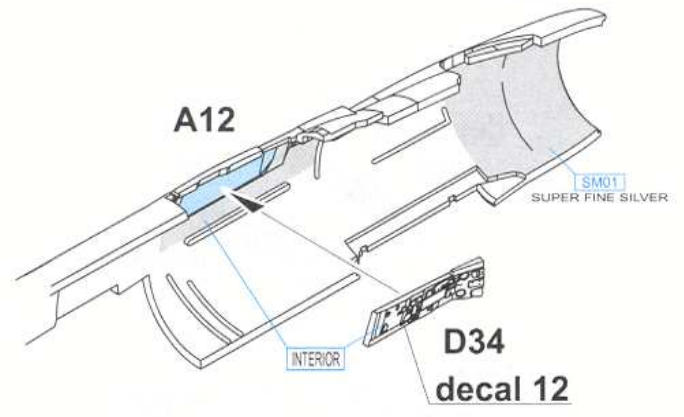
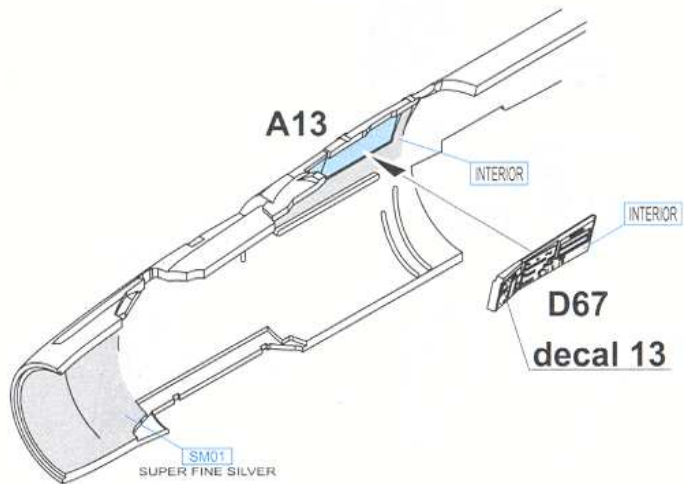
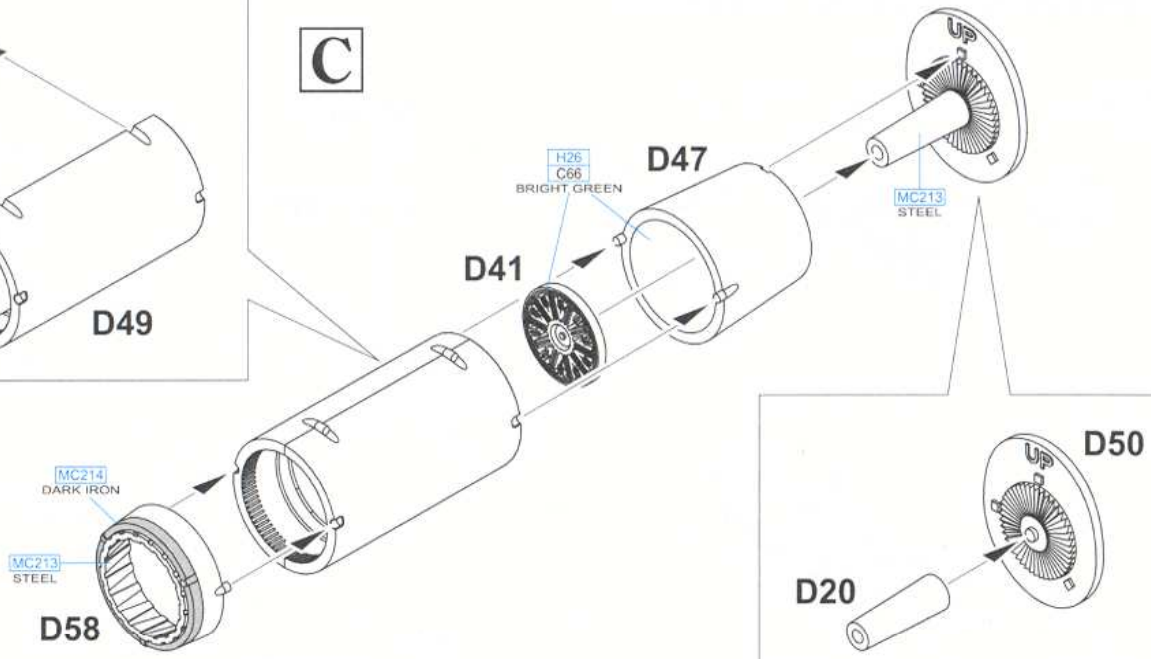

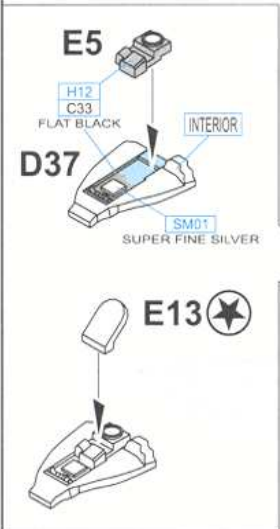
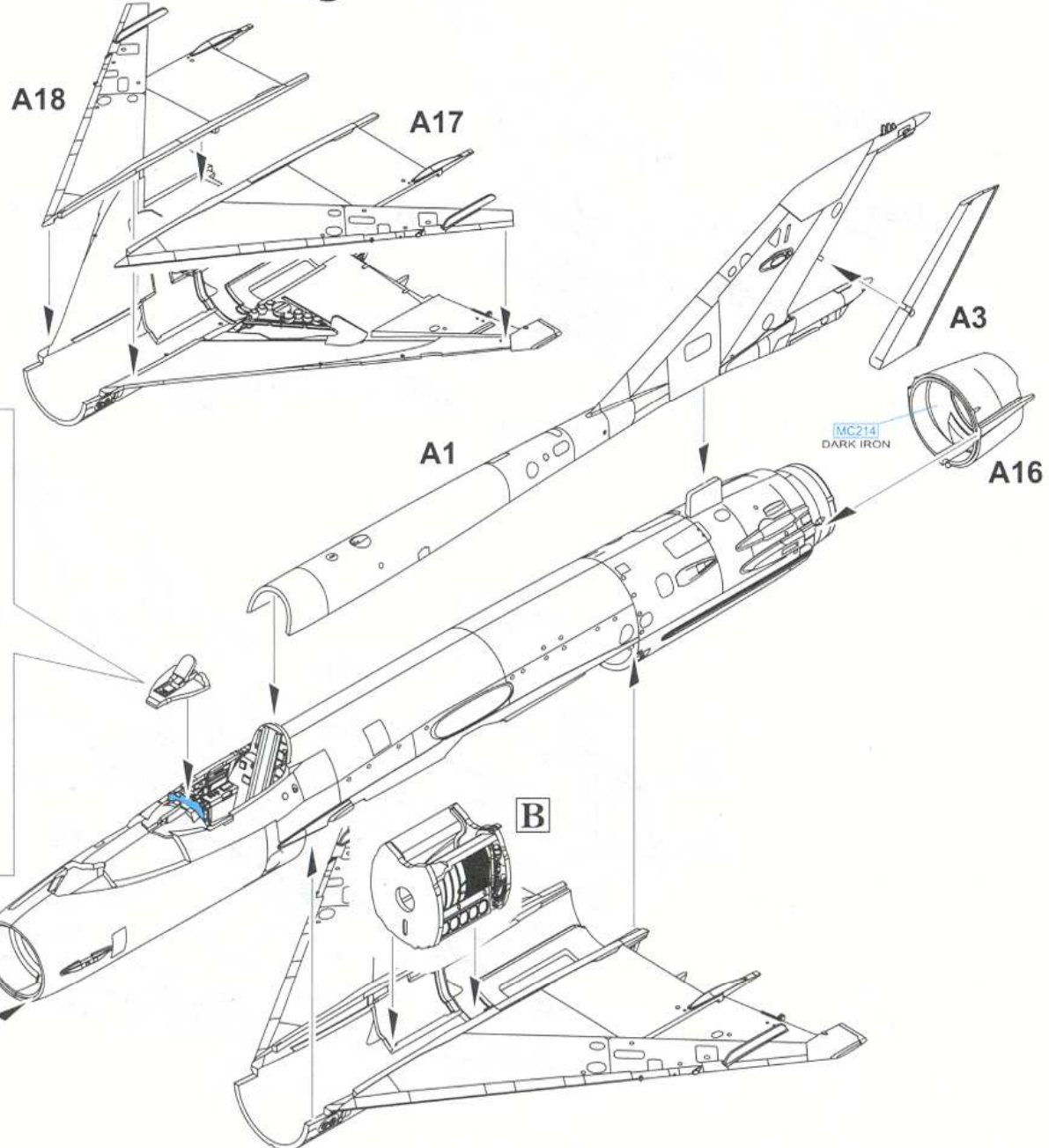
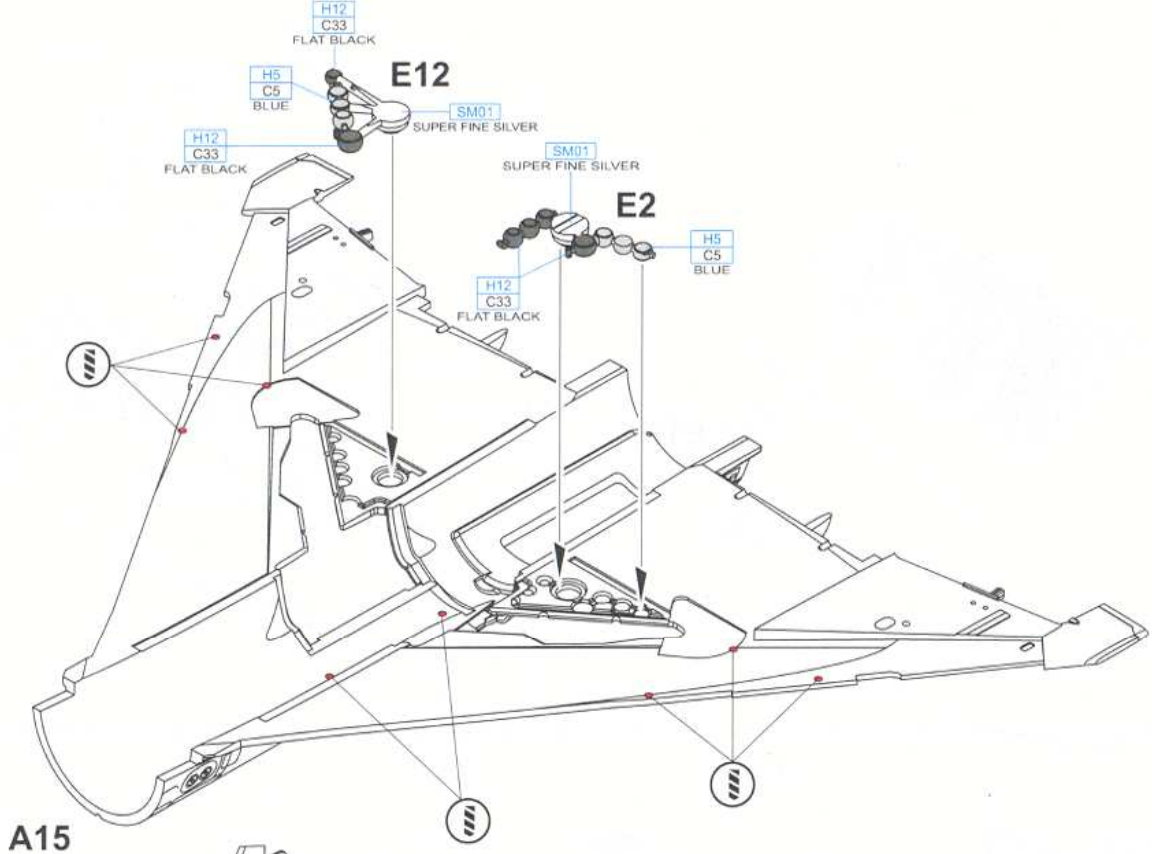

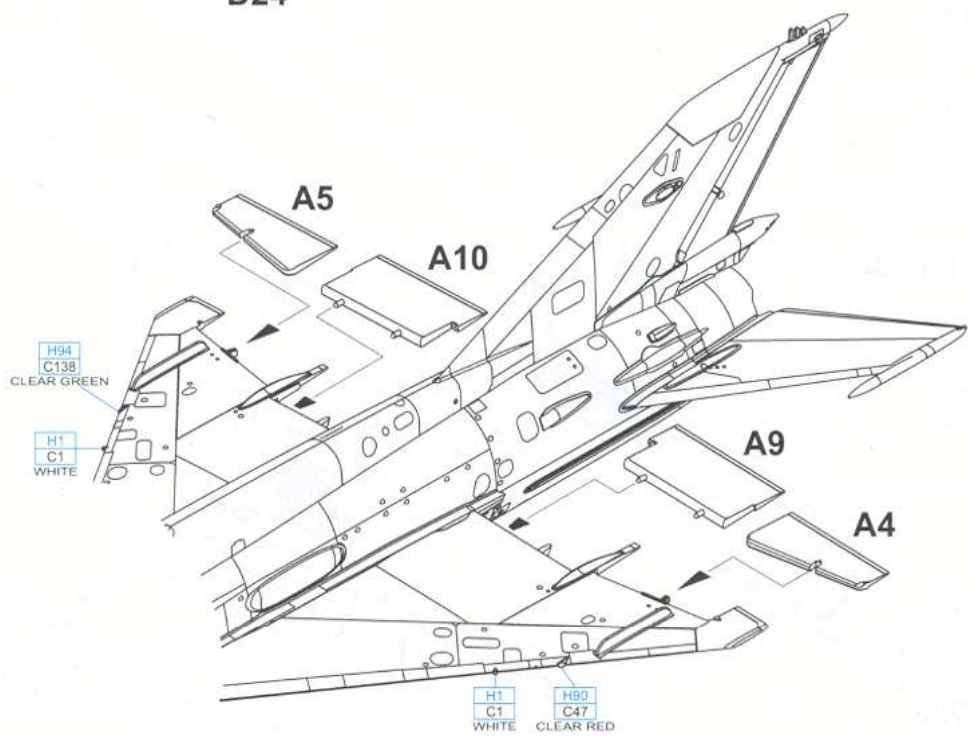
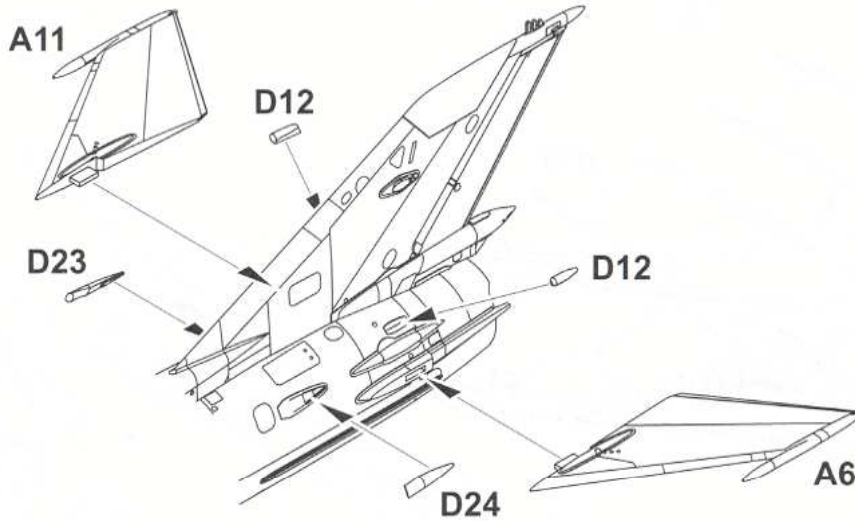
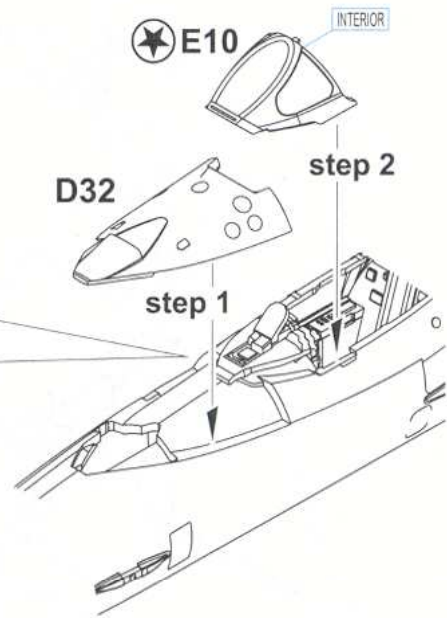
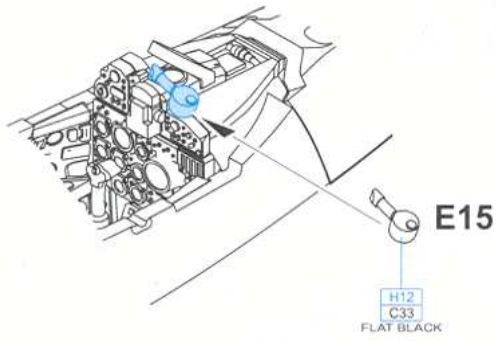

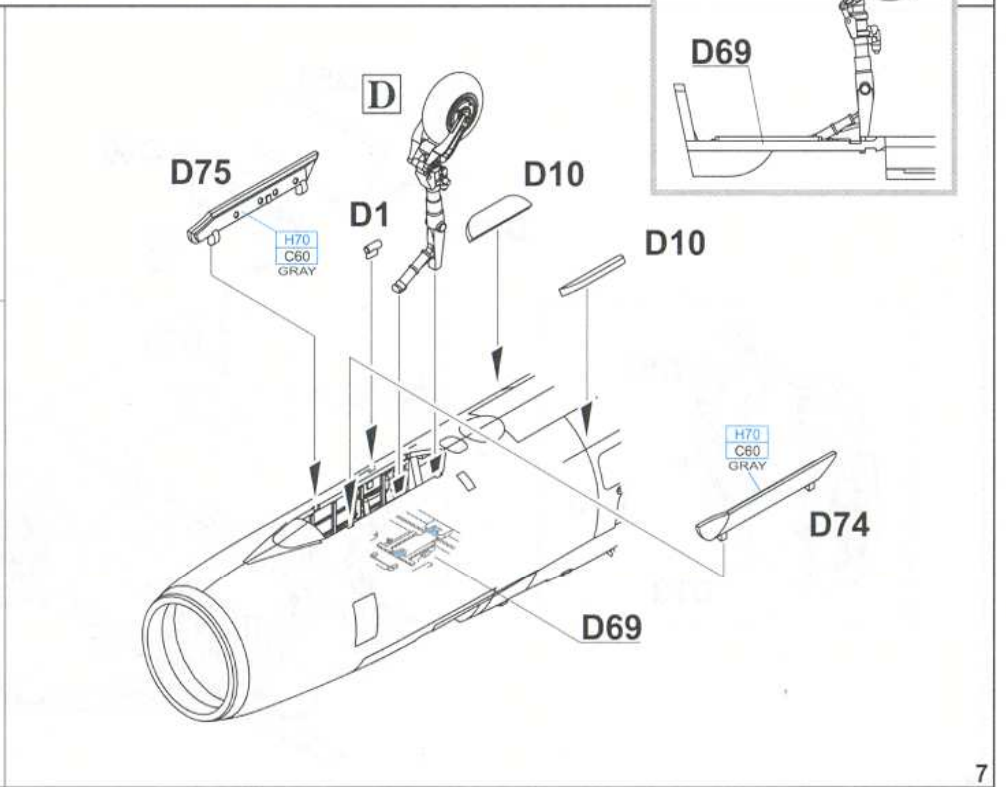
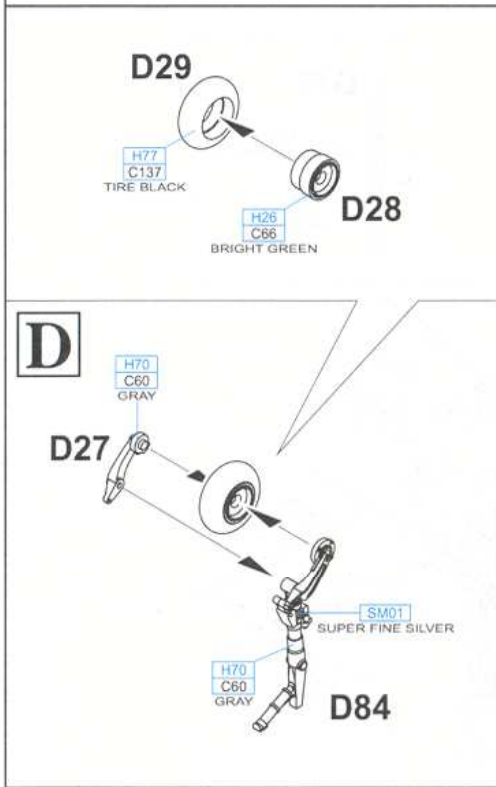
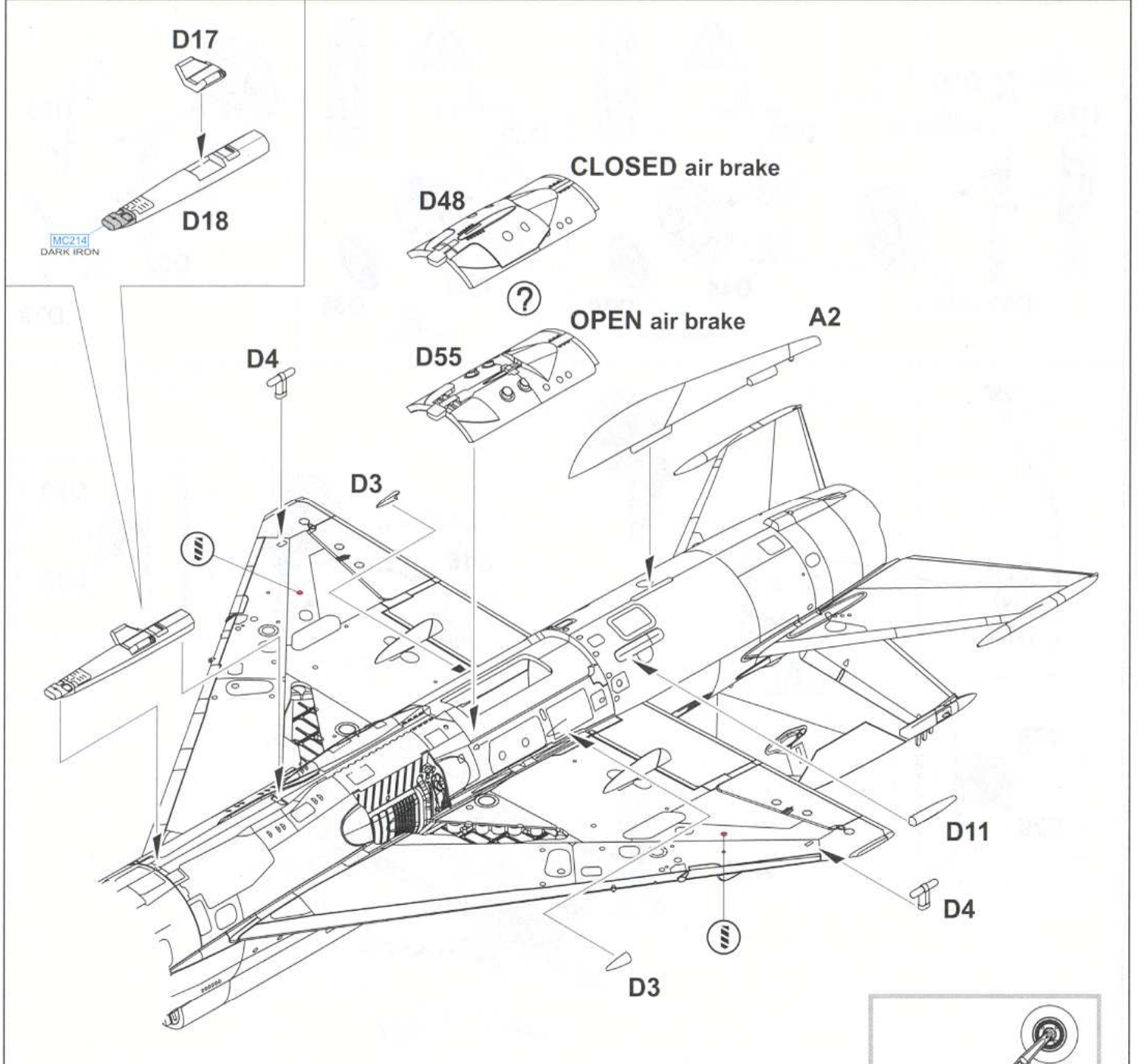

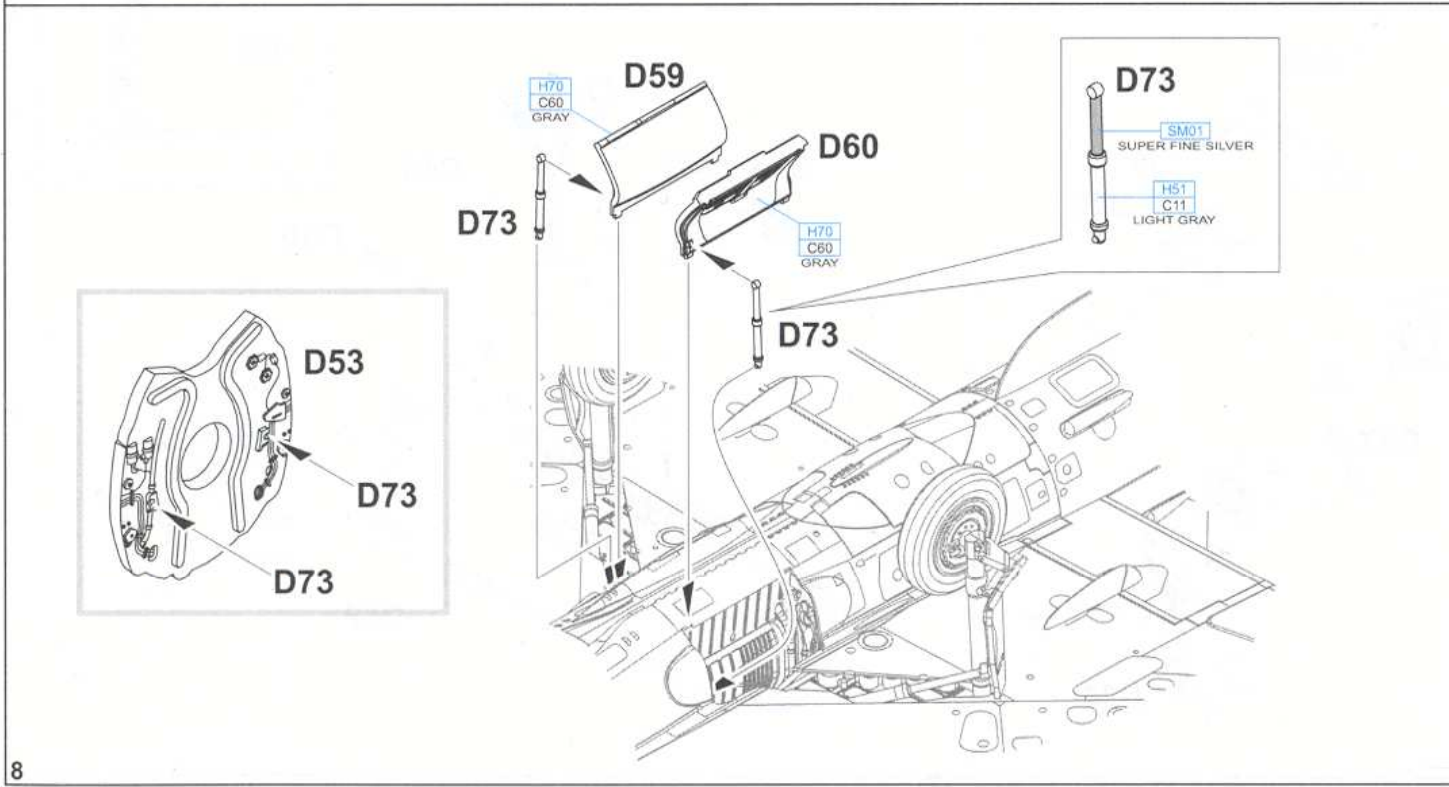
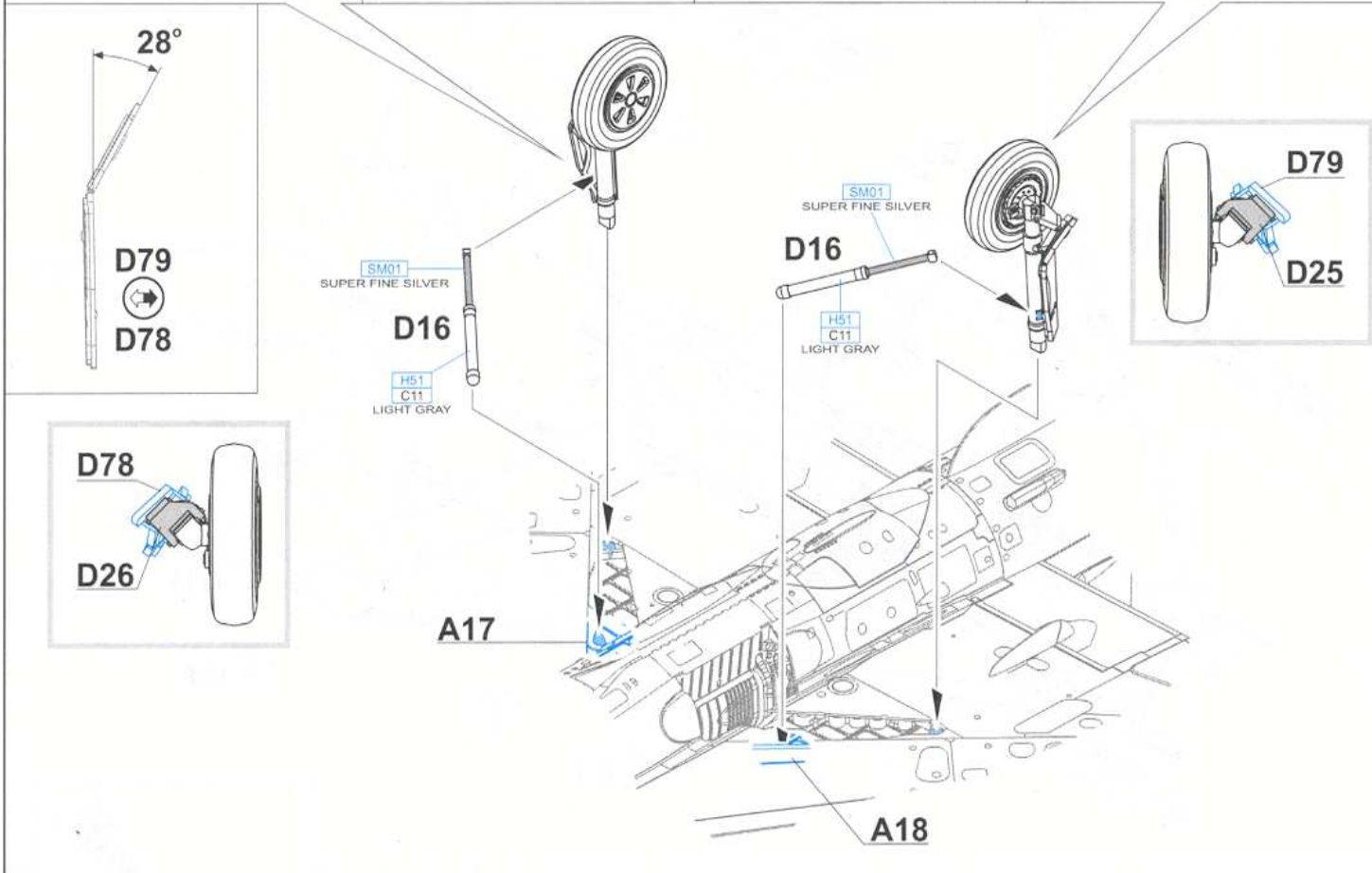
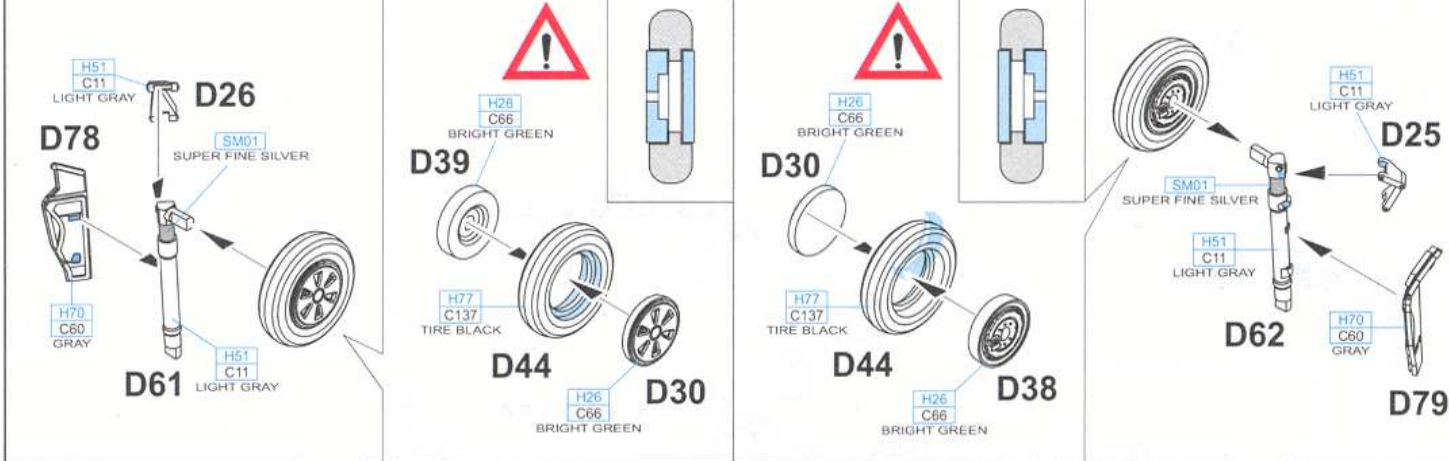

E 2 pcs.

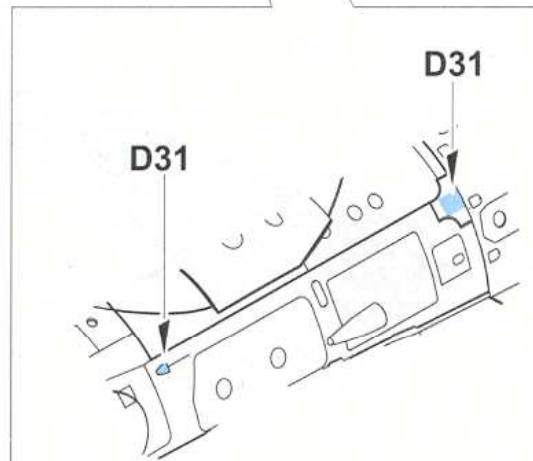
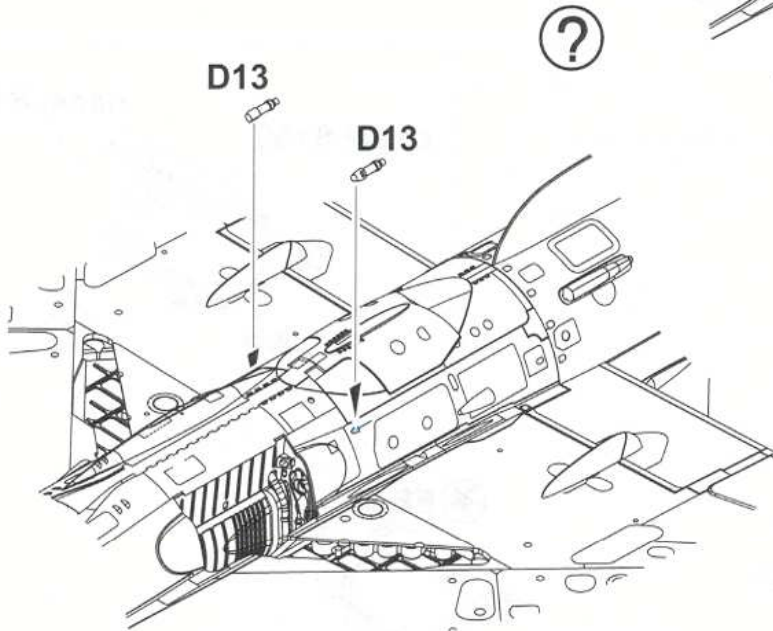
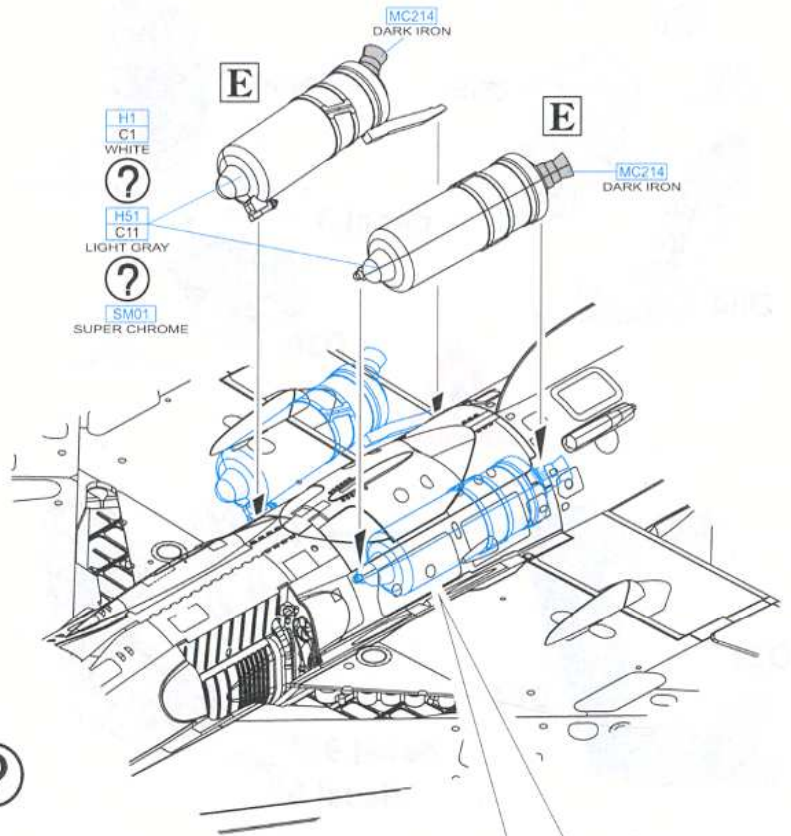
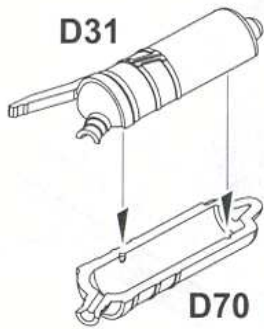

?

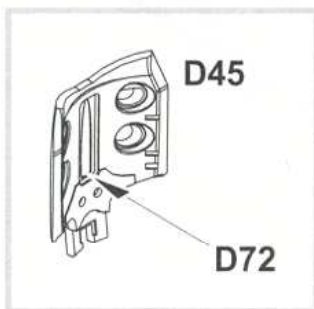

OPEN air brake
D45

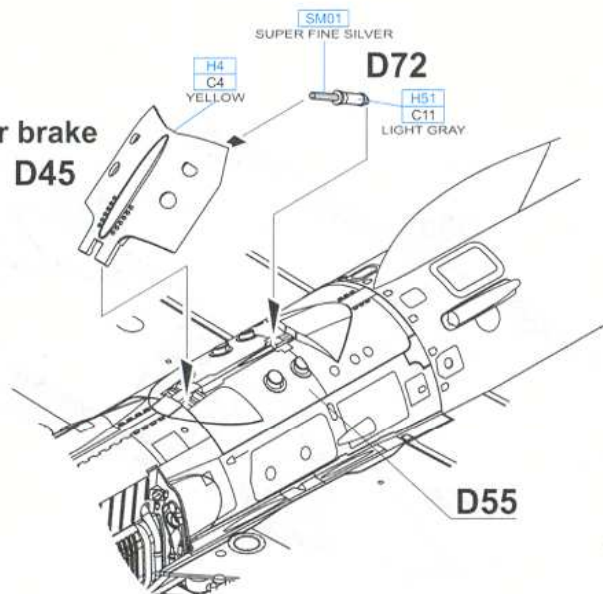

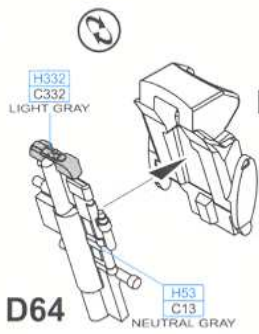

D65

decal 7

decal 8

D36



decal 10

decal 9
decal 9

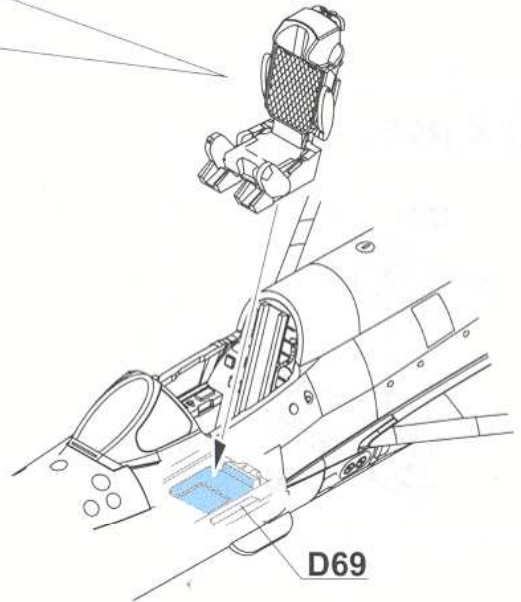
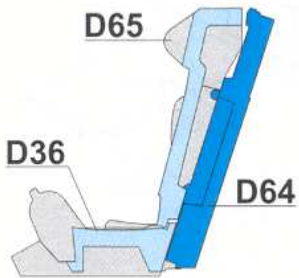

D69

decal S169 decal S168

E6

INTERIOR

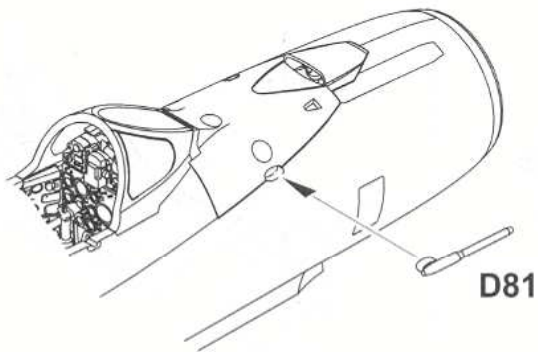

D81

CLOSED
CANOPY

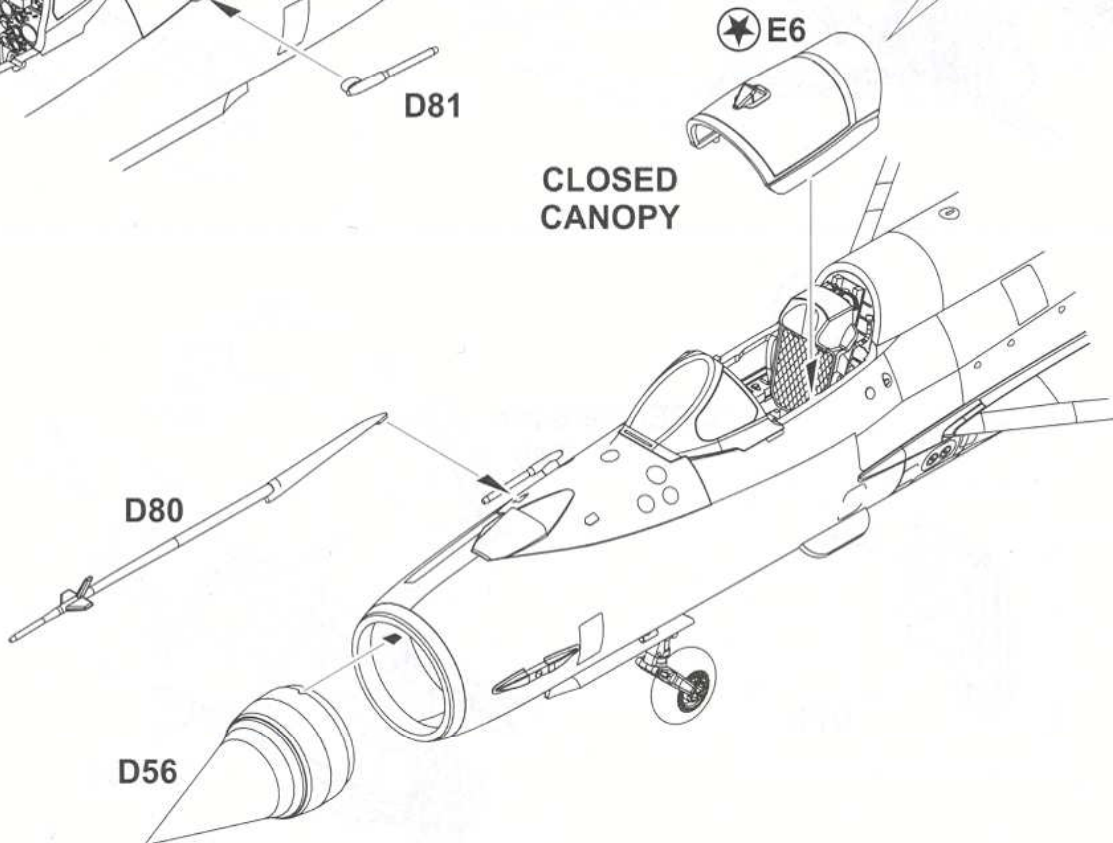

D80

D56

E6

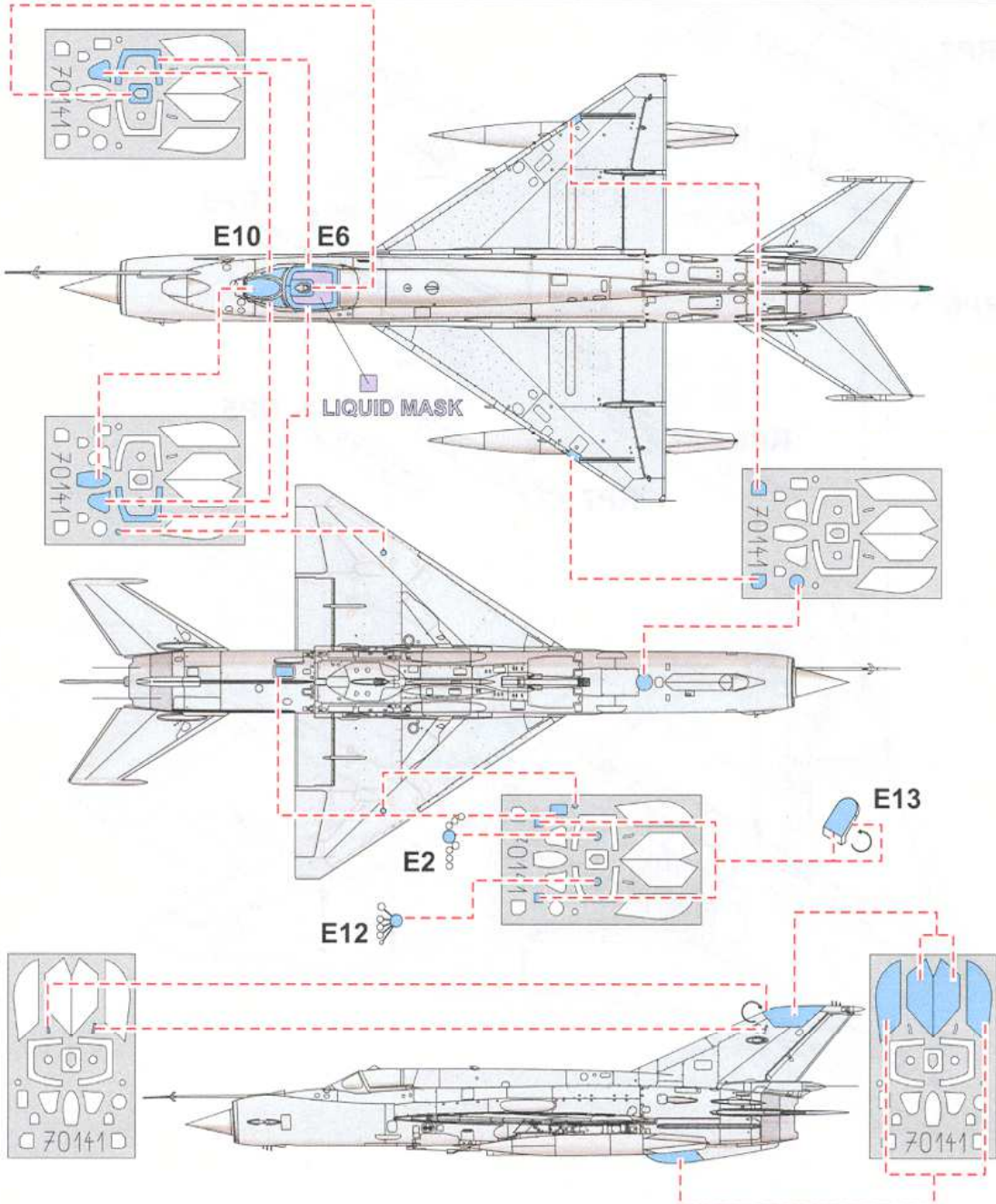
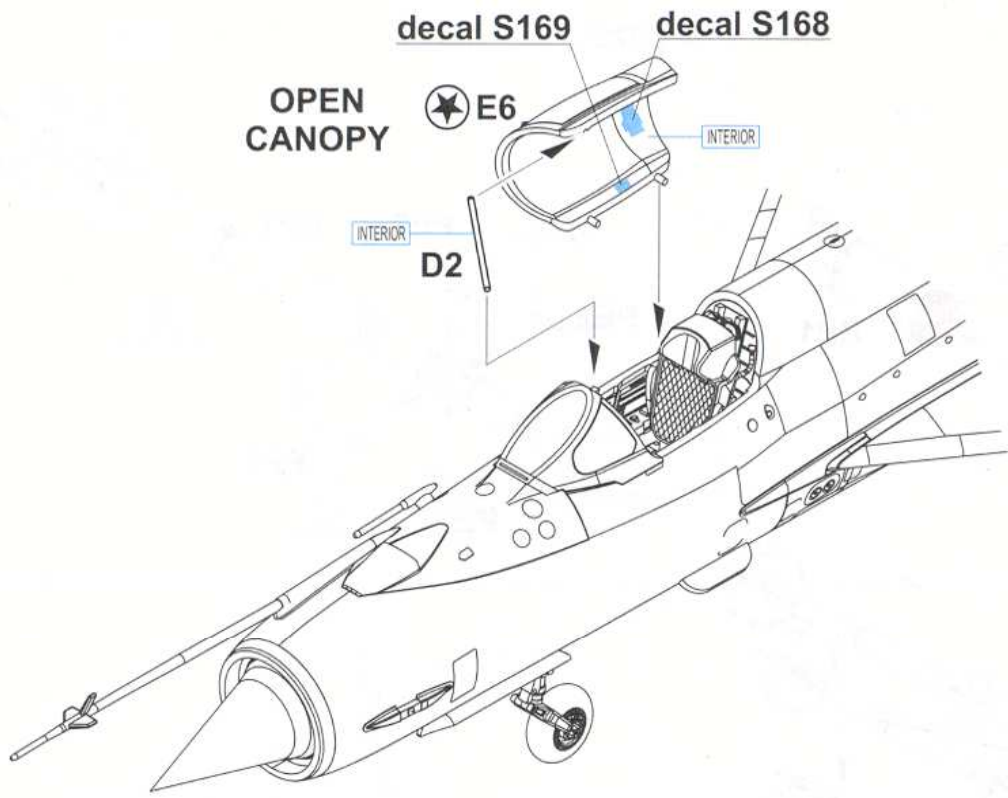

4 pcs.

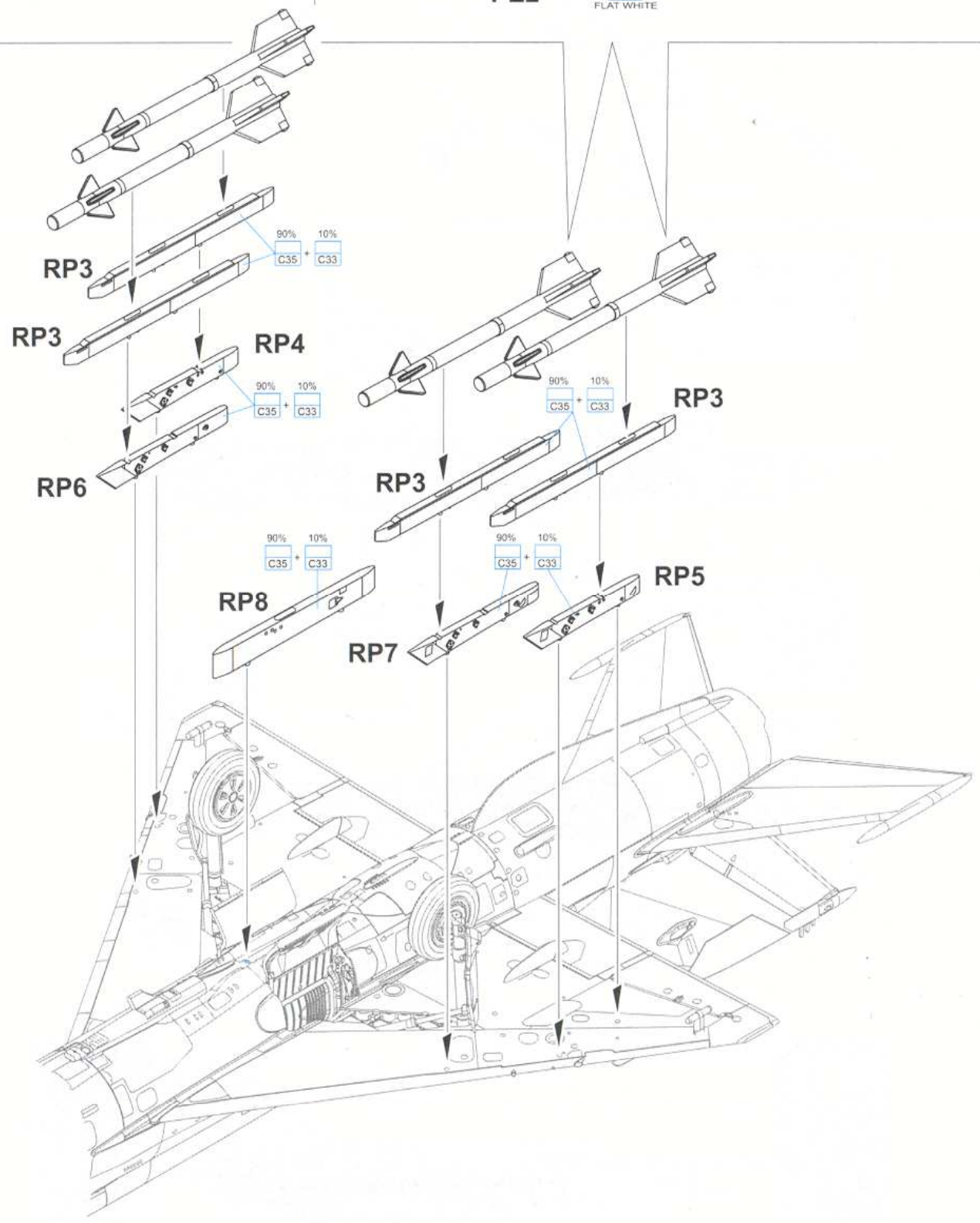
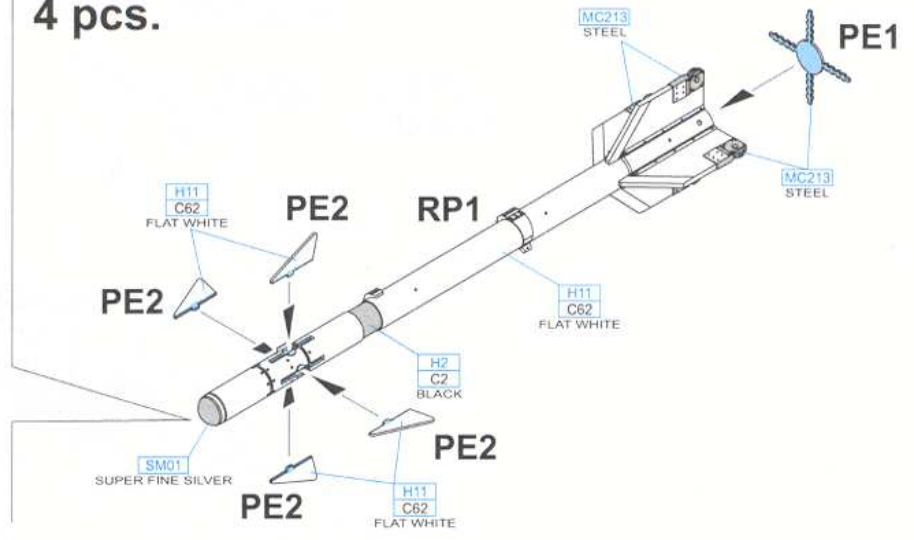
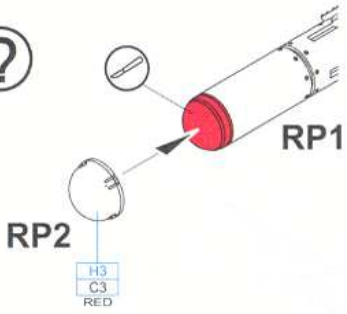

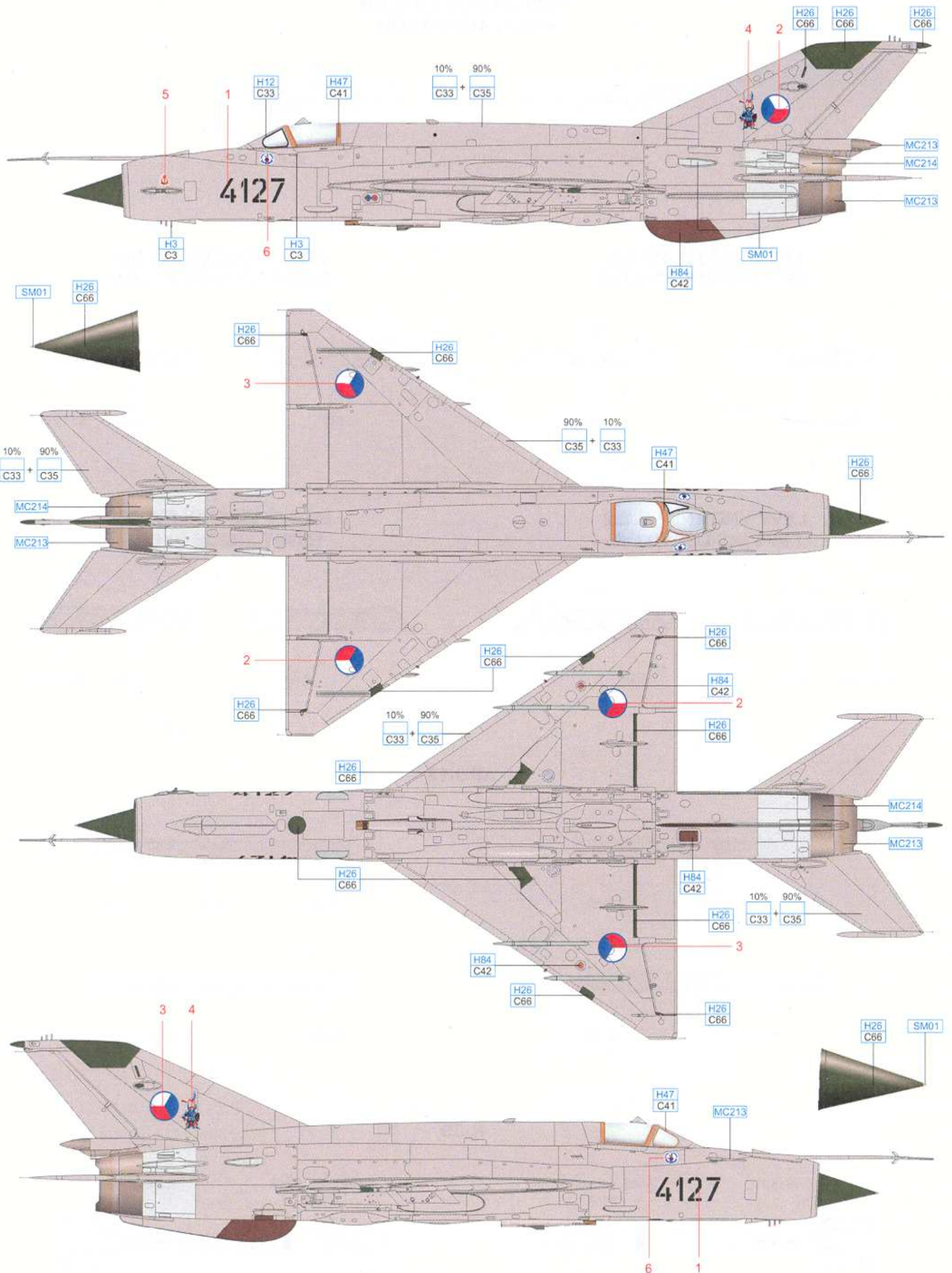

STEEL	MC213	SUPER CHROME	SM01	LIGHT BROWN	H47 C41	LIGHT GRAY	C35
DARK IRON	MC214	GREEN	H26 C66	DARK BROWN	H84 C42	BLACK	H12 C33
						RED	H3 C3

PODTRUPOVÝ PYLON FUSELAGE PYLON

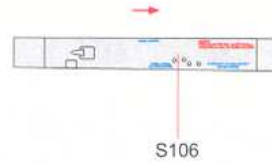
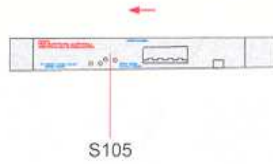

LEVÝ VNĚJŠÍ PYLON LEFT OUTSIDE PYLON

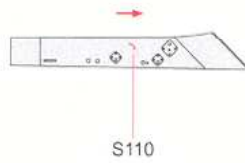
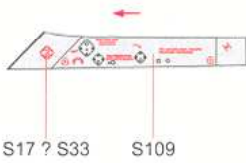

PRAVÝ VNĚJŠÍ PYLON RIGHT OUTSIDE PYLON

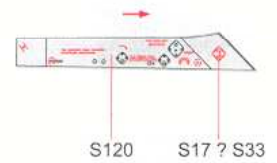
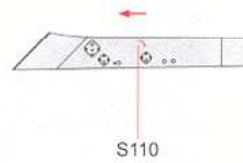

LEVÝ VNITŘNÍ PYLON LEFT INSIDE PYLON

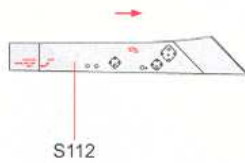
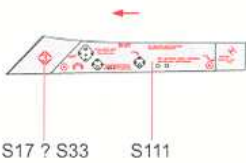

PRAVÝ VNITŘNÍ PYLON RIGHT INSIDE PYLON

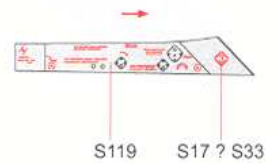
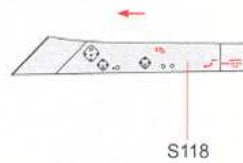

APU-13

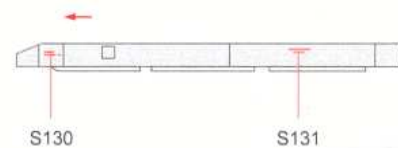
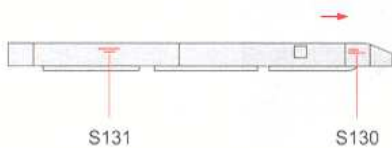

R-3S

