

"THE ENAMEL WITH THE SPRAYED ON LOOK"

- ONE COAT COVERS
- NO BRUSH MARKS
- DRIES IN 30 MINUTES



SPEED-DRY ENAMELS are AURORA'S REVOLUTIONARY NEW ENAMEL PAINTS developed after years of research especially for Plastic Models and other products of Wood, Metal, Glass or China.

BEFORE ASSEMBLING THE P-51 MUSTANG CAREFULLY STUDY SKETCH AND PLACE ALL PARTS ON WORK TABLE, AS INDICATED. IMPORTANT — APPLY CEMENT TO INSIDE SURFACES ONLY. AVOID GETTING CEMENT ON OUTER SURFACES OF PLANE SECTIONS. USE CEMENT VERY SPARINGLY AND AVOID GETTING CEMENT ON HANDS, SO AS NOT TO MAR OR SMEAR PLASTIC SURFACES. DO NOT HURRY. WORK CAREFULLY AND PATIENTLY. FOR BEST RESULTS ASSEMBLE MODEL EXACTLY IN THE ORDER INDICATED. BEFORE PROCEEDING TO CEMENT PARTS TOGETHER, IT IS ADVISABLE TO FIT PARTS TOGETHER DRY (WITHOUT CEMENT) SO THAT YOU MAY FAMILIARIZE YOURSELF WITH THE PARTS AND HOW THEY GO TOGETHER, ALSO NOTING THE POINTS WHERE CEMENT IS TO BE APPLIED.

1. Locate and cement SEAT to FLOOR PANEL.
2. Locate and cement CONTROL STICK to FLOOR PANEL.
3. Locate and cement THROTTLE to rib on FLOOR PANEL.
4. Locate and cement PILOT to SEAT.

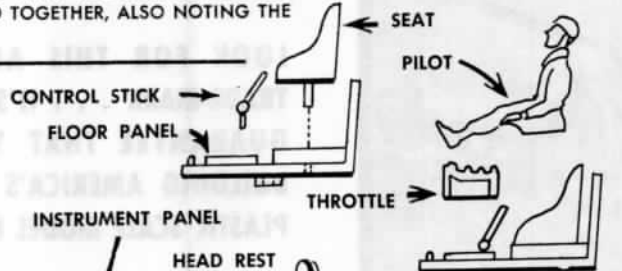

5. Locate and cement INSTRUMENT PANEL to FLOOR PANEL.
6. Locate and cement RADIO PANEL to back of SEAT.
7. Locate and cement HEAD REST to front of RADIO PANEL.
8. Locate and cement DOOR HINGE PANEL to bottom of FLOOR PANEL by applying cement to top of HINGE PANEL and inserting into slot in underside of FLOOR PANEL. Set assembly aside to dry.

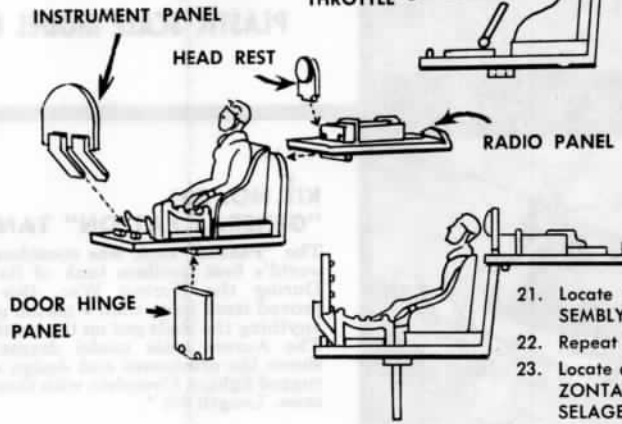

9. Locate and cement ENGINE HALVES together. Before joining ENGINE HALVES be sure to locate PROPELLER SHAFT into hole in front of ENGINE. CAUTION: Do not get any cement near or around propeller shaft hole.
10. Locate and cement OIL COOLER PIPE to ENGINE and set aside to dry.

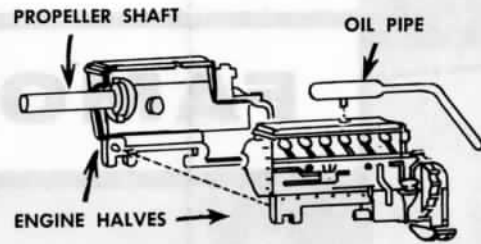

11. Locate and cement left LANDING GEAR WHEEL (Marked L) to STRUT DOOR (Marked L) and set aside to dry. NOTE: Top end of WHEEL STRUT must bear against top end of slot in STRUT DOOR.
12. Locate and cement right LANDING GEAR WHEEL (Marked R) to STRUT DOOR (Marked R) and set aside to dry.

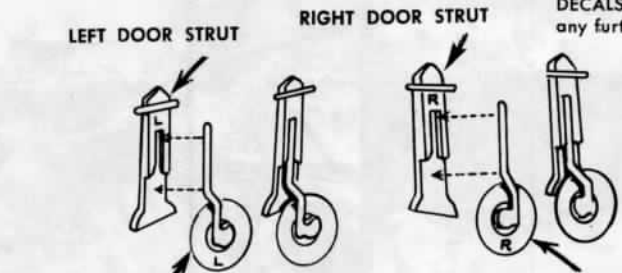

13. Locate, but DO NOT CEMENT, left STRUT DOOR and WHEEL ASSEMBLY (Marked L) in left BOTTOM WING (Marked LB). Then cement left TOP WING HALF (Marked LT) to BOTTOM WING HALF. IMPORTANT: In order for WHEEL and DOOR ASSEMBLY to be RETRACTABLE, do not get any cement near or around STRUT DOOR or WHEEL.
14. Repeat same procedure for RIGHT WING and set aside to dry.

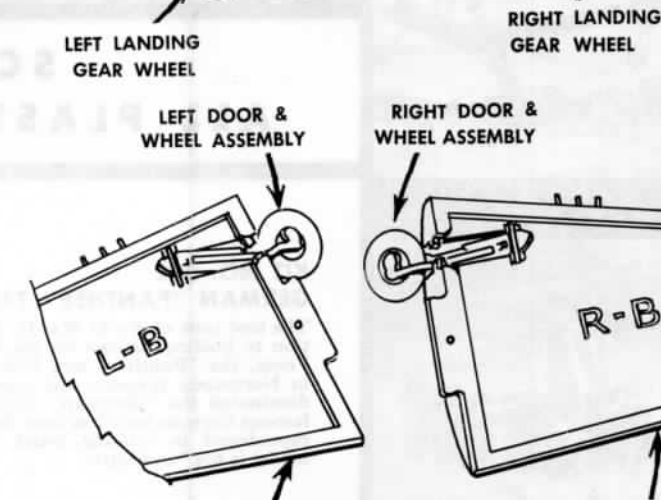

15. Locate and cement FIRE WALL between ribs inside FUSELAGE.
16. Locate and cement previously assembled FLOOR PANEL with pilot, seat, instrument panel, etc., to locating ribs in FUSELAGE. NOTE: DO NOT APPLY ANY CEMENT TO DOOR HINGE PANEL.
17. Locate and cement ENGINE onto ribs inside FUSELAGE.
18. Locate and cement FUSELAGE HALVES together.
19. Snap hinge pins on LEFT DOOR (Marked L) into holes in bottom of DOOR HINGE PANEL and FIRE WALL on left side of FUSELAGE. NOTE: Left and right sides are marked L and R on lower end of FIRE WALL.
20. Repeat same procedure for RIGHT DOOR.

21. Locate and cement tab on LEFT WING ASSEMBLY to slot in left side of FUSELAGE.
22. Repeat for RIGHT WING ASSEMBLY.
23. Locate and cement tab on left and right HORIZONTAL STABILIZERS to slots in tail of FUSELAGE.
24. Locate and cement PROPELLER to PROPELLER SHAFT.
25. Locate and cement CANOPY to FUSELAGE.
26. Locate and cement TAIL WHEEL to FUSELAGE.
27. Locate and cement RADIO ANTENNA to FUSELAGE.
28. Locate left ENGINE SIDE PANEL over opening on left side of FUSELAGE, DO NOT CEMENT—SIDE PANEL is designed to snap in place so as to be REMOVABLE.
29. Repeat for right ENGINE SIDE PANEL.
30. Cut out sections of DECALS to correspond with markings on plane. Read directions on back of DECALS before applying. Allow to dry before any further handling.

RIGHT WING ASSEMBLY



Every effort has been made to insure the completeness of this Kit—however, should any part be missing, write directly to:

AURORA PLASTICS CORP.
West Hempstead, L. I., N. Y., Dept. M

(When writing please print your NAME and ADDRESS PLAINLY)



AURORA PLASTICS CORP.
West Hempstead, L. I., N. Y.

MADE IN U. S. A.

His

Designed for the British in 1941 this plane endured as a first line fighter in Korean action. First known as the X-1 States and as the NA-73 "Mustang" British nickname. Not only is it a classical design but also it personifies the length of time from the initial to its first flight was an amazingly long time. The aforementioned experimental model P-51 were powered by an Allison A-66 engine with a top speed of 387 MPH. The reception of the air arms was so good that manufacturing was increased. The P-51B had only slight improvements retaining the old "greenhouse" type size of the belly radiator scoop and rudder. Probably the biggest change was a switch to a Packard built Rolls-Royce incorporates two-speed, two-stage supercharger and glycol cooling. The more powerful engine had a higher service ceiling than the Allison A-66. Production of the P-51B reached 437 MPH. Production of the P-51C was 437 MPH. Improvements on the engines continued and the overall configuration of the "Mustang" was changed.

"PRAYED ON LOOK"



"S REVOLUTION-
ed after years
ic Models and
Glass or China.

WALL between ribs

ly assembled FLOOR
strument panel, etc.,
GE. NOTE: DO NOT
DOOR HINGE PANEL.
INE onto ribs inside

ELAGE HALVES to-

R DOOR (Marked L)
DOOR HINGE PANEL
ide of FUSELAGE.
as are marked L
RE WALL.
or RIGHT DOOR.

G AS-

HORI-
of FU-

PELLER

AGE.

ELAGE.

to FU-

pening

MENT—

so as

nd with

ack of

before

sure the complete-

ould any part be

S CORP.

. Y., Dept. M

r NAME and AD

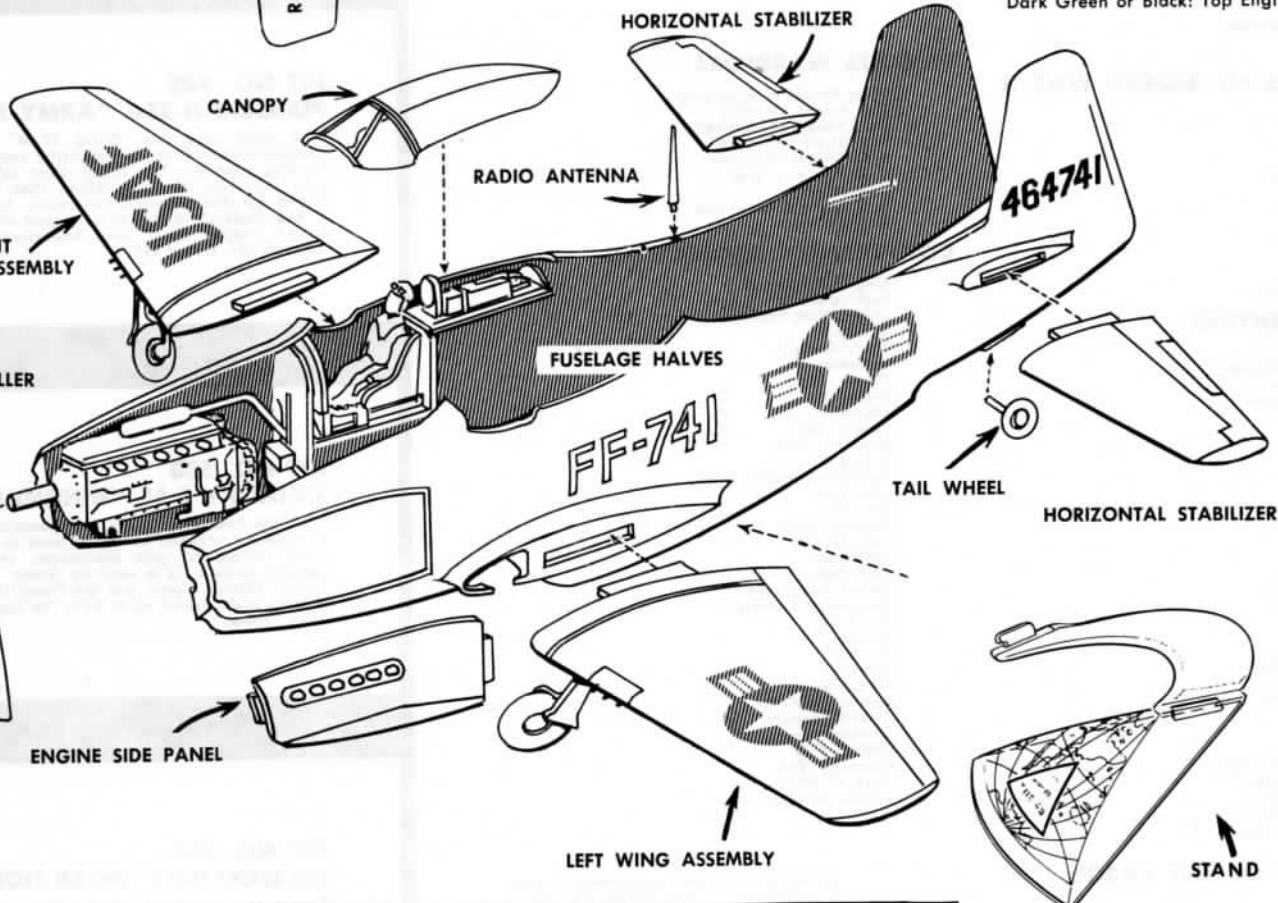
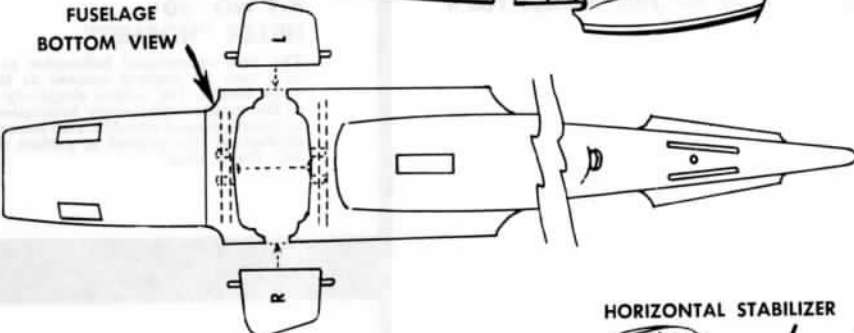
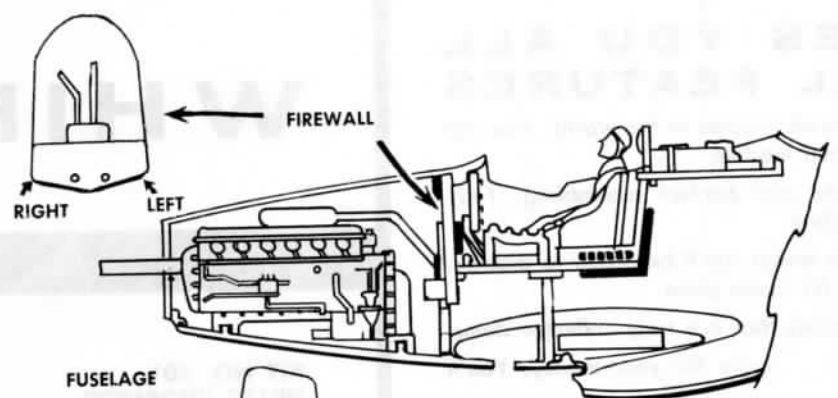

THIS KIT IS MOLDED OF STYRENE PLASTIC

Use Only . . .

AURORA'S

FIREPROOF
STYRENE PLASTIC
CEMENT

TUBE 10c
BOTTLE WITH BRUSH 25c

SUGGESTED DETAIL PAINTING SCHEME

- Black: Tires
- Wing Walks
- Exhaust Stacks
- Engine
- Machine Guns protruding from wings
- Yellow: Tips of Propeller Blades
- Silver: Landing Gear Strut
- Dark Green or Black: Top Engine Cowling

History of the North American P-51 "Mustang"

... for the British in 1941 for use as a low level fighter, ...
 ... as a first line fighter up to and through the recent ...
 ... First known as the XP-51 "Apache" in the United ...
 ... as the NA-73 "Mustang" in Britain, it has retained its ...
 ... name. Not only is it a classic example of superb aero- ...
 ... design but also it personified America's productive genius ...
 ... of time from the initial conception of the "Mustang" ...
 ... fight was an amazingly short 100 days. ...
 ... mentioned experimental model and the first production ...
 ... were powered by an Allison V-12 engine driving it at ...
 ... of 387 MPH. The reception of this fighter by the various ...
 ... was so good that manufacture of it was increased tremen- ...
 ... the P-51B had only slight changes over the prototype, ...
 ... the old "greenhouse" type canopy, but increasing the ...
 ... the belly radiator scoop and squaring off the top of the ...
 ... probably the biggest change was in the power plant with ...
 ... to a Packard built Rolls-Royce "Merlin" engine which ...
 ... es two-speed, two-stage supercharging with fuel injection ...
 ... cooling. The more powerful "Merlin" had a much ...
 ... vice ceiling than the Allison and boosted the "Mustang's" ...
 ... 437 MPH. Production of the "B" model reached 2000 ...
 ... ments on the engines continued with little change in the ...
 ... nfiguration of the "Mustang" until the "D" model reached

the flight line. On this version appeared one of the first "bubble"
 type canopies. This canopy was the answer to the demand of fighter
 pilots for more visibility. In it a full 360 degrees of vision was
 offered plus faster entry to and exit from the cockpit. On the P-51H,
 a triangular web was added to the rudder to produce the "Mustang"
 as we know it today. The Packard-Rolls-Royce engine, the finest
 propeller driving power plant in the world, had been continually
 changing and gave the P-51H a top speed in excess of 460 MPH,
 making it one of the fastest conventional planes in the world.
 On June 11, 1948, the Department of the Air Force revised the
 plane type designation system of the Air Force eliminating the old
 "P" (for pursuit) and substituting for it an "F" (for fighter),
 hence we have the new designation F-51H.
 During World War II the "Mustang" proved versatile by perform-
 ing missions as a fighter-bomber, a photo-reconnaissance plane and
 even as a dive-bomber. The photo-reconversion, known as the F-6,
 carried two K-24 aerial cameras. So aerodynamically perfect was
 the F-51 that two of them were reworked and placed together
 side-by-side to create the F-82, a twin-engined, two-man fighter for
 use as a long range bomber escort and as a night fighter. This
 version carried a radome on the center section of the wing to seek
 out targets on the blackest of nights.
 Although it has been replaced by jets as a first line fighter, the
 F-51 is still in extensive use by Reserve and Air National Guard units.

HOLD FILM WITH MOIST FINGERS

SLIDE OUT PAPER BACK FROM UNDER DECAL

PRESS DECAL DOWN WITH CLEAN DAMP CLOTH TO OBTAIN GOOD CONTACT

1. Cut each decal/commo from sheet separately inside of cutting lines close to design.
2. Dip each decal/commo into water for approximately 30 seconds, and then lay on flat surface.
3. When decal/commo slides easily on paper backing, DON'T FORCE! - with moist fingers slide decal/commo partly off paper and place in location desired. Hold decal/commo in this position and then slide paper backing from underneath design. (Note illustration.)
4. Press out bubbles with soft, damp cloth and allow decal/commo to set.

A HOBBY

AURORA

FOR EVERYBODY

LOOK FOR THIS AURORA TRADE-MARK . . . IT'S YOUR GUARANTEE THAT YOU'RE BUILDING AMERICA'S FINEST PLASTIC SCALE MODEL KITS.

**KIT NO. 301
"GENERAL PATTON" TANK**

The "Patton" tank was considered the world's best medium tank of its time. During the Korean War, this tank proved itself more than a match against anything the Reds put on the battlefield. The Aurora scale model dramatically shows the armament and design of this rugged fighter. Complete with three man crew. Length 5½".



FAMOUS TANKS



**KIT NO. 303
RUSSIAN "STALIN" TANK**

In 1943 the Russians produced the famous T-34 Tank which did much to help drive the Germans from their homeland. From the basic designs of the T-34 the Russians now boast the greatly improved "Stalin" Tank. The Aurora detailed model is 5½" in length and clearly shows the power of this big tank.

SCALE MODEL ALL PLASTIC ASSEMBLY KITS

**KIT NO. 302
GERMAN "PANTHER" TANK**

The best tank of World War II. In addition to holding its own on the Eastern Front, the "Panther" met U.S. Forces in Normandy invasion and completely dominated the "Sherman" tanks. This famous German tank has been faithfully reproduced in exciting detail. Aurora model is 5½" in length.



WHIRLYBIRDS

KIT NO. 501 HILLER "HORNET"

The first operational helicopter to be powered with ram jet engines located at the tips of its rotor blades. Its radical simplicity made it one of the most revolutionary helicopters in the field of rotary-winged aircraft. The Aurora scale model duplicated the original in perfect detail. Length 10". Rotor 18 $\frac{1}{4}$ ".



KIT NO. 502 PIASECKI H-25A "ARMY MULE"

The Army uses this "flying Mule" for laying communication lines, transporting personnel and hauling supplies. The Navy, they call it HUP, owe the lives of many pilots that have been saved by this versatile helicopter. In addition, it has chalked up several thousand civilian lives saved during flood and hurricane disasters. Length 14". Rotor 11".



KIT NO. 503 SIKORSKY S-55 "WINDMILL"

The first helicopter to fly the Atlantic. The S-55 in military versions has been used in Korea for troop transport, gun placement, even as an assault aircraft. It is used by Army, Navy, Air Force, Marine Corps and the Coast Guard. The Aurora scale model kit is 11 $\frac{1}{2}$ " in length with a 14 $\frac{1}{2}$ " rotor.



KIT NO. 504 PIASECKI H-21 "WORK HORSE"

The H-21 is a single-engine, tandem rotor, assault transport helicopter. It is capable of carrying up to twenty passengers plus crew of two. In 1953, an H-21 held the world's speed and altitude record for helicopters. The detailed Aurora model is 14" in length and has an 11" rotor.



KIT NO. 505 KAMAN HOK "EGG BEATER"

The Kaman, a Navy helicopter, became nationally famous during the disastrous 1955 floods in Connecticut. With thousands of families trapped by the fast-rising waters, the "Egg Beaters" brought Doctors, food and medical supplies to inaccessible areas. Aurora model has 11 $\frac{1}{4}$ " rotors and 6" length.



ONLY AURORA GIVES YOU ALL THESE SCALE MODEL FEATURES

- Aurora offers the largest collection of truly authentic scale models in the world. You can choose from 17 exciting categories with over 150 different models.
- Aurora's years-ahead engineering insures quick, easy and perfect assembling. Fully illustrated instructions are complete, clear and easy to follow.
- Aurora's super-detail and dramatic realism gives you a model you'll be proud to display. All military kits are scaled from official army, Navy and Air Force plans.
- Aurora's research brings you unusual, hard-to-find models that are truly collector items.
- Aurora gives you more to build . . . more to display . . . more for your money. You'll see for yourself the very first kit you build.

FAMOUS FIGHTERS OF WORLD WAR I

French Nieuport
Sopwith Camel
British Scout SE-5
German Albatross D-3
Fokker DRI Triplane
Fokker D-7
Spad 13
Nieuport 28
Pfalz D-3
DeHaviland DH-4
F2B "Brisfit"
JN-4 "Jenny"
DeHaviland DH-10 Bomber
Gotha Bomber

FAMOUS FIGHTERS OF WORLD WAR II

B-17 Flying Fortress
British Spitfire
Focke Wulf
P40 Flying Tiger
ME 109 Messerschmitt
AT-6 "Texan"
SNJ Navy Trainer
Jap Zero
Hellcat
Russian Mig 19
P-51 "Mustang"
P38 Lockheed Lightning

MODERN DAY FIGHTERS

Convair F102 "Dart"
Lockheed F104 "Starfighter"
Douglas F4D "Skyray"
Grumman F9F6 "Cougar"
F-94C Starfire
F-100 Super Sabre
B-36 Bomber
B-47 Stratojet
B-52 Stratofortress
F9F Panther Jet
Lockheed VTO
F86D Sabre Jet
F90 Lockheed
Convair V.R.
F8U "Crusader"

GIANT BOMBERS

PBY "Catalina"
B26 Martin "Marauder"
B-29 Superfortress
B25 "Mitchell" Bomber

WHIRLYBIRDS

Piasecki H-25A "Army Mule"
Kaman Hok "Egg Beater"
Hiller Hornet "Ram Jet"
Sikorsky S-55 "Windmill"
Piasecki H-21 "Work Horse"

POPULAR PLANES OF THE 1930's

Boeing P-26A
Curtiss P-6E
Curtiss SBC3 "Helldiver"
M-2 "Mail Plane"
Boeing P12E
Boeing F4B4

U.S. NAVY WARSHIPS

Destroyer Bennion
Cruiser St. Paul
Atomic Sub. SSN Sea Wolf
Destroyer USS Halford
Battleship Iowa
Carrier USS Forrestal
Carrier USS Saratoga

HISTORIC SAILING SHIPS

Pirate Ship Black Falcon
Viking Ship
Chinese Junk
Blue Nose Schooner

FAMOUS TANKS

Patton Tank
Panther Tank
Stalin Tank

FAMOUS WARRIORS

Silver Knight of Augsburg
Blue Knight of Milan
Black Knight of Nurnberg
Red Knight of Vienna
Gold Knight on Horse
U. S. Air Force Pilot
U. S. Sailor
U. S. Army Infantryman
U. S. Marine

COPPERSMITH COLLECTION

King of the Beasts
Bucking Bronco
Chief White Feather
Ballerina
Pirate Captain
Madonna
Flower Spray
Elephant
Clown
Liberty Bell
American Flag
Buffalo Hunt
Venetian Gondola
Wild Deer
Sea Life
Colonial Lady
Colonial Man
Haiti Lady
Haiti Man
Mercer Raceabout
Bouquet of Flowers
Venus
Modern Fish
Painter
Kittens
Flying Geese
Roman Gladiator
Oriental Beauty
Oriental Man
Clipper Ship
Hawaiian Eve
Vase of Roses
Indian Warrior





USAF
USAF

U.S. AIR FORCE
464741

U.S. AIR FORCE
464741

FF-741 **FF-741**

1. Cut each decalcomania from sheet separately inside of cutting lines.
2. Dip each decalcomania into water for approximately 30 seconds. When decalcomania slides easily on paper backing (Don't force.) with moist fingers, slide decalcomania partly off paper and place in location desired. Hold decalcomania in this position and then slide paper backing from underneath design.
3. Press out bubbles with soft, damp cloth and allow decalcomania to set.

AURORA PLASTICS

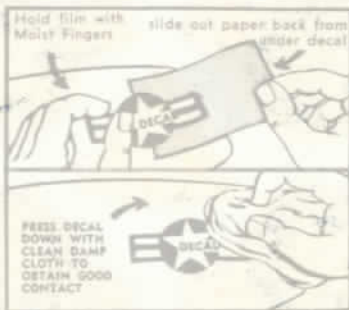

ACZ-2627 #1 SA #1 7533
Kit No. 118-13
MADE IN U.S.A.