

PLEASE OPEN CAREFULLY — INSTRUCTIONS OVERLEAF

Ask for other AIRFIX models in this series

The Skyhawk is powered by a Wright J65 Turbojet, giving a speed of approximately 700 m.p.h. Armament consists of two 20 mm. cannon, and underwing load can include bombs, rockets or guided missiles. Wing span: 27 ft. 6 in. Length: 39 ft. 5 in.

Designed and built within eighteen months, the tiny Skyhawk combines a speed comparable with many fighters and the ability to carry an atomic bomb. It is designed to operate from any size of aircraft carrier, or from short landing fields. Because of the small size the Skyhawk does not require the folding wings necessary for most carrier-based aircraft, and simplified design makes it easier to produce and maintain than the normal complicated modern jet aircraft.

The A4D Skyhawk fighter-bomber, which entered service with the U.S. Navy in October, 1956, is claimed to be the smallest and lightest American combat jet.

THE DOUGLAS A4D-1 SKYHAWK



AIRFIX - 72 SCALE

A4D-1 SKYHAWK

SKYHAWK

INSTRUCTIONS

PAINT ALL DETAILS AND LET DRY BEFORE ASSEMBLING (SEE SECTION 4)
 N.B. FOR PAINTING USE "AIRFIX" PAINTS, FOR FIXING USE "AIRFIX" POLYSTYRENE CEMENT

1 FUSELAGE ASSEMBLY

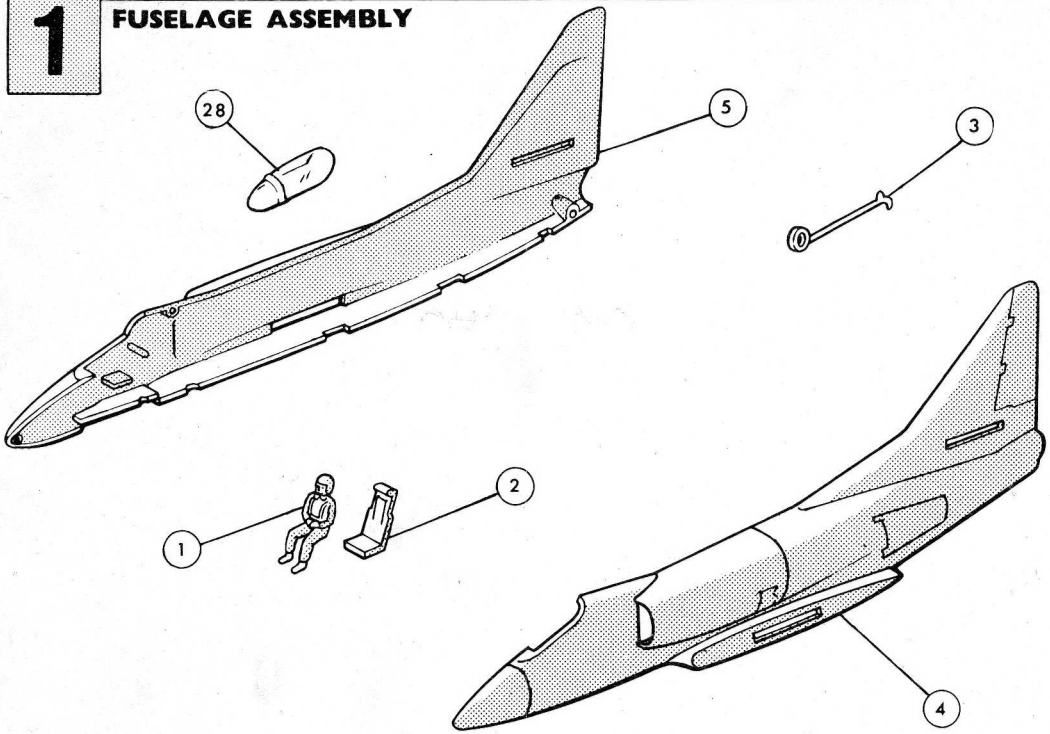

It is recommended that the instructions and exploded view are studied before assembly. If it is wished to paint internal details such as pilot and cockpit interior this should be done before assembly.

1. Cement pilot (1) on to ejector seat (2) after first painting if required.
2. Locate and cement seat into locations provided in one fuselage half.

3. Position arrester hook (3) on locating pivot in port fuselage half. (4)
4. Cement together port and starboard (5) sides of fuselage, ensuring no cement comes into contact with arrester hook.
5. Cement canopy (28) into position, applying cement carefully to edges of canopy.

2 WING ASSEMBLY

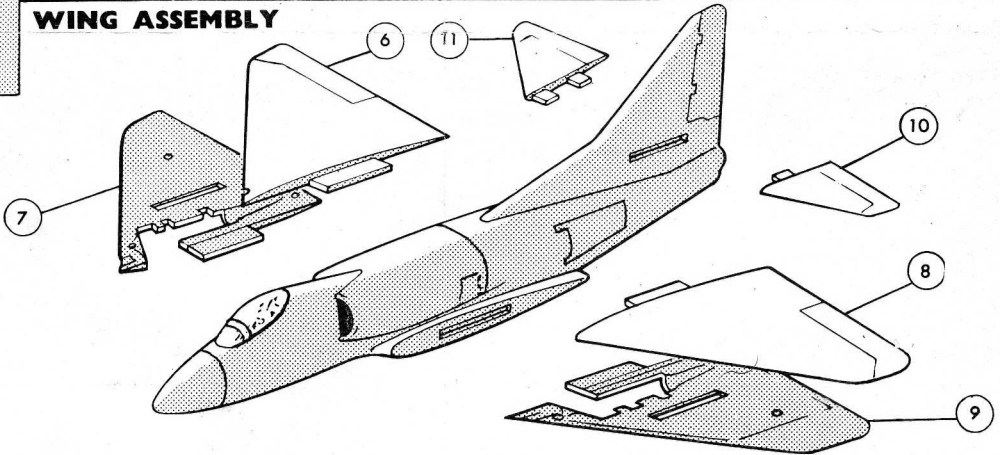

6. Cement together upper and lower halves of port and starboard wings (6, 7, 8 and 9).
7. When wings are dry cement into locating holes in

fuselage sides, by means of tabs on wings.

8. Cement tabs on port and starboard tailplanes (10, 11) into slots in tailfin.

3 UNDERCARRIAGE ASSEMBLY

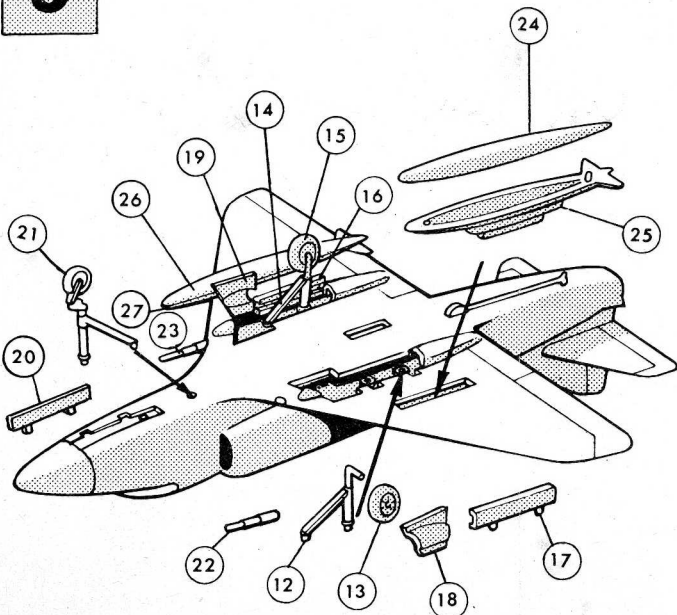

THE DESIRED UNDERCARRIAGE POSITION SHOULD NOW BE CHOSEN.

9. For a model with lowered undercarriage. Cement wheels on to axles of undercarriage legs (12, 13, 14 and 15).
10. Locate and cement main undercarriage doors (16, 17) to wings, outboard of wheel wells.
11. Similarly locate and cement forward main undercarriage doors (18 and 19)
12. Cement undercarriage legs into wing locations.
13. Locate nose wheel door in position beneath nose and cement (20).
14. Cement nose wheel (21) into locating hole.
15. Cement cannons (22, 23) into locating holes in wing roots.
16. Carefully cement together upper and lower halves of fuel tanks; (24-27) when dry cement locating slots beneath wings.

For a model with retracted undercarriage the wheels and undercarriage legs are omitted and the undercarriage doors cemented in place flush with the under-surface of the wing.

NOTE:—If it is wished to paint the model it should be done at this stage.

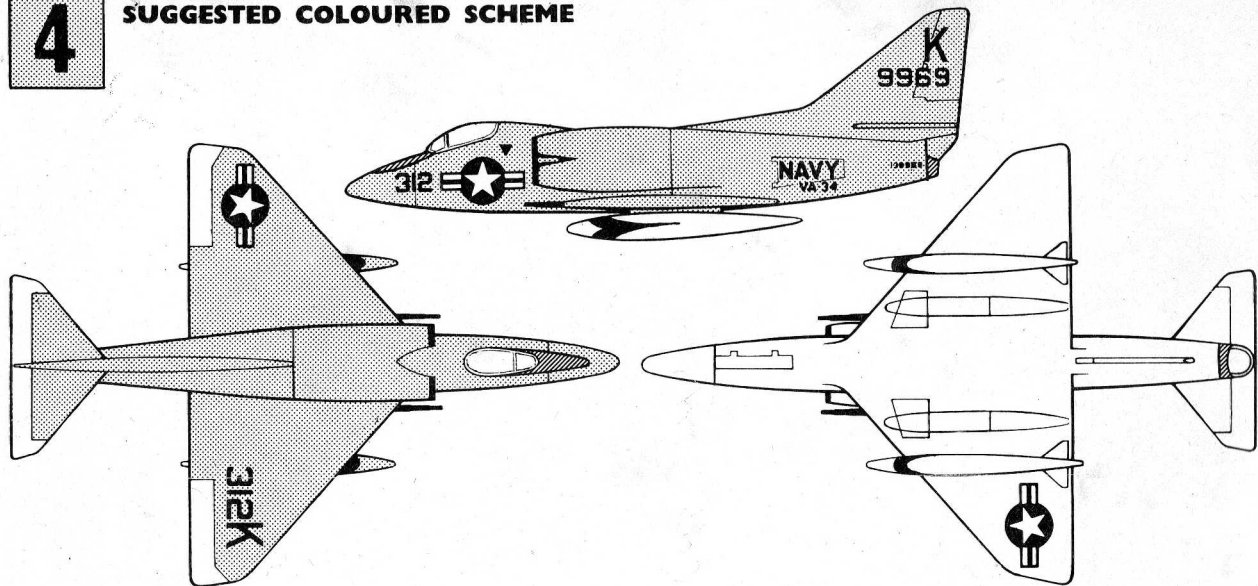
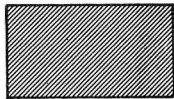
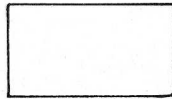
4**SUGGESTED COLOURED SCHEME****LIGHT GREY****DARK GREY****WHITE G2****RED G.1**

17. Apply transfers. First cut the sheet into eighteen separate subjects. Then dip each in warm water for a few minutes, slide off backing into positions as indicated on illustration. The national stars are applied on either side of the nose above the port and below the starboard wings. The large "312K" is applied above the starboard wing, and the two transfers "K9969" are applied on either side of the fin. The number transfers "312" are applied to either side of the nose, forward of the insignia, and the ejector warning triangles beneath the cockpit, behind the insignia. The warning arrows are applied to the sides of each jet intake, the "NAVY" transfers to the rear fuselage, and the small serial numbers to the rear fuselage beneath the tailplane. The aircraft name is applied to transparent base.

18. Cement together both parts of stand.

19. Cement arm of stand into slot provided in fuselage. N.B. If it is not wished to use the stand it will be found that the model can be made to assume its correct ground position by lowering the arrester hook to the ground.

WHITE G2: All undersurfaces, ailerons and elevators.

LIGHT GREY: All upper surfaces except ailerons and elevators.

BLACK M6: Tyres, cannons.

DARK GREY: Anti-glare panel around cockpit.