

## EE Lightning F.1/F.2



In 1947 the Ministry of Supply issued Experimental Requirement 103 for a manned research aircraft capable of exploring transsonic and supersonic speeds.

English Electric and Fairey Aviation submitted proposals, the former being designated the P.1 designed initially by W.E.W. "Teddy" Petter.

Fairey Aviation submitted proposal too in the design of the FD.2.

Design performance had been set to a maximum speed of Mach 1.5 at a height of 30,000'.

Lightning P1 - The ER103 design study was sufficiently good to be awarded by Air Ministry Requirement F.23/49 for two prototypes and a structural-test airframe. The requirement differed from E.R.103 in that the design had to incorporate military capabilities.

The design was a quite unorthodox - two engines were mounted on top of each other, the upper being slightly more forward, swept wings,

The first time a British aircraft was to go supersonic in level flight was on 11th August 1954. One of these two prototypes - WG760 went transsonic at 30,000 ft, but the event went unrecorded as the flight was too short.

One day later, on 12th August W/C Roland Beamont (who also had experience flying F-86 Sabre) took the aircraft to 38,000' and recorded a speed of Mach 1.02.

The transition was so smooth, it was even unnoticed, the aircraft continued to respond in a normal manner with no apparent difficulty.

There have been other tests and other prototypes, but finally it led to final design. The Lightning finally received its official name on 23 October 1958 at a ceremony which was held at Farnborough.

Lightning have been built in several variants starting F.1, followed by F.1A, F.2 and F.3 and definitive F.6, with responding trainer versions T.4 (based on F.1A) and T.5 (based on F.3).

T.4 and T.5 were two-seaters with pilots seating side by side, having a larger fin and also full armament capabilities like single versions.

Lightning have been also exported to Kuwait and Saudi Arabia.

Service with the RAF had lasted from 1960 until 1988 and now there are still flying Lightnings in private hands.

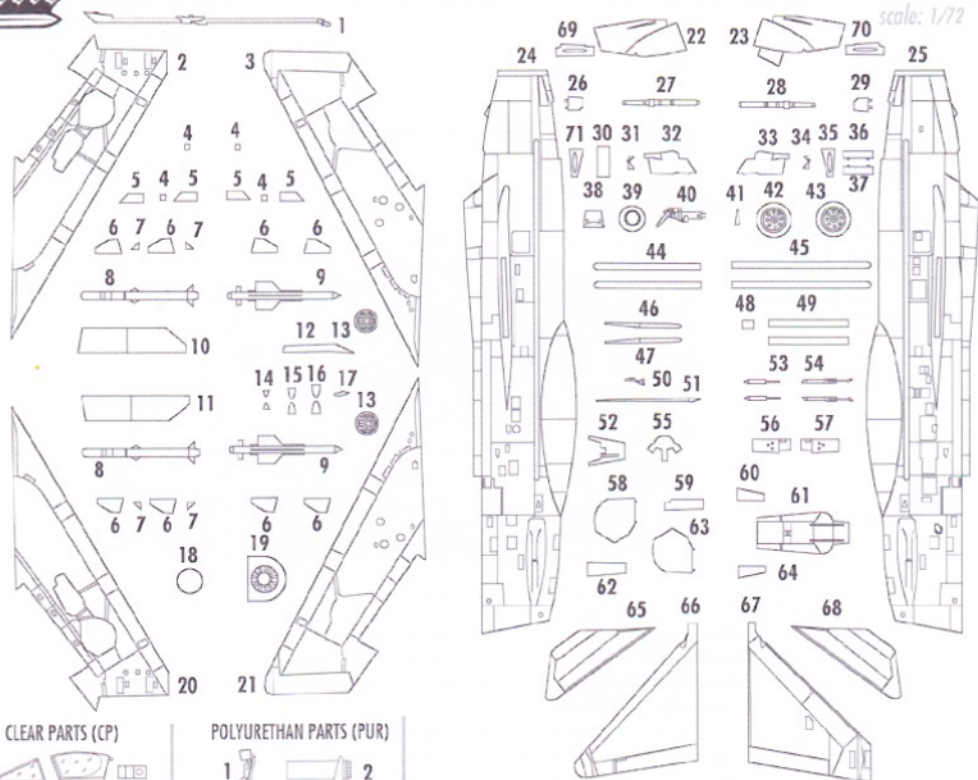

## CLEAR PARTS (CP)

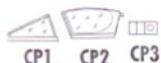

## PHOTO-ETCHED PARTS (PP)

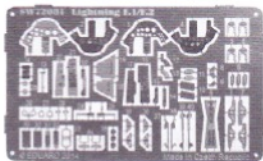

## POLYURETHAN PARTS (PUR)

 OHNOUT  
BEND

 VRTAT  
OPEN HOLE

 VYROBIT  
SCRATCH BUILD

 VTRIVNOVÉ LÉPIDLO  
CYANOACRYLATE GLUE

 SYMETRICKÁ MONTÁŽ  
SYMMETRICAL ASSEMBLY

 VOLBA  
OPTION

 ODSTABNIT  
REMOVE

? F.1

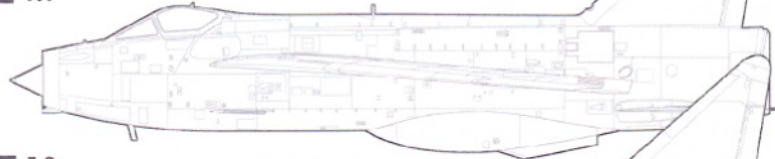

? F.2

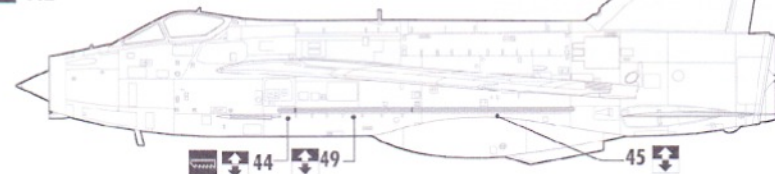

## BARVA/COLOR

- A ČERNÁ/BLACK
- B INTERIÉROVÁ ČERNÁ  
INTERIOR BLACK
- C STŘÍBRNÁ/SILVER
- D HLINÍK/ALUMINIUM
- E ČERVENÁ/RED
- F ŽLUTÁ/YELLOW
- G OLIVOVÁ  
OLIVE
- H PÍSKOVÁ  
SAND
- I CHROM/CHROME
- J HNĚDÁ/BROWN
- K KOV/GUN METAL
- L ŠEDÁ/GREY
- M PNEU/TYRE BLACK

STEP 1

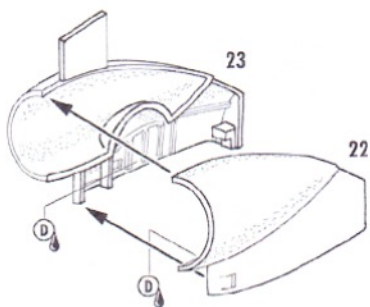

STEP 2

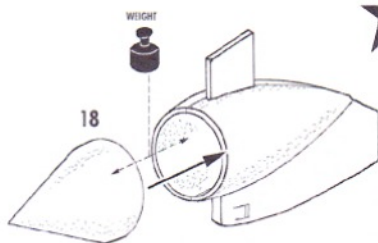

STEP 3

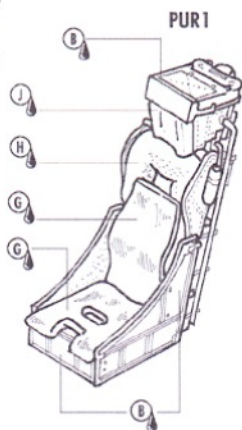

STEP 4

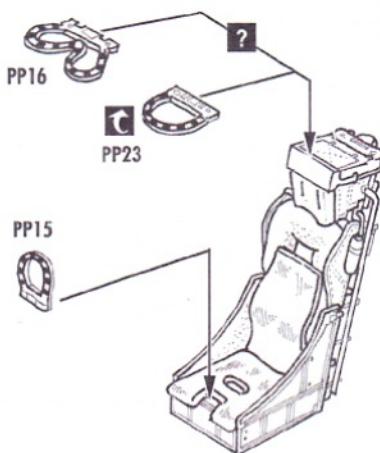

STEP 5

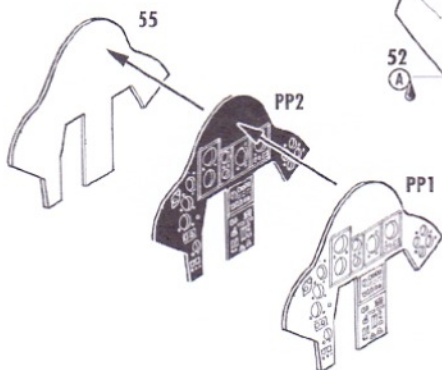

STEP 6

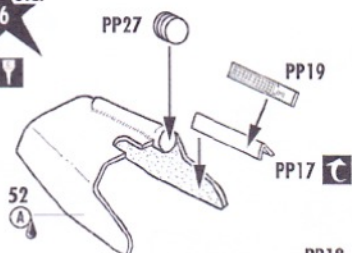

STEP 7

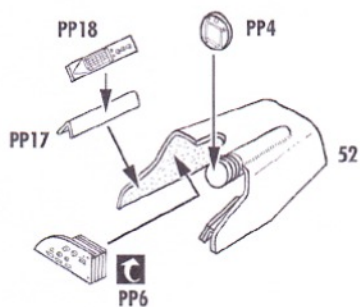

**STEP**  
**8**

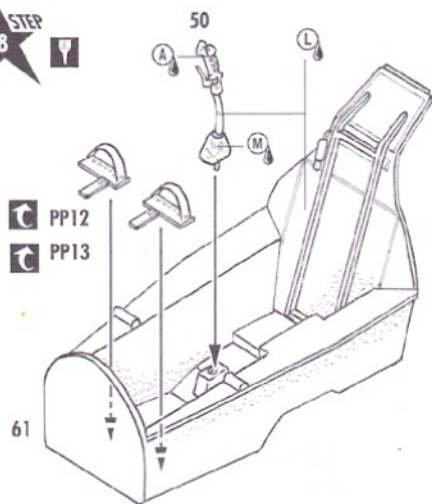

**STEP**  
**9**

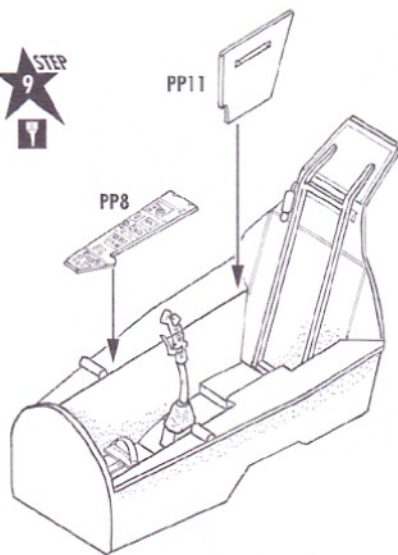

**STEP**  
**10**

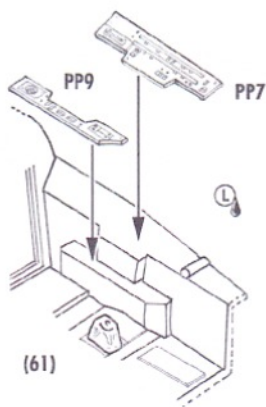

**STEP**  
**11**

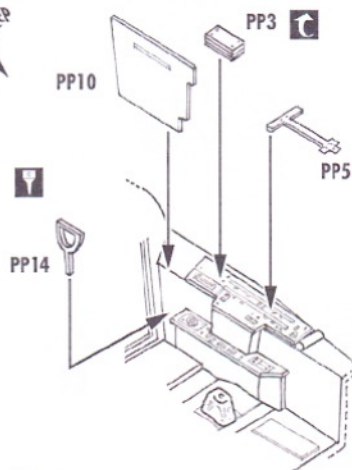

**STEP**  
**12**

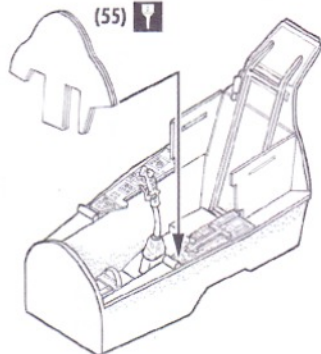

**STEP**  
**13**

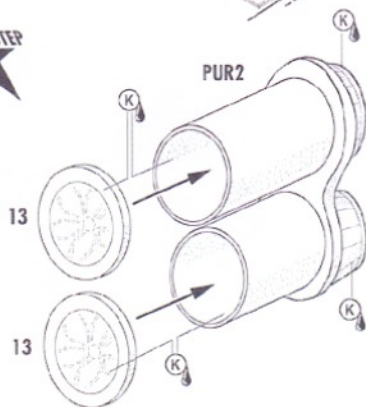



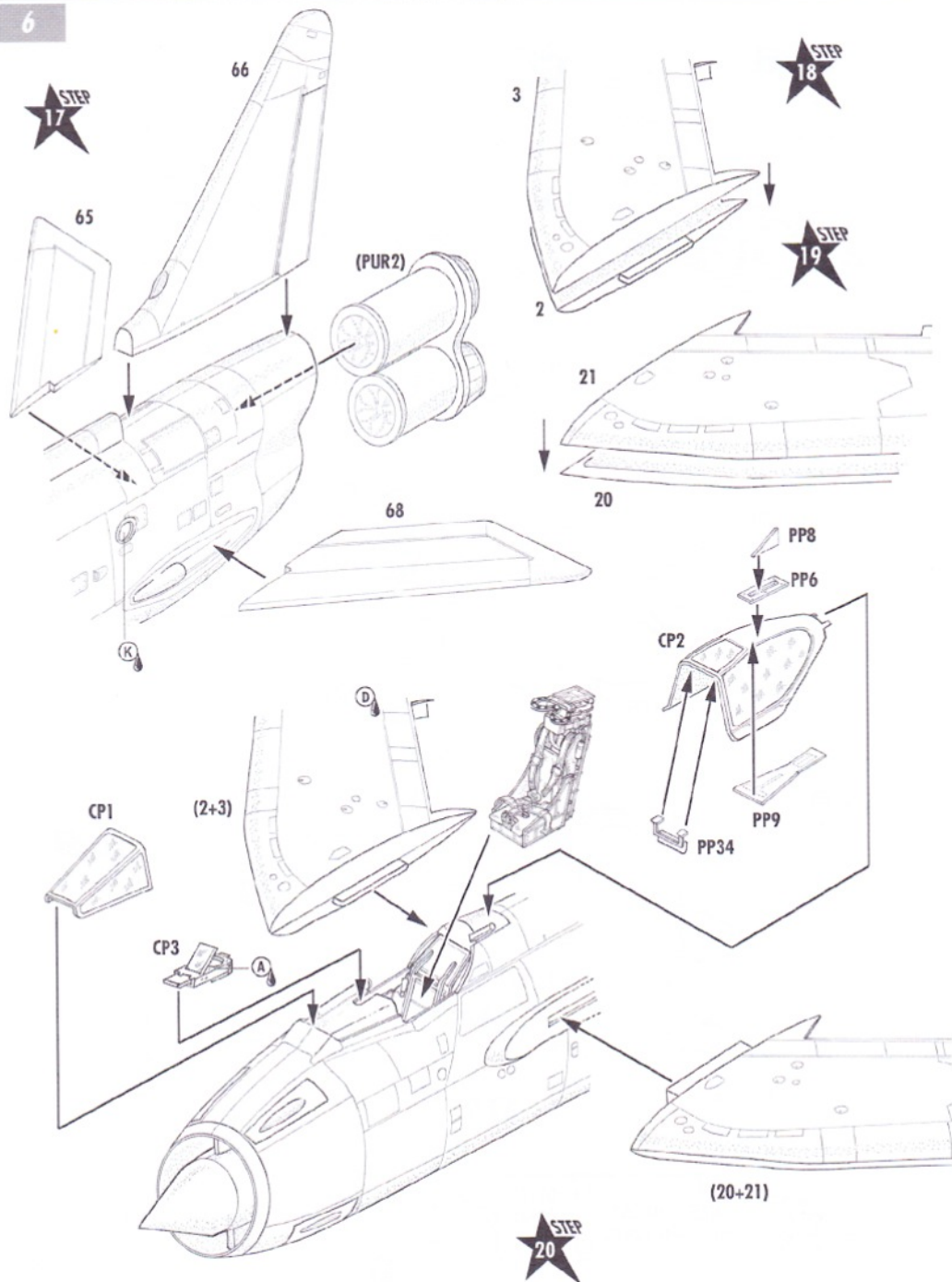

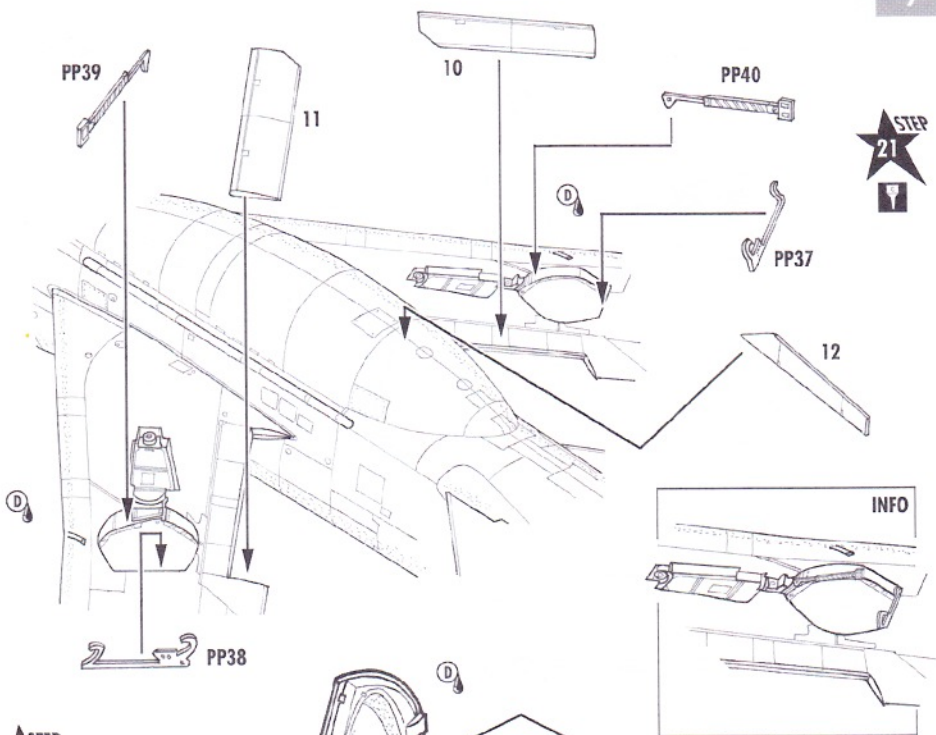

STEP 21

STEP 22

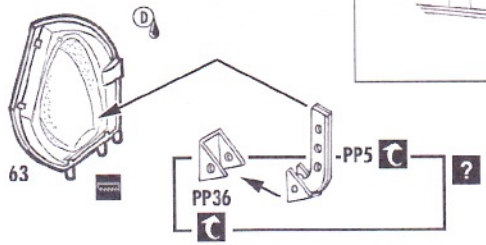
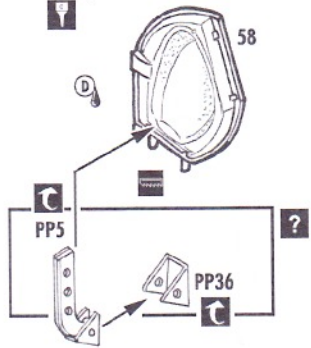

STEP 23

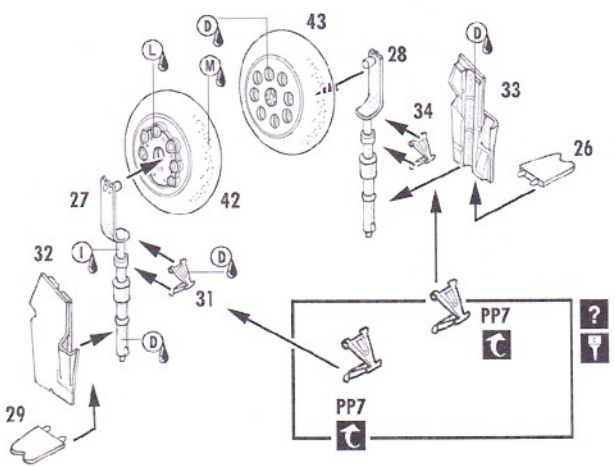

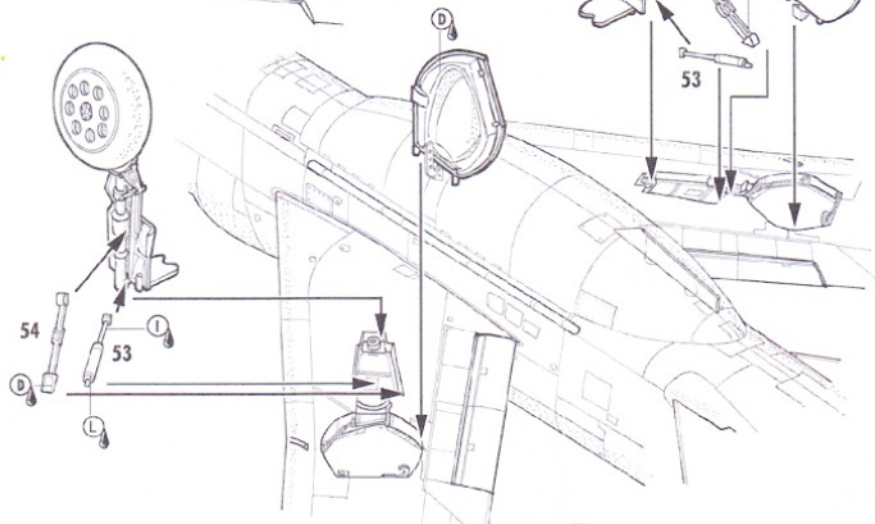
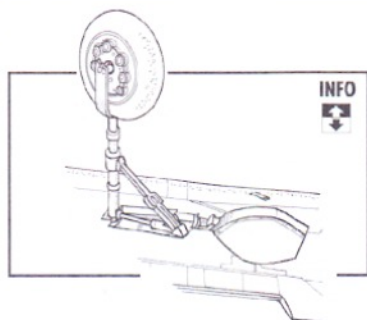
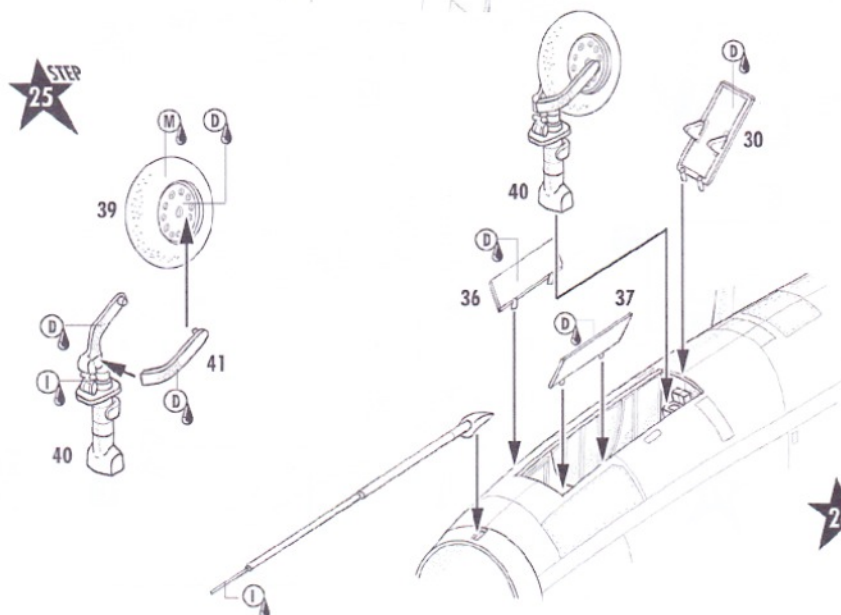
STEP  
24STEP  
25STEP  
26



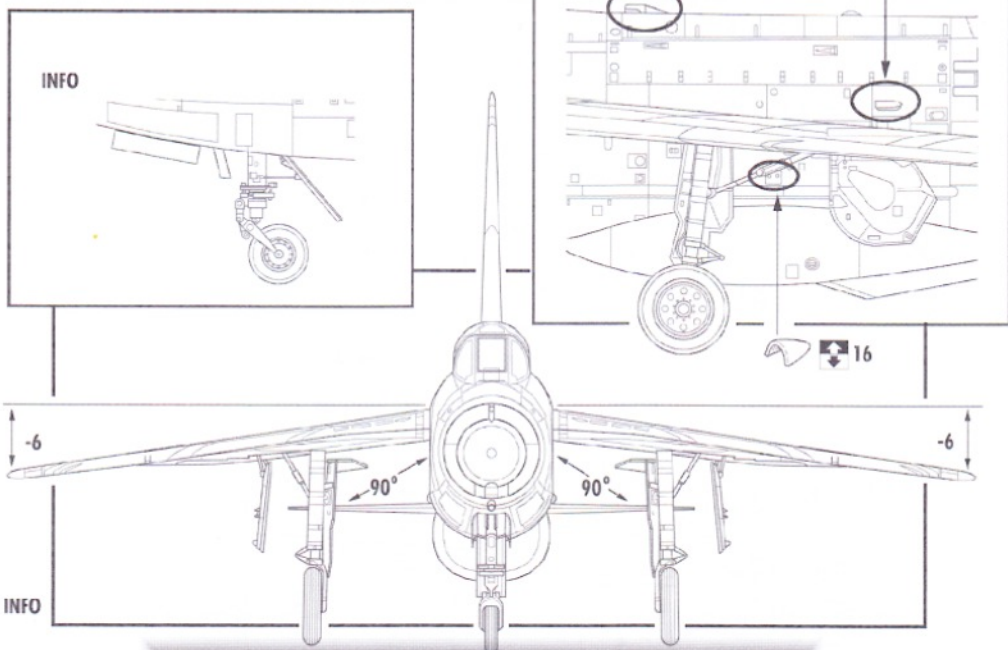

## STENCIL DATA F.3

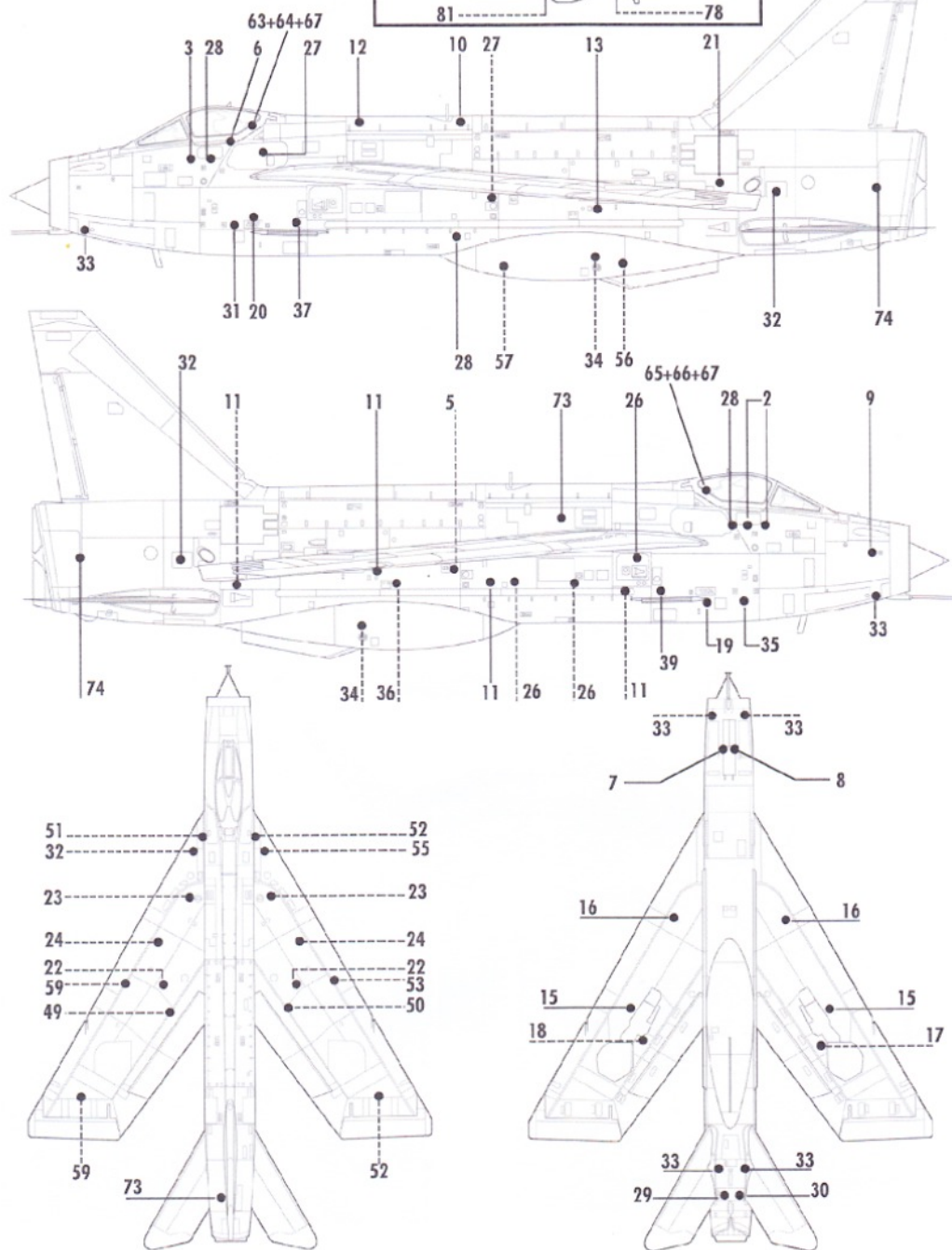
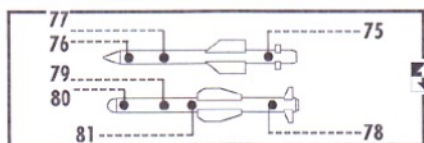

**A** *Lightning F1, XM137/D, 74 Sq. RAF, Coltishall 1963*

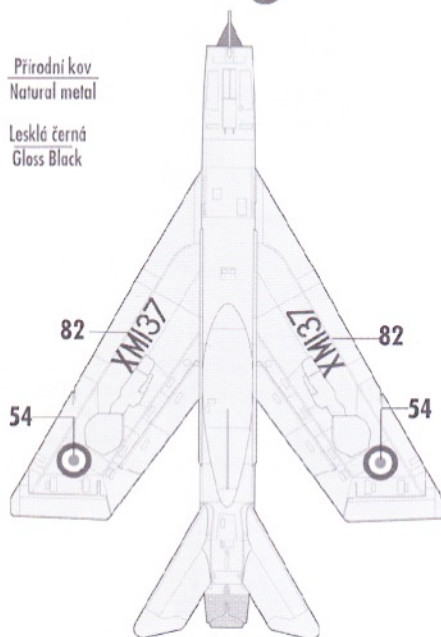
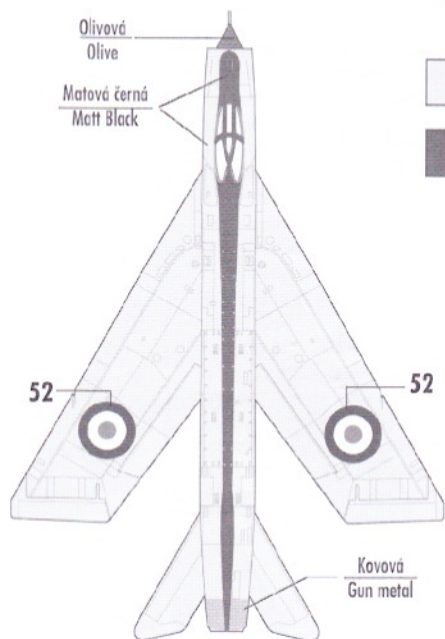
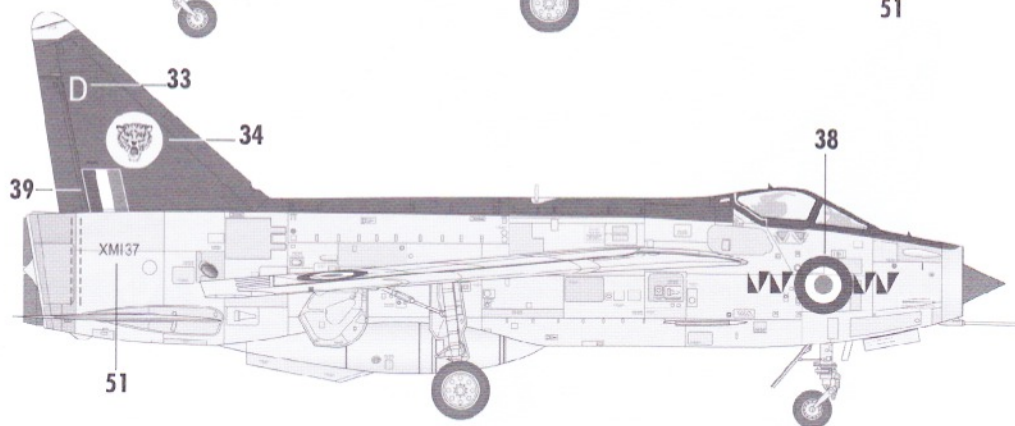
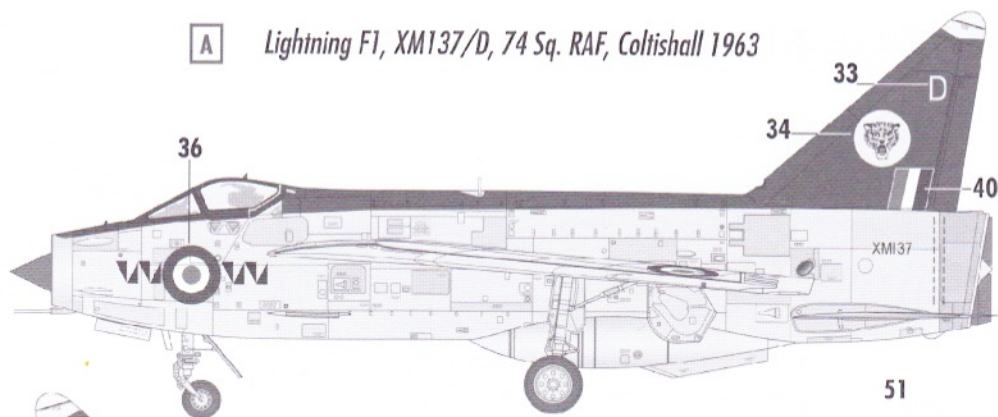

Olivová  
Olive

Matová černá  
Matt Black

— Přirodní kov  
Natural metal

— Lesklá černá  
Gloss Black

Kovová  
Gun metal

82 XM137 82

54 54

**B** Lightning F2, XN768/S, 92 Sq. RAF, Farnborough 1964

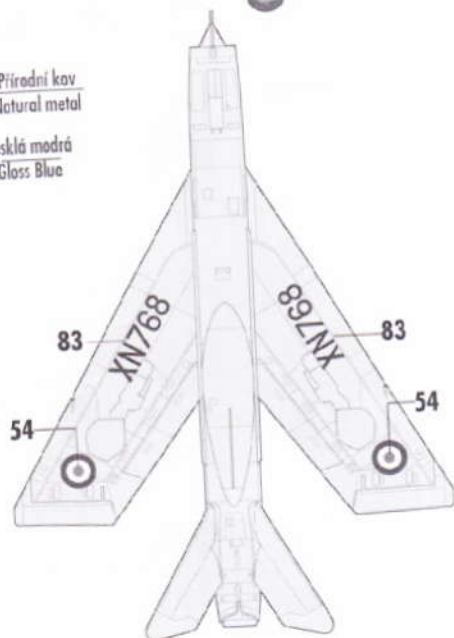
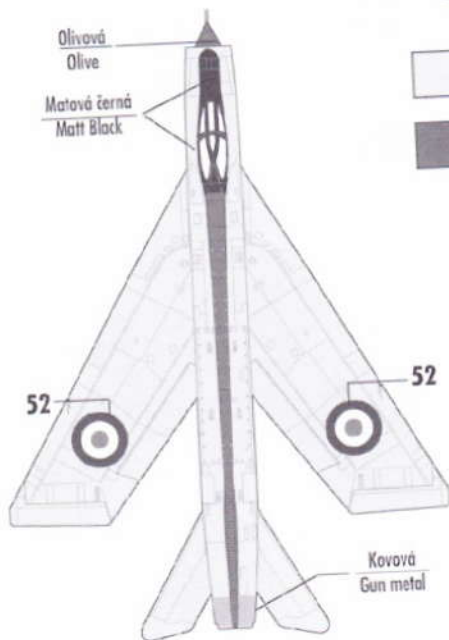
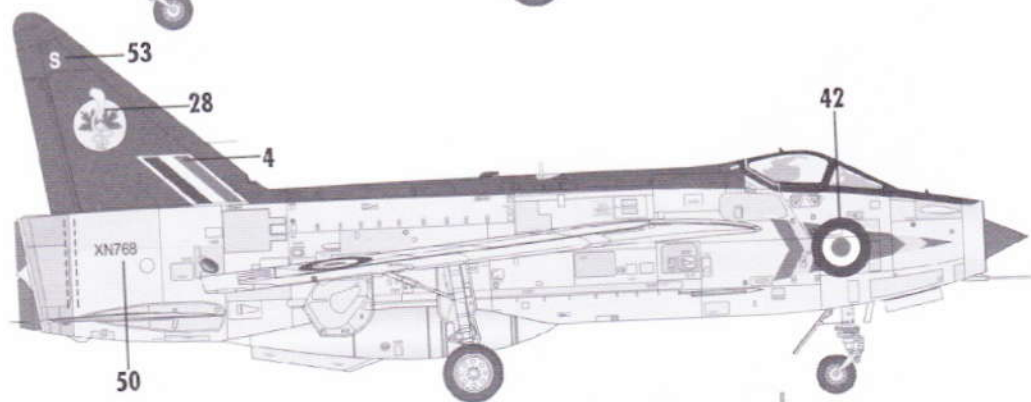
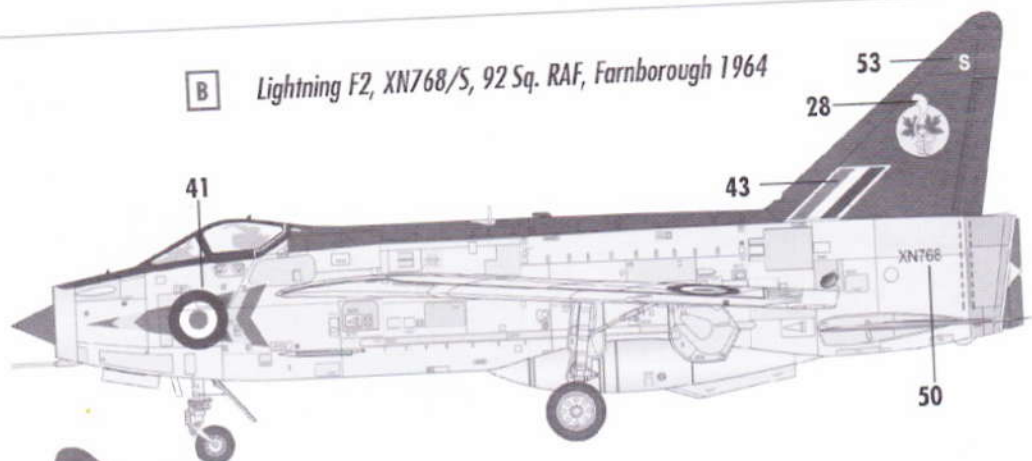

Olivová  
Olive

Matová černá  
Matt Black

Prírodní kov  
Natural metal

Lesklá modrá  
Gloss Blue

Kovová  
Gun metal

SW72081 EE Lightning F.1/F.2

1 2 3 4 5 6 7 8 9 10 11 12 13 14 15 16 17 18 19 20 21 22 23 24 25 26 27 28 29 30 31 32 33 34 35 36 37 38 39 40 41 42 43 44 45 46 47 48 49 50 51 52 53 54 55 56 57 58 59 60 61 62 63 64 65 66 67 68 69 70 71 72 73 74 75 76 77 78 79 80 81 82 83 84 85 86 87 88 89 90 91

**XMI37** **XN768** **XMI37**  
**XMI37** **XN768** **XMI37**  
**XN768** **XMI37** **XN768**  
**XMI37** **XN768**

**FIRESTREAK**  
 84 85 86

**RED TOP AAM**  
 88 88 89 89 89  
 90 90 91 91

© Printed by Eduard Made in Czech Republic

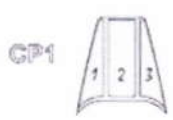
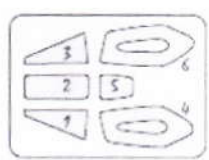

Liquid mask

SW72081 Lightning F.1/F.2

© EDUARD 2014 Made in Czech Republic