

History

HMS Badsworth was one of a number of Type 2 Hunt Class Destroyers ordered by the Royal Navy in 1939, to a revised design that was to correct deficiencies that had occurred in the Type 1 Hunts. The Type 2 design had an increase in beam of 2 feet 8 inches which gave the ships a better stability that allowed the original armament to be fitted. The Type 1 Hunts had one of the 4 inch gun turrets removed along with the AA Platform and some of the fittings to reduce top weight following a dockside incident.

HMS Badsworth was laid down 15th May 1940 at Cammell Laird Shipbuilders in Birkenhead and Launched 17th March 1941 Commissioned in August 1941 she joined the Londonderry Escort Group and operated in the North Western Approaches giving much close convoy defence to various convoys from the North Atlantic down to West Africa.

From April 1942 HMS Badsworth was nominated for Arctic convoy duties and found herself busy providing both defence against air attacks and from U boats, on one occasion spotting a periscope and carrying out a depth charge attack.

The end of May 1942 saw Badsworth detached to the Mediterranean and Malta convoys which saw even more action and led to Badsworth coming under heavy air attacks. Being in action against units of the Italian Navy saw HMS Badsworth as part of Force X defending the vital convoys from being sunk. Ironically on her return to Malta, Badsworth struck a mine in the harbour entrance which caused serious structural damage. The damage was so severe that she had to be temporarily repaired at Malta and then Gibraltar, before returning to the UK ship yards for an in depth repair which took until late November.

From January 1943 Badsworth was employed on more Atlantic convoy duties and found herself on a detachment to the Mediterranean again until April when she struck another mine off Bone, Algeria. This time her whole aft end was damaged and had to be beached, from where she was towed to Malta for temporary repairs before being towed back to the UK for more extensive in depth repairs. HMS Badsworth was paid off from the Royal Navy in August 1944 and transferred to the Royal Norwegian Navy. She was renamed as HNoMS Arendal and finally decommissioned from Royal Navy service in November 1944.

From September 1944 as HNoMS Arendal she was based with the 16th Destroyer flotilla at Harwich until after the end of WW2 when she was bought by Norway. She continued a distinguished service with the Royal Norwegian Navy until 1961. She was scrapped in 1965.

Specifications

Length: 279ft 10ins oa. Beam: 31ft 6ins Displacement: 1070 tons standard 1450 tons deep. Speed: 27 knots

Armament: 6 x 4 inch guns in three twin HA/LA mountings.
 110 Depth Charges fired from 2 x Mk 1 depth charge rails and 4 x Mk 11 depth charge throwers.
 1 x 4 barrelled 2 pounder Pom Pom. 2 x 20mm Oerlikons in 2 x Single Mountings

Resin and Metal Parts Identification

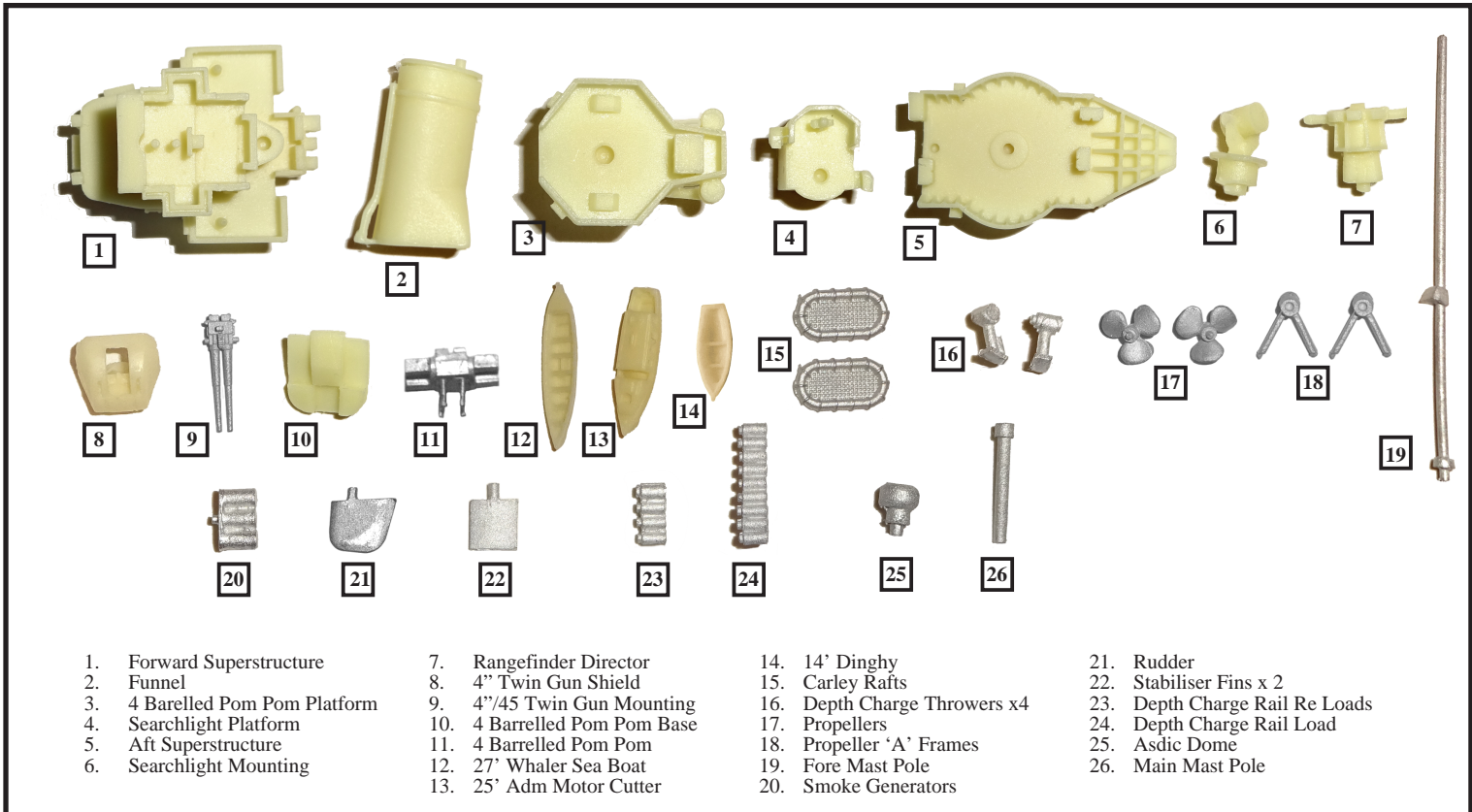

This kit contains a mixture of resin and white metal small parts, of which some of the resin parts have been attached to sprues for ease of casting.

Care must be taken when detaching the parts from the sprues, to remove the flash without causing damage.

When cleaning off the excess material using files or abrasive paper, it is recommended that a mask is worn as resin dust can be harmful to health if inhaled.

Photo Etched Parts Identification

ATLANTIC MODELS © 2021

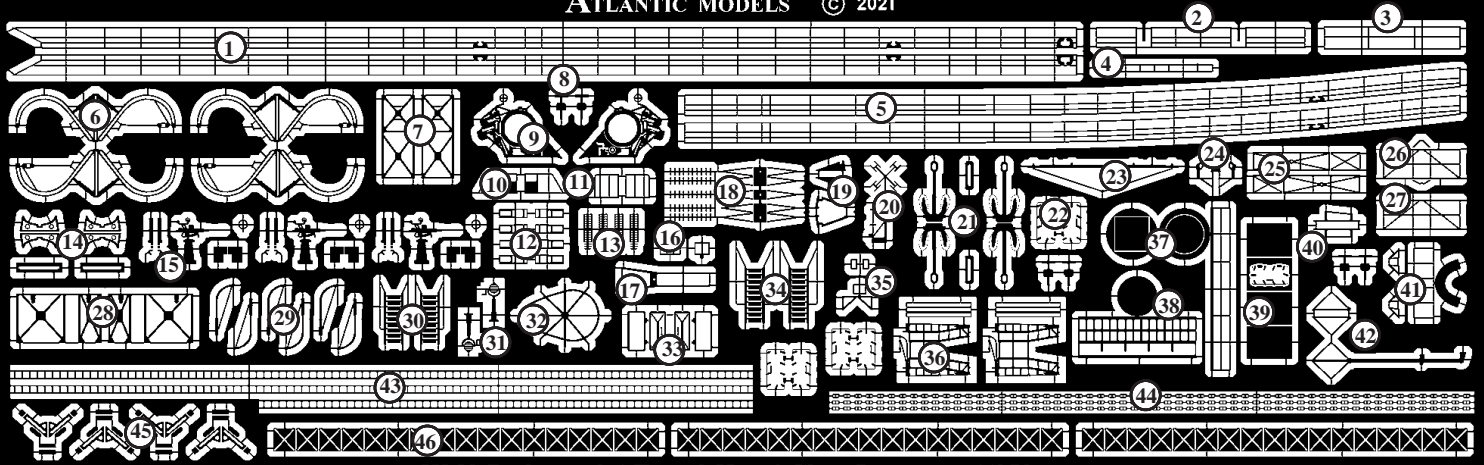

HMS Badsworth 'Type 2 Hunt' Class Destroyer 1/350

- | | | | |
|------------------------------------|-----------------------------------|-----------------------------------|----------------------------------|
| 1. Railings (Main Deck Aft) | 12. Pom Pom Ammunition Box Sides | 24. Funnel Sirens | 36. Depth Charge Rails |
| 2. Railings (Hull Step) | 13. Pom Pom Ammunition Belts | 25. 286 Radar Antenna Frames | 37. 276 Radar Lantern Platform |
| 3. Railings (Searchlight Platform) | 14. 14' Dinghy Cradles | 26. 286 Radar Rear Frame | 38. 276 Radar Lantern |
| 4. Bridge Windscreen | 15. 20mm Single Oerlikon | 27. 286 Radar Front Frame | 39. 276 Radar Lantern Office |
| 5. Railings (Fo'c'sle) | 16. DF Antenna | 28. Forward Gun Platform Supports | 40. Headache Antennas |
| 6. Boat Davits | 17. Bridge Front DF Antenna Frame | 29. Depth Charge Davits | 41. Funnel Siren Platform |
| 7. Aft Carley Raft Racks | 18. 285 Radar Yagi Antenna | 30. Inclined Ladders Bridge | 42. Early Mast Top MF/DF Antenna |
| 8. 4" Gun Layers Seats | 19. 285 Antenna Mountings | 31. Signal Lamps | 43. Vertical Ladder Stock |
| 9. Pom Pom Mounting Sides | 20. 291 Air Warning Radar | 32. Funnel Cap Grill | 44. Anchor Chain |
| 10. Pom Pom Rear Railings | 21. Anchors | 33. Open WT Door Inner Panels | 45. Depth Charge Throwers (Alt) |
| 11. Pom Pom Forward Railings | 22. WT Door Panels | 34. Inclined Ladders Gun Deck | 46. Splinter Matting |
| | 23. Fore Mast Yardarm | 35. Alternative Bridge Front DF | |

Major Parts Location Diagram

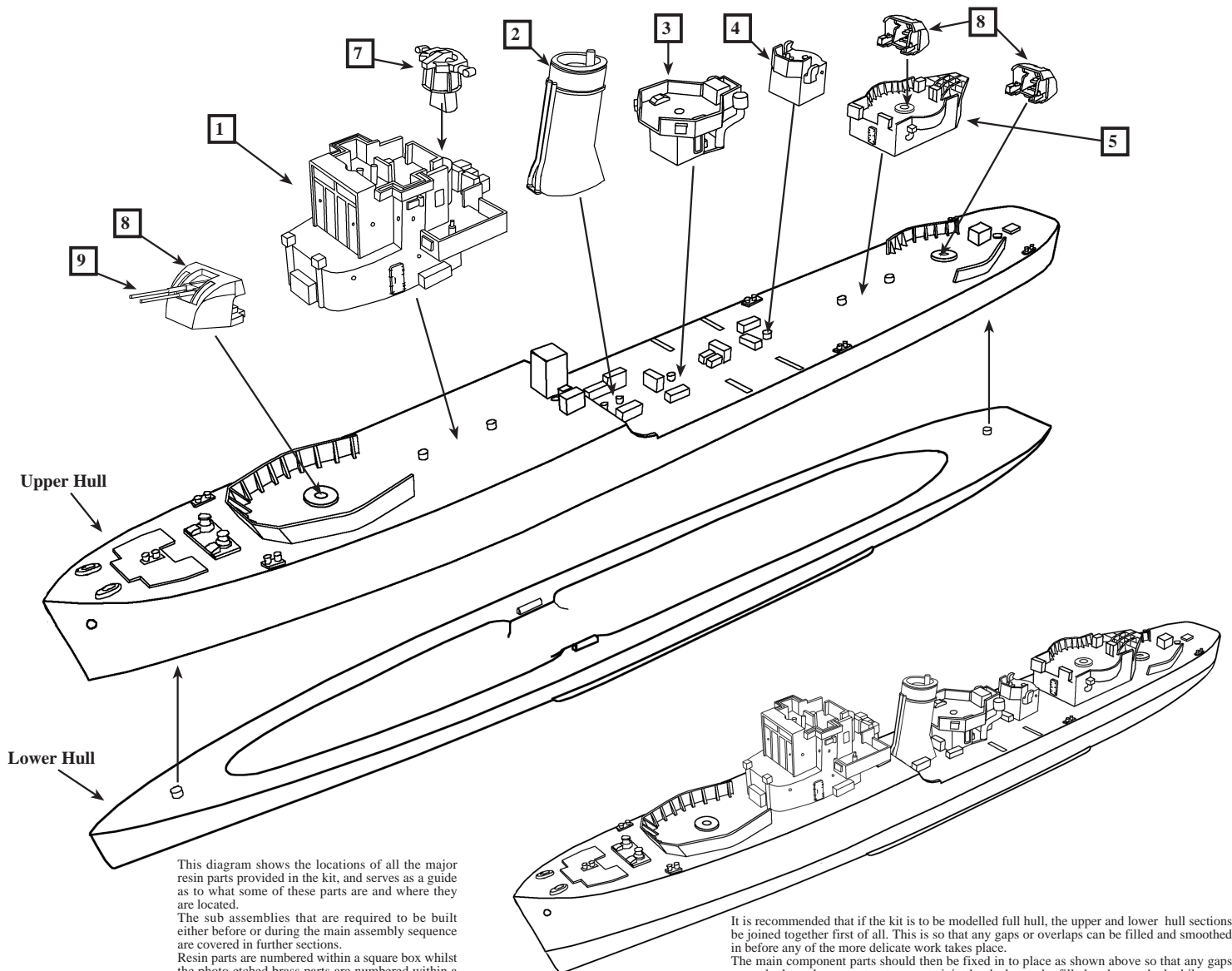

This diagram shows the locations of all the major resin parts provided in the kit, and serves as a guide as to what some of these parts are and where they are located.
 The sub assemblies that are required to be built either before or during the main assembly sequence are covered in further sections.
 Resin parts are numbered within a square box whilst the photo etched brass parts are numbered within a circle.

It is recommended that if the kit is to be modelled full hull, the upper and lower hull sections be joined together first of all. This is so that any gaps or overlaps can be filled and smoothed in before any of the more delicate work takes place.
 The main component parts should then be fixed in to place as shown above so that any gaps around where the superstructure parts join the deck, can be filled and smoothed whilst easy access can be achieved. Once any work of this nature has been completed, the build can then proceed to the next stages of adding the finer parts.

Twin 4" HA/LA Gun Mounting

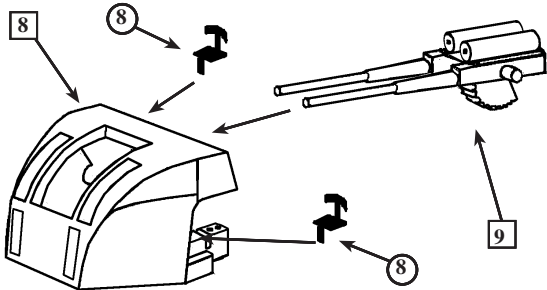

Fit the gun barrels metal parts 9, into the gun shield 8, so that the lugs on the sides of the gun fit into the recesses on the mounting inside the shield.
Fold the gun layers seats, etched parts 8 to shape and fit to the forward ends of the fusing boxes.

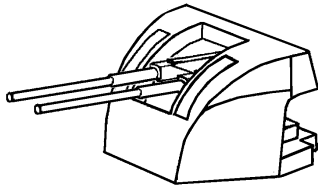

4 Barrelled Pom Pom Assembly

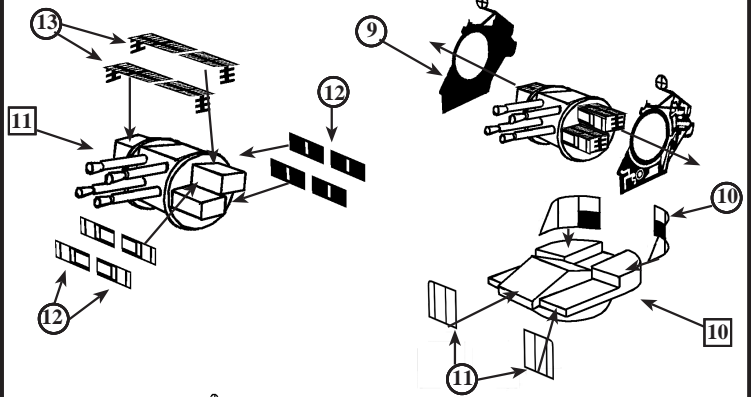

Clean any casting burrs off the metal parts 10 and 11. Fit the photo etched parts 9, mechanisms over the ammo boxes, so that the rings take up around the circular part of the barrel cluster.
Secure the photo etched parts down either side of the angled centre of part 10. These will hold the barrel cluster in place, enabling it to elevate, if the glue has not made contact with the circular area.
Fit Rear Handrails, etched parts 10, to the rear of the Pom Pom platform and the Front Rails, etched parts 11 as shown.
Fit completed assembly to the AA Platform, resin part 3, located aft of the funnel.
Further finer detail may be achieved by removing the soft white metal gun barrels and replacing them with turned brass gun barrels if desired.

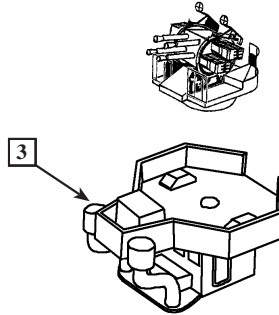

20mm Oerlikon

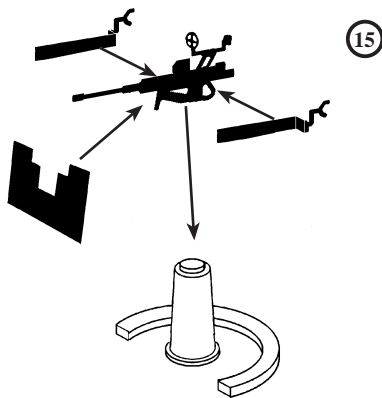

Assemble the 20mm Oerlikon mounting as shown above. The etched metal mounting pintles should be removed from the lower part of gun mounting before any assembly begins.
Locate these into positions on the gun platforms on either side of the forward superstructure as shown in the section below.

285 Radar Yagi Antenna

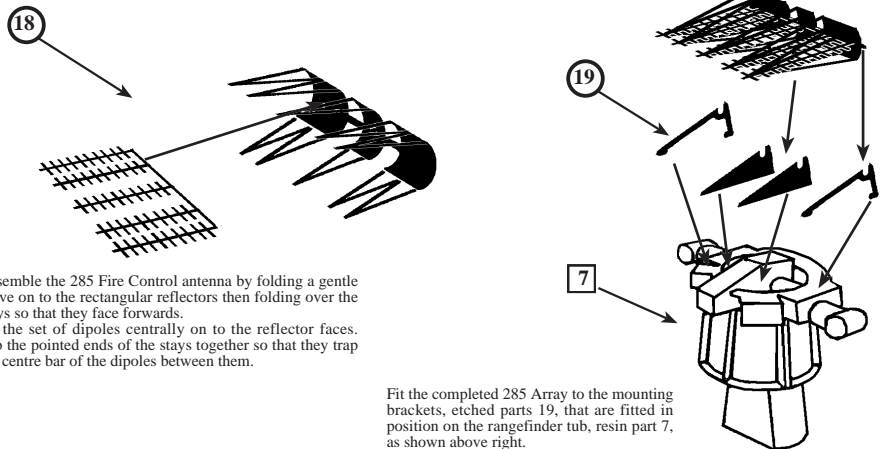

Assemble the 285 Fire Control antenna by folding a gentle curve on to the rectangular reflector then folding over the stays so that they face forwards.
Fit the set of dipoles centrally on to the reflector faces.
Nip the pointed ends of the stays together so that they trap the centre bar of the dipoles between them.

Fit the completed 285 Array to the mounting brackets, etched parts 19, that are fitted in position on the rangefinder tub, resin part 7, as shown above right.

Forward Superstructure Fittings

Assemble the DF Antenna, etched part 16 and fit the half loops to each side of the central vertical pole on the antenna. This should appear as a cross when viewed from above

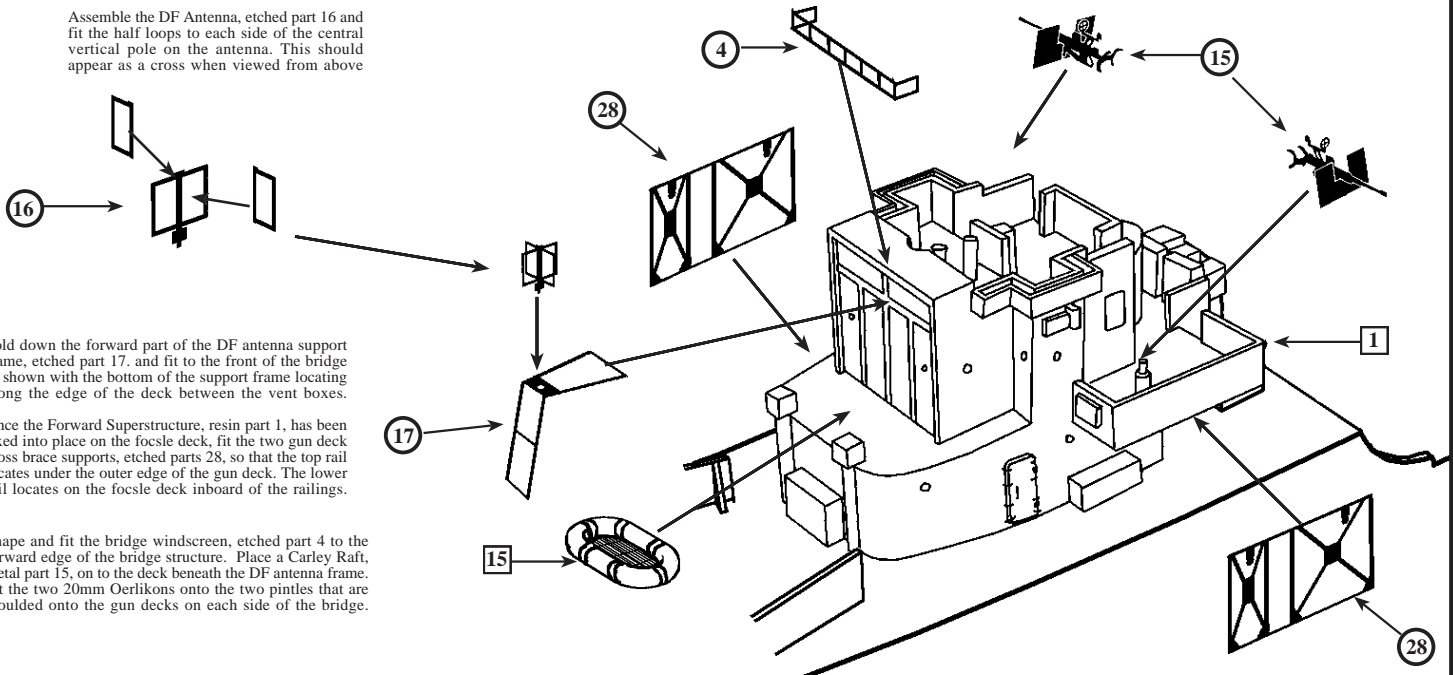

Fold down the forward part of the DF antenna support frame, etched part 17, and fit to the front of the bridge as shown with the bottom of the support frame locating along the edge of the deck between the vent boxes.

Once the Forward Superstructure, resin part 1, has been fixed into place on the focsle deck, fit the two gun deck cross brace supports, etched parts 28, so that the top rail locates under the outer edge of the gun deck. The lower rail locates on the focsle deck inboard of the railings.

Shape and fit the bridge windscreen, etched part 4 to the forward edge of the bridge structure. Place a Carley Raft, metal part 15, on to the deck beneath the DF antenna frame. Fit the two 20mm Oerlikons onto the two pintles that are moulded onto the gun decks on each side of the bridge.

291 Radar Antenna and Fore Mast Assembly

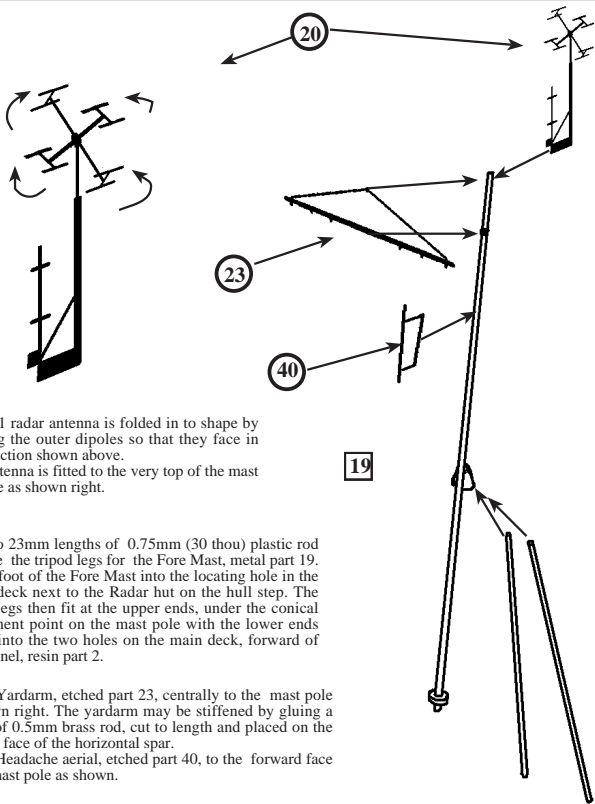

The 291 radar antenna is folded in to shape by bending the outer dipoles so that they face in the direction shown above. This antenna is fitted to the very top of the mast top pole as shown right.

Cut two 23mm lengths of 0.75mm (30 thou) plastic rod to make the tripod legs for the Fore Mast, metal part 19. Fit the foot of the Fore Mast into the locating hole in the focsle deck next to the Radar hut on the hull step. The tripod legs then fit at the upper ends, under the conical attachment point on the mast pole with the lower ends fitting into the two holes on the main deck, forward of the Funnel, resin part 2.

Fit the Yardarm, etched part 23, centrally to the mast pole as shown right. The yardarm may be stiffened by gluing a length of 0.5mm brass rod, cut to length and placed on the forward face of the horizontal spar. Fit the Headache aerial, etched part 40, to the forward face of the mast pole as shown.

HF/DF Antenna and 286 Radar Antenna

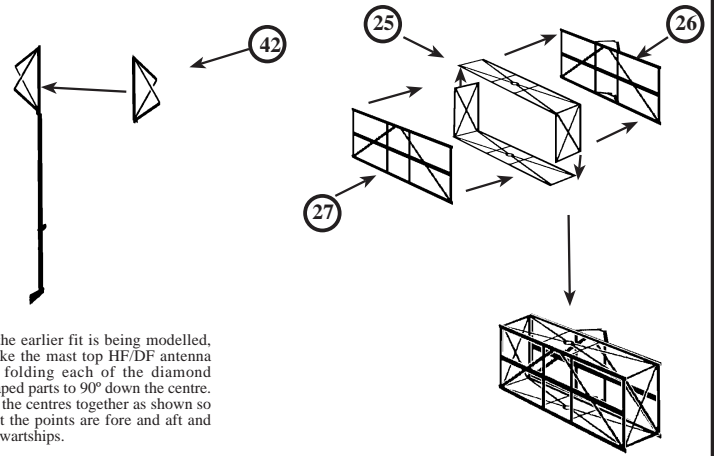

If the earlier fit is being modelled, make the mast top HF/DF antenna by folding each of the diamond shaped parts to 90° down the centre. Fit the centres together as shown so that the points are fore and aft and athwartships.

Fold the outer parts of the centre frame of the 286 antenna to 90° as shown above then fit to the rear frame first. Fold the mounting brackets on the rear frame rearwards. Fit the front frame to the edges of the centre frames so that the antenna looks like the lower diagram.

Funnel Fittings

Fold down the short legs around the outside of the funnel cap grill, etched part 32, as shown right so that they locate onto the rim of the funnel cap. Fit the two siren horns, etched parts 24, to a position just above the line of the siren platform location.

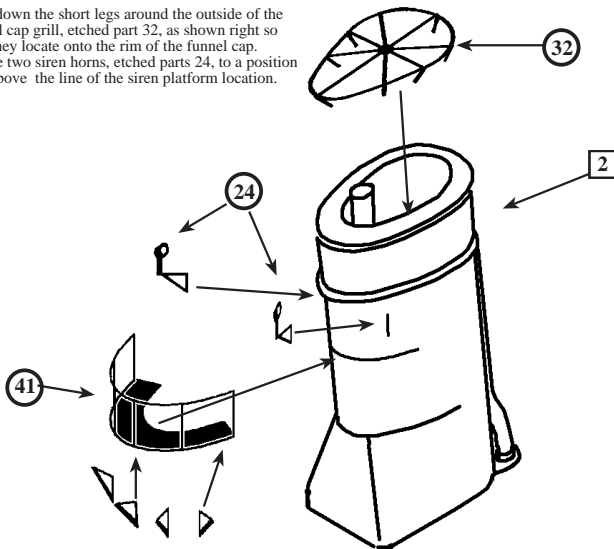

Fold up the railing on the funnel Siren Platform, etched part 41, to 90° and shape to fit around the outer edge of the platform. Fit the triangular support brackets to the underside of the platform. One at each end and the other two at equal distances in between. Fit the siren platform to the rear of the funnel as shown above. A length of vertical ladder can be fitted between the centre of the siren platform and the AA platform below.

Depth Charge Thrower Assembly

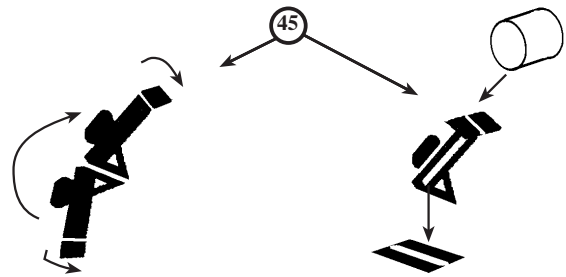

To assemble etched parts 45, fold the main body of the thrower gun in half, so that it is double thickness. Fold top plates outwards to 90° so that the depth charge can be located easily. Fit the base of the gun body to the footplate as shown above right. Make depth charges by cutting short lengths of 1.5mm (60thou) diameter plastic rod and fitting to the tops of the throwers. These may be used instead of the metal parts 16 if desired.

Depth Charge Rails

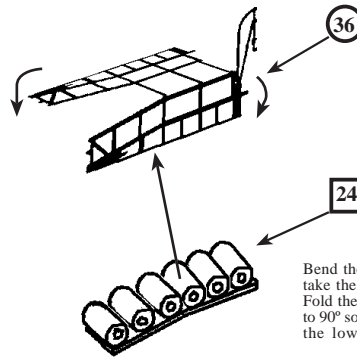

Bend the first three depth charges down to a slight angle to take the shape of the lower rail on the etched rail frame 36. Fold the side of the depth charge rail frames, etched parts 36, to 90° so that they are parallel. Fit the depth charges in between the lower rails of the frame. Make two of these.

276 Radar Lantern (Late)

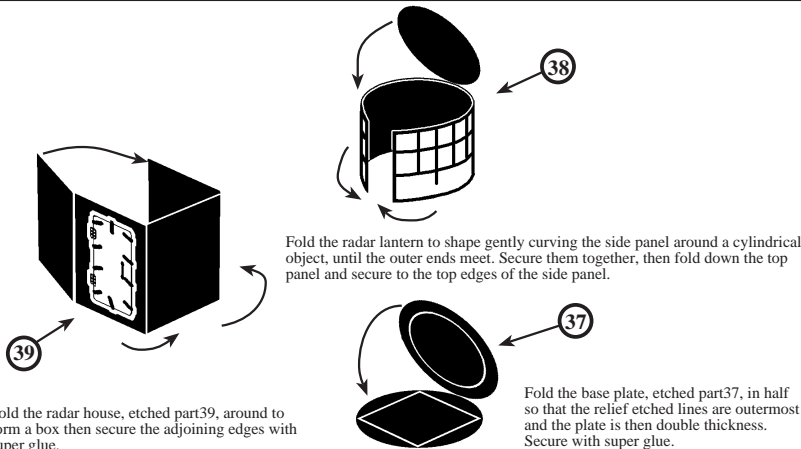

Fold the radar lantern to shape gently curving the side panel around a cylindrical object, until the outer ends meet. Secure them together, then fold down the top panel and secure to the top edges of the side panel.

Fold the base plate, etched part 37, in half so that the relief etched lines are outermost and the plate is then double thickness. Secure with super glue.

Fold the radar house, etched part 39, around to form a box then secure the adjoining edges with super glue.

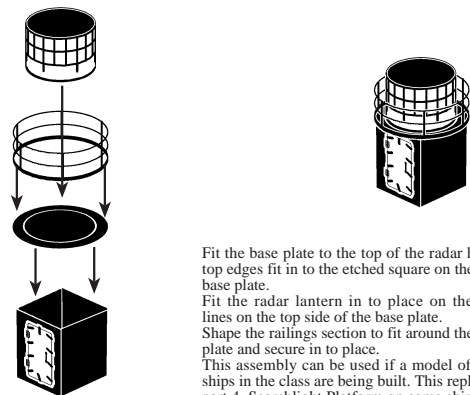

Fit the base plate to the top of the radar house, so that the top edges fit in to the etched square on the underside of the base plate. Fit the radar lantern in to place on the circular etched lines on the top side of the base plate. Shape the railings section to fit around the edge of the base plate and secure in to place. This assembly can be used if a model of any of the other ships in the class are being built. This replaces the resin part 4, Searchlight Platform on some ships and is fitted on top of it on some others. Further research will be required.

Boats Location and Depth Charge Throwers

Fold the davits, etched parts 6 in half so that the relief etched detail is outermost. Fix the halves together with adhesive.

Fit davits, etched parts 6, in to position on the main deck and secure in to place. Test fit the boats and note the position of where the falls will pass. Drill small holes through the boats at these positions and then pass the falls through the holes until the boats are snugly in position against the davits. Secure in to place.

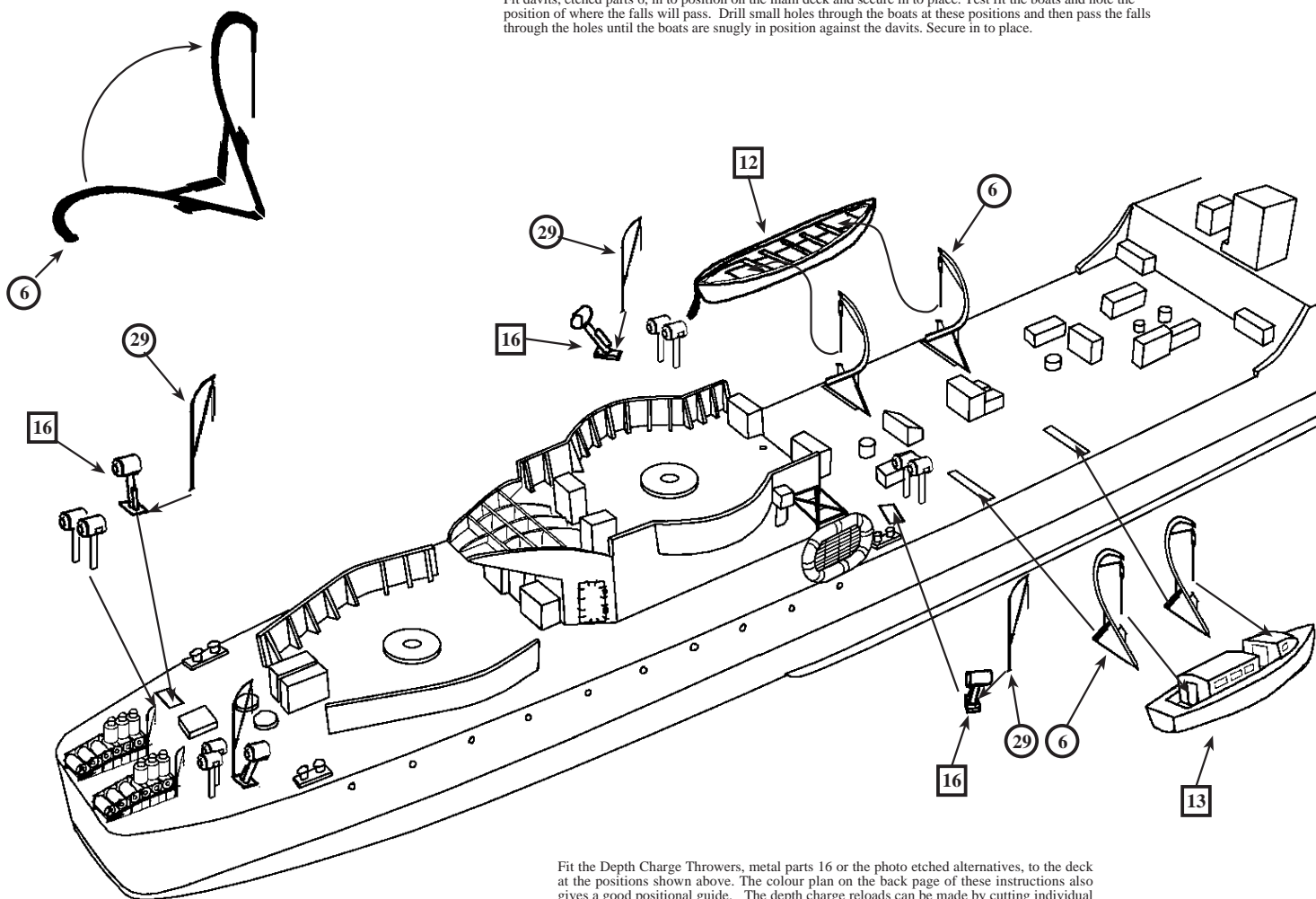

Fit the Depth Charge Throwers, metal parts 16 or the photo etched alternatives, to the deck at the positions shown above. The colour plan on the back page of these instructions also gives a good positional guide. The depth charge reloads can be made by cutting individual depth charges from the metal strips 23 or 24 and attaching to a short length of 0.5mm plastic rod, before fitting into a hole drilled into the deck. This is one method of reload stowage. Another way of showing the Depth Charge reloads is to place the strips of depth charges, metal parts 23 directly on to the deck adjacent to the throwers, vertically as if they were in a frame or horizontally as if they are laid in cradles. Research as to how the depth charges were stowed on various ships is recommended.

Aft Superstructure Fittings and Searchlight Platform

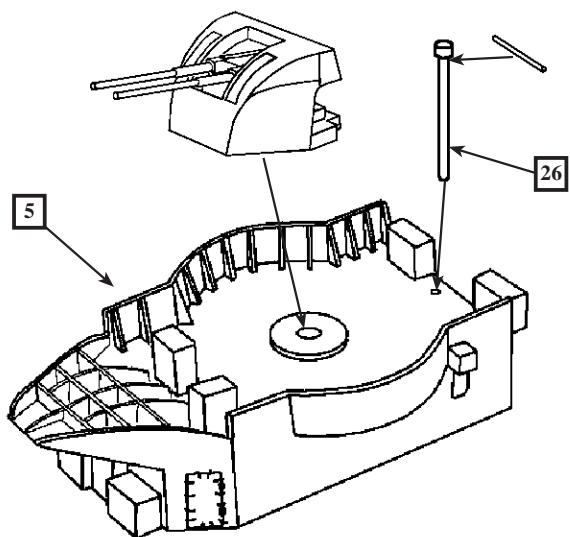

Once the aft superstructure, resin part 5 has been securely fitted to the main deck aft, fit the 4" gun turret assembly as shown in X position and another further aft in Y position. Fit the main mast pole, metal part 26, to the forward edge of the aft superstructure deck as shown above left. Cut a 15mm length of 0.5mm diameter brass or plastic rod to make a stub yardarm and fit in place centrally under the top cap.

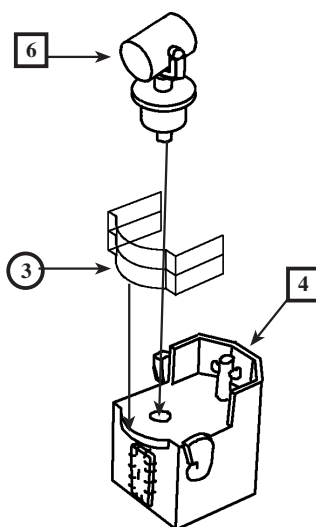

Shape the railing section, etched part 3, to fit around the aft edge of the Searchlight Platform, resin part 4, as shown above. Fit the Searchlight, resin part 6, to the locating hole in the deck of the platform. Note: This platform also forms the Auxiliary Conning position and has compass binnacle at the forward end within the shielded area. This area may also be added by fitting splinter matting, etched part 46, around the outside of the bulwarks.

Anchor Assembly

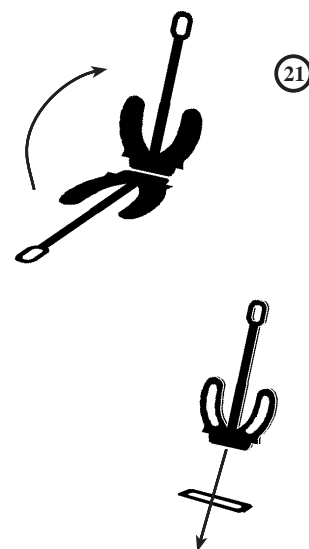

Assemble photo etched anchors 21 as shown above. Fit anchors into the hawse pipes each side of the bow, after first drilling out the holes with a 1.3mm drill bit.

Railings and Carley Raft Rack Location

Shape and fit the railing sections, etched parts 5, to the edges of the focsle deck as shown below. Fit the railing section, etched part 2, to the edge of the hull step with the longer outer railing section to starboard

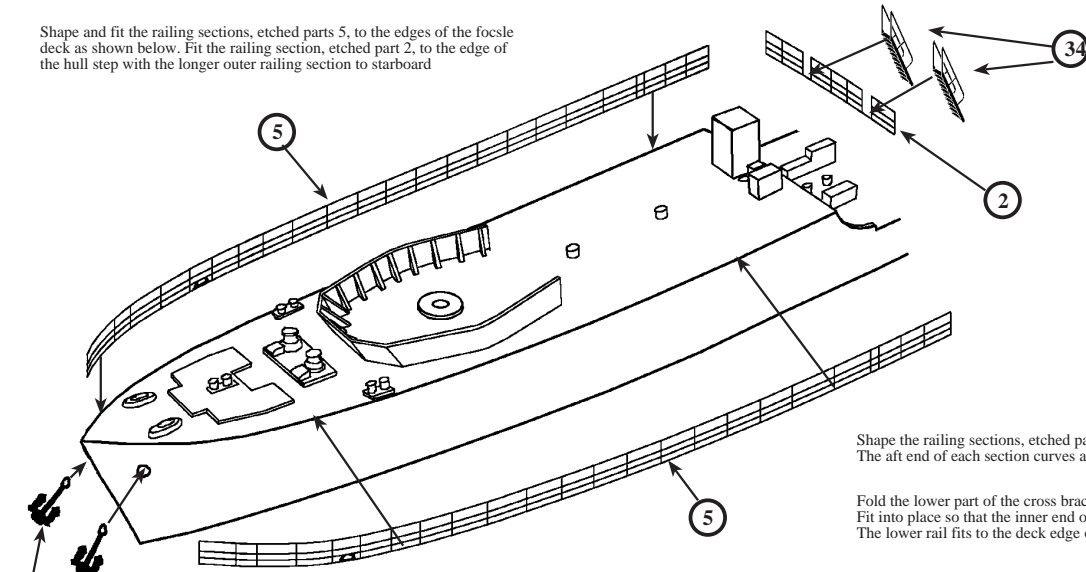

Shape the inclined ladders, etched parts 34, by folding the handrails up to 90° so that they are parallel. Turn each step individually so that they are horizontal. Fit in place to the hull step as shown left.

Shape the railing sections, etched parts 1, to fit the edges of the main deck aft of the hull step. The aft end of each section curves around the stern and stop at the Depth Charge rails.

Fold the lower part of the cross braced Carley Raft racks, etched parts 7, down to approx 80°. Fit into place so that the inner end of each rack fits against the side of the aft superstructure. The lower rail fits to the deck edge outboard of the railings.

Fit the anchors, etched parts 21, into place on the bow by first drilling out the HawsePipe holes with a 1mm drill bit. Allow enough depth so that the shank of the anchor can mostly fit inside. Trim as necessary

fit the Carley Raft, metal parts 15, to the outsides of the racks as on some ships, or they can be fitted on top of the racks as on others. The choice depends on research into the particular ship be modelled. Fit the small Smoke Generator canisters, metal parts 5, to the tops of the Depth Charge racks.

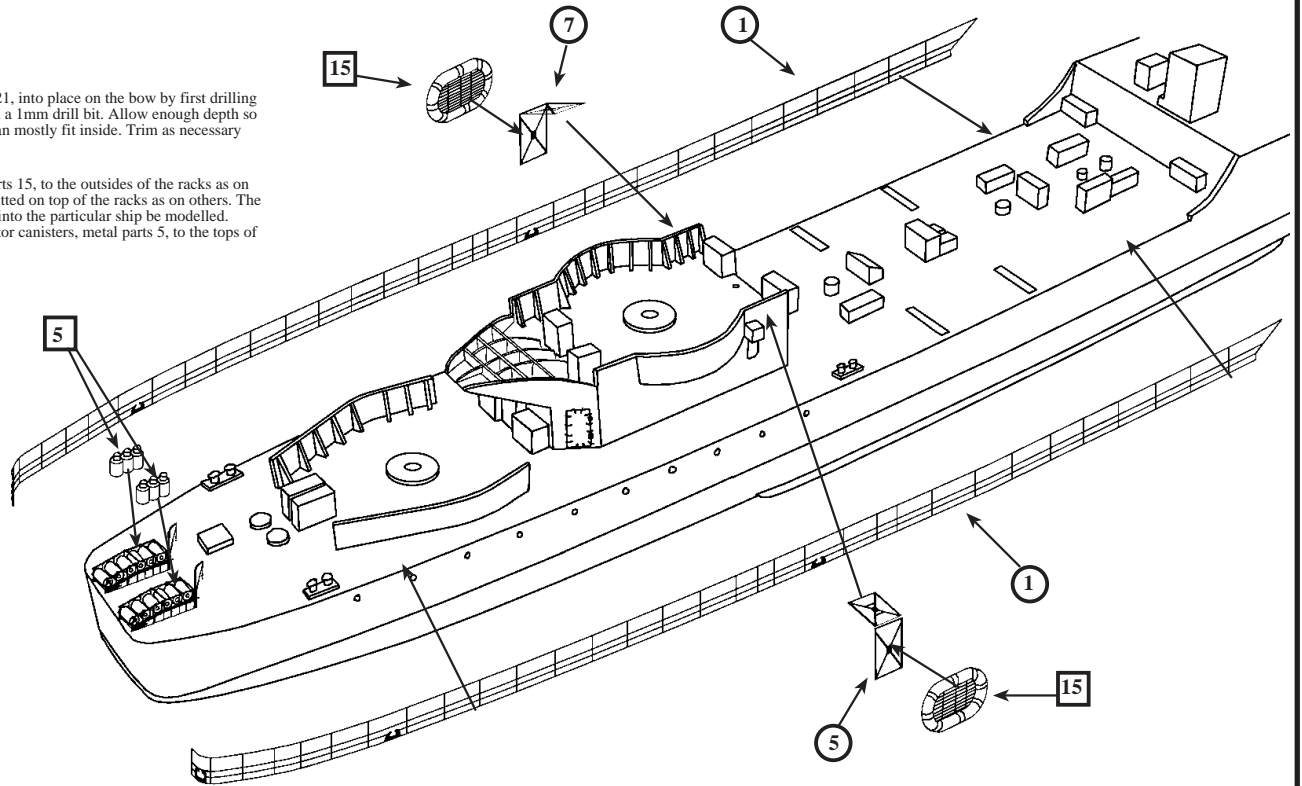

Propeller and Rudder Fittings

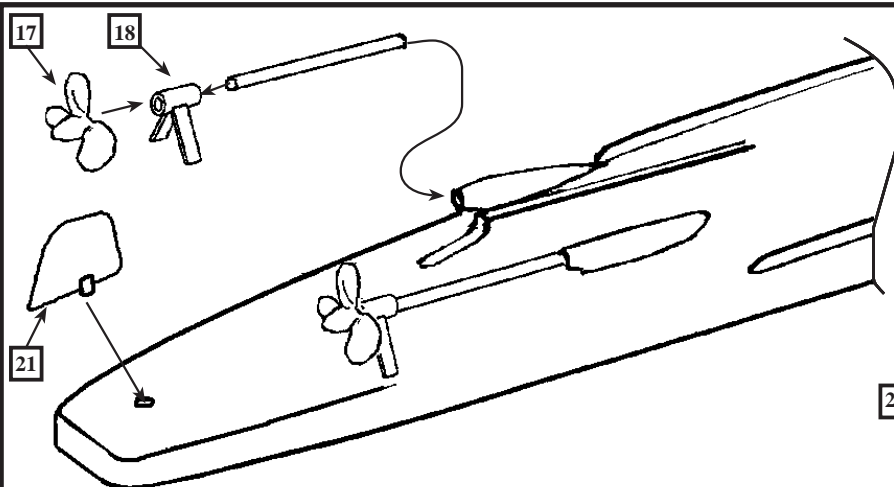

Fit the propellers to the outer side of the bearing A Frames as shown left. The legs of the A frames can be trimmed so that they fit in alignment with the stern gland openings on each side, with the shafts cut to length and fitted in to place.

Fit the stabiliser fins, metal parts 22 to the locating holes on each side of the Lower Hull forward of the bilge keels.

The Asdic Dome, metal part 25, can be fitted as an option as this item was retractable into the underside of the hull.

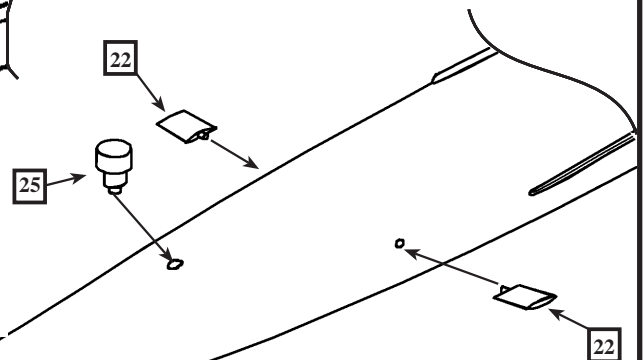

If the ship is to be modelled as a full hulled exhibit, assemble the running gear components as shown above, using two 20mm lengths of 0.75mm (30thou) diameter brass or plastic rod.

Colour Chart and Painting Guide



Western Approaches Green
NARN 39



MS 1
Colourcoats NARN 28



White
Colourcoats C03



Anti Fouling Red
Colourcoats RN19



Deck Steel Grey G10
Colourcoats RN 23

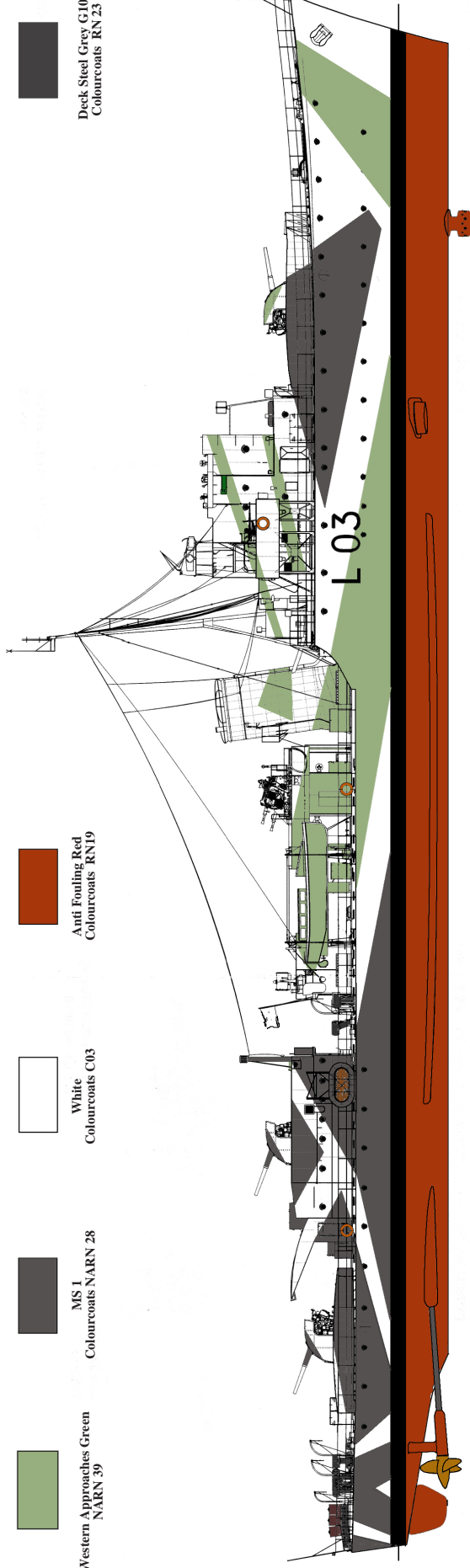

HMS Badsworth 1942

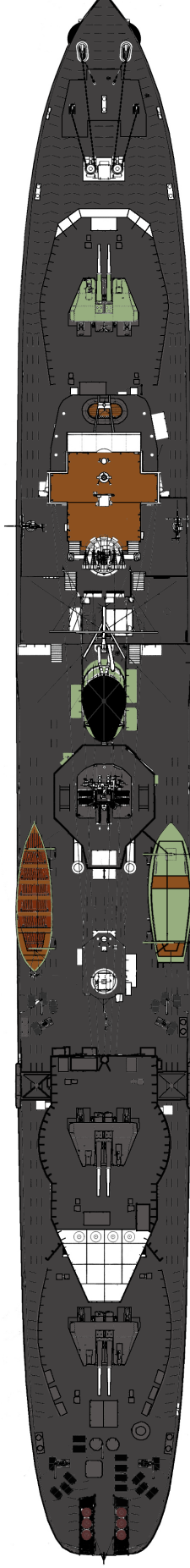

The colour guide has given the references for Colourcoats Enamel Paints that are available from Sovereign Hobbies.com but it is clear that these are readily available or accessible in some areas, nor are they available in Acrylic. Therefore an alternative set of Humbrol reference numbers has been listed below with the nearest alternative colour match.

- MS 1 = Humbrol 27
- Western Approaches Green = Humbrol 120
- White = Humbrol 34
- Anti Fouling Red = Humbrol 100
- Deck Steel Grey G10 = Humbrol 67

Other Colours:

- Black
- Bronze
- Natural Wood

- Funnel Cap, Gun Barrels on Pom Poms, Waterline Boot Topping
- Propellers and Ammunition in trays on Pom Poms.
- Inner Decks and Thwarts on Ships Boats, Bridge Platform, Carley Raft Gratings