



COLONIAL ONE

1:350 SCALE

ALL-PLASTIC

ASSEMBLY KIT

SKILL LEVEL 3

AGES 15 & UP

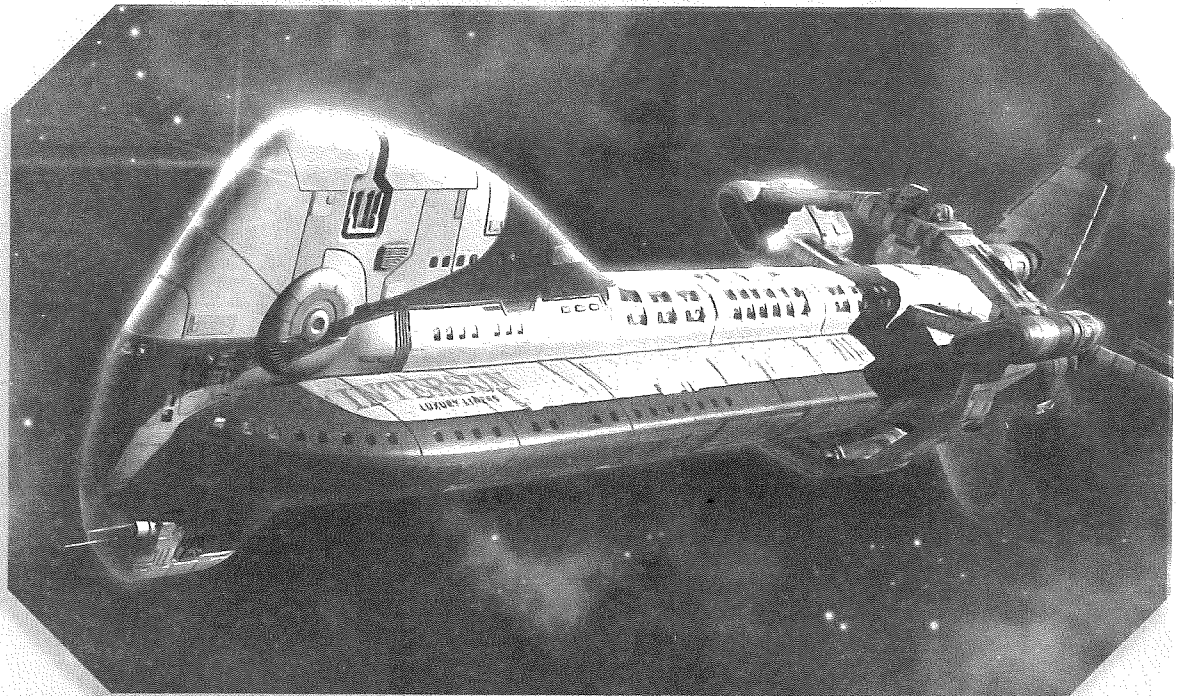

ASSEMBLY INSTRUCTIONS

IMPORTANT - READ THIS FIRST

Before assembling your model, **study pictures carefully**. These instructions include detailed drawings describing each step of assembly. You can also refer to photos on the packaging. You will find the following tips helpful:

- This model kit is molded of styrene plastic – **use only styrene-compatible glues or cements**.
- Apply cement to the **inside surfaces** of model only, avoid getting cement on outer surfaces of model.
- **Use cement sparingly** and **avoid getting cement on hands**, so as not to mar or smear plastic surfaces.
- **Do not hurry**, work carefully and patiently.
- Before cementing, **it is advisable to assemble parts dry** (without cement) so that you may familiarize yourself with parts and fit, **noting the points where cement is to be applied**.
- For best results assemble model **in the order indicated**.

PAINTING YOUR KIT

- **Use paint that is made for use on plastic**. If you are unsure, test paint on scrap pieces of sprue before applying it to kit parts.

- This kit is designed to be built in **sub-assemblies**. We suggest that **it is best to paint each sub-assembly separately** before the final assembly of the model.
- In certain cases **it may be a good idea to paint some parts during assembly**. For example, it will be easiest to paint the landing gear before gluing them in place.

APPLYING DECALS

Decals have been provided to ensure the utmost detail and authenticity. Apply decals only after paint is **completely dry**.

- **Dip the decal in water for 10 seconds**. For best results, mix one drop of common dish washing detergent per cup of **lukewarm** water.
- Place wet decal face up on a paper towel and **wait 30-60 seconds** until the decal is **movable on paper backing**.
- **Wet the area of the model** where decal will be applied.
- Hold the decal face up, in position on model and **slide backing away** from under it.
- Once positioned correctly, **gently smooth out decal** and **absorb excess water** with a paper towel, cotton swab or clean, soft paintbrush.
- **Let decals dry completely** before applying any sort of dull coat or gloss coat to decal area, if desired.



NOTE

This kit includes optional parts for **Extended Landing Gear** as well as options for **Extended** or **Retracted Blast Guards**. Review instructions carefully and determine which options you prefer before cementing parts in place.

1

THRUSTERS

- A** Cement two sets of the **Thrustor Halves** (#40 & #41) together.
- B** Cement assembled **Thrustors** to the **Rear Bulkhead** (#9).

1A

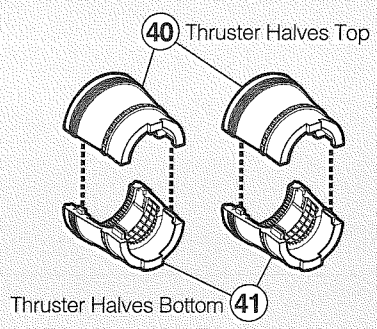

1B

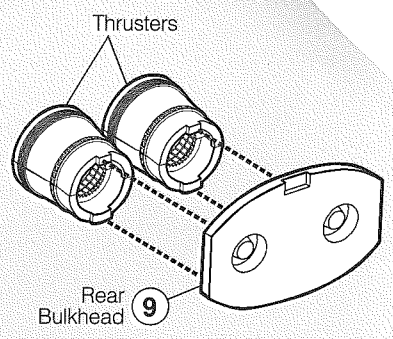

2

BLAST GUARDS

- A** Chose two **Extended Inner Blast Guards** (#44) or two **Retracted Inner Blast Guards** (#48) and cement the **Exterior Blast Guards** (#42) to them.
- B** Cement your choice of **Extended Side Blast Guards** or **Retracted Side Blast Guards** in place on the **Lower Main Fuselage** (#4).

2A

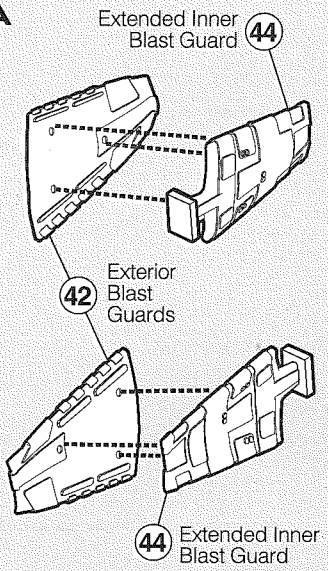

OR

Retracted Inner Blast Guard (#48)

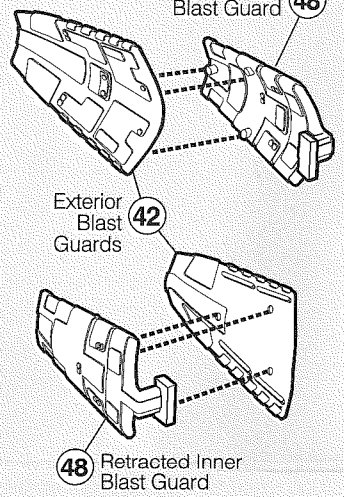

2B

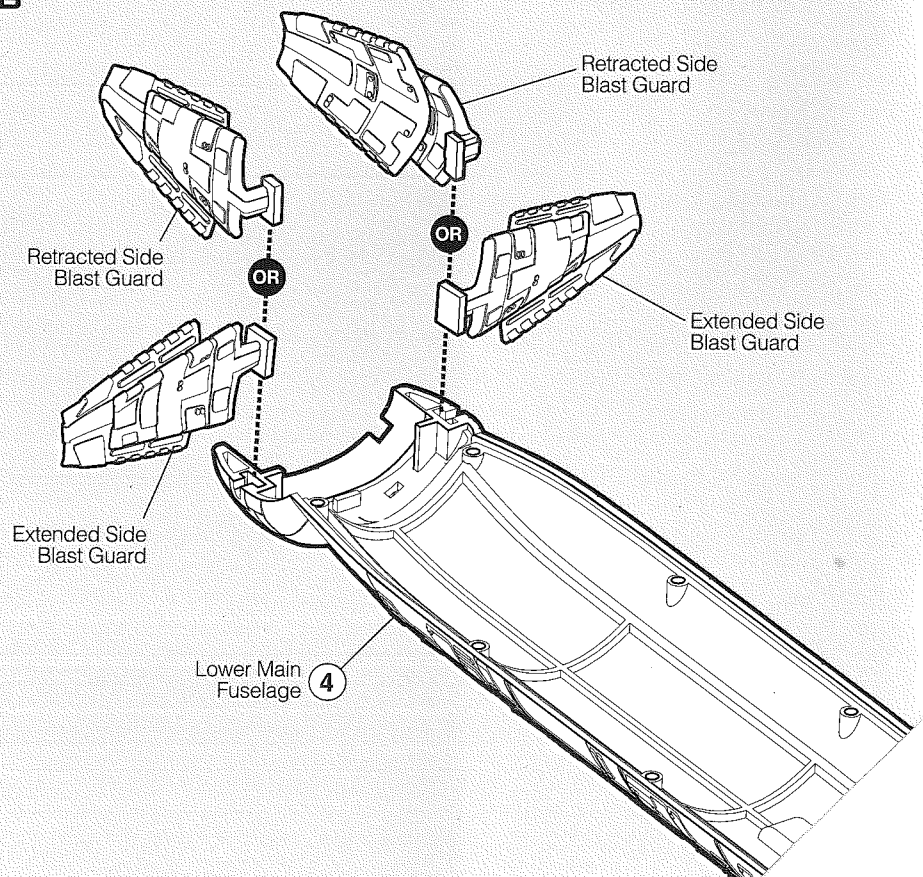

3 MAIN FUSELAGE

Cement **Rear Bulkhead Assembly** to **Lower Main Fuselage** (#4), then cement the **Upper Main Fuselage** (#3) in place.

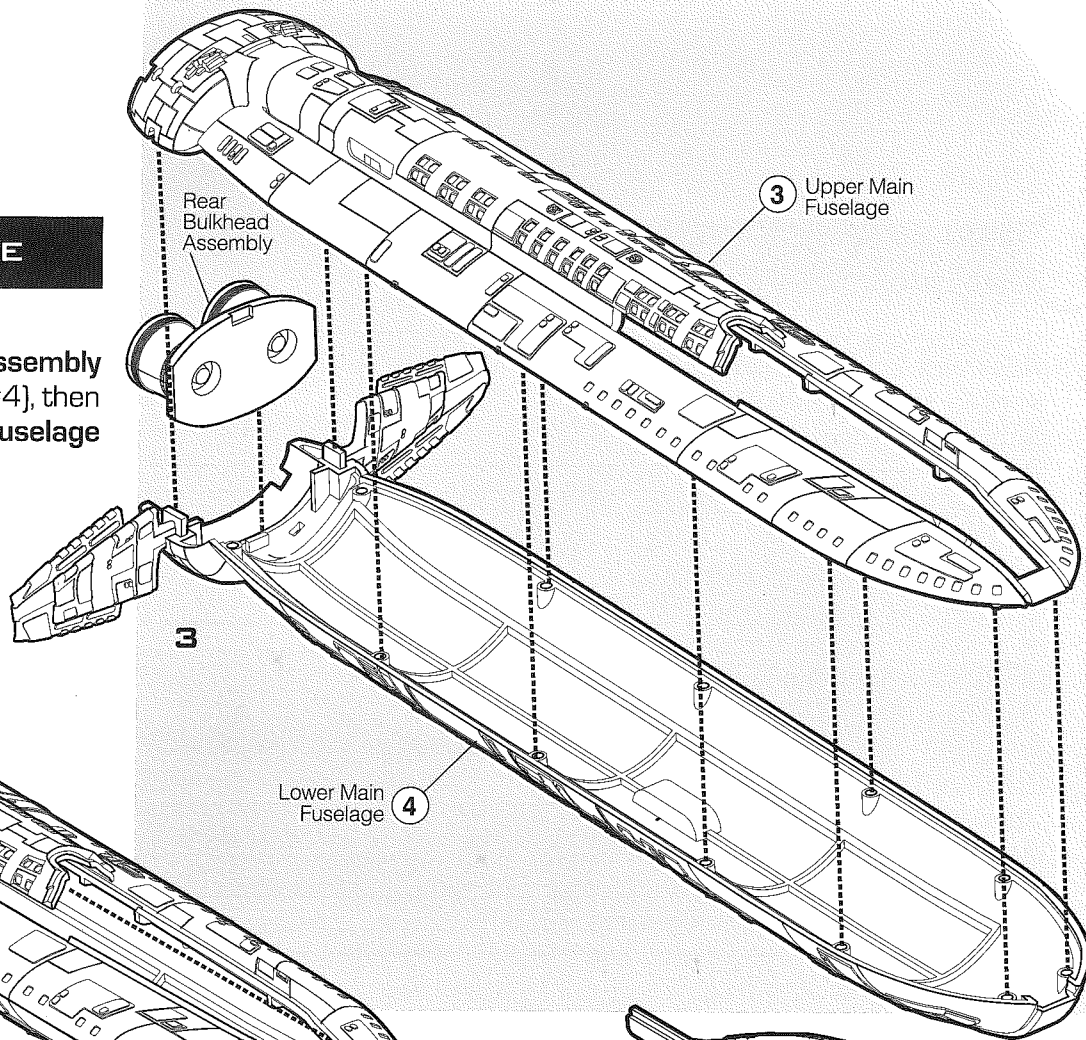

4 CONNING TOWER

A Cement **Conning Tower Halves Port** (#1) and **Starboard** (#2) together. Cement **Conning Tower Assembly** to the **Main Fuselage**.

B For model on its landing gear, add **Lower Gear Fairings** (#12 & #14), and **Landing Foot** (#13) to bottom of nose.

C For model in flight, cut the extended forward landing leg off leaving only a stub for locating **Fairings** (#12 & #14) which will now be glued against the bottom of nose.

D Add **Antenna Arrays** (#10 & #11), **Cockpit Window** (#49) and **Observation Deck Windows** (#50).

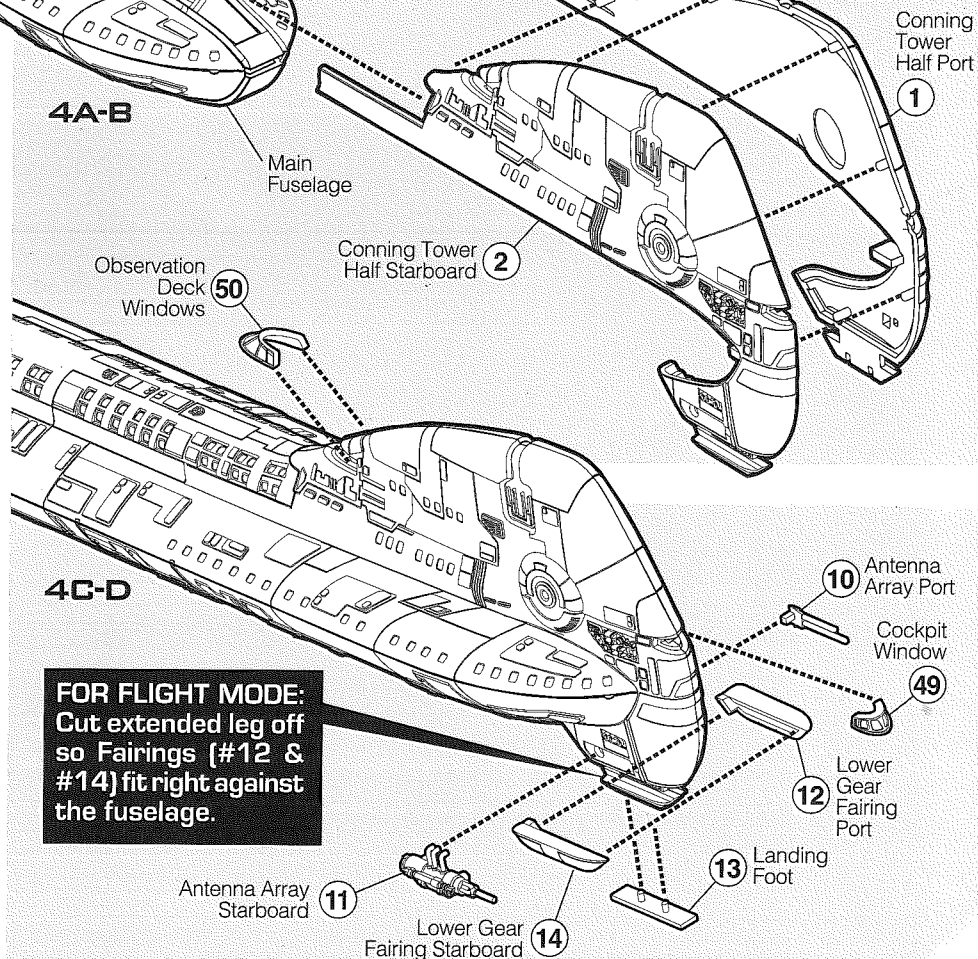

FOR FLIGHT MODE:
Cut extended leg off so Fairings (#12 & #14) fit right against the fuselage.

5 ENGINES

- A** Assemble the **Upper Engine** by inserting the **Exhaust Plate** (#39) into **Upper Engine Port Half** (#5) then cementing the **Upper Engine Starboard Half** (#6) in place.
- B** Assemble the **Lower Engine** by inserting the **Exhaust Plate** (#39) into **Lower Engine Port Half** (#7) then cementing the **Lower Engine Starboard Half** (#8) in place.
- C** Cement **Upper** and **Lower Engine Assemblies** to top and bottom of **Main Fuselage** as shown.
- D** Add the **Engine Coolant Fixtures** (#45R & #45L) to the rear of the **Main Fuselage** as shown.
- E** Assemble **Lower Auxiliary Engine** by cementing the **Upper Half** (#33) to the **Lower Half** (#34). Add the **Protective Plates Forward** (#35) and **Aft** (#36) to the bottom.
- F** Cement **Lower Auxiliary Engine** to underside of the **Main Fuselage** as shown.

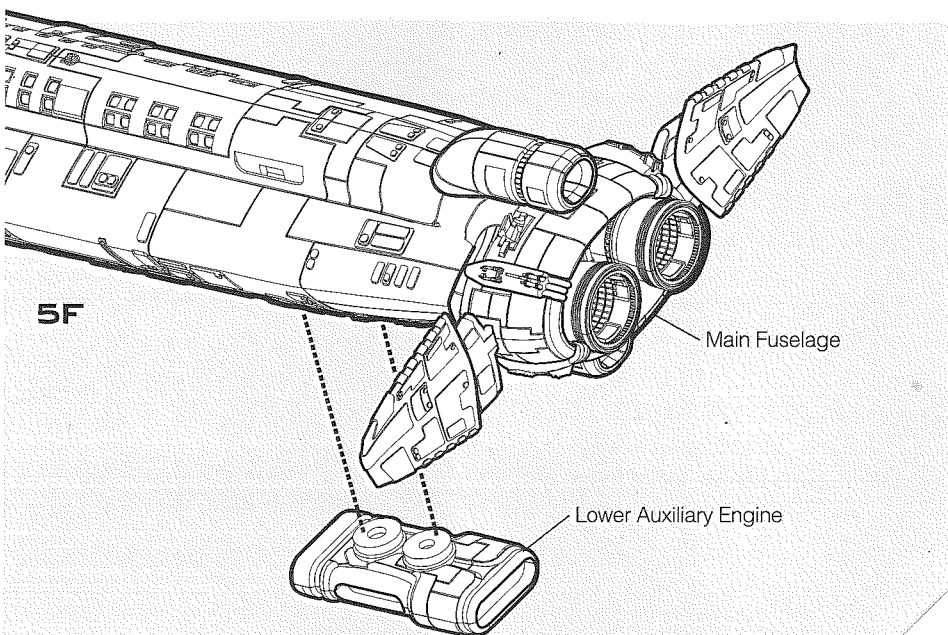
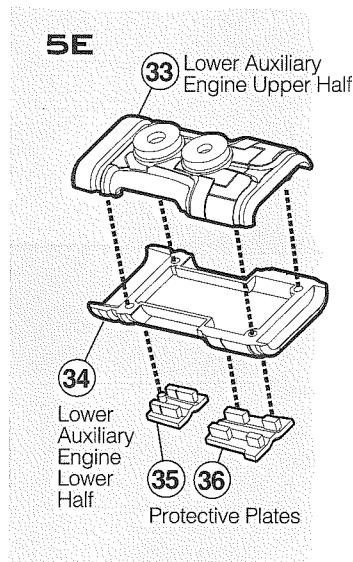
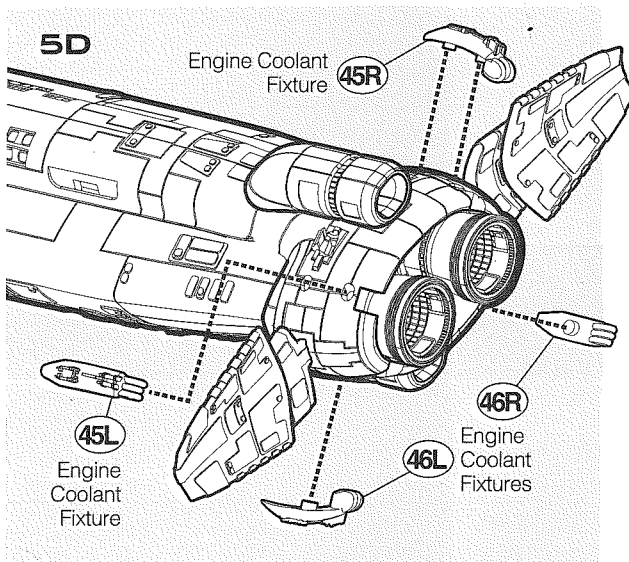
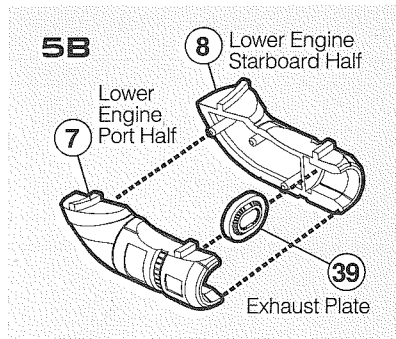
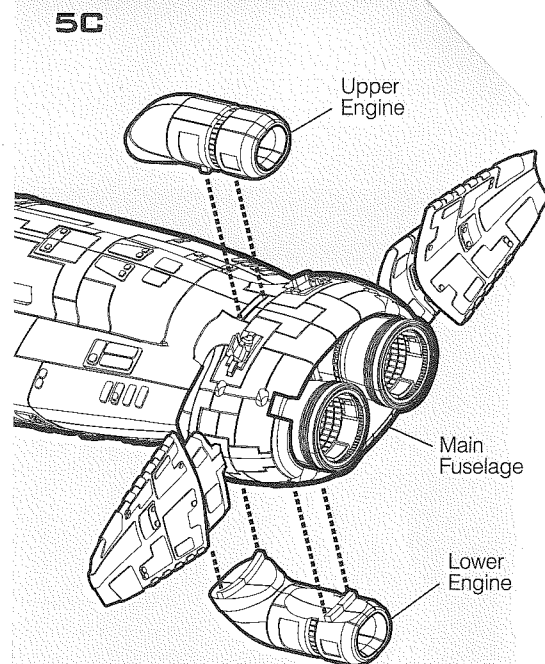
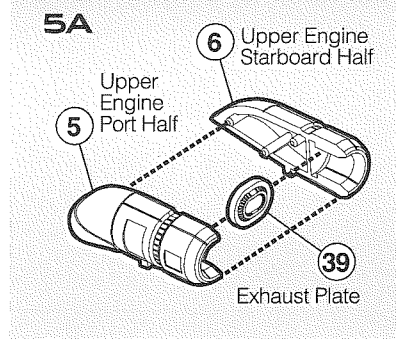

6 PROPULSION ARRAY

6A

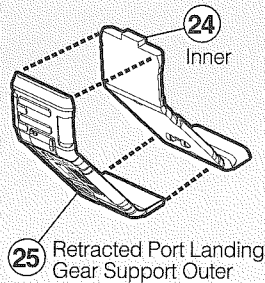

OR

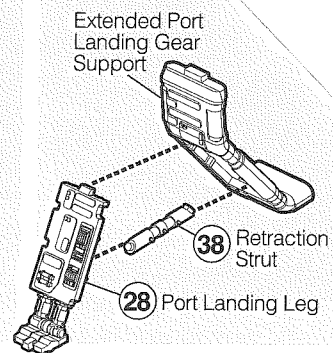
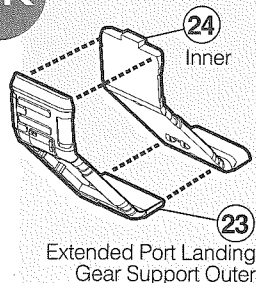

6B

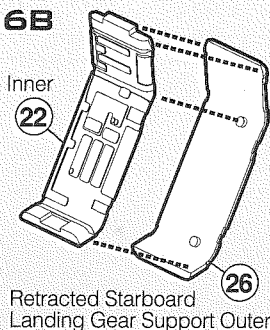

OR

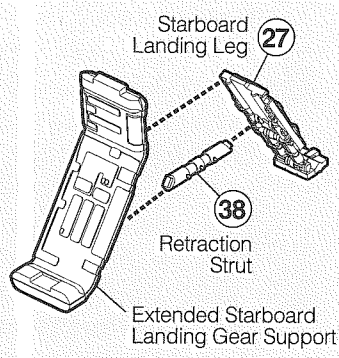
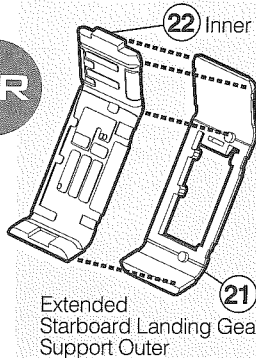

6C

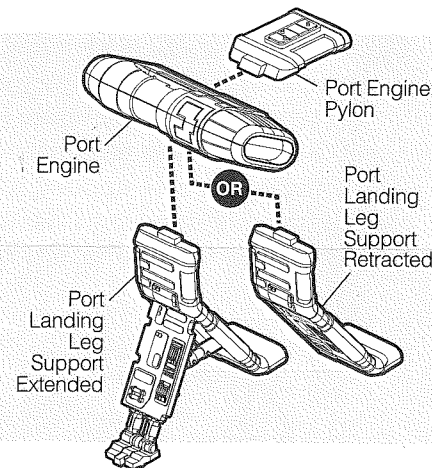
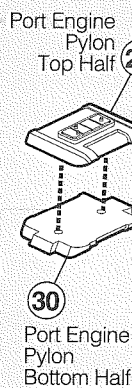
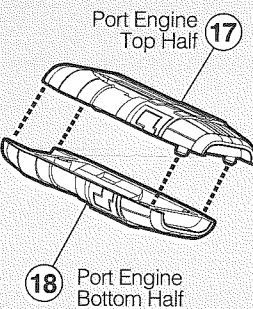

6D

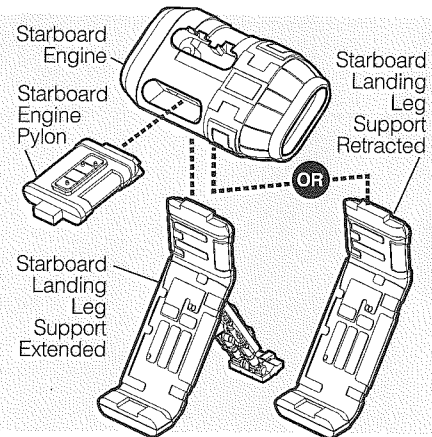
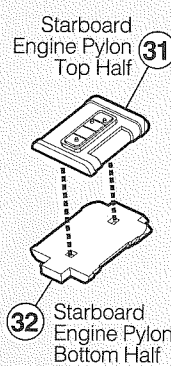
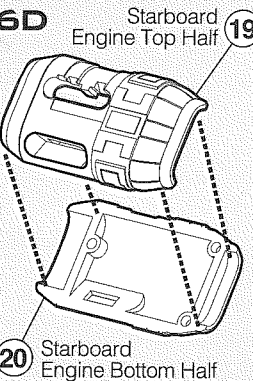

6E

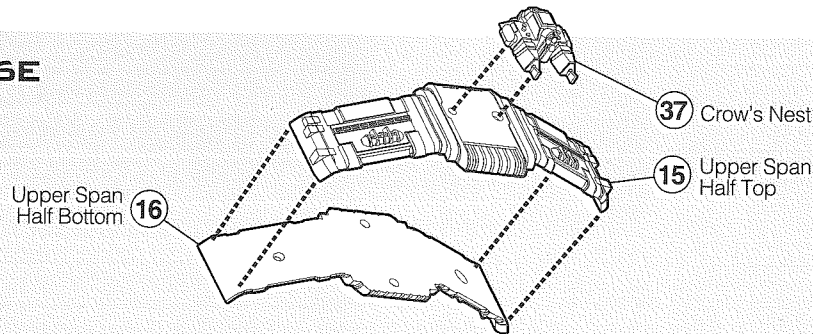

! Decide if you wish to display your model in flight with **Retracted Landing Gear**, or in landing mode with **Extended Landing Gear** and assemble the following parts accordingly.

A For model in flight, cement the **Retracted Port Landing Gear Support Outer** (#25) to **Inner** (#24).
OR

For model on landing gear, cement the **Extended Port Landing Gear Support Outer** (#23) to the **Inner** (#24) and add **Port Landing Leg** (#28) and **Retraction Strut** (#38).

B For model in flight cement **Retracted Starboard Landing Gear Support Outer** (#26) to **Inner** (#22).
OR

For model on landing gear, cement **Extended Starboard Landing Gear Support Outer** (#21) to **Inner** (#22) and add **Starboard Landing Leg** (#27) and **Retraction Strut** (#38).

C Assemble the **Port Engine** (#17 & #18) and the **Port Engine Pylon** (#29 & #30). Cement **Port Engine Assembly** to top of **Port Landing Leg Support**. Add the **Port Engine Pylon** to the **Port Engine**. Set this assembly aside for now.

D Assemble the **Starboard Engine** (#19 & #20) and the **Starboard Engine Pylon** (#31 & #32). Cement **Starboard Engine Assembly** to top of **Starboard Landing Leg Support**, add the **Starboard Engine Pylon** to **Starboard Engine**. Set this assembly aside for now.

E Cement the **Upper Span Halves** (#15 & #16) together and add the **Crow's Nest** (#37).

! **NOTE:** For purposes of simplification, the final assembly steps show model being built with **Extended Landing Gear** only. However, the builder may choose to assemble model with **Retracted Landing Gear** instead.

F Attach **Port Landing and Engine Assembly** by cementing the **Port Engine Pylon** to the **Main Fuselage** and the **Port Landing Gear Support** to the **Lower Engine**.

G Cement the **Span Assembly** to the top of the **Port Landing and Engine Assembly**.

H Attach the **Starboard Landing and Engine Assembly** by cementing the **Starboard Engine Pylon** to the **Main Fuselage**, the **Starboard Landing Gear Support** to **Lower Engine** and the **Span Assembly** to the top of the **Starboard Engine**.

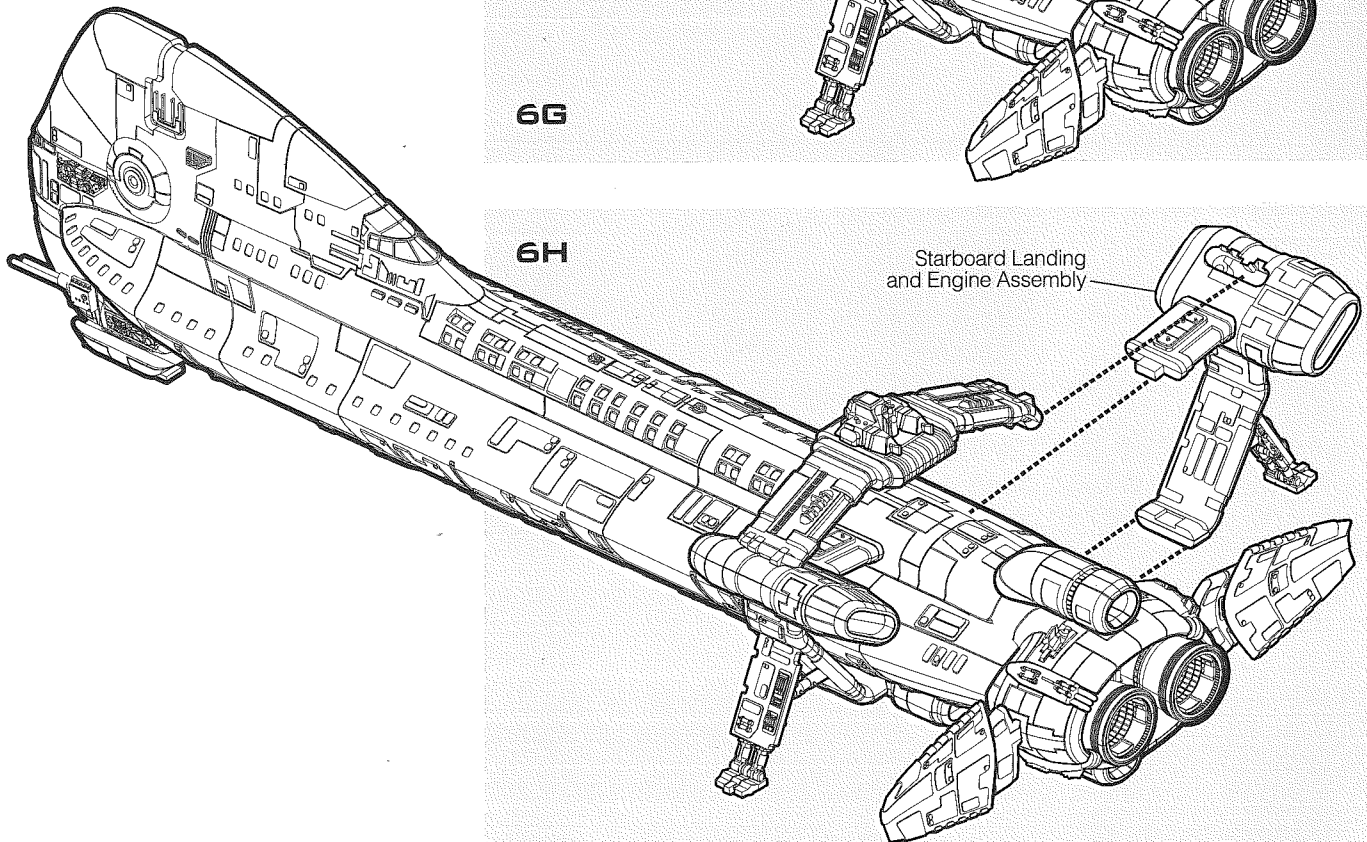
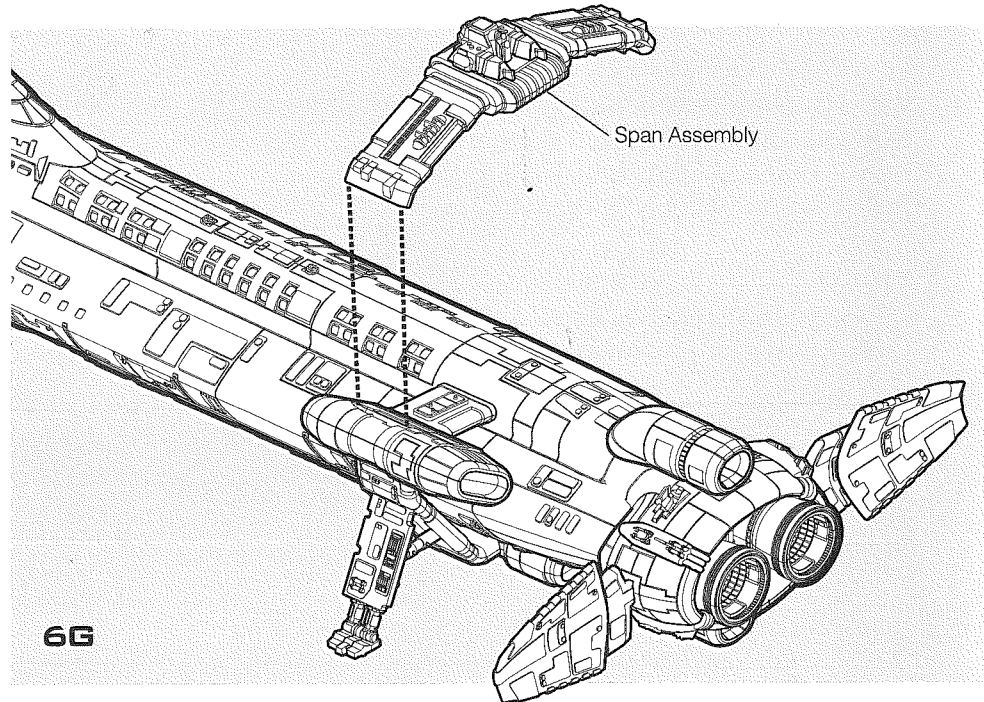
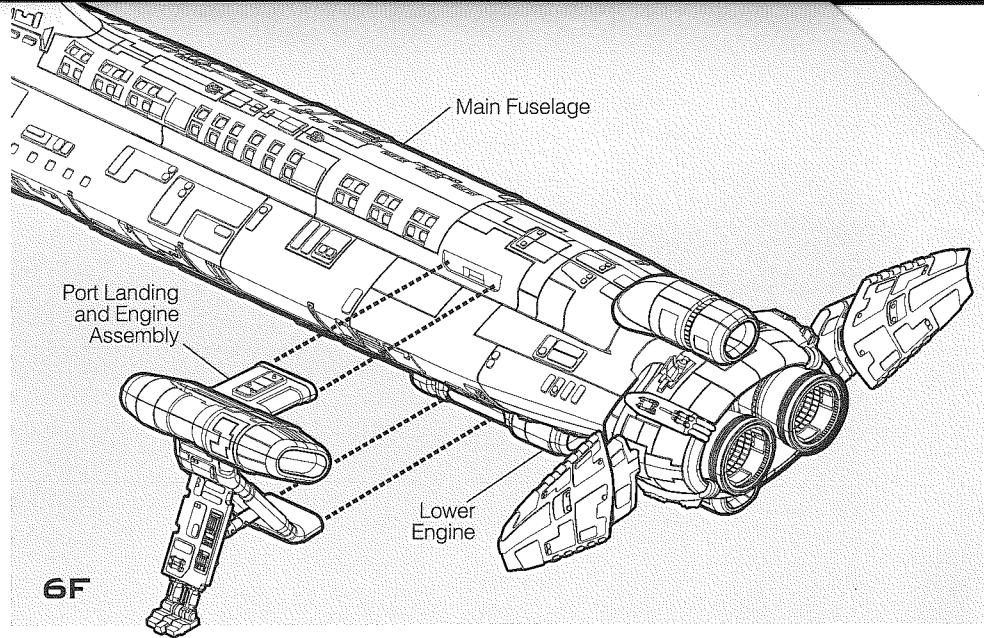

7 BLAST GUARDS

A For **Upper Blast Guard**, choose either the **Extended Inner Blast Guard (#43)** or **Retracted Inner Blast Guard (#47)** and add the **Exterior Blast Guard (#42)**.

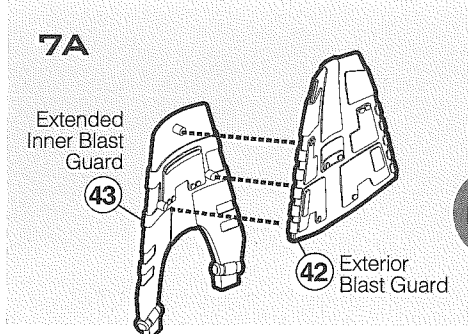

OR

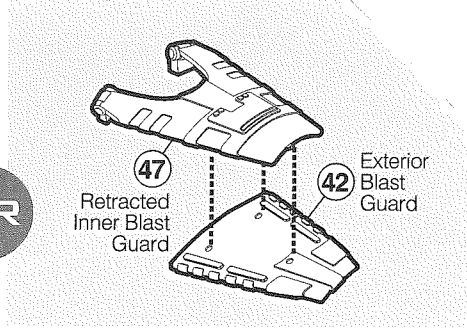

B For **Lower Blast Guard** for in flight model use **Extended Inner Blast Guard (#43)** and add an **Exterior Blast Guard (#42)**.

OR
For model sitting on landing gear, choose **Retracted Inner Blast Guard (#47)** and add **Exterior Blast Guard (#42)**.

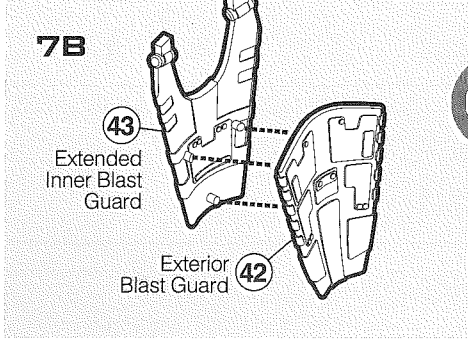

OR

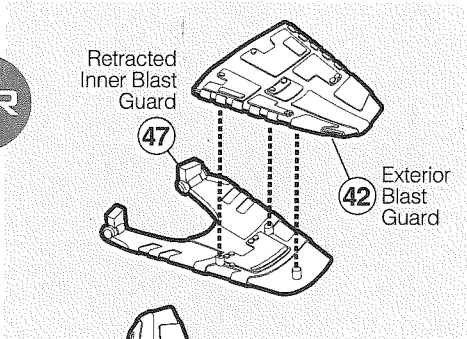

C Add **Upper/Lower Blast Guards** of your choice to **Main Fuselage**.

D Cement the **Display Stand Arm (#45)** to **Display Stand Base (#44)**. Attach the **Display Stand Arm** to the notch on underside of the **Main Fuselage**. Add **Decal (#21)** to base, if desired.

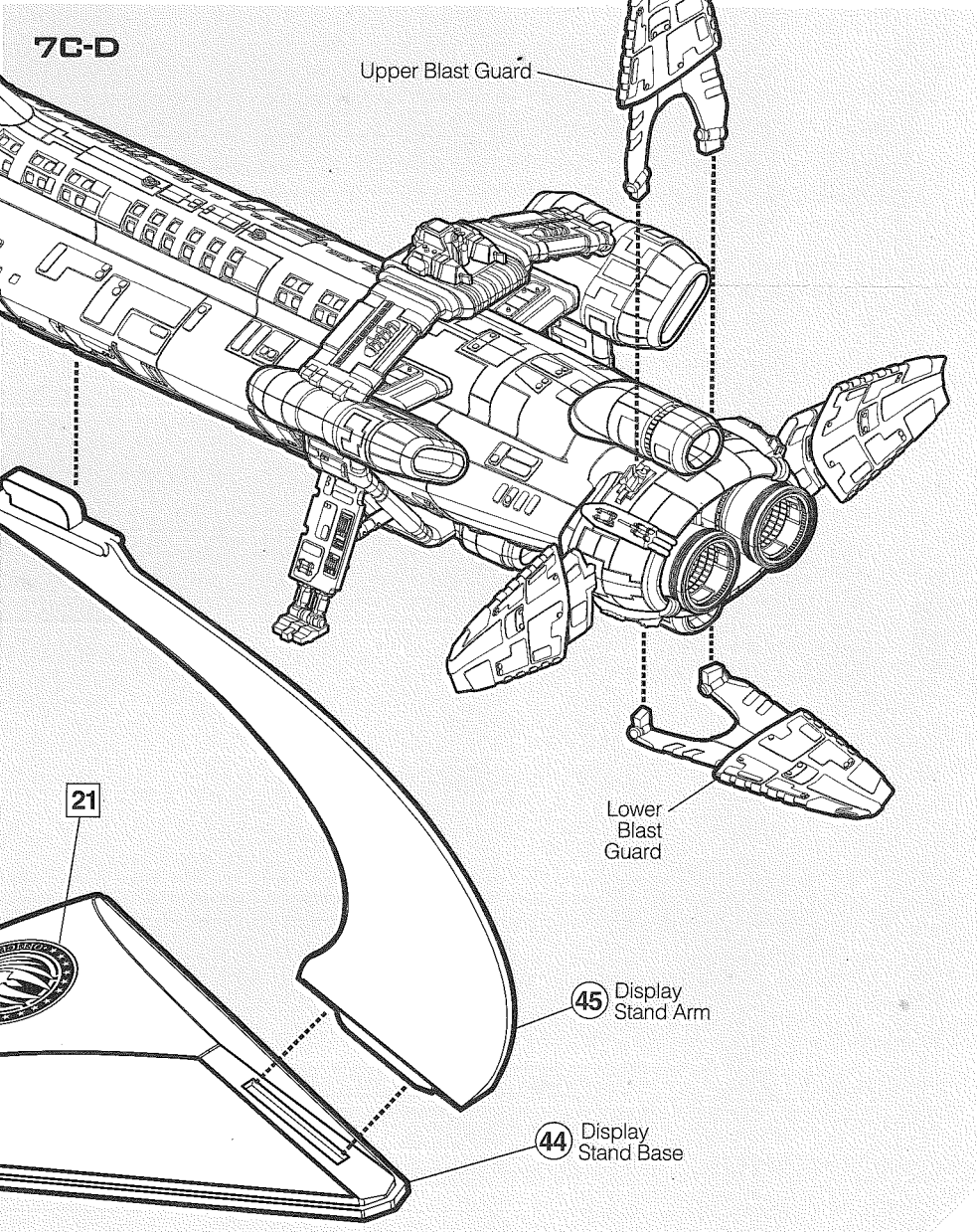

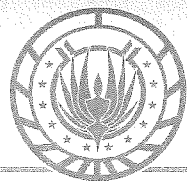

COLONIAL ONE

NOTE Colors described are general guidelines only. You may wish to do more in-depth research if greater detail and accuracy are desired.

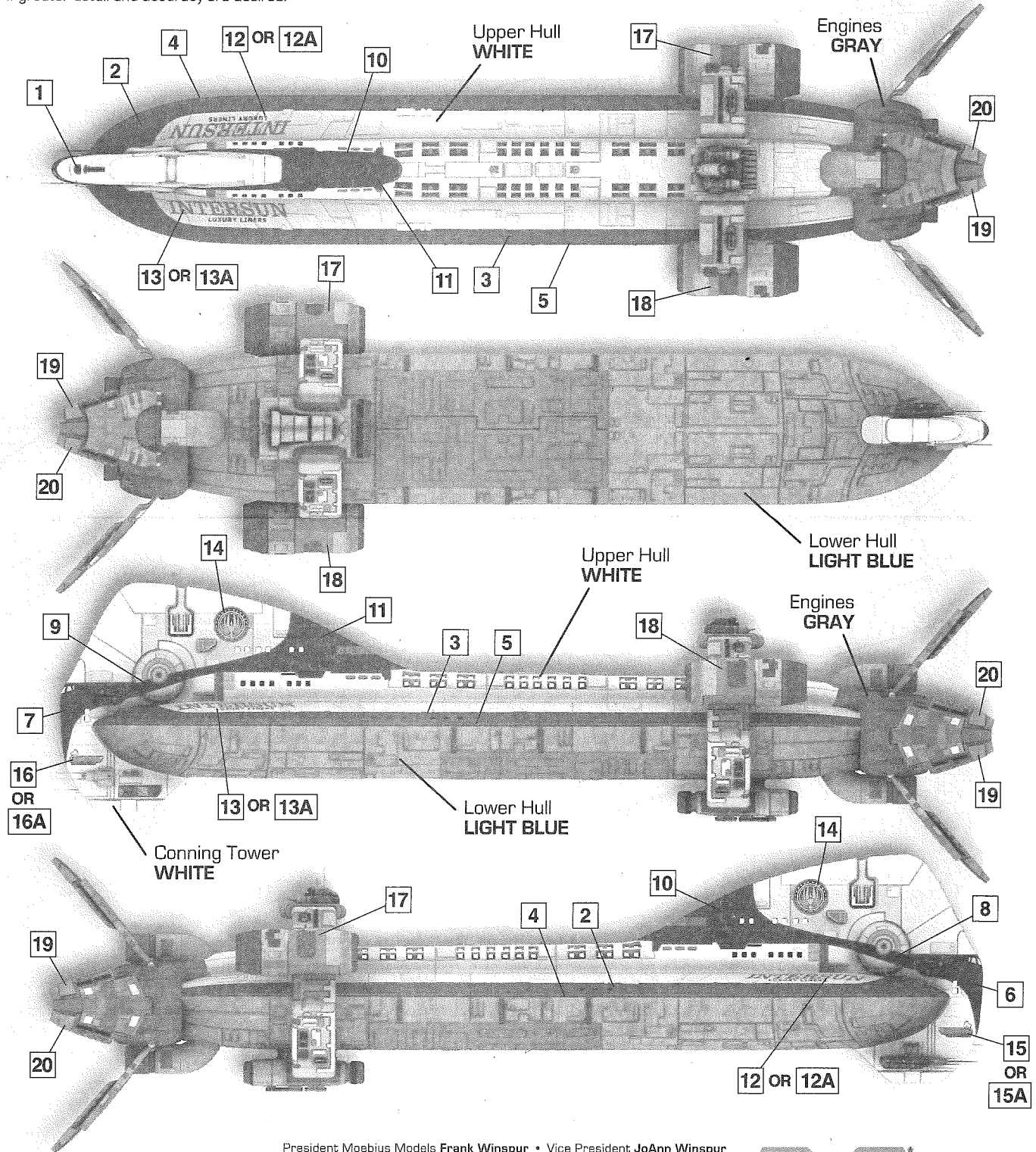

President Moebius Models **Frank Winspur** • Vice President **JoAnn Winspur**
 New Product Manager **Dave Metzner** • Art Director **Bob Plant**
 Buildup for Packaging **Iain Costall** • Special Thanks to **Richard Livingston**



Battlestar Galactica ©2015 Universal Network Television LLC. All Rights Reserved © 2015 Moebius Models. All rights reserved.
 Moebius Models, P.O. Box 229372, Glenwood, FL 32722. Made and printed in China.