

8TON HALF TRACK Sd.Kfz 7/1

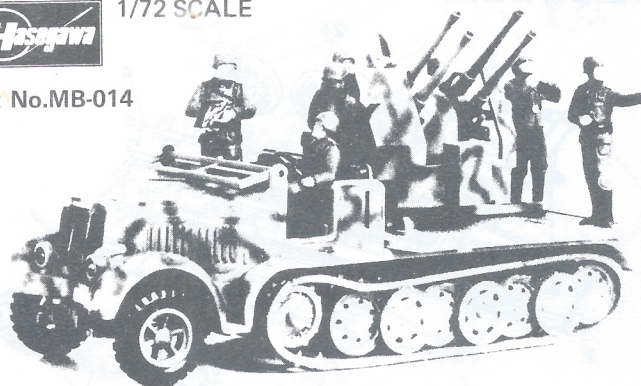

1/72 SCALE

Kit No.MB-014



Based on the design of the very successful prime mover Sd.Kfz 7, the 7/1 was modified to mount the German 2 cm Flakvierling quad 38 anti-aircraft gun. Having a rate of fire of some 800 rounds per minute and a range of two miles, the quad 38 made a very formidable anti-aircraft weapon.

The Sd.Kfz 7/1 was operated by a crew of six and, with its tracked drive wheels, was a very mobile unit. Six-hundred rounds of ammunition were carried in the vehicle and additional rounds could be towed in a trailer. The Sd.Kfz 7/1 could be made into a midget fortress by attaching sheets of armor plating to the truck body. Thus protected the vehicle was nearly invulnerable to anything but heavy arms fire.

SPECIFICATIONS

Length: 22 feet 3 inches

Road Speed: 30 mph

Engine: Six cylinder Maybach HL 62, 140 hp

Crew: Six men



MANUFACTURED IN JAPAN
& PACKED IN ENGLAND
By A. A. HALES LTD.
HINCKLEY, LEICS.

- ① Cement 3 and 4 to sides of 2. Cement 5 to front of 2 as shown. Cement 20 and 22 to axles on 3 and 4, then cement 21 and 23 to the forward pin on each side. Now cement one 24 over each axle pin marked by an arrow.

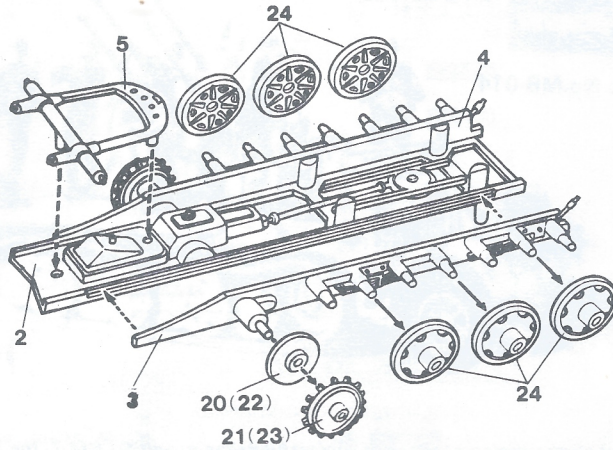

- ② Cement 18 and 19 to front axle as shown. Cement a 25 and 26 to each remaining axle, four to a side.

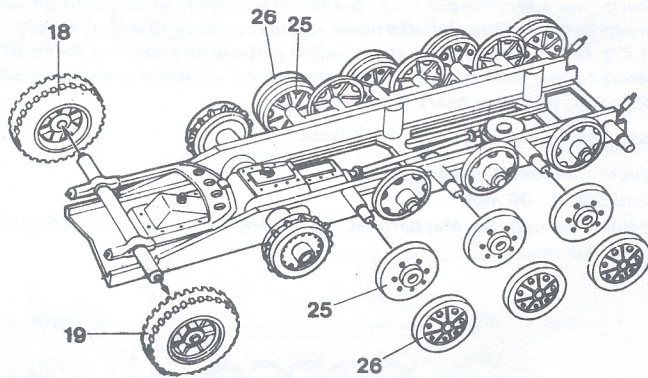

- ③ Cement a 27 to inside wheel (24) as shown. Cement 6 to the front of the assembly and 10 to the rear.

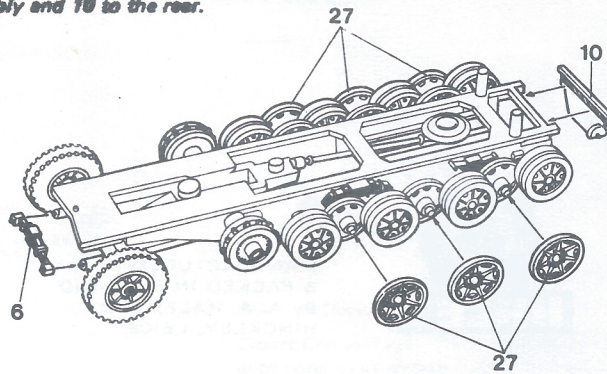

- ④ Cement 5 to 7 as shown by the arrows. Cement A-1 to A then cement 12 into the driver's hands.

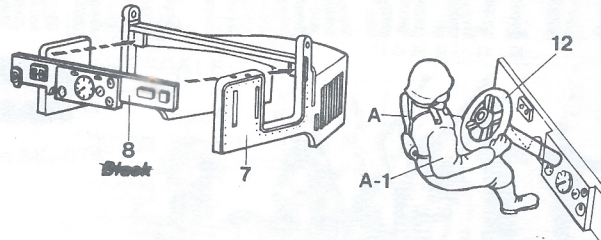

- ⑤ Snap 14 into pins on hood assembly. Cement 9 to front of hood and cement unit to 1. Cement 13 and 28 in place.

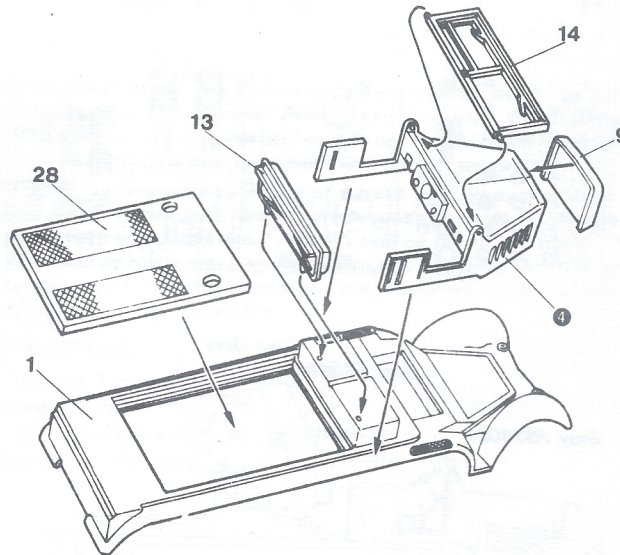

- ⑥ Cement 15, 16 and 17 to front fenders. Cement 29, 30 and 31 in place as shown.

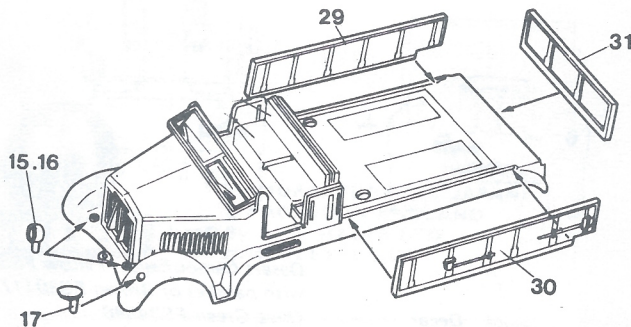

- 7** Cement 40 to pin on 38 as shown by arrow. Cement 50 to 38. Now cement 39 to 38 and 40, locating pin on 40 to 39 as shown by arrow. Cement gun body to 37. Note that pad on 37 fits notch in body. Slide pin on 41 through hole in gun body then cement 42 to end of pin. Gun should elevate.

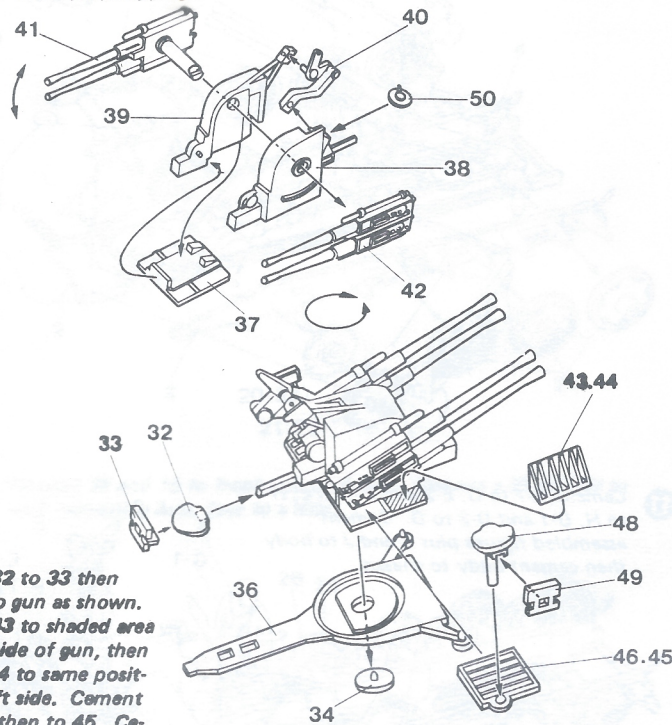

- 8** Cement 32 to 33 then cement to gun as shown. Cement 43 to shaded area on right side of gun, then cement 44 to same position on left side. Cement 48 to 49 then to 45. Cement 45 in place as shown. Repeat for opposite side using parts 46, 48 and 49.

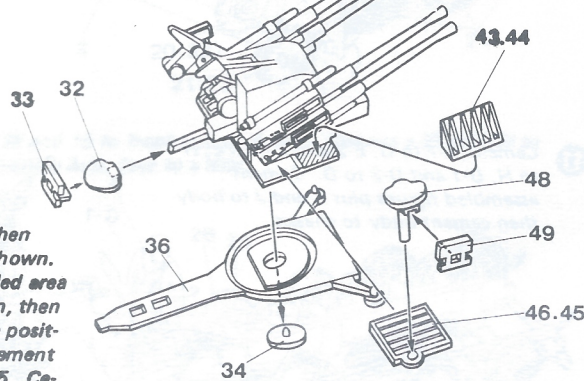

- 9** Remove the flexible tracks from the runners. Place the pins on one end through the holes in the opposite end. Using a heated blade, melt the end of each pin to secure the track. Slide the track over the wheels as shown. Cement 11 to the rear of the chassis unit.

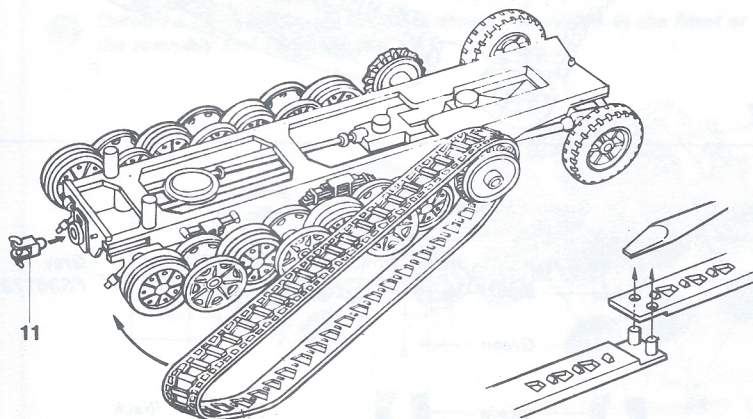

- 10 Cement 47 to front of gun then cement gun into body.

47

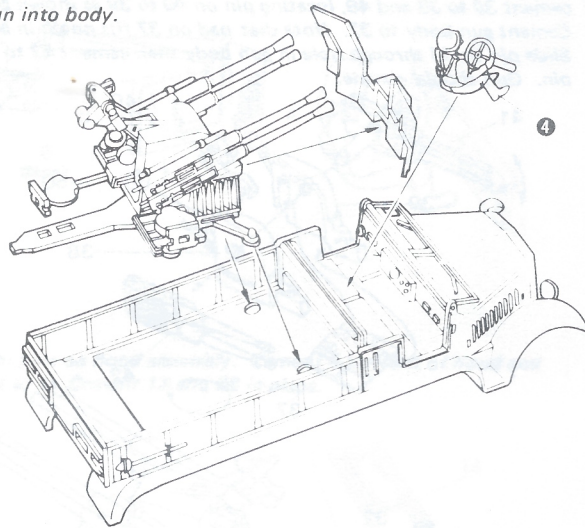

- 11 Cement G-1 to G, E-2 and E-1 to E, H-1 to H, D-1 and D-2 to D. Cement assembled figures plus F and J to body then cement body to chassis.

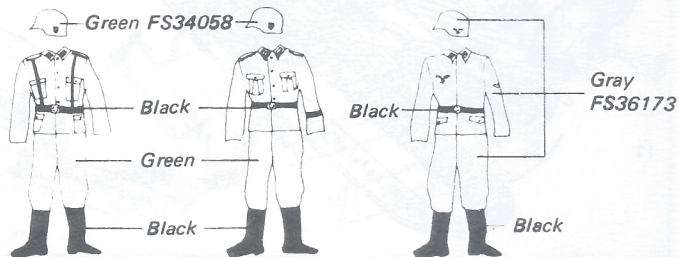
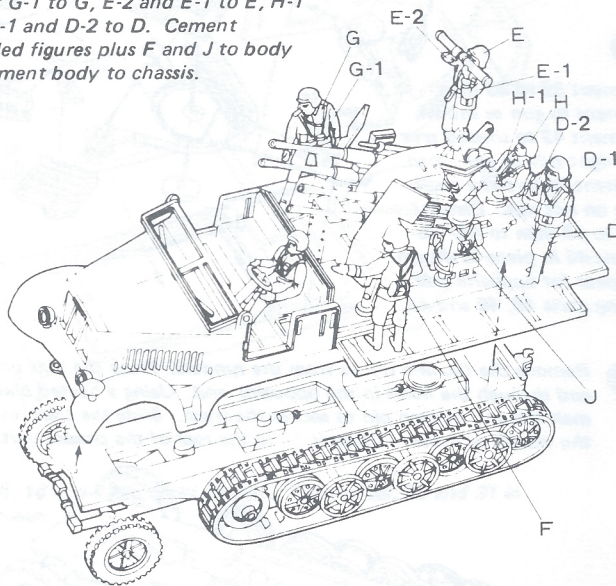

PART DRAWINGS AND PART NUMBERS

