

FROG

Registered Trade Mark

BLACK WIDOW

1/72nd Scale.

CAT. No. F.175

INSTRUCTIONS

It is recommended that the instructions and exploded view are studied and assembly practised before commencing.

Use Frog Polystyrene Cement and Frog Paints.

It may be necessary in some cases to mix two or more colours to obtain shades required. Paint all small parts before assembly.

Great care should be taken on handling the capsules of cement to avoid getting the adhesive on the face or clothing, and in particular, in the eyes.

ASSEMBLY INSTRUCTIONS

1. Cement and locate together Parts Nos. 1, 2 and 3, making sure that Part No. 2 is movable. Allow to dry.
2. Locate Part No. 4 on to Part No. 2. To retain in position, spread end of pin on Part No. 2 with a hot knife blade.
3. Locate and cement in position Parts Nos. 5, 6, 7, 8, 9, 10, 11 and 12, noting that Part No. 12 may be fitted in the open or closed position.
4. Cement and locate in position Parts Nos. 13, 14 and 15, making sure that Part No. 15 is movable.
5. Cement and locate in position Parts Nos. 16, 17 and 18, making sure that Part No. 18 is movable.
6. Cement together the tail Parts Nos. 19, 20, 21 and 22, making sure that Parts Nos. 21 and 22 are movable. Allow to dry.
7. Cement together left hand tailboom Parts Nos. 23, 24, 25, 26 and 27, making sure that Parts Nos. 25, 26 and 27 are movable.
8. Cement together right hand tailboom Parts Nos. 28, 29, 30, 31 and 32, making sure that Parts Nos. 30, 31 and 32 are movable.
9. Locate and cement left and right hand tailbooms together with tail unit on to underside of Parts Nos. 13 and 16 and allow to dry.
10. Cement together Parts Nos. 33 and 34 and locate on to Parts Nos. 25 and 30. To retain in position spread end of pin on Parts Nos. 25 and 30 with a hot knife blade.
11. Locate and cement in position Parts Nos. 35, 36, 37, 38, 39 and 40, making sure that Parts No. 36 are able to rotate.
12. Locate and cement in position Parts Nos. 41, 42, 43, 44 and 45.
13. Locate and cement in position Parts Nos. 46 and 47.
14. At this stage it is best to paint the model. See instructions for colours.
15. Apply transfers. First cut the sheet into 9 separate subjects, then dip each one into water for about half a minute, slide off backing into position shown on illustration.
16. Cement together stand and locate arm of stand in slot on model.

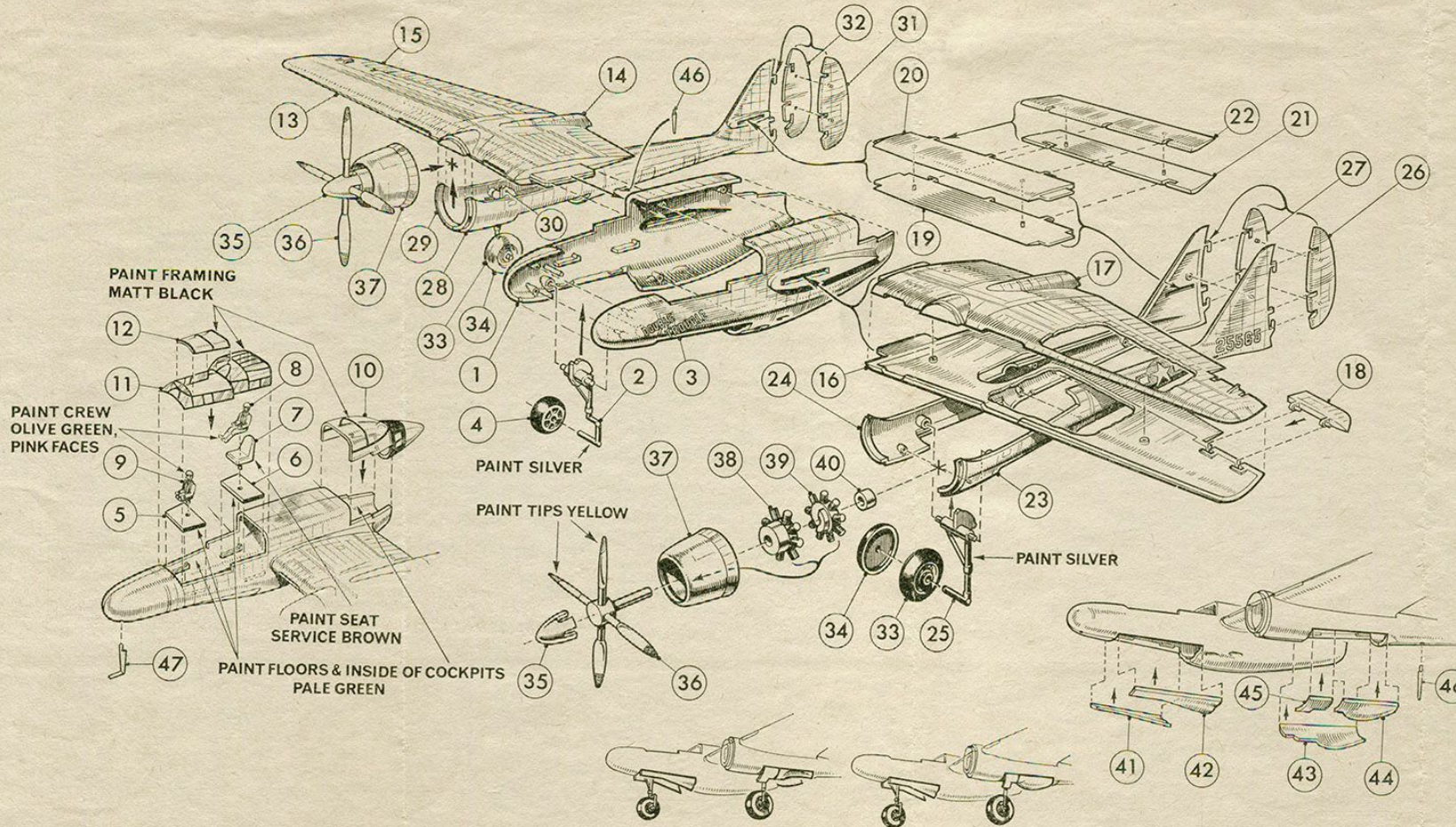

LIST OF PARTS:

- | | | |
|----------------------------------|---|--|
| 1. Fuselage Half (Right Hand) | 16. Lower Wing Half (Left Hand) | 34. Inner Main Wheel Half — 2 off |
| 2. Nose undercarriage leg | 17. Upper Wing Half (Left Hand) | 35. Airscrew Spinner — 2 off |
| 3. Fuselage Half (Left Hand) | 18. Aileron (Left Hand) | 36. Airscrew — 2 off |
| 4. Nose Wheel | 19. Lower Tailplane Half | 37. Engine Cowl — 2 off |
| 5. Front cabin floor | 20. Upper Tailplane Half | 38. Front Engine — 2 off |
| 6. Rear cabin floor | 21. Lower Elevator Half | 39. Rear Engine — 2 off |
| 7. Crewman's seat | 22. Upper Elevator Half | 40. Airscrew Collar — 2 off |
| 8. Rear crewman | 23. Outer Tailboom Half (Left Hand) | 41. Nose Undercarriage Door (Right Hand) |
| 9. Front crewman | 24. Inner Tailboom Half (Left Hand) | 42. Nose Undercarriage Door (Left Hand) |
| 10. Rear Cabin | 25. Main Undercarriage Leg (Left Hand) | 43. Main Inner Undercarriage Door — 1 off Left Hand and 1 off Right Hand |
| 11. Main Cabin | 26. Outer Rudder Half (Left Hand) | 44. Rear Main Outer Undercarriage Door — 1 off Left Hand and 1 off Right Hand |
| 12. Main Cabin Roof | 27. Inner Rudder Half (Left Hand) | 45. Front Main Outer Undercarriage Door — 1 off Left Hand and 1 off Right Hand |
| 13. Lower Wing Half (Right Hand) | 28. Inner Tailboom Half (Right Hand) | 46. Aerial Mast — 2 off |
| 14. Upper Wing Half (Right Hand) | 29. Outer Tailboom Half (Right Hand) | 47. Air Speed Indicator |
| 15. Aileron (Right Hand) | 30. Main Undercarriage Leg (Right Hand) | |
| | 31. Outer Rudder Half (Right Hand) | |
| | 32. Outer Main Wheel Half — 2 off | |
| | 33. Outer Main Wheel Half — 2 off | |

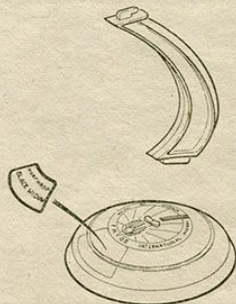

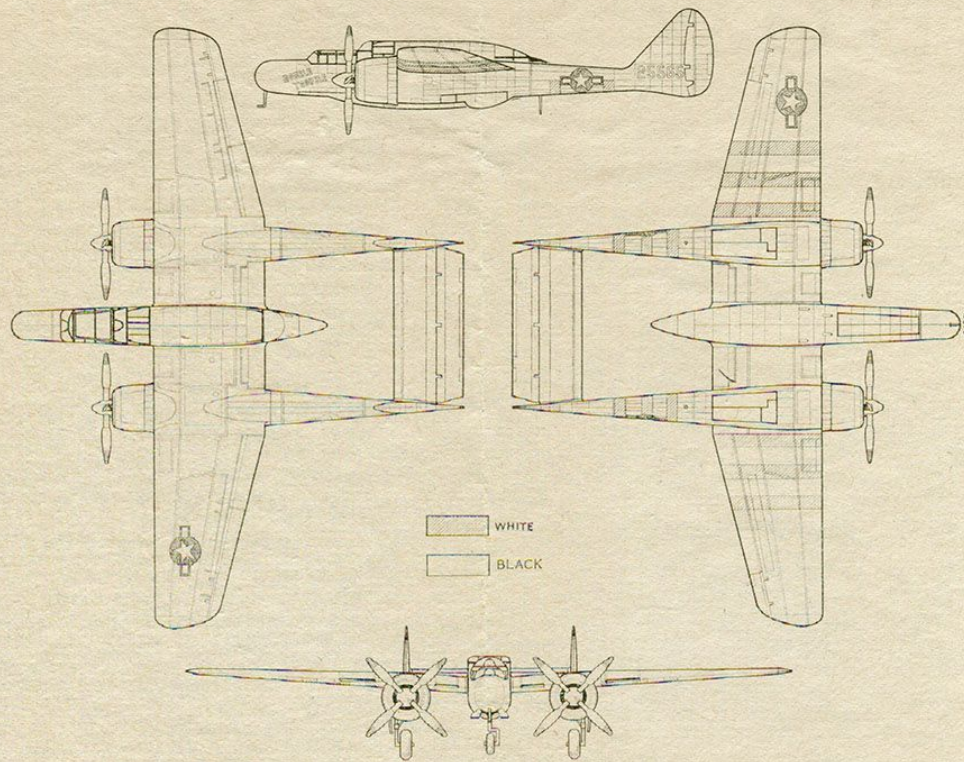

HISTORY OF THE BLACK WIDOW.

Built by Northrop Aircraft Inc., California, U.S.A.
 The Black Widow was the first American aircraft to be designed as a night fighter.
 The first prototype was flown on May 21st, 1942.
 Black Widows were used in Europe and the Pacific during the later stages of the War.
 Our model is of a two-seat version used in Europe with D-Day invasion markings.

The power plant of the Black Widow was two 2,250 h.p. Pratt & Whitney Double Wasp R-2800-65 eighteen cylinder air-cooled radial engines.

DATA :
 Wing Span ... 66ft.
 Length ... 48ft. 9ins.
 Armament ... Four 20 m.m. Cannon.
 Maximum Speed ... 369 m.p.h. at 20,000ft.

SOME OF THE OTHER EXCITING FROG KITS TO ADD TO YOUR COLLECTION *

- | | | |
|--|---|--|
| <p>1/72nd SCALE AIRCRAFT
 Percival Proctor IV.
 Hawker Sea Fury X.
 Miles Magister
 Miles Master III.
 Fokker D21
 Dewoitine D520C
 Morane Saulnier 406
 Macchi C202
 Curtis Kittyhawk (Gold Tokens)
 Focke Wulf FW.190 (Gold Tokens)
 Hawker Typhoon (Gold Tokens)
 Republic Thunderbolt (Gold Tokens)
 Supermarine Spitfire II. (Gold Tokens)
 Mitsubishi Zero (Gold Tokens)
 Supermarine S6B. (Trail Blazer) (Gold Tokens)
 North American Sabre (Gold Tokens)
 Bristol Beaufort II.
 Westland Wessex I. (Gold Tokens)
 Airspeed Oxford II. (Gold Tokens)
 Fairey Barracuda (Gold Tokens)
 Spirit of St. Louis (Trail Blazer) (Gold Tokens)
 Blackburn Skua (Gold Tokens)
 Westland Wallace (Trail Blazer) (Gold Tokens)</p> | <p>D.H. Comet 88 (Trail Blazer) (Gold Tokens)
 G.A. Hotspur II. (Gold Tokens)
 Hawker Hunter (Gold Tokens)
 Fairey Delta (Gold Tokens)
 Vickers Supermarine Attacker (Gold Tokens)
 Fairey Gannet (Gold Tokens)
 De Havilland D.H.110 (Gold Tokens)
 Hawker Sea Hawk (Gold Tokens)
 English Electric P.1 (Gold Tokens)
 Martin Baltimore (Gold Tokens)
 Douglas Boston III. (DB/7B) (Gold Tokens)
 Junkers J.U.88 (Gold Tokens)
 Gloster Javelin (Gold Tokens)
 English Electric Canberra PR7 (Gold Tokens)
 Martin Marauder II. (Gold Tokens)
 North American Mitchell (Gold Tokens)
 Vickers Vimy (Trail Blazer) (Gold Tokens)
 Handley Page Dart Herald
 Bleriot XI. (Gold Tokens)</p> | <p>BEA Vickers Viscount 800
 De Havilland Comet
 Avro Vulcan
 Vickers Valiant
 Handley Page Victor
 Air France Caravelle
 Bristol Britannia 100</p> <p>1/144th SCALE AIRCRAFT :
 Special New Super Kit.
 B.O.A.C. Super V.C.10 with flashing lights
 B.O.A.C. Boeing 707</p> <p>1/500th SCALE SHIPS :
 H.M.S. Hero
 H.M.S. Ashanti
 H.M.S. Torquay
 H.M.S. Undine
 H.M.S. Exeter (Gold Tokens)
 H.M.S. Revenge (Gold Tokens)</p> <p>OTHER SCALE SHIPS :
 Shell Coastal Tanker
 Trinity House Lightship
 H.M.S. Tiger. Cruiser
 Battle Class Destroyer</p> |
|--|---|--|

* PRICES ARE U.K. ONLY FROM 2/- to 19/11.



GET YOUR FROG STORY-BOOK CATALOGUE AND ALBUM FROM YOUR FROG DEALER NOW!
 Collect all the picture transfer cards in the "Trail Blazers" kits in order to complete your Album.

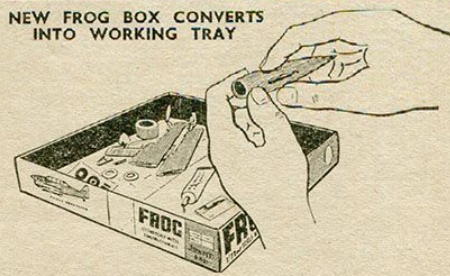

SAVE GOLD TOKENS FOR EXCITING FREE GIFTS!

Here are 12 FROG GOLD TOKENS for you to collect for the wonderful free gifts. Every time you buy a FROG Construction Kit with a GOLD TOKEN on the box you will find FROG GOLD TOKENS inside which are worth exciting free gifts to you. Save your FROG GOLD TOKENS. Look out for other FROG Construction Kits with GOLD TOKENS inside. They are fun and easy to collect and when you have enough you can send for any of these free gifts :-
 Two FROG "Chuck" Gliders. Balsa construction. Stunt and fly like a real plane ... 15 tokens.
 Book of "Record-Breakers". 32 pages of full colour showing records and pictures of land, air and water record breakers ... 30 tokens.
 FROG Junior Sail Plane Kit. 20" semi-scale Glider. Balsa wood and tissue construction. All shaped parts pre-cut. Outstanding flying characteristics ... 45 tokens.

ALL YOU HAVE TO DO.

Just cut out and save your FROG GOLD TOKENS on this leaflet. When you have collected enough for the free gifts you want, send them with your name and address together with a 3d. stamp, to help with the postage of your gift to :-

GOLD TOKEN (DEPARTMENT F), LONDON, N.W.1.

Due to the cost of postage and duty the FROG GOLD TOKEN GIFT SCHEME has to be confined to the United Kingdom Only.

Made in England by International Model Aircraft Ltd., Morden Road, Merton, London, S.W.19.

FROG

FROG PAINTING GUIDE



Every time you buy a FROG kit with a Gold Token on the box you will find Gold Tokens inside which are worth exciting FREE GIFTS. UK ONLY.

Collect the GOLD TOKENS IN FROG KITS!



KIT FEATURES

Movable airscrews and wheels. Movable ailerons, elevator and rudders. Retractable undercarriage. Two crewmen. 11" wing span. 63 parts.