

Fig. 1

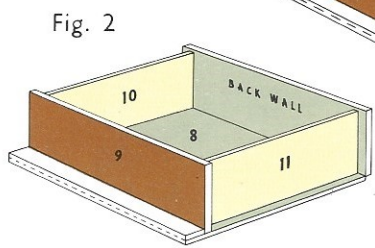

Fig. 2

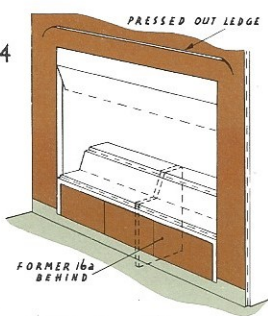

Fig. 4

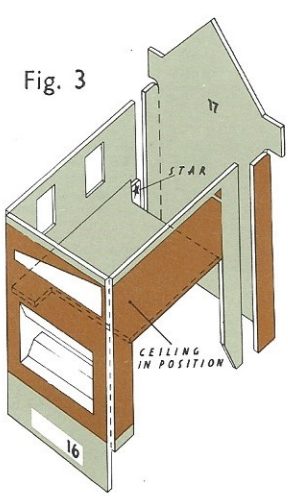

Fig. 3

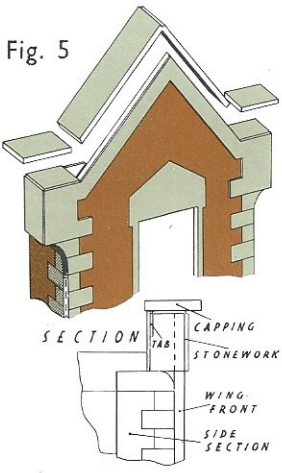

Fig. 5

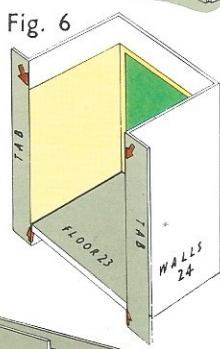

Fig. 6

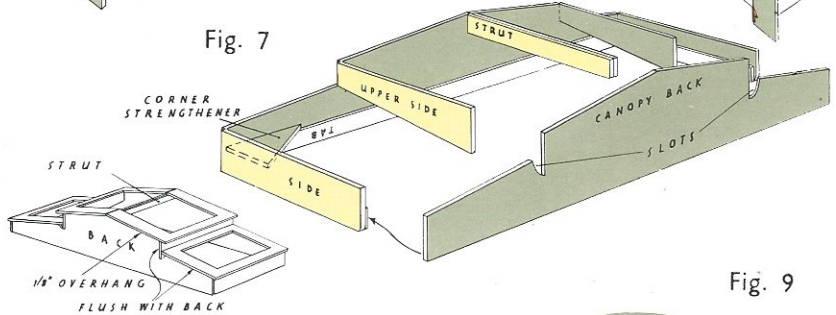

Fig. 7

Fig. 9

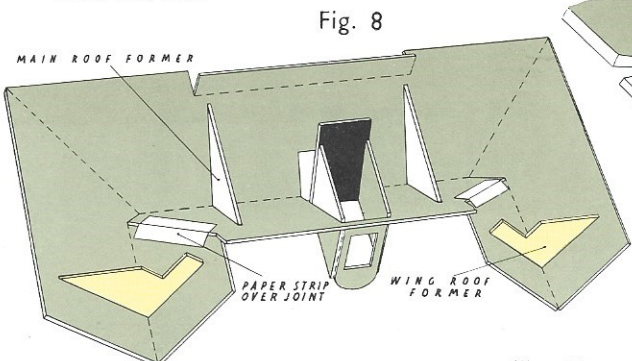

Fig. 8

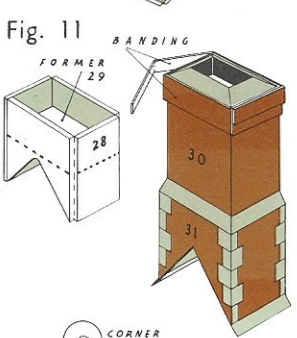

Fig. 11

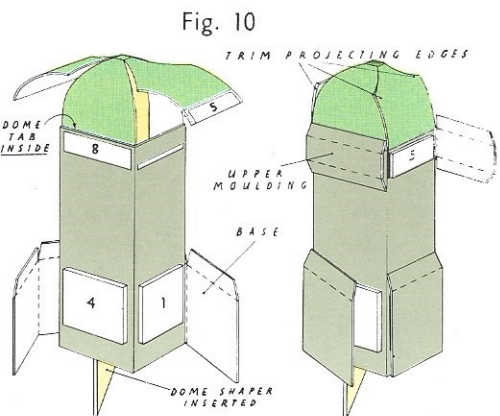

Fig. 10

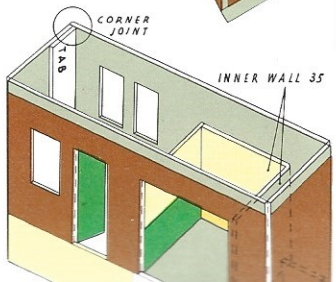
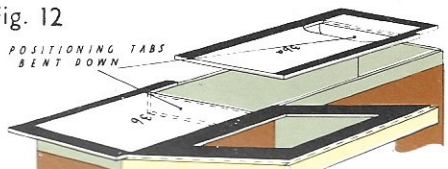

Fig. 12



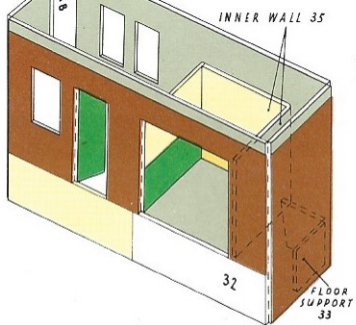
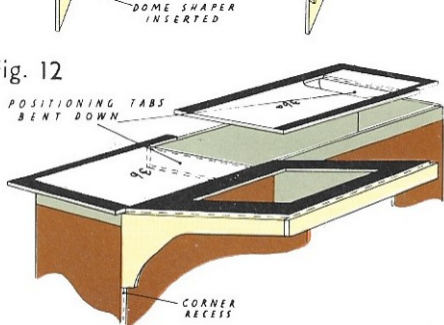

Fig. 12



8. Remove the Main Roof, cut away the three waste pieces and bend to shape along the ridge tiles. Bend back along the top edge the black portion where the Dormer Window will be fixed. Take the two Main Roof Formers and glue them underneath, spaced about 3" apart (Fig. 8) followed by the Wing Roof Formers, set back from the front no more than 3/4". Run glue along the slanting inner edge of one of the Wing sections of the roof, pull it downwards until the triangular gap at the ridge is closed and join it to the adjacent main roof by overlapping it by its own thickness only. In other words, the edges must appear flush on the underside. Strengthen this joint with a strip of paper creased longwise down the middle before being applied over the joint. Complete the other side and apply all the Ridge Tiles. Prepare the Gutters by first making light bending cuts along the red arrow marked lines and bending right back along these lines before opening flat again and cutting out. Bend over and glue down for double thickness the two solid black sections leaving the Tab to be bent at right angles and glued to the underside and edges of the roof (Fig. 9). Glue the Gutters to the Roof noting that the four gutters on the Wings are cut short of the front edges to accommodate the gable stonework. Remove the Dormer Window 25, glaze the window and add its curtain. Bend to shape and glue it around its Former 26, set near the top edges. Fix in place in the Roof. Dampen the underside of Dormer Roof 27 and bend to a curve. When dry, glue in place. Place the Roof in position as a trial, noting how it fits under the stonework at the gable corners. The flap tucks behind the concourse canopy back. Remove the Roof and run glue along the top edges of the back and outside Wing Walls, the front edges of the Wing portions of the Roof and the Tabs on the Entrance.
9. CLOCK TOWER. Make light bending cuts along the four red arrow marked lines before cutting out. The curved lines are best cut with scissors as these end at the corners of the small central square and must not be cut beyond. Glue Clock Tower Packing Pieces 1, 2, 3 and 4 on the face where shown. By dampening the underside and rolling each segment around a cylindrical pencil, produce a curl in the dome sections in their separate directions. This curl need only approximate the finished shape. Bend and glue the Tower to shape. Bend over and glue the Dome Tab, tucking it inside the top (Fig. 10). Insert the Clock Tower Dome Shaper, glued around the curved top and along the edges and press it up into the dome. Spread glue on the underside of the remaining two dome segments and smooth them down in place outside the tower. Trim the projecting edges with scissors only when thoroughly dry. Add Packing Pieces 5, 6, 7 and 8. Make the bending cuts and cut out the Clock Tower Base, glue the underside and wrap it around the tower, flush at the bottom. Repeat with the Upper Moulding above the clock face.
10. CHIMNEYS. Remove and bend one Chimney Base 28 to shape and glue around a Chimney Former 29 set no lower than the dotted line printed on the outside. Make the bending cuts, cut out and glue to shape a Chimney Stack 30 and insert it in the Base. Tuck in the bent black and grey portions until the mitred corners meet. Apply Chimney Base Covering 31 with the sloping bottom edges set just a little below the corresponding edges of the Base for a close fit when attaching to the Roof. Apply the Banding (Fig. 11).
11. Remove Side Building 32 as one piece including the Tab formed from the white margin. Glue down the Tab, glaze the windows and bend to shape, noting, before gluing, how the section below "WAY OUT" bends back to meet the opposite wall and how the joint is made at the corner (Fig. 12). Insert Floor Support 33 in the corner shown, flush at the bottom. Fix Floor 34 (Sheet 2) at this end of the building and resting on 33. Complete by inserting Inner Wall 35 bent up at right angles. Remove Side Building Awning Roof 36, glue down the Valance Tab, glaze the awning and bend up a little along the blue arrowed line. Bend down the Valance front and sides and glue the corner joints. Bend the Positioning Tab down and place onto the walls noting how the Awning is kept in a sloping position by the Valance sides, the outer one fitting into the recess at the wall corner. Glue down, remove Guttering 36a and fix it alongside having cut away the white corner for a flush fit against the main building if the model is to be used as a terminus. Make up Side Building Roof 37. Construct the other Side Building in a similar way, the Parcels Office Partition being bent to follow the line of the print on the floor. Glue Platforms 8 and 12 to their respective Side Buildings.
12. Remove the "Way Out" Covered Way 38 as one piece, glaze the window and glue Door 39 behind the aperture. Bend to shape and glue up, setting the floor portion horizontal to retain the shape. Insert Ramp 40 bent and fixed under the floor. Remove Roof 41, bend to shape noting that it is bent up along the blue arrow marked line. Join the middle section with gummed paper fixed under the ridge and retain the shape with Former 41a. Glue the Roof in place, flush at the back and fix Valance 42 set back a little from the front edge. Apply the Ridge Tiles. The aperture in the side can be covered if required with Repair Piece 38a (Fig. 13).
13. BARRIERS. These are only needed for a terminus. Glue them along the edge of the Concourse with their gates bent back. The model's appearance can be considerably enhanced by colouring all exposed edges with water colour paint mixed to an approximate match. SUPERQUICK Station Platforms No. 1 are designed to fit and match the model you have now completed. The Joint Covering Pieces are supplied for making good the joints between these No. 1 platforms and those sections included in the Terminus kit.

PLAN

