

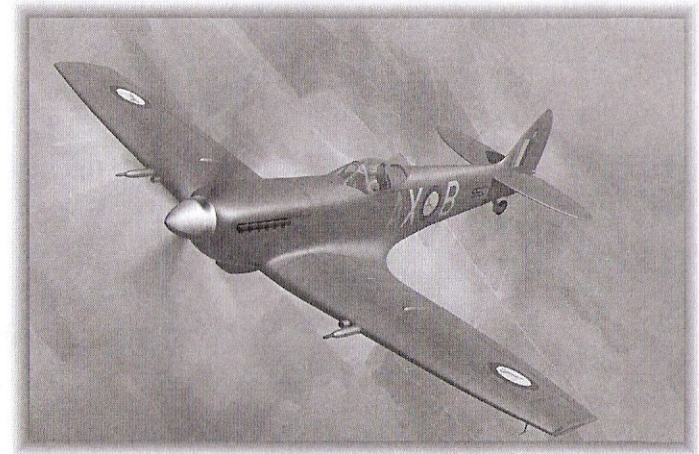

SW 72068 scale: 1/72



Supermarine Spitfire Mk. XVI in International services

Merlin 66, which powered most late-production Spitfire IX's was also made in the U.S.A. by Packard. Due to the fact the Packard-Merlin was built to U.S. tolerances, metric scale and required a complete set of its own tools, the RAF to avoid mishaps has decided to call this version of Spitfire XVI and squadrons re-equipped with Spitfire XVI, were completely re-equipped by this type.

The Mk XVI entered production in September 1944, and remained in production until August 1945, the first unit to take the type on operational charge was 443 Squadron RCAF. Early Mk XVI's were equipped with the "c" wing (four 20mm cannon or two 20mm cannon and four .303in machine guns). Later models used the "e" wing (two .50in machine guns instead of the four .303s).

From February 1945 the Mk XVI used the bubble canopy with cut down fuselage as seen on late Mk IXs and following Spitfire versions. The first bubble-canopy Spitfire XVI's appeared in 74 Squadron in April 1945. The majority of the 1,053 Mk XVI's produced had clipped wings, which improved their rate of roll.

After the war, Spitfire XVI saw service with squadrons of the Royal Auxiliary Air Force, prior to its disbandment in 1952, as well as Anti-Aircraft Cooperation Squadrons in Great Britain.

In abroad XVI's were used by Belgian and Hellenic AF.

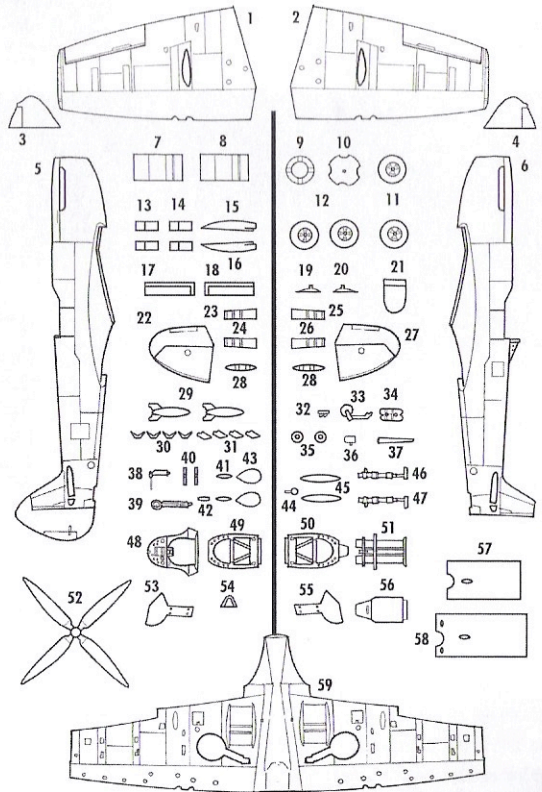

URETHAN

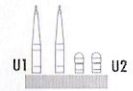

CLEAR

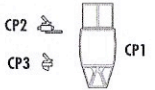

SYMBOLS



BARVA/COLOR	
A	Černá/Black
B	Interierová zelená Interior Green
C	Stříbrná/Silver
D	Hliník/Aluminium
E	Světle šedá/ Light Grey
F	Červená/Red
G	Žlutá/Yellow
H	Zelená/Green
I	Černošedá/ Tyre Black
J	Špinavý hliník/ Dirty Aluminium
K	Chromová/ Chrome
L	Hnědá/Brown
M	Kovová/Gun metal
N	Dřevo/Wood
O	Rezavá/Rust

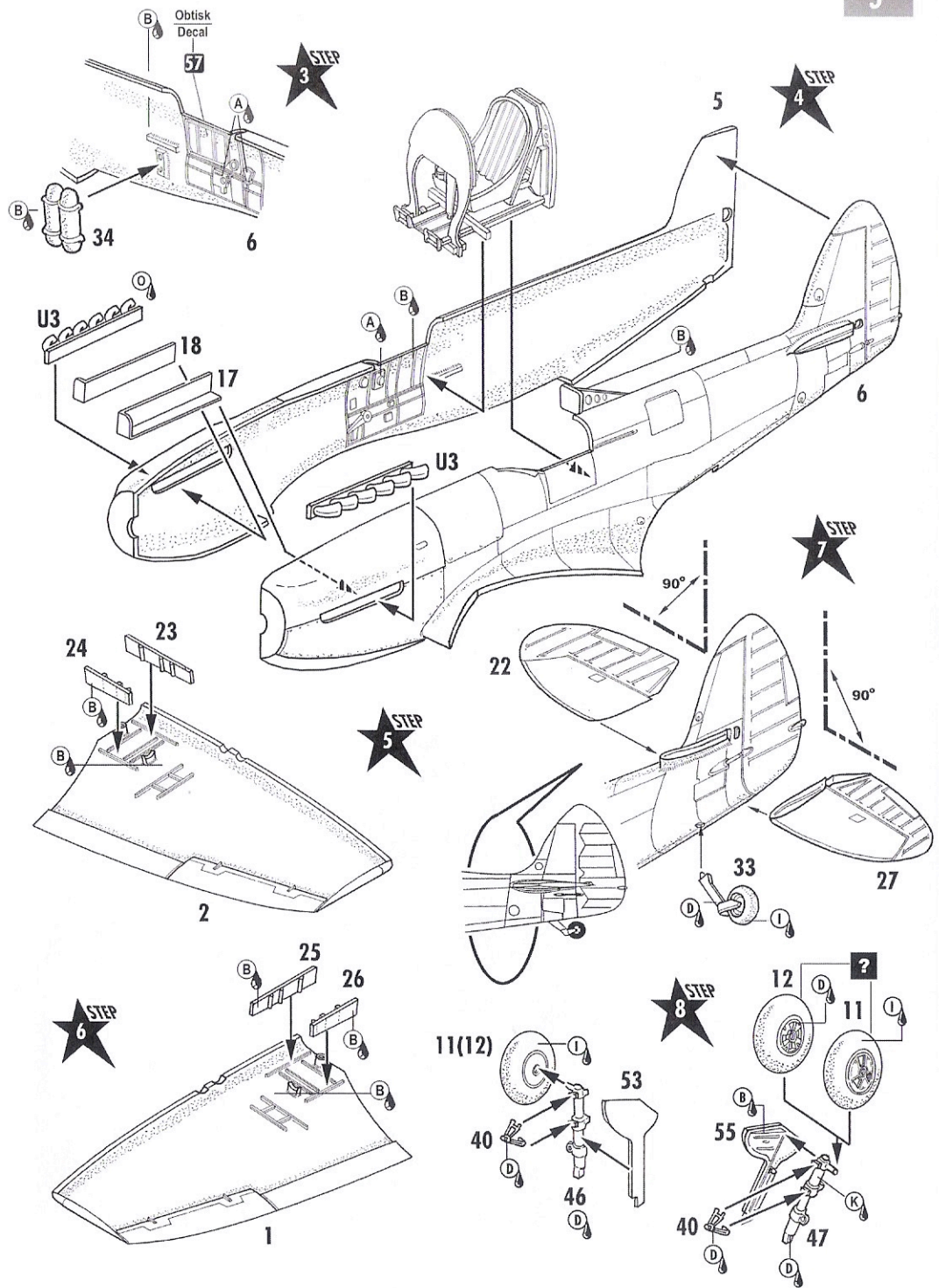
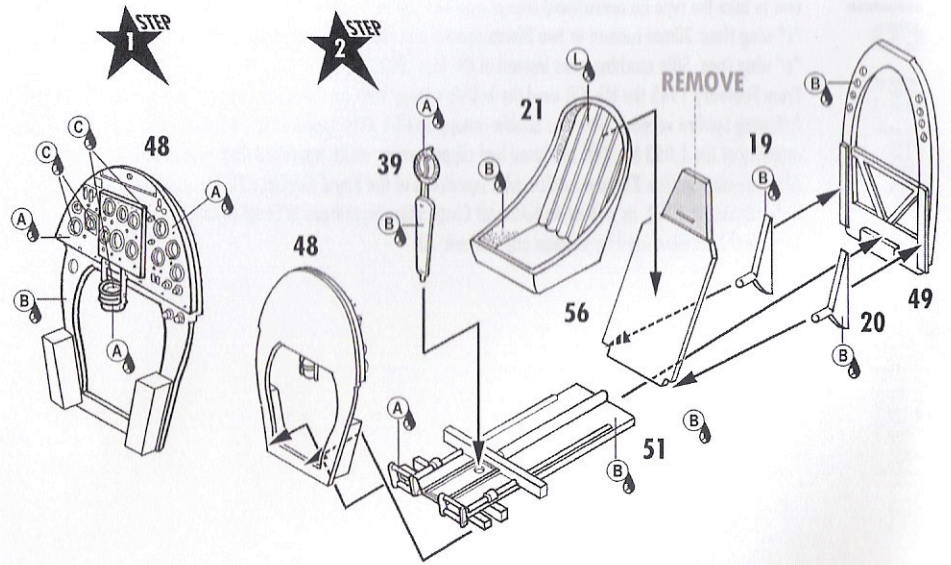

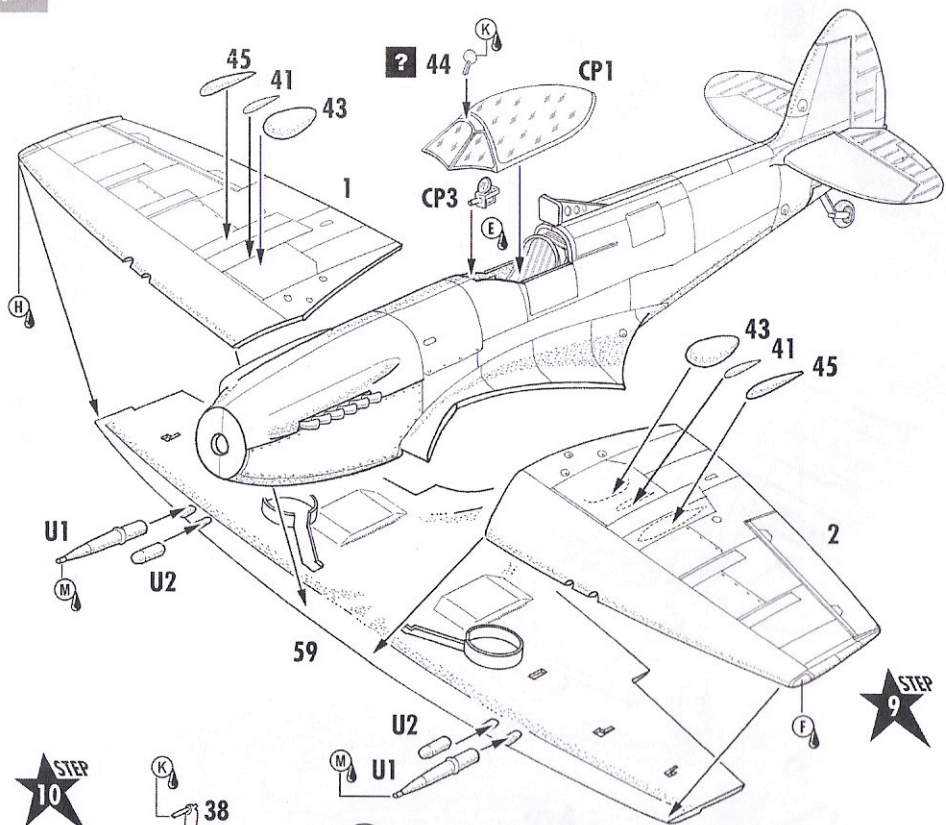

STEP 10

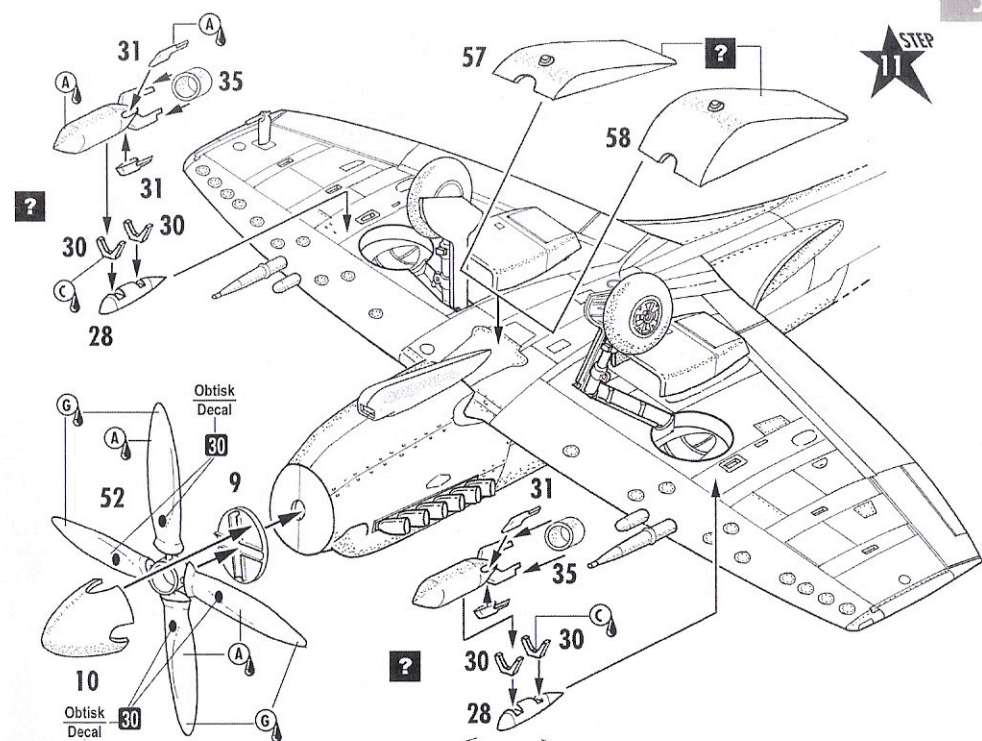
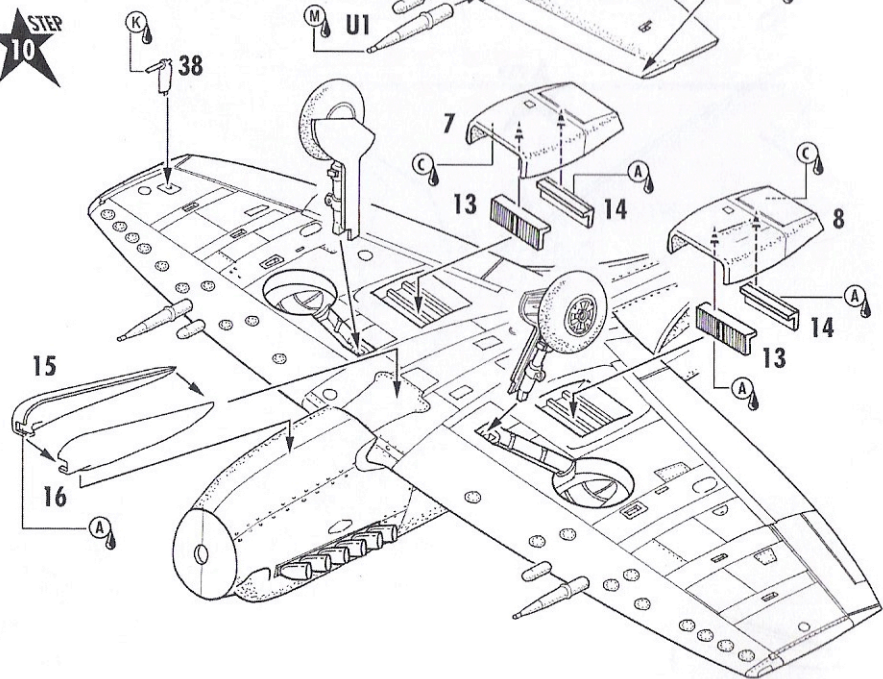

info

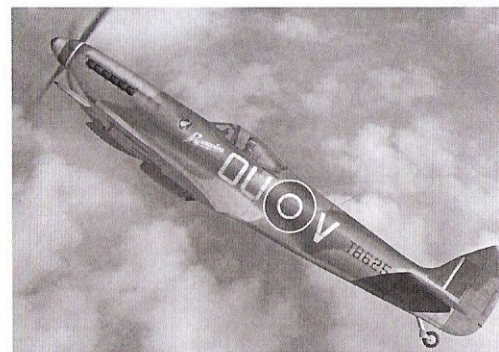
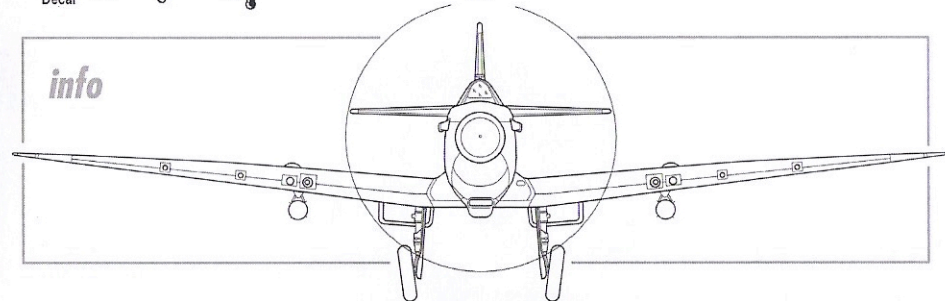

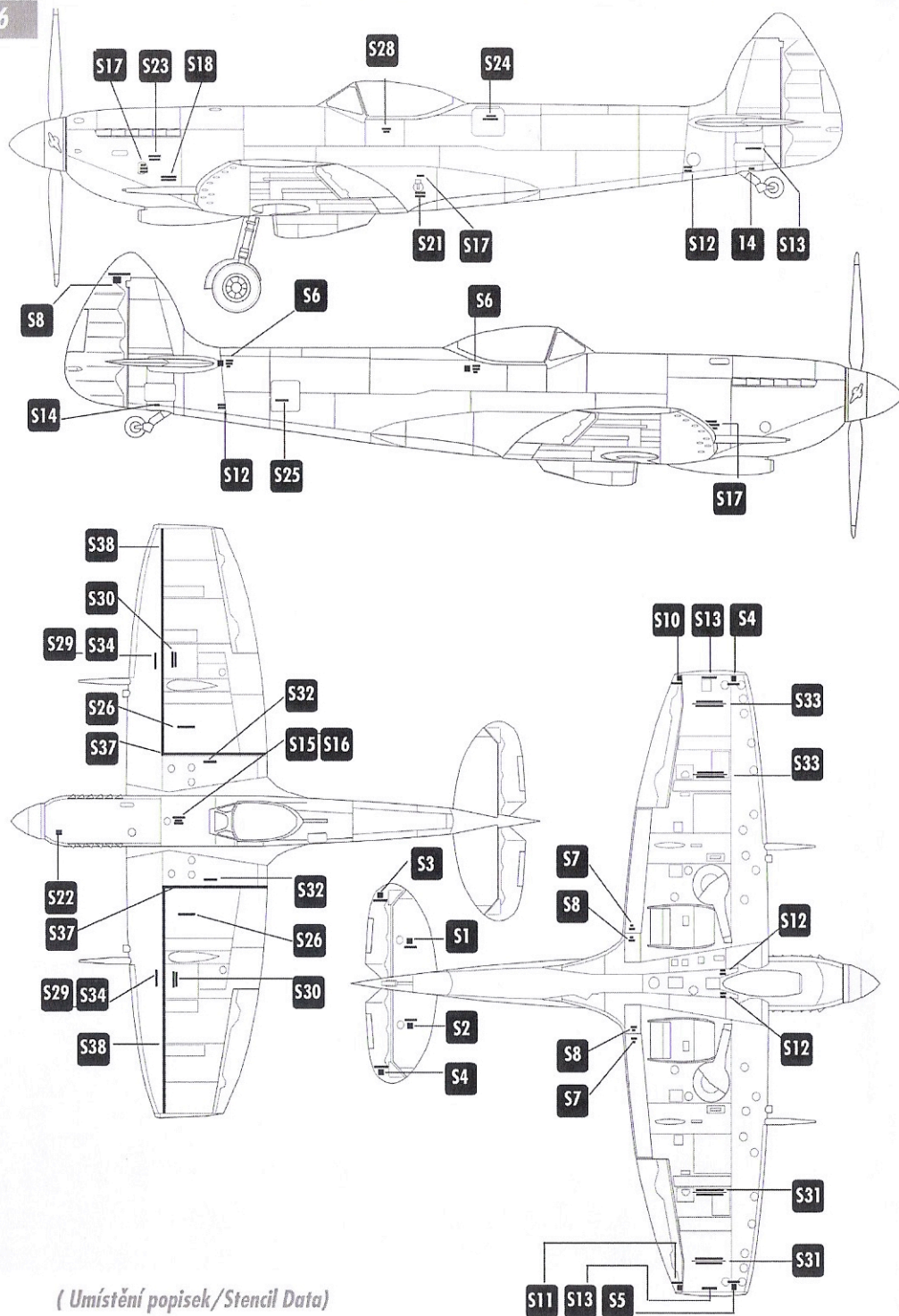

(Umístění popisek/Stencil Data)

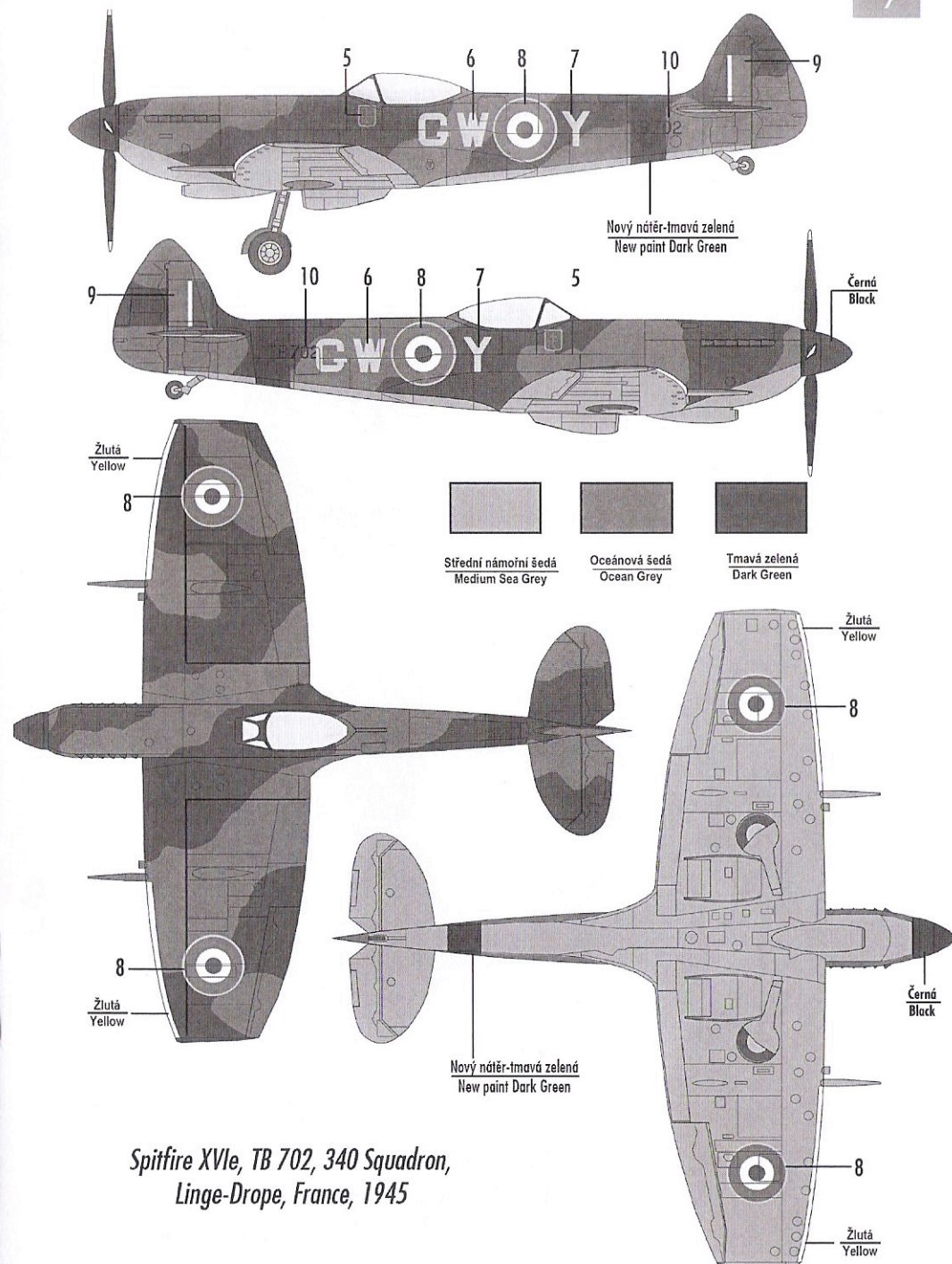

Spitfire XVI, TB 702, 340 Squadron,
Linge-Drope, France, 1945

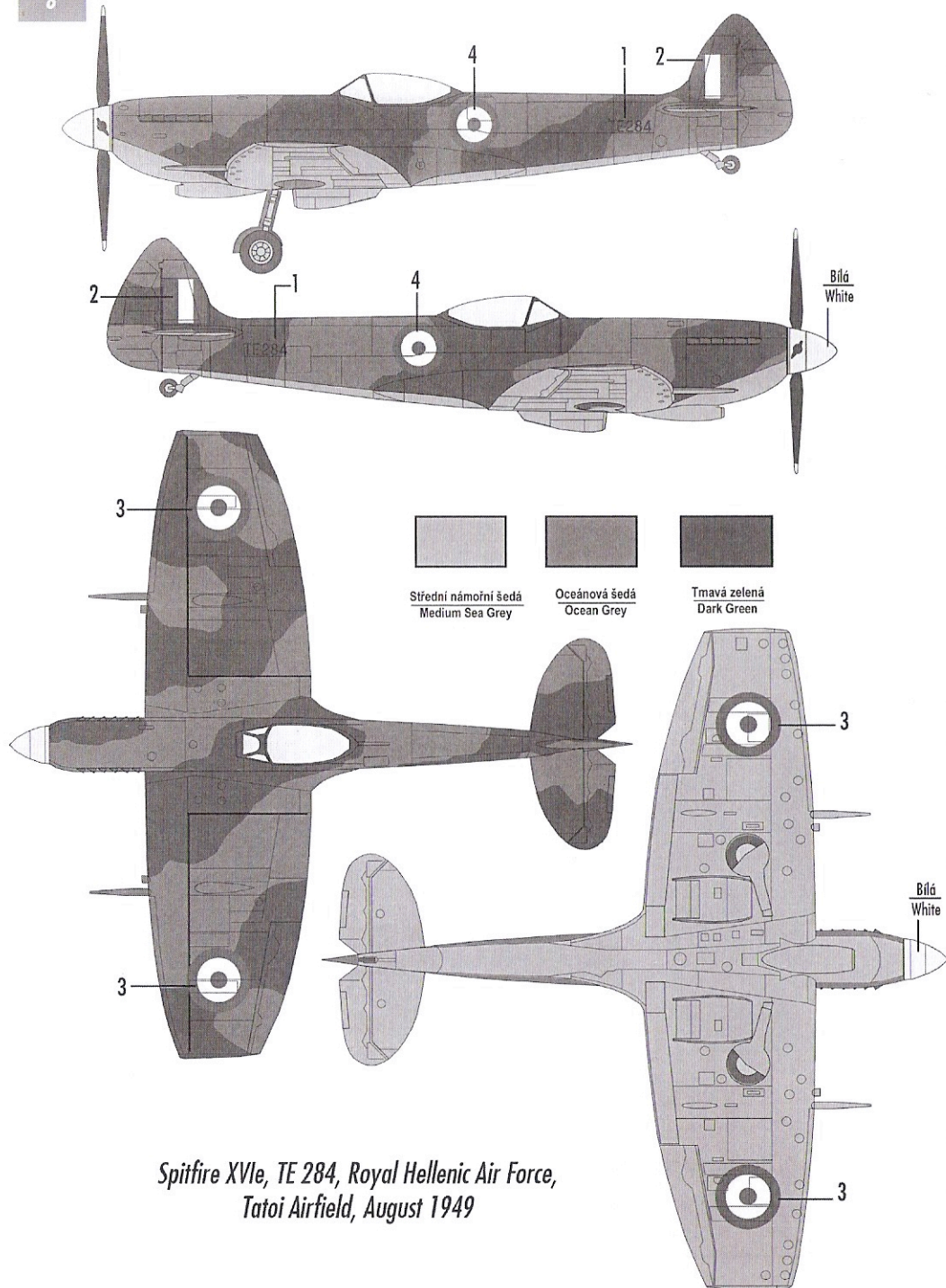

*Spitfire XVI, TE 284, Royal Hellenic Air Force,
Tatoi Airfield, August 1949*

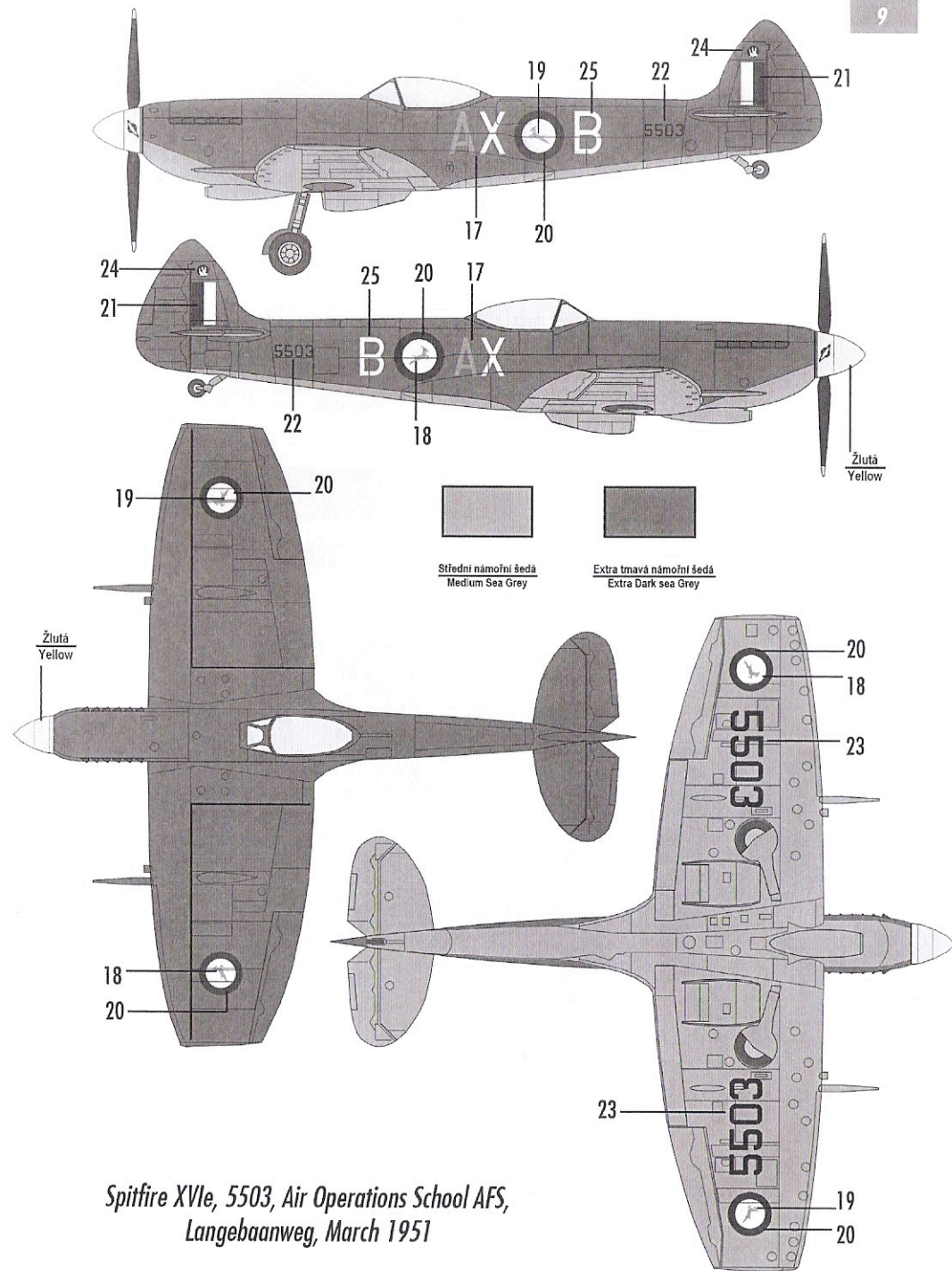

*Spitfire XVI, 5503, Air Operations School AFS,
Langebaanweg, March 1951*

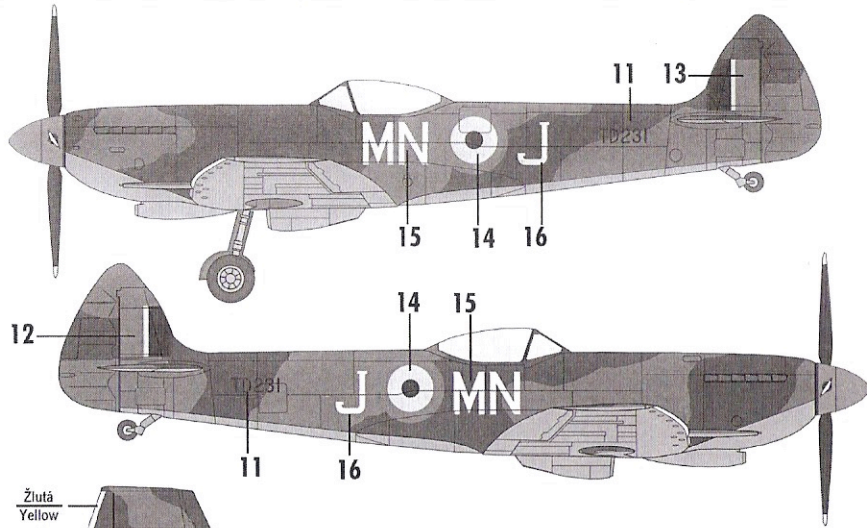

Žlutá
Yellow

Nový nátěr
New paint

14



Sředi ní námořní šedá
Medium Sea Grey



Oceánová šedá
Ocean Grey



Tmavá zelená
Dark Green

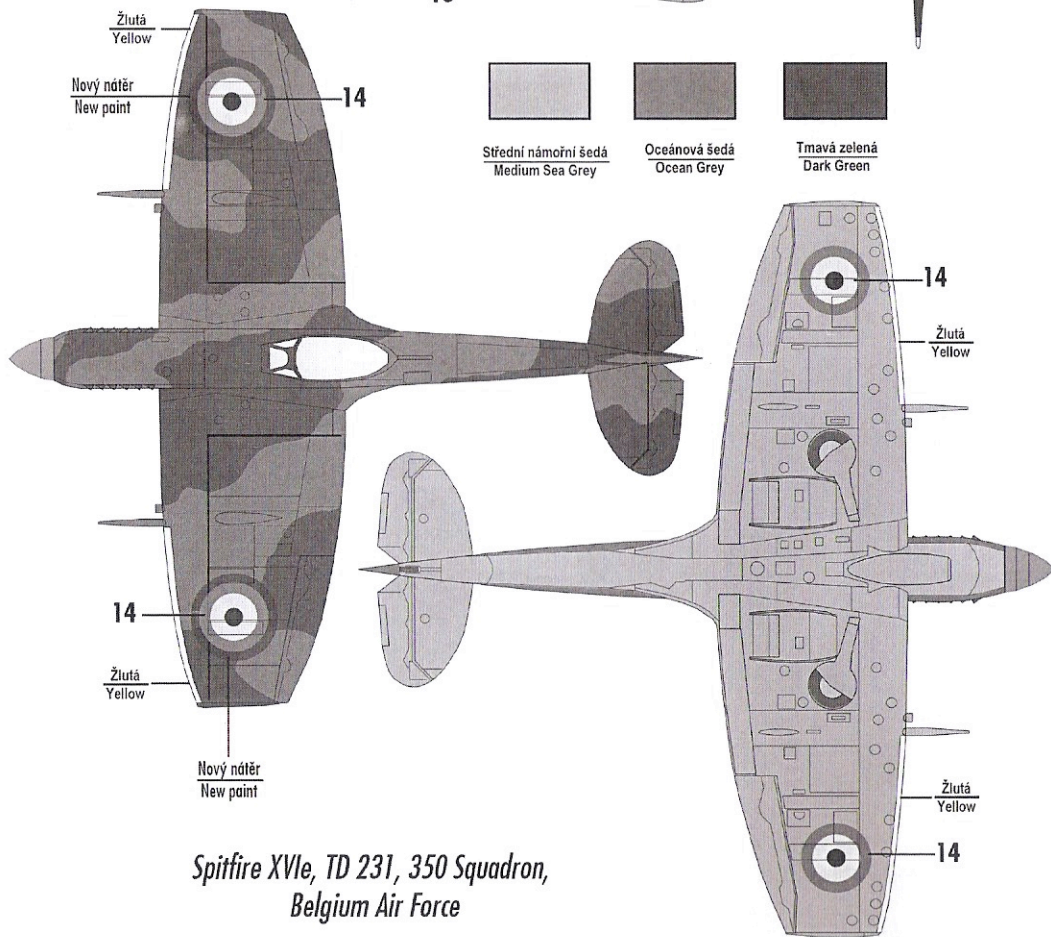

14

Žlutá
Yellow

Žlutá
Yellow

14

*Spitfire XVI, TD 231, 350 Squadron,
Belgium Air Force*

Supermarine Spitfire XVIe in International services



*Spitfire XVIe, TB 702, 340 Squadron,
Linge-Drope, France, 1945*

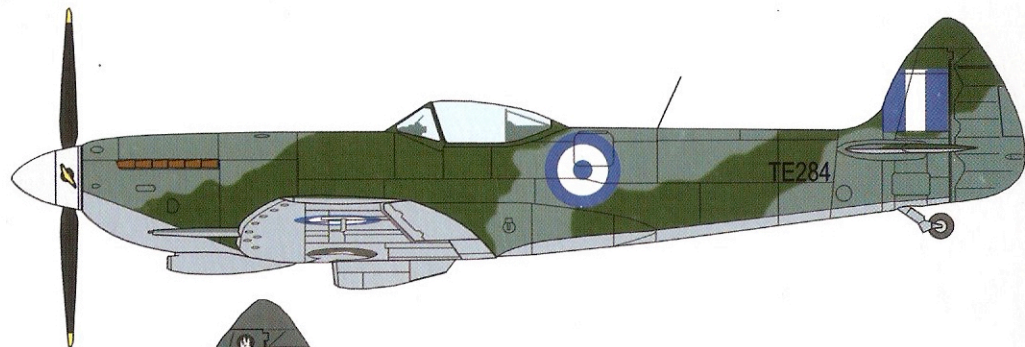

*Spitfire XVIe, TE 284, Royal Hellenic Air Force,
Tatoi Airfield, August 1949*



*Spitfire XVIe, 5503, Air Operations School AFS,
Langebaanweg, March 1951*

*Spitfire XVIe, TD 231, 350 Squadron,
Belgium Air Force*

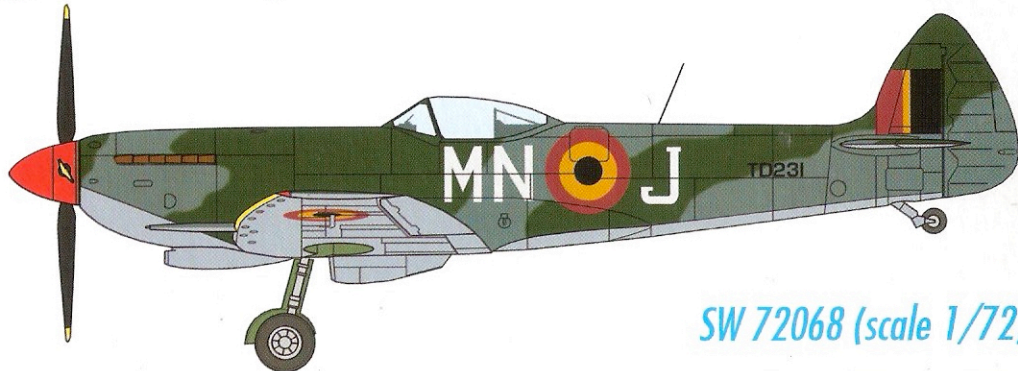

SW 72068 (scale 1/72)