

F4U 海盗

VOUGHT F4U CORSAIR

8+

SCALE MODELS 1/49

NO. 5

F4U“海盗”(F4U Corsair)战斗机是美国沃特公司为美国海军所研发的一种舰载战斗机。F4U战斗机加速性能好,火力强大,爬升快,坚固耐用,是美国第一种速度超过640千米/时的战斗机,也是速度最快的活塞式战斗机之一。其机翼独具一格的设计使得其与其他同类飞机相比显得很另类。“海盗”除空战外,亦担当战术轰炸机的角色。机翼采用了倒海鸥翼的布局。F4U采用了当时出力最大的活塞发动机“普惠公司”R-2800,功率达到2000马力,而同期的军机多数的引擎只有1000马力。

翼展:	12.5m	长度:	10.3m
高度:	4.90m	翼面积:	29.17平方米
空重:	4175.3kg	起飞重量:	5633.6kg
最大起飞重量:	6654.2kg	最大速度:	717.75km/h
最大飞行高度:	12,649.2m	最大飞行距离:	2,510.5km

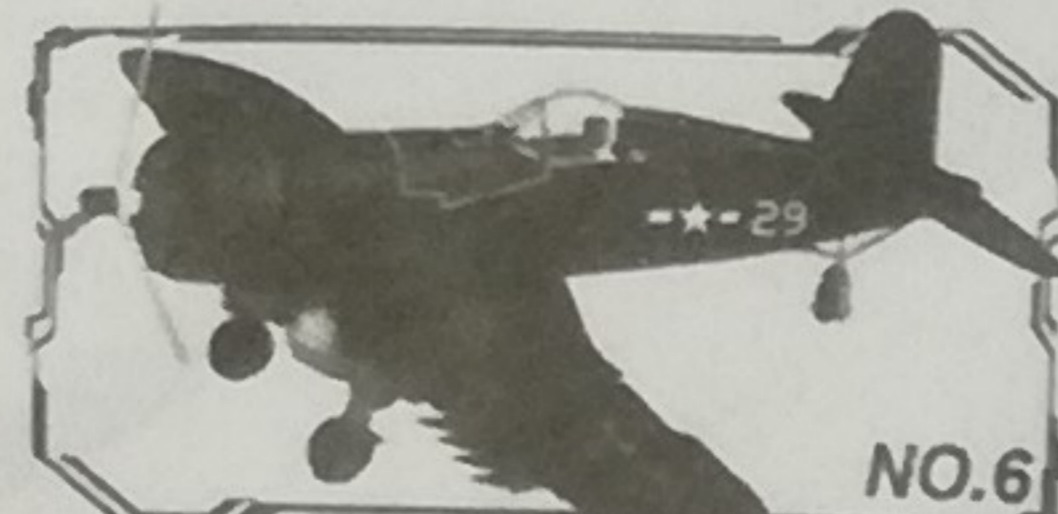
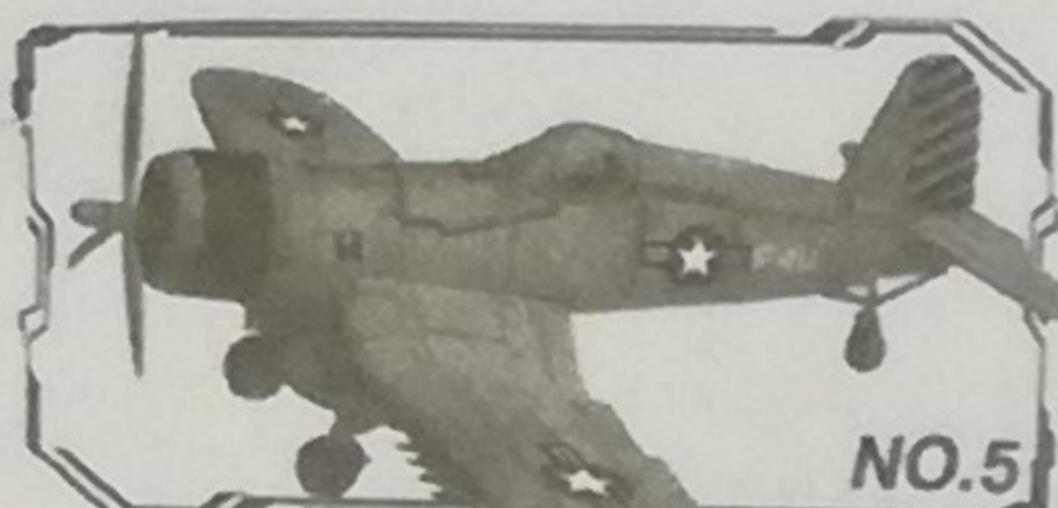
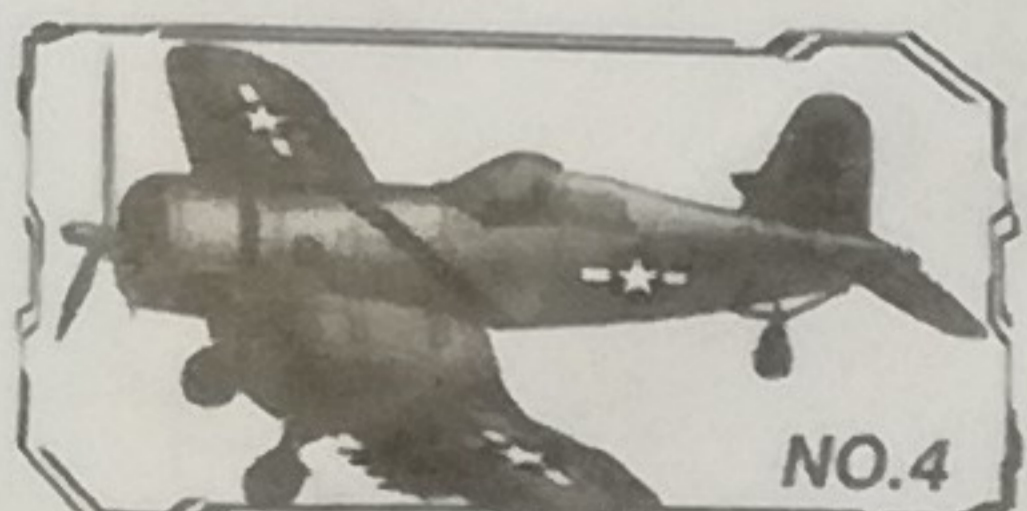
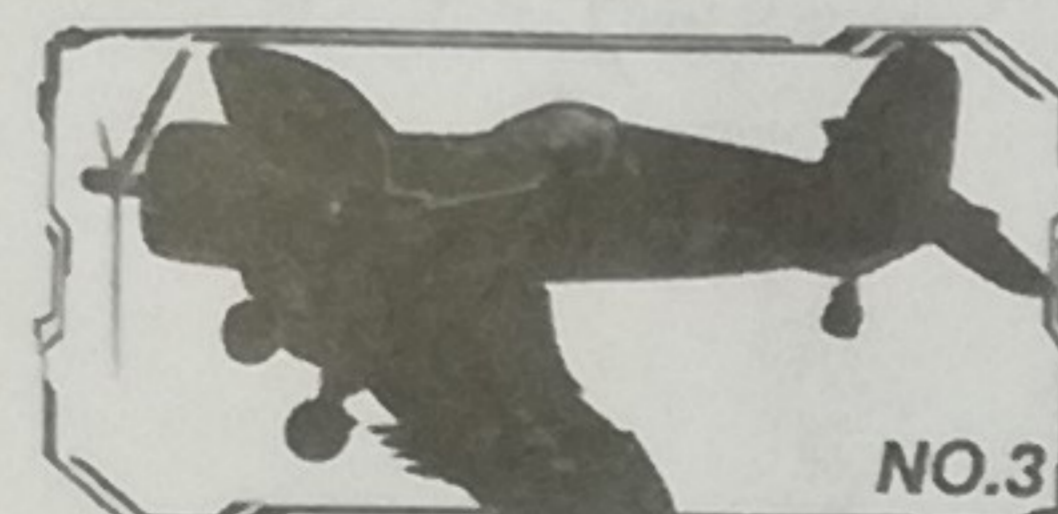
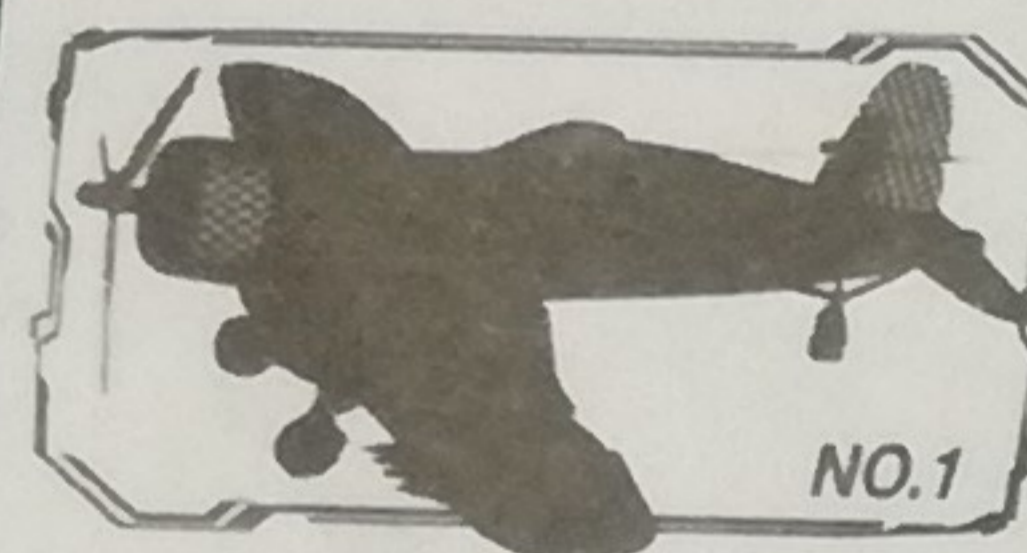

粘贴水贴纸时,请先对准要贴的部位,再轻轻撕开保护膜进行粘贴。粘贴水贴纸时,尽量以按压的方式进行,请勿对水贴纸大力刮动,以免造成水贴纸内部图案撕裂,影响模型的美观!

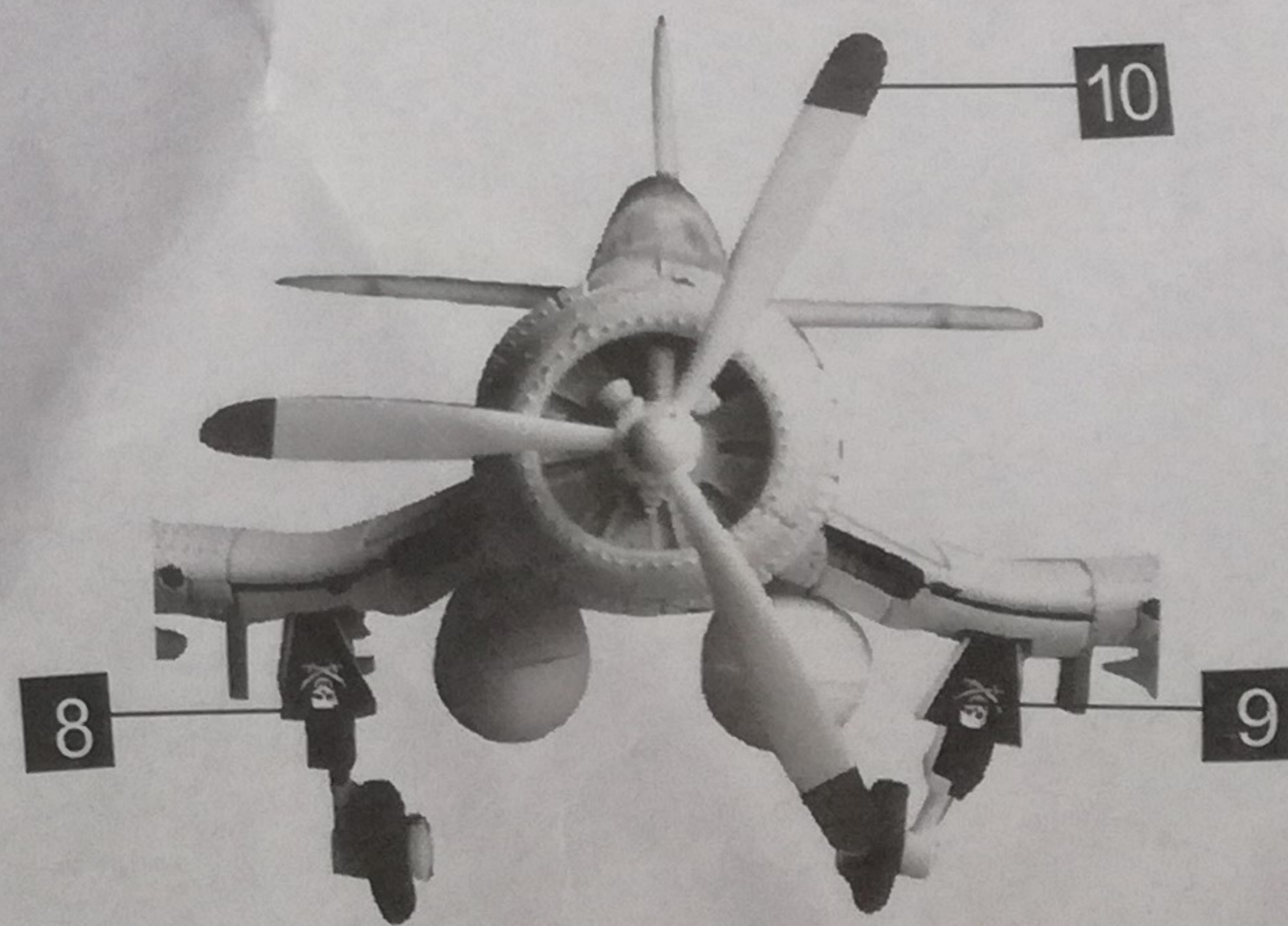
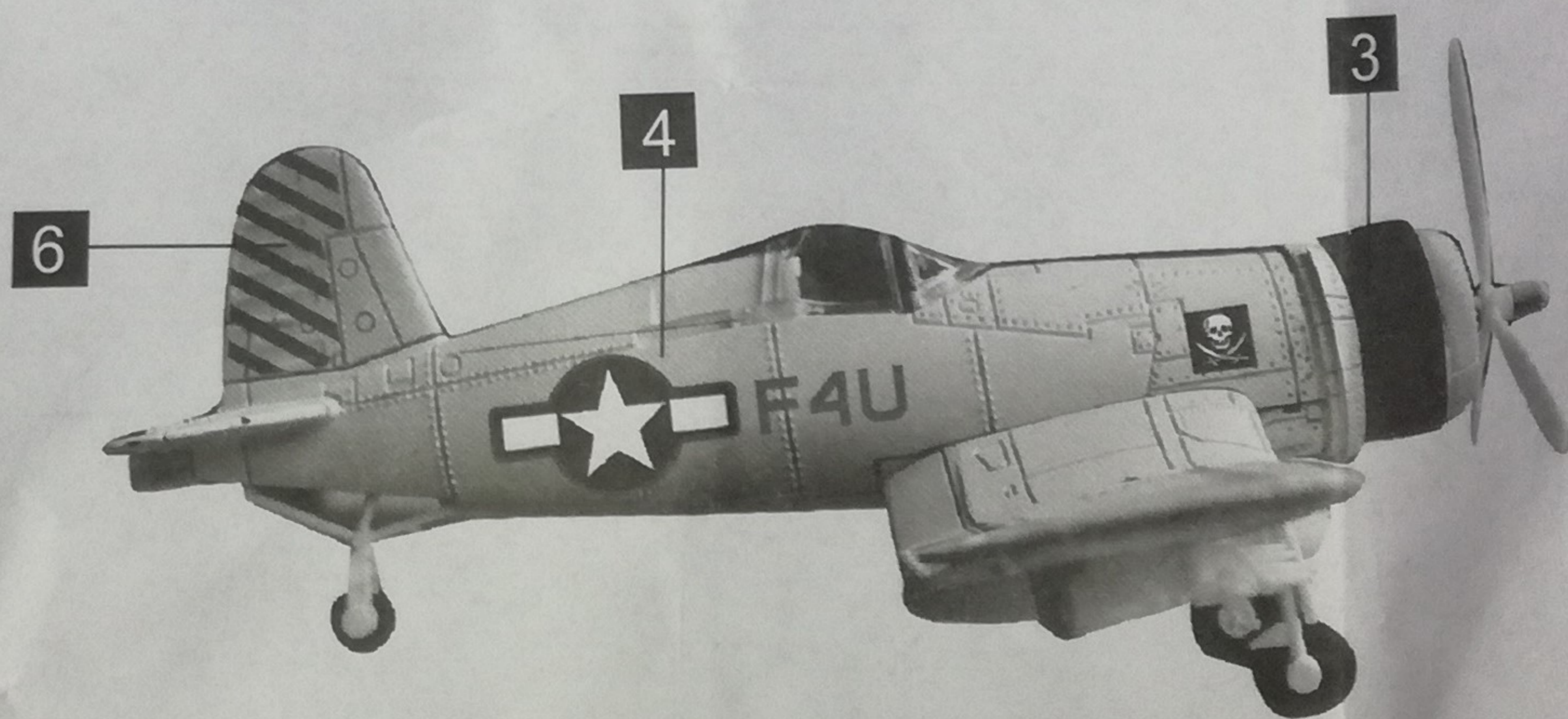
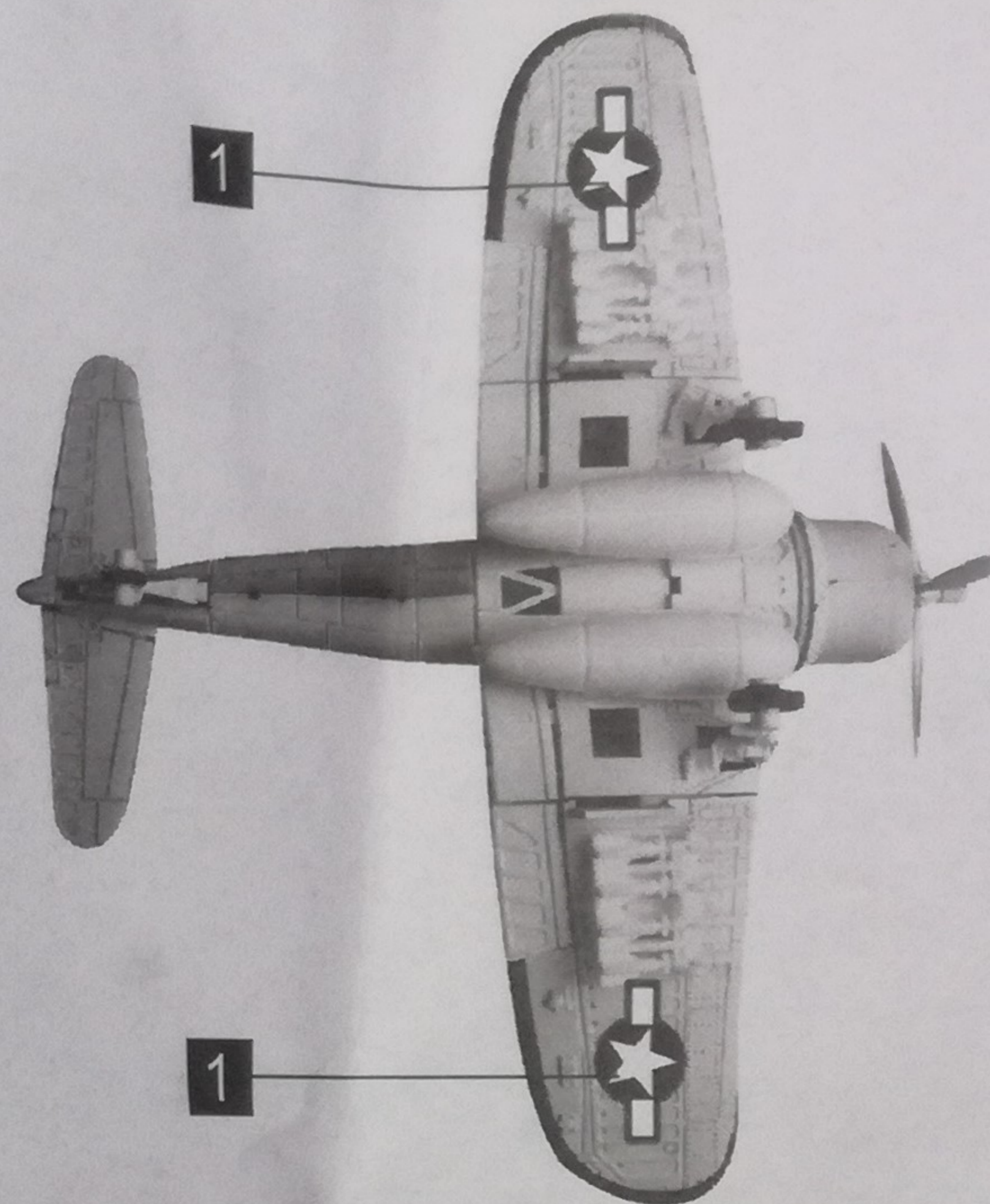
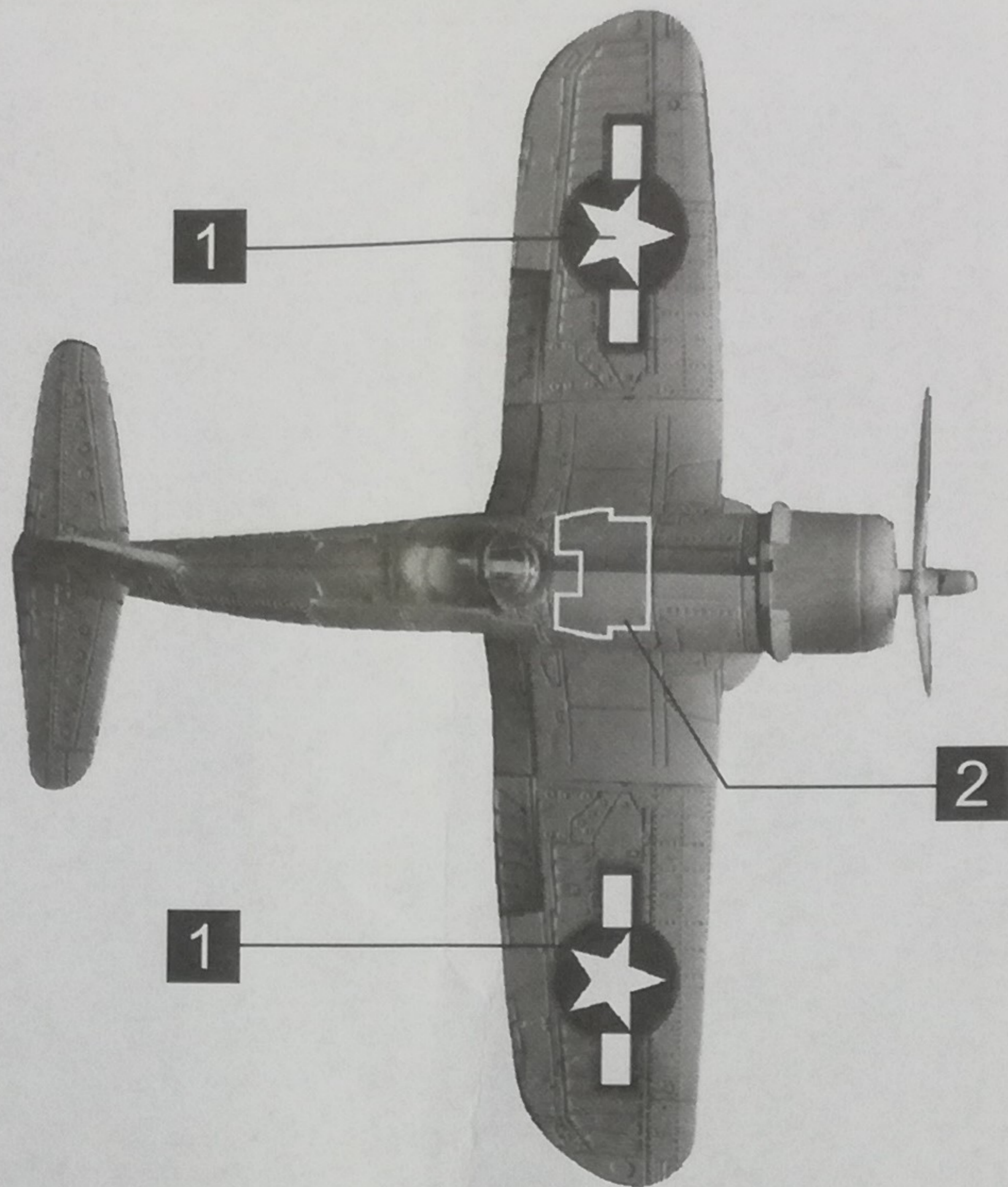

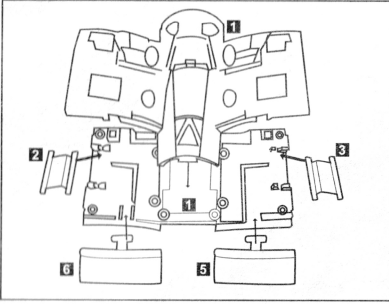

部件完成

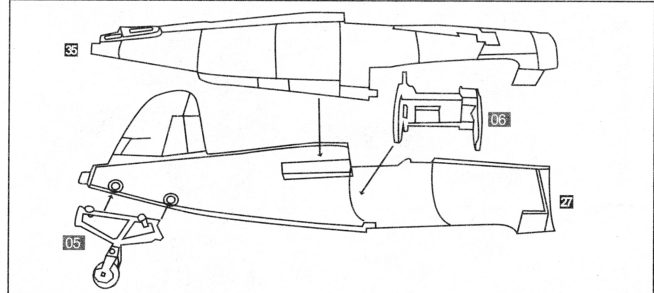
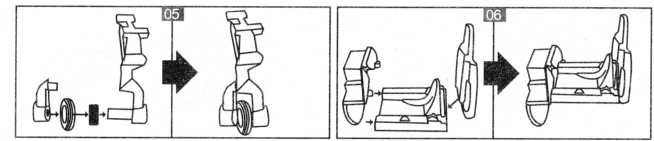
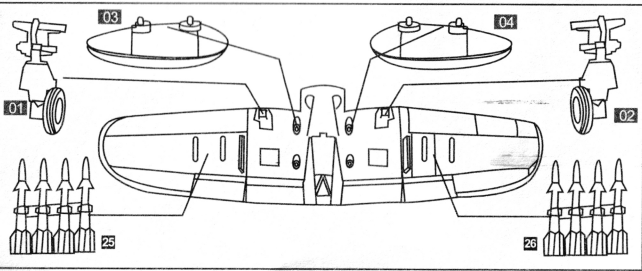
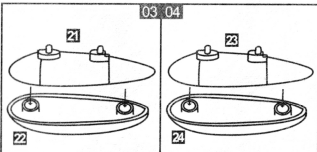
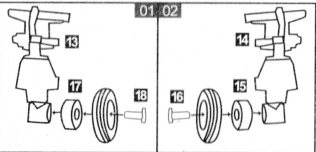
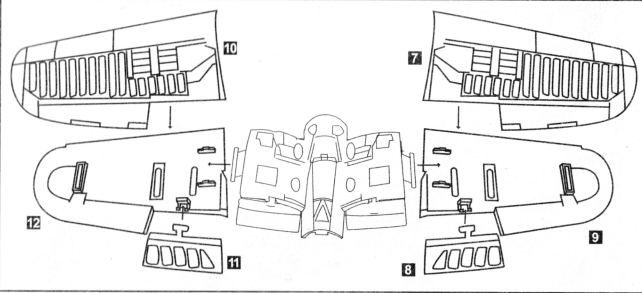
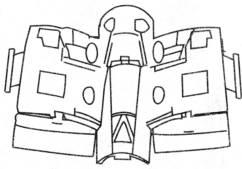

部件完成

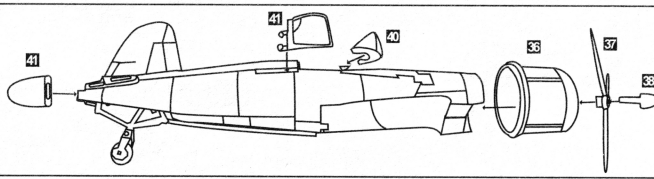
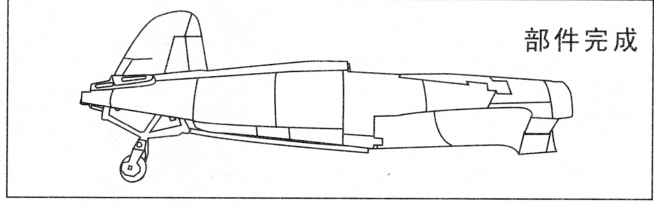

部件完成

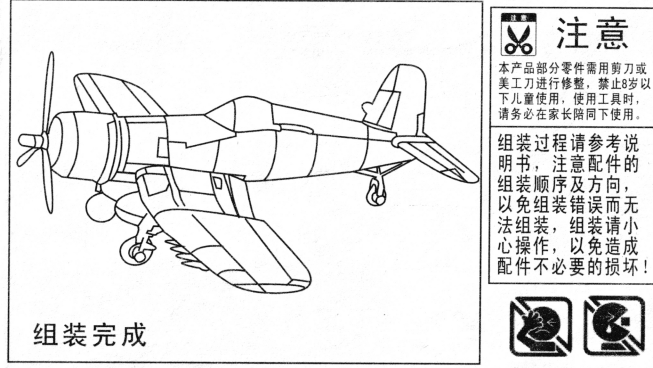
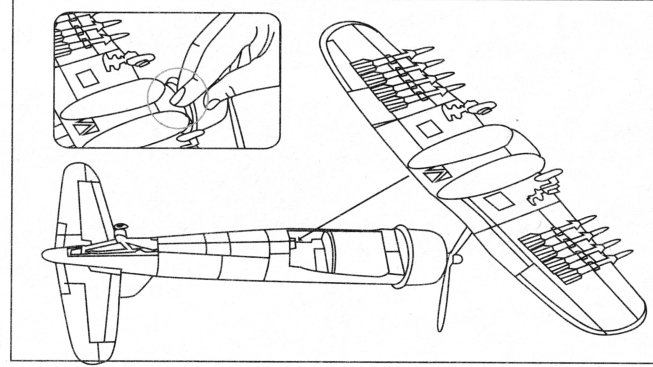
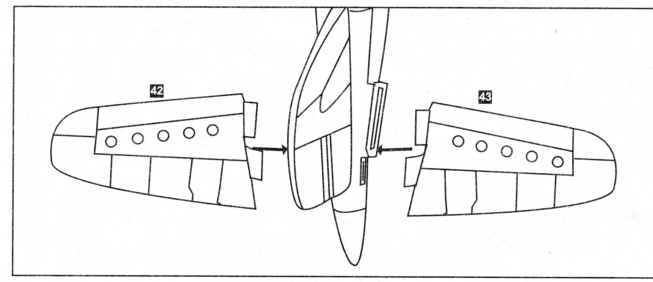
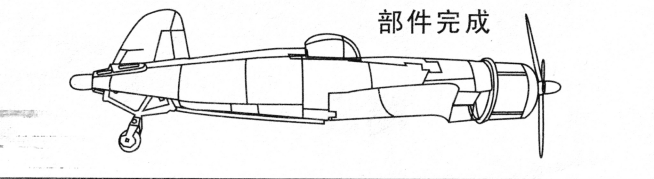

组装完成

注意

本产品部分零件需用剪刀或美工刀进行修整，禁止8岁以下儿童使用，使用工具时，请务必在家长陪同下使用。

组装过程请参考说明书，注意配件的组装顺序及方向，以免组装错误而无法组装，组装时请小心操作，以免造成不必要的配件损坏！

