

Fiat G.50 bis/AS

72049

Made in Czech Republic



1/72

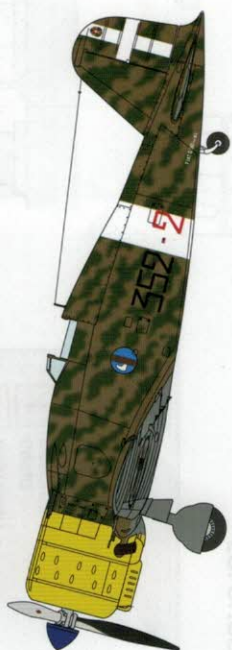

| | | | | |
|-------------|-----------------|-----------------|----------------|--------|
| White | Grigio Mimetico | Giallo Mimetico | Verde Mimetico | Blue |
| RC 004 | RC 247 | RC 225 | RC 027 | RC 010 |
| C062 | C317 | C310 | C017 | C003 |
| Humbrol 130 | 154 | 118 | 116 | 62 |
| | 140 | 118 | 116 | 246 |
| | | | | 247 |
| | | | | 248 |
| | | | | 249 |
| | | | | 250 |
| | | | | 251 |
| | | | | 252 |
| | | | | 253 |
| | | | | 254 |
| | | | | 255 |
| | | | | 256 |
| | | | | 257 |
| | | | | 258 |
| | | | | 259 |
| | | | | 260 |
| | | | | 261 |
| | | | | 262 |
| | | | | 263 |
| | | | | 264 |
| | | | | 265 |
| | | | | 266 |
| | | | | 267 |
| | | | | 268 |
| | | | | 269 |
| | | | | 270 |
| | | | | 271 |
| | | | | 272 |
| | | | | 273 |
| | | | | 274 |
| | | | | 275 |
| | | | | 276 |
| | | | | 277 |
| | | | | 278 |
| | | | | 279 |
| | | | | 280 |
| | | | | 281 |
| | | | | 282 |
| | | | | 283 |
| | | | | 284 |
| | | | | 285 |
| | | | | 286 |
| | | | | 287 |
| | | | | 288 |
| | | | | 289 |
| | | | | 290 |
| | | | | 291 |
| | | | | 292 |
| | | | | 293 |
| | | | | 294 |
| | | | | 295 |
| | | | | 296 |
| | | | | 297 |
| | | | | 298 |
| | | | | 299 |
| | | | | 300 |

PLASTIC PARTS

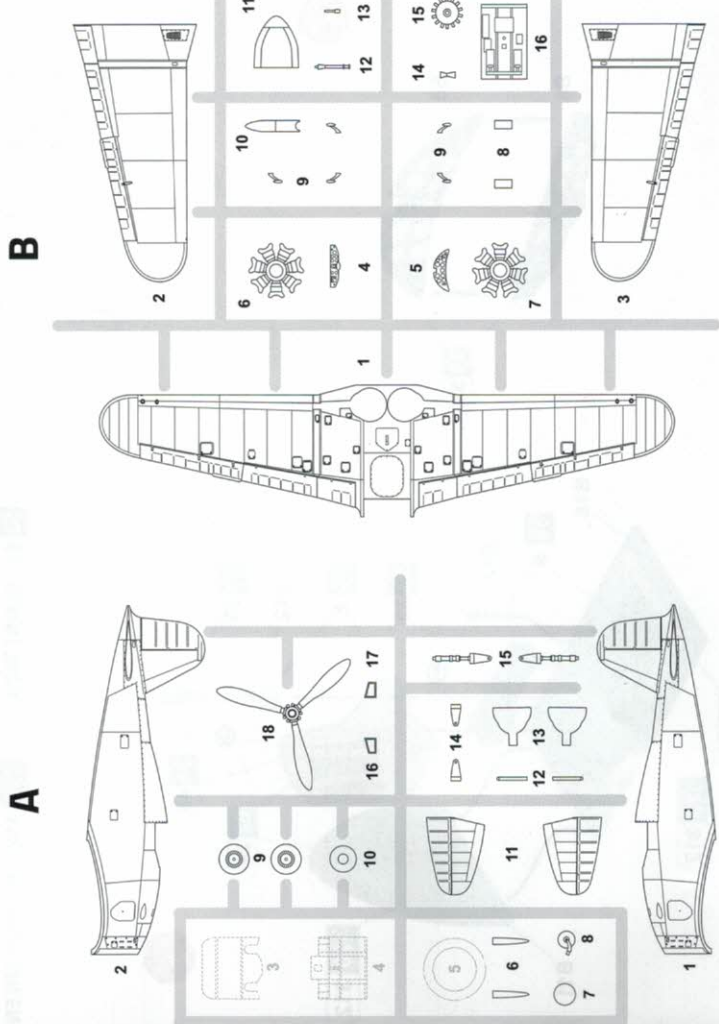

Fiat G.50 bis AS of JG 107 known as Jagd Fliegerschule 7 (No.7 Fighter School), Luftwaffe, Toul - France, January 1944.

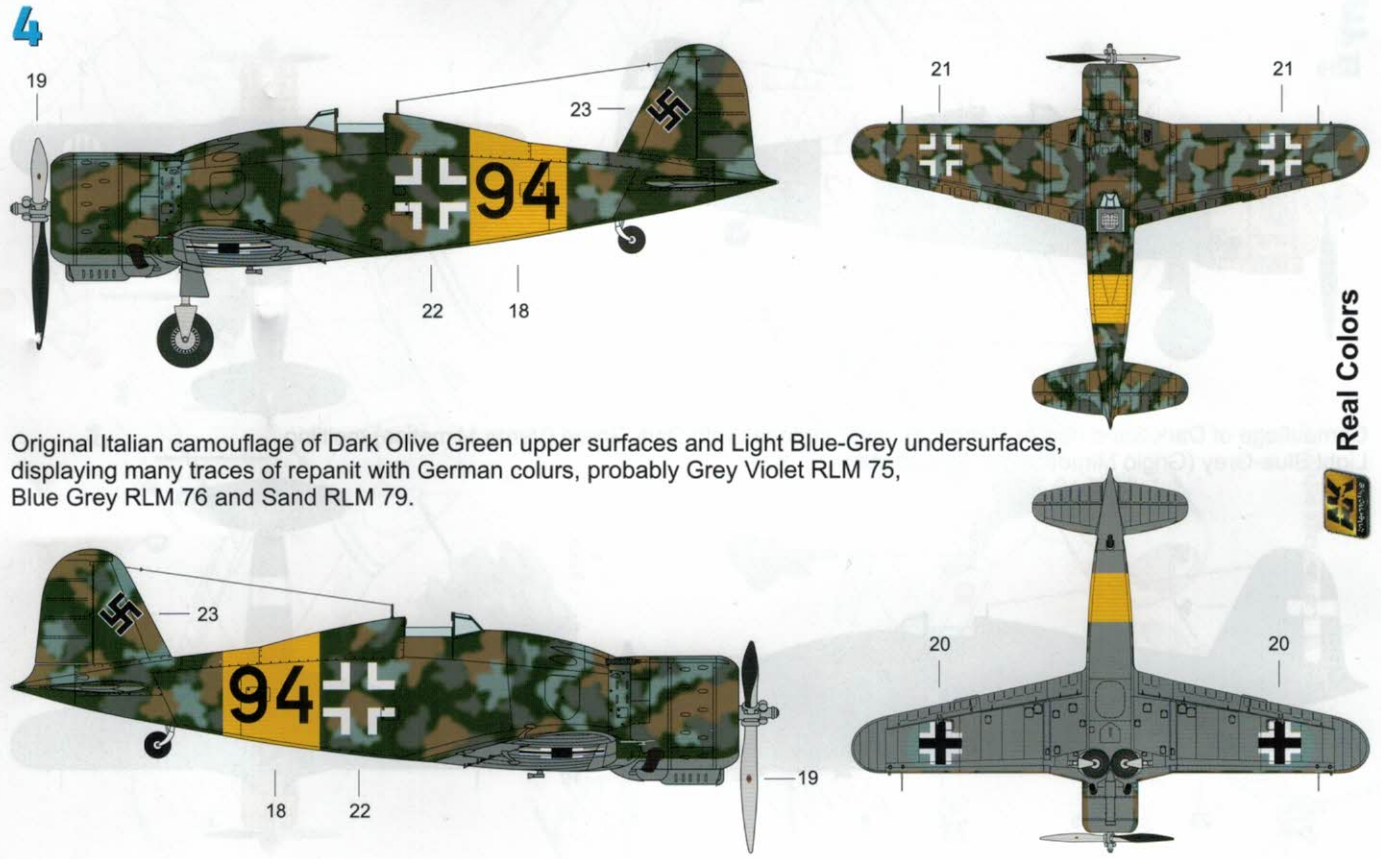

Original Italian camouflage of Dark Olive Green upper surfaces and Light Blue-Grey undersurfaces, displaying many traces of repainting with German colours, probably Grey Violet RLM 75, Blue Grey RLM 76 and Sand RLM 79.

Real Colors

RESIN PARTS

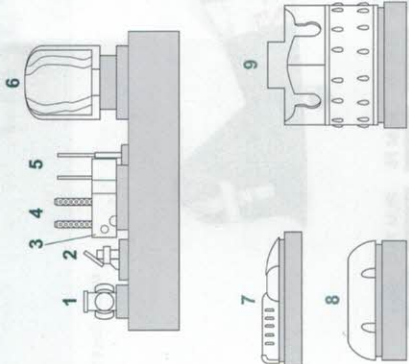

LEGEND

| | | | |
|--|---|--|------------------|
| | SYMMETRICAL ASSEMBLY SYMETRICKÁ MONTÁŽ | | OPTION VOLBA |
| | REMOVE ODSTRANIT | | DECAL OBTISK |
| | GRIND OBROUSIT | | COLOR BARVIT |
| | DRILL HOLE VRTAT OTVOR | | ENGRAVE VVYŘT |
| | BEND OHNOUT | | |

COLOURS

| Humbrol | Mr.Color | |
|---------|----------|----------------|
| 2 | 6 | GLOSS GREEN |
| 11 | 90 | SILVER |
| 19 | 3 | GLOSS RED |
| 33 | 33 | FLAT BLACK |
| 53 | 61 | BURNT IRON |
| 56 | 8 | ALUMINIUM |
| 62 | 29 | LEATHER |
| 74 | 45 | LINEN |
| 113 | 41 | RUST |
| 120 | 312 | INTERIOR GREEN |

CELAR PARTS

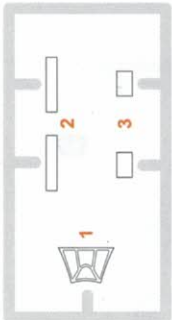

STEP 3

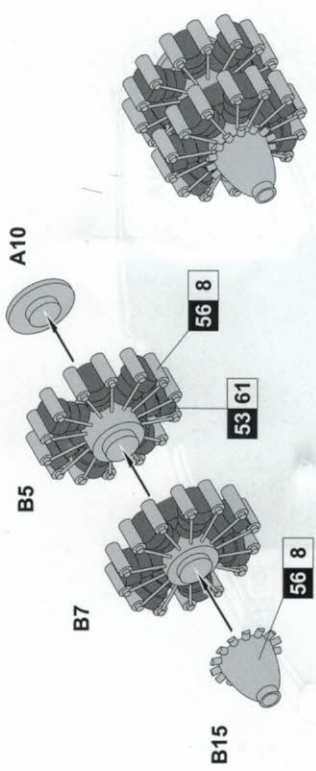

STEP 4

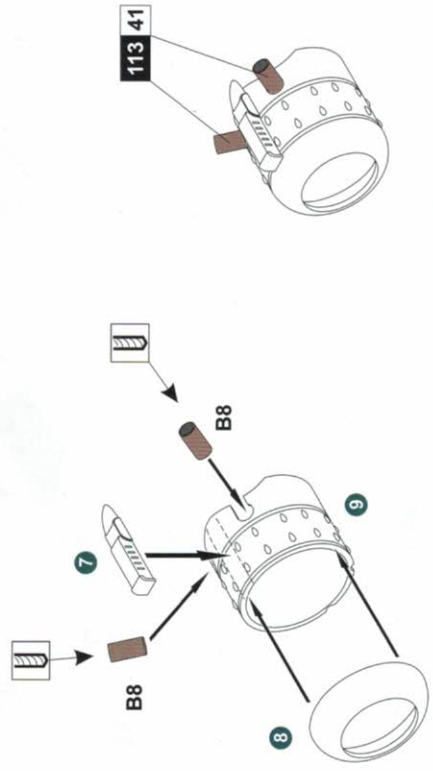

STEP 2

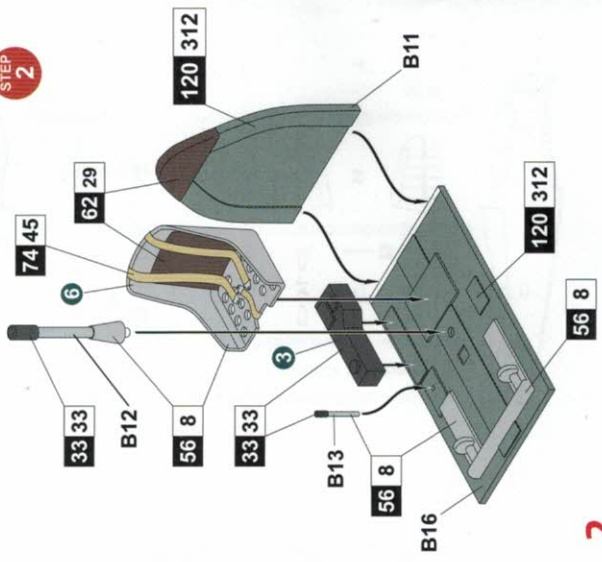

STEP 5

For camouflage scheme 1, 2, 3 For camouflage scheme 4 only Propeler colours

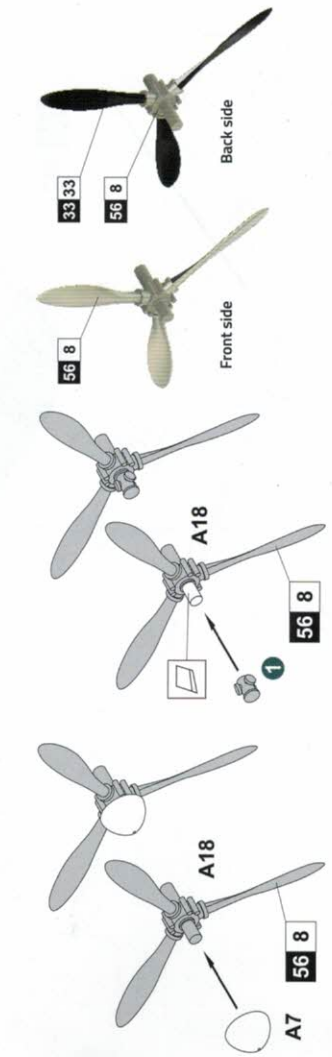

STEP 1

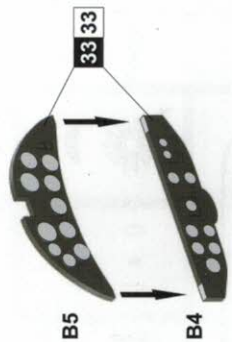

2

3

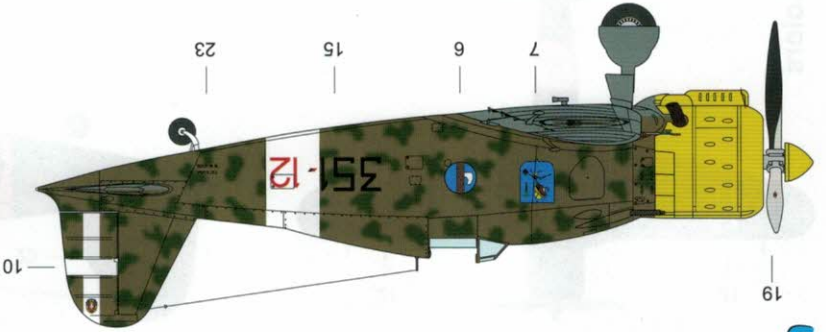
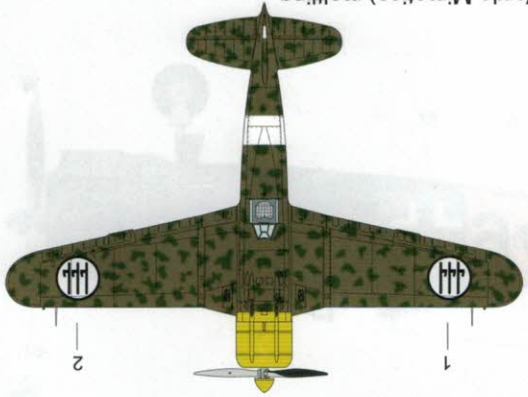
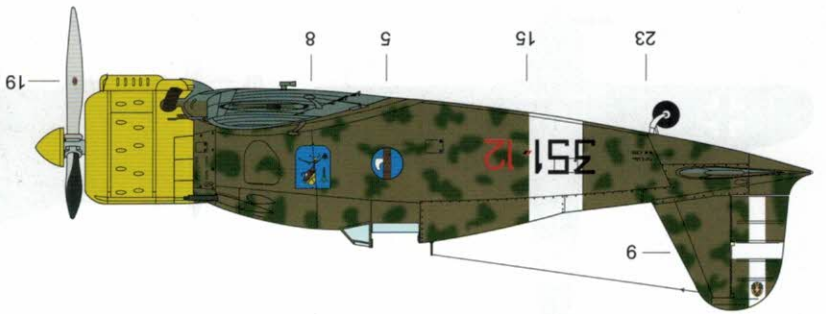
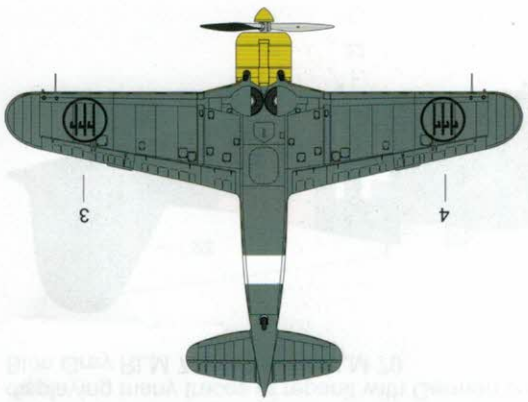

Fiat G.50 bis AS, MM. 6385/351-12 of the 15° Gruppo Autonomo, Dema, April 1941.

Camouflage of Dark Sand (Giallo Mimetico) upper surfaces with Dark Green (Verde Mimetico) mottling.

Light Blue-Grey (Grigio Mimetico) undersurfaces.

3

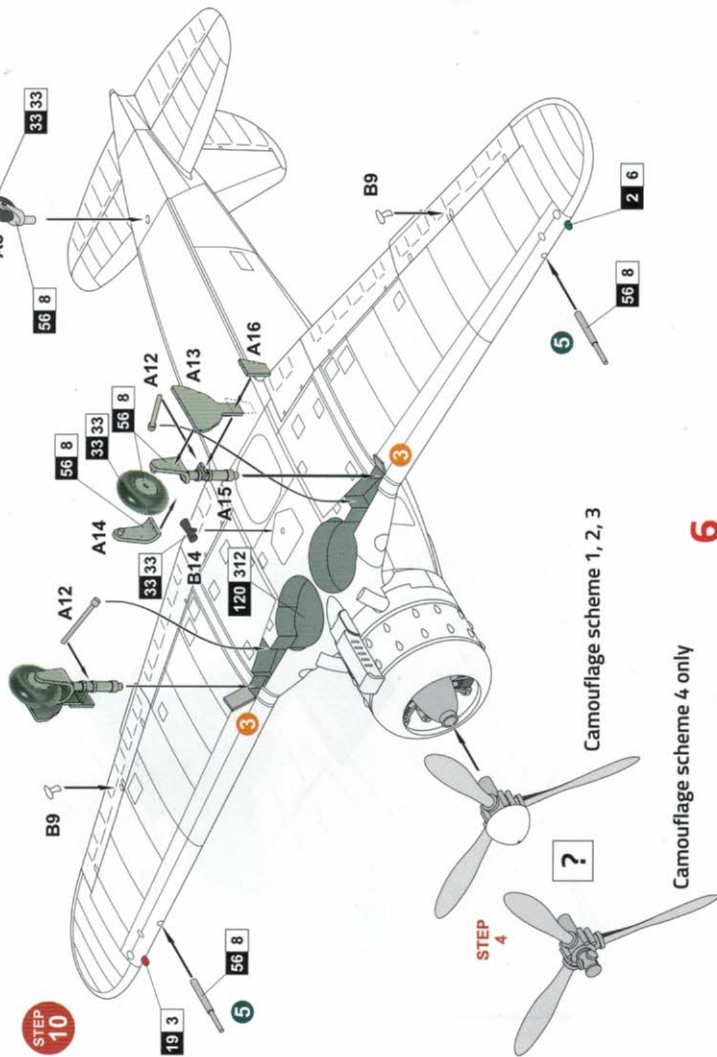
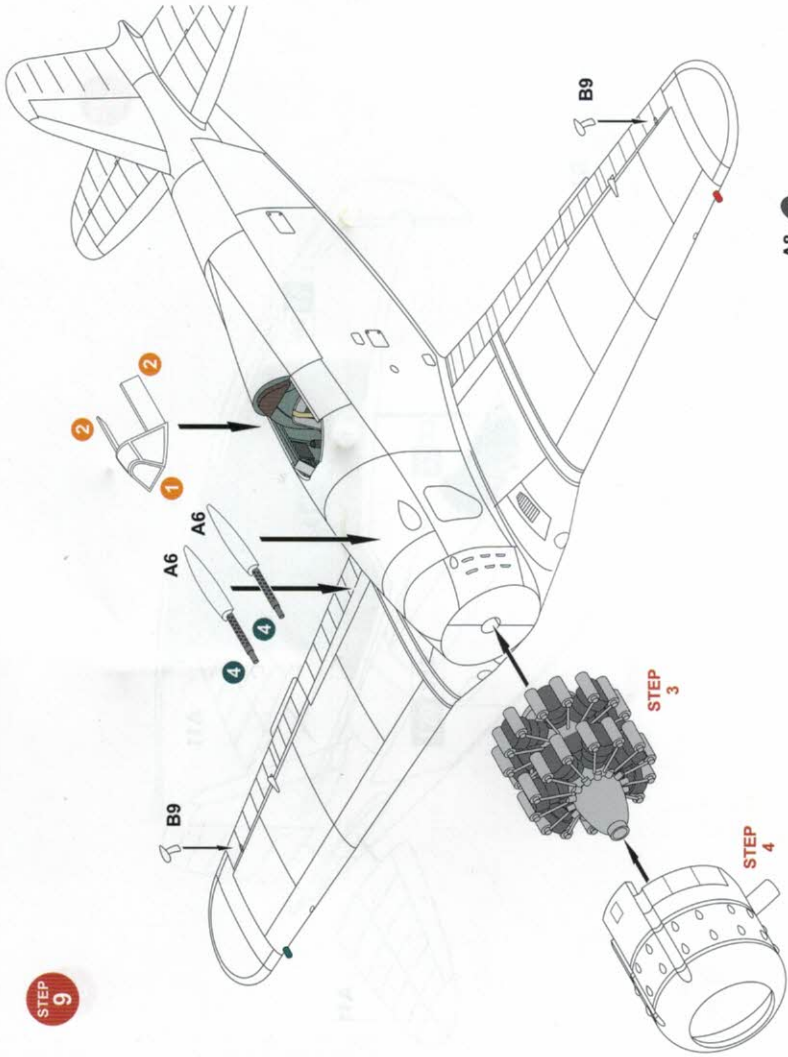

Camouflage scheme 1, 2, 3

Camouflage scheme 4 only

6

STEP 9

STEP 10