

intro

The MiG-21 was one of a long list of Mikoyan-Gurevich products to be integrated into the armed forces of the Soviet Union, the Warsaw Pact, and allied client states. Its predecessors included such notable types as the MiG-15, MiG-17 and the supersonic MiG-19. The roots of this project reach back to the first half of the fifties. In 1954, the Ye-1 project came to an end, and was quickly picked up by the Ye-2. Both had a swept wing. The first machine to feature the delta wing was the Ye-4, which first took to the air on June 16th, 1955. It was also demonstrated a year later at the Moscow airfield Tushino. The first of the new line to enter production was the MiG-21F, which together with the MiG-21P and F-13 represented the first generation of the MiG-21, and was in production through the end of the fifties and the beginning of the sixties. Subsequent versions included the PF, FL, PFM, R the production of which peaked at the end of the sixties. The third generation started production in 1968, which included such versions as M, SM, MF, SMT, bis among others. Simultaneously, two-seat training versions were also produced designated MiG-21U, UM and US. Production of the MiG-21 ended in 1985, and was put into service with some fifty nations. Over the course of the cold war, the opponents of the MiG-21 included the likes of the Northrop F-5 Freedom Fighter and the Dassault Mirage III. NATO assigned it the reporting name 'Fishbed'. It became the most produced supersonic fighter in terms of quantity. The new machines came off Soviet production lines in Moscow, Gorky and Tbilisi. The MiG-21F-13 was also built under license in Czechoslovakia and the MiG-21FL, M and bis in India by Hindustan Aeronautics Ltd. The Soviet Union produced 10,645 examples of all versions, 194 were built in Czechoslovakia and 657 in India. Outside of the Soviet Union, the type flew with a long list of nations on all continents with the exception of Australia. The MiG-21 participated in combat in Vietnam, the Indo-Pakistan wars, the Cuban participation in Angola and in the Arab world's attempt to eliminate Israel. Thanks to the high volume of use, the highest number of aces produced on the type was in Vietnam. The top of the ladder is occupied by Nguyen Van Coc with nine kills. The type serving as a interceptor served with the Soviet Union and other nations of the Warsaw Pact into the eighties, when it began to be displaced by the MiG-29 Fulcrum.

This kit allows you to build a model of the MiG-21MF that was built in the factory in Moscow between 1969 and 1974 (around 1300 units having been produced) and represented the most common variant of this sub-type. Later production airframes built at Gorky (between 1975 and 1976), differed in many details from the aircraft built at Moscow. The vast majority of exported aircraft came from the Moscow production facility. At first, these left the factory in natural metal and from 1973 in camouflage schemes specific to the client state. The MiG-21SM was at first sight virtually identical to the MiG-21MF, only differing in the better RP-22 radar unit. This version was used exclusively by the Soviet Union and was never cleared for export.

MiG-21MFs were powered by Tumanskij R-13-300 turbojet engine with additional combustion chamber and carried an RP-21 radar. The armament constituted of a twin-barreled GSch-23-2L 23mm autocannon with 200 rounds of ammunition. The racks carried a combination of FAB bombs with 500kg warhead, UB-16-57U launchers and R-3S rockets, Ch-66, S-24, including R-60 air-to-air missile and its infrared homing variant R-60M. The NATO code for MiG-21MFs was "Fishbed-J".

PLASTIC PARTS

B>

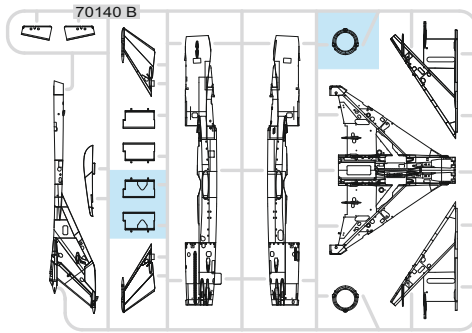

C>

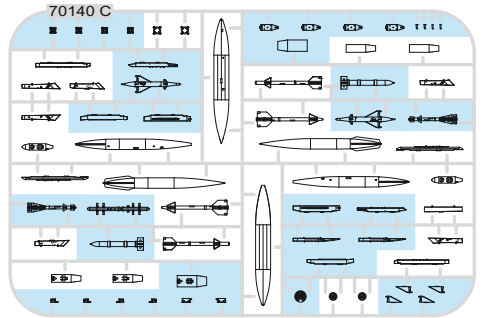

D>

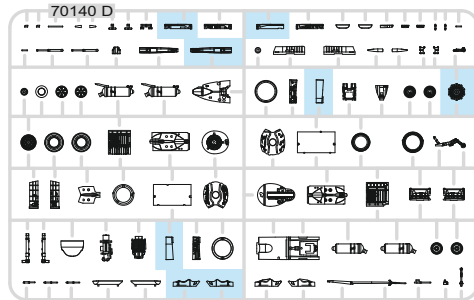

E>

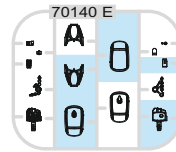

| GSI Creos (GUNZE) | | MISSION MODELS | |
|-------------------|----------|----------------|-----------------|
| AQUEOUS | Mr.COLOR | PAINTS | |
| H1 | C1 | MMP-001 | WHITE |
| H3 | C3 | MMP-003 | RED |
| H4 | C4 | MMP-007 | YELLOW |
| H5 | C5 | MMP-048 | BLUE |
| H6 | C6 | MMP-004 | GREEN |
| H11 | C62 | MMP-001 | FLAT WHITE |
| H12 | C33 | MMP-047 | FLAT BLACK |
| H26 | C66 | | BRIGHT GREEN |
| H51 | C11 | MMP-063 | LIGHT GULL GRAY |
| H53 | C13 | | NEUTRAL GRAY |
| H70 | C60 | MMP-056 | GRAY |

| GSI Creos (GUNZE) | | MISSION MODELS | |
|-------------------------|------------|----------------|---------------------|
| AQUEOUS | Mr.COLOR | PAINTS | |
| H77 | C137 | MMP-040 | TIRE BLACK |
| H81 | C55 | MMP-023 | KHAKI |
| H84 | C42 | | MAHOGANY |
| H80 | C47 | | CLEAR RED |
| H84 | C138 | | CLEAR GREEN |
| H318 | C318 | | RADOME |
| H332 | C332 | | LIGHT AIRCRAFT GRAY |
| H338 | C338 | MMP-116 | LIGHT GRAY |
| H413 | C113 | | YELLOW |
| H418 | C118 | MMP-055 | LIGHT BLUE |
| | C19 | | SANDY BROWN |
| | C391 | | INTERIOR GREEN |
| Mr.METAL COLOR | | METALLICS | |
| | MC213 | MMM-006 | STEEL |
| | MC214 | MMM-001 | DARK IRON |
| | MC218 | MMM-003 | ALUMINIUM |
| Mr.COLOR SUPER METALLIC | | METALLICS | |
| | SM205/SM06 | MMC-001 | SUPER CHROME SILVER |

-Parts not for use. -Teile werden nicht verwendet. -Pièces à ne pas utiliser. -Tyto díly nepoužívejte při stavbě. - 使用しない部品

ATTENTION * UPOZORNĚNÍ * ACHTUNG * ATTENTION

(GB)

Carefully read instruction sheet before assembling. When you use glue or paint, do not use near open flame and use in well ventilated room. Keep out of reach of small children. Children must not be allowed to suck any part, or pull vinyl bag over the head.

(CZ)

Před započatím stavby si pečlivě prostudujte stavební návod. Při používání barev a lepidel pracujte v dobře větrané místnosti. Lepidla ani barvy nepoužívejte v blízkosti otevřeného ohně. Model není určen malým dětem, mohlo by dojít k požití drobných dílů.

(D)

Vor dem Zusammenbau die Bauanleitung gut durchlesen. Kleber und Farben nicht in der Nähe von offenem Feuer verwenden und für eine ausreichende Belüftung sorgen. Den Bausatz von kleinen Kindern fernhalten. Vermeiden Sie, dass Kinder Bauteile in den Mund nehmen oder sich Plastiktüten über den Kopf ziehen.

(F)

lire soigneusement la fiche d'instructions avant d'assembler. Ne pas utiliser de colle ou de peinture à proximité d'une flamme nue, et aérer la pièce de temps en temps. Garder hors de portée des enfants en bas âge. Ne pas laisser les enfants mettre en bouche ou sucer les pièces, ou passer un sachet vinyl sur la tête.

INSTRUCTION SIGNS * INSTR. SYMBOLY * INSTRUKTION SINNBILDEN * SYMBOLES

OPTIONAL VOLBA

BEND OHNOUT

SAND BROUSIT

OPEN HOLE VYVRTAT OTVOR

SYMMETRICAL ASSEMBLY SYMETRICKÁ MONTÁŽ

REMOVE ODŘINOUT

REVERSE SIDE OTOČIT

APPLY EDUARD MASK AND PAINT
POUŽIT EDUARD MASK NABARVIT

1

H51 MMP (C91) (052) LIGHT GULL GRAY
H70 MMP (C60) (056) GRAY

- MARKING B
- MARKING A

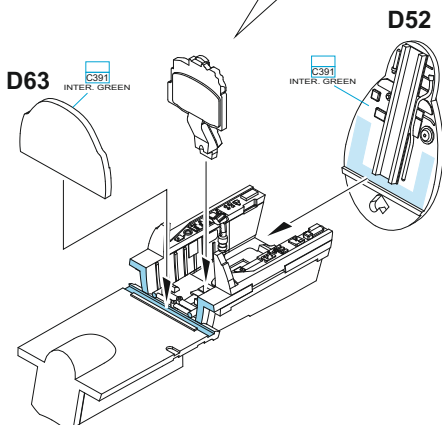
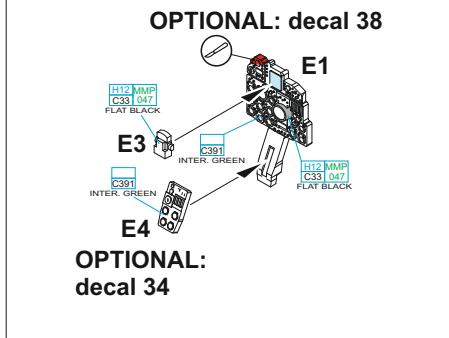
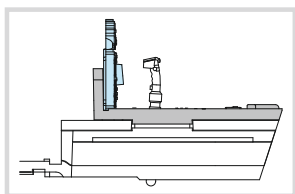
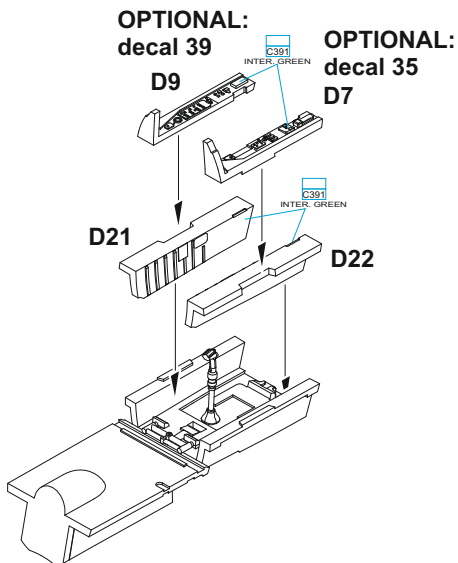
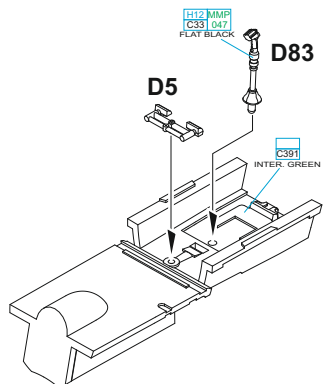
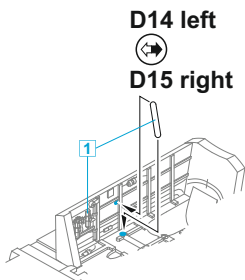
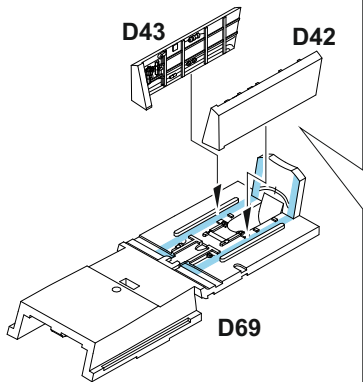

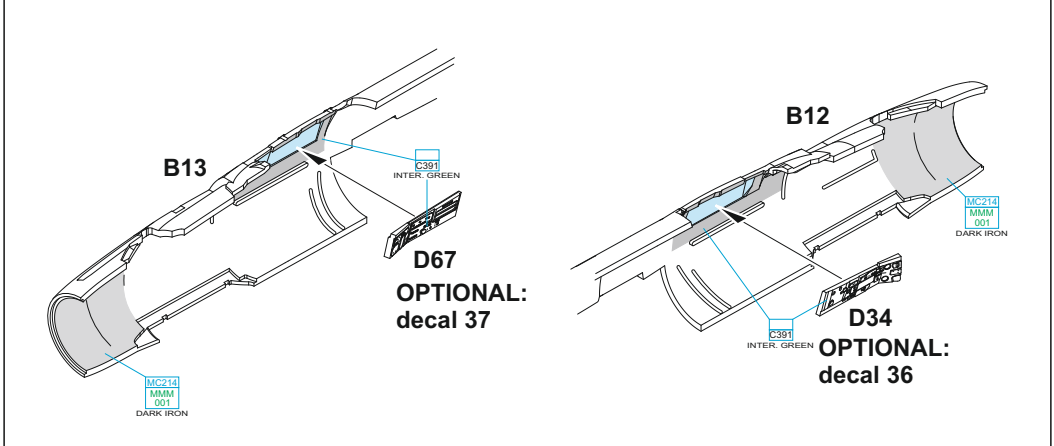
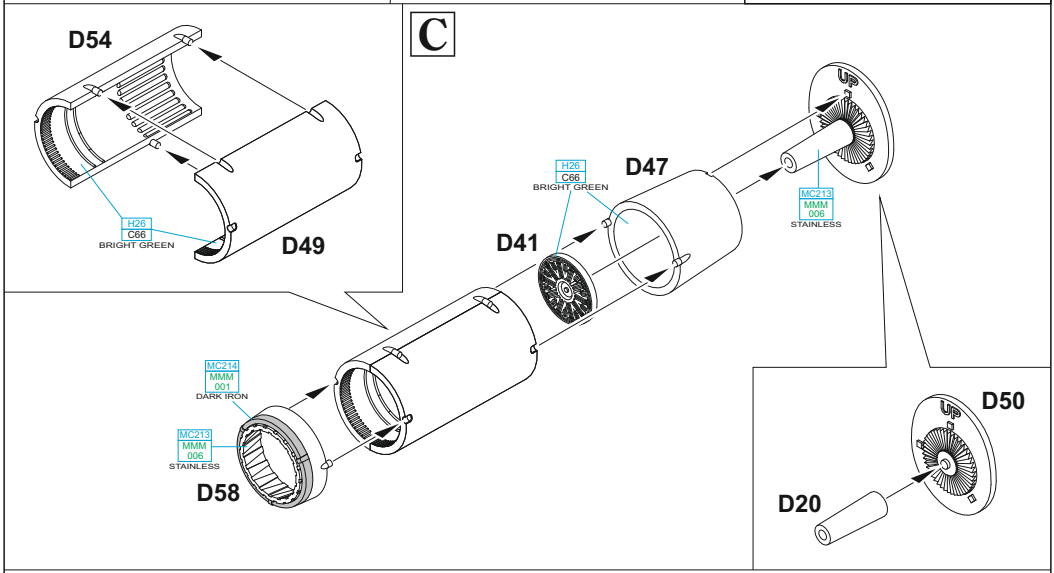
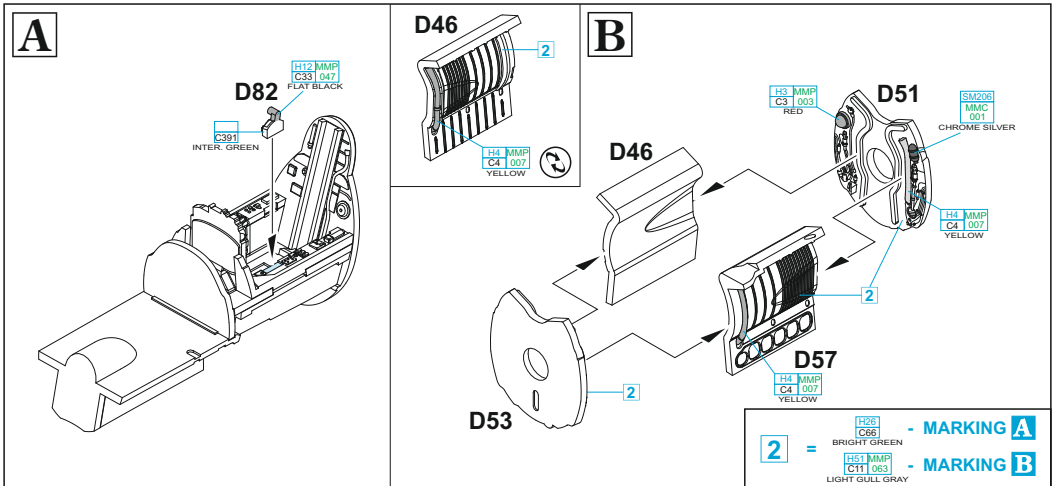

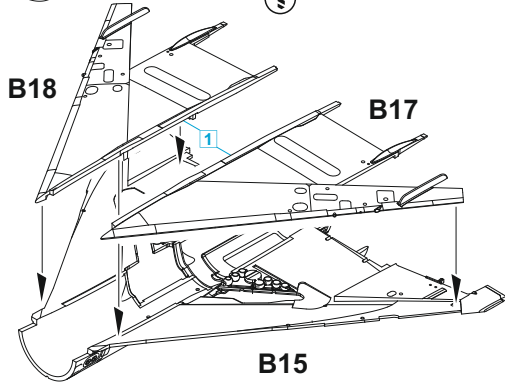
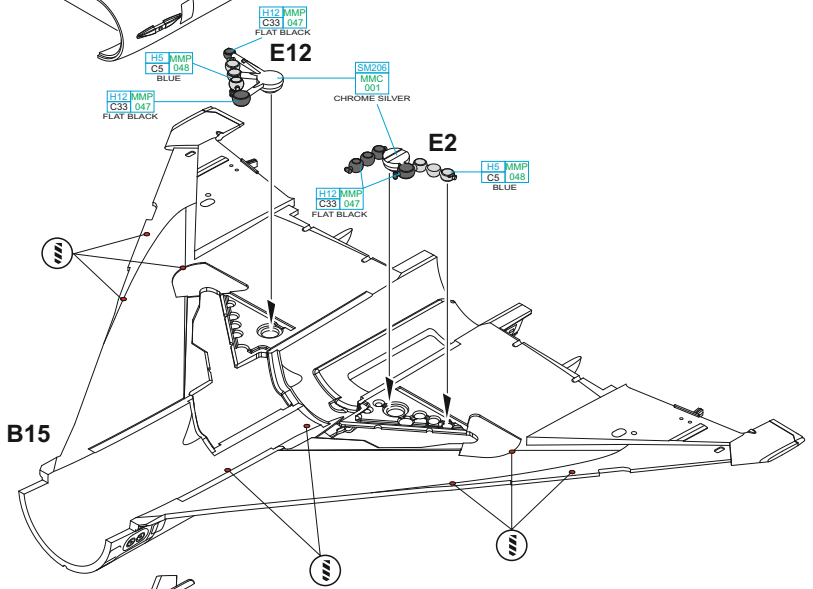
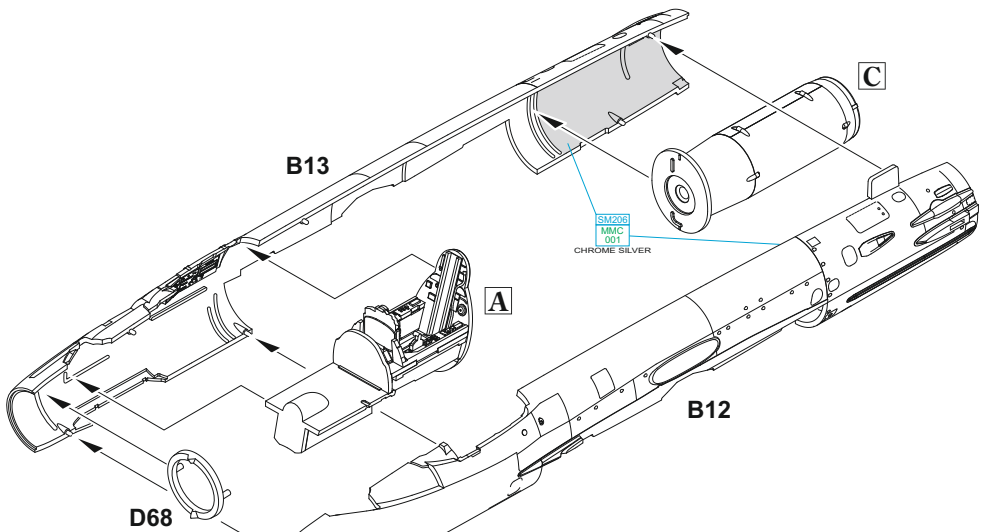

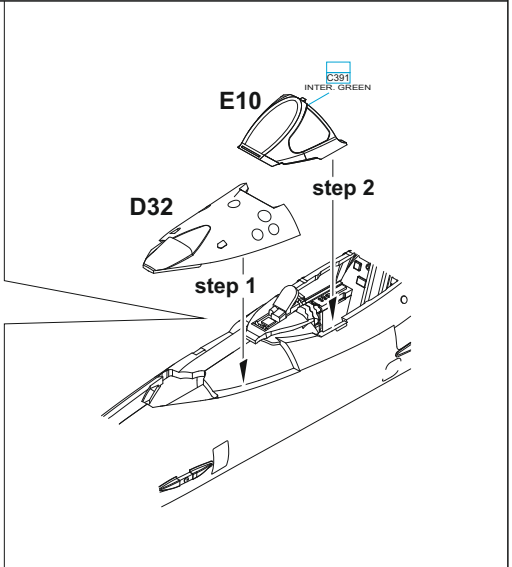
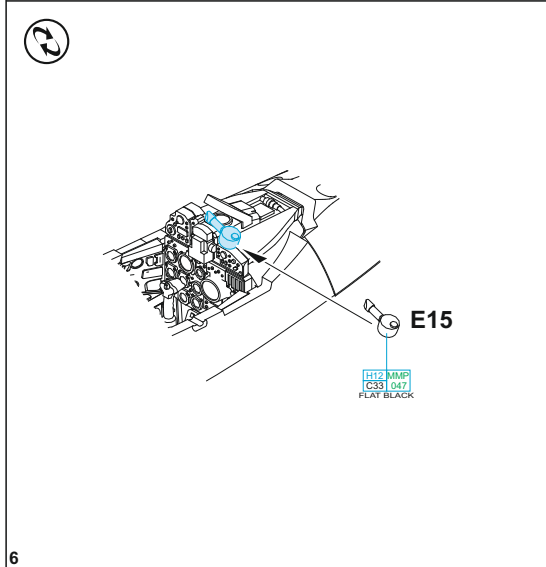
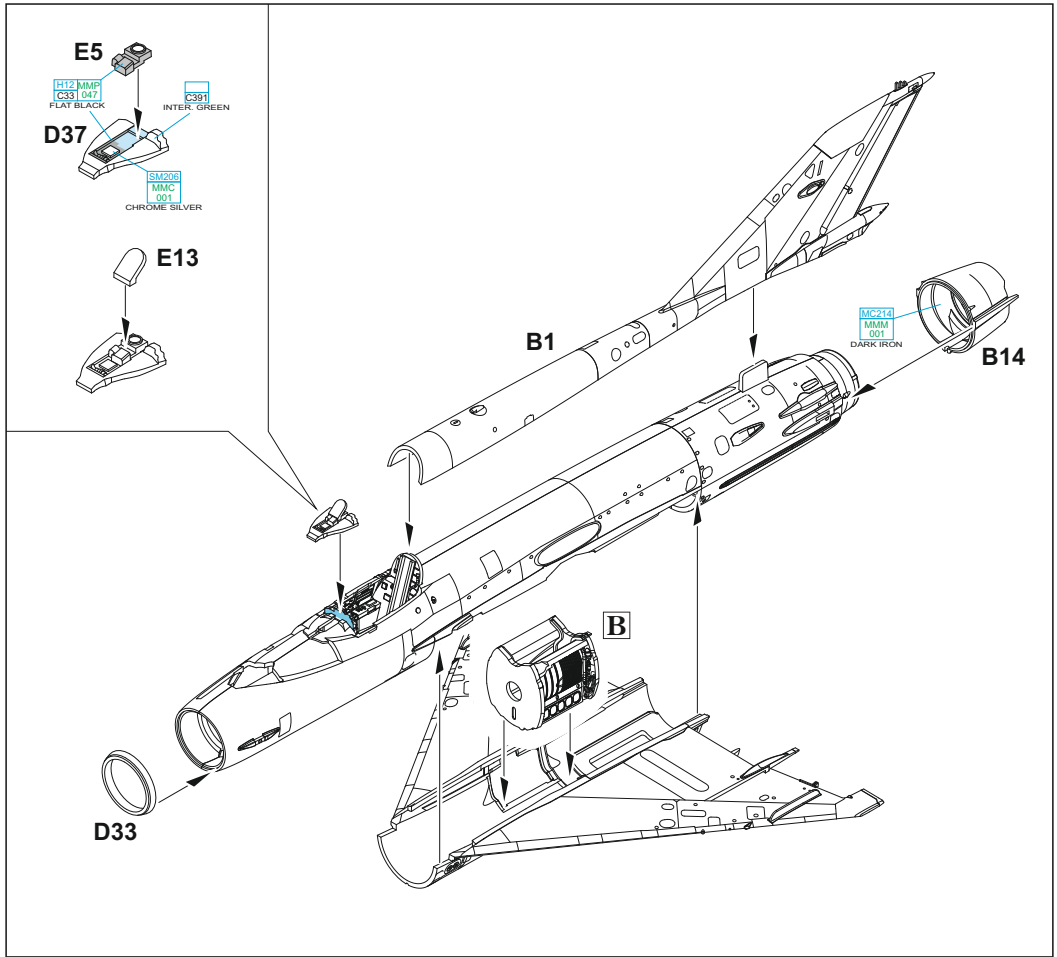

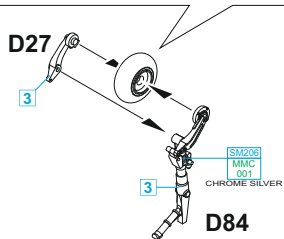
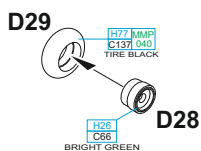
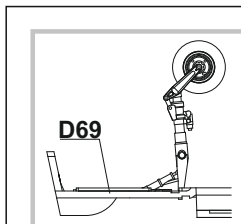
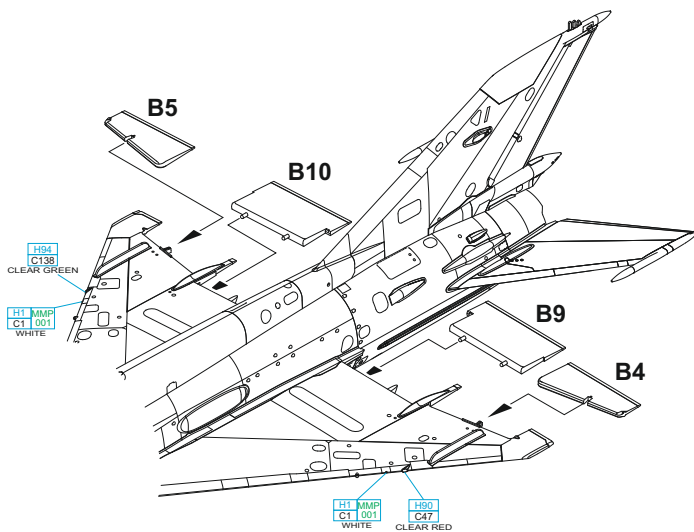
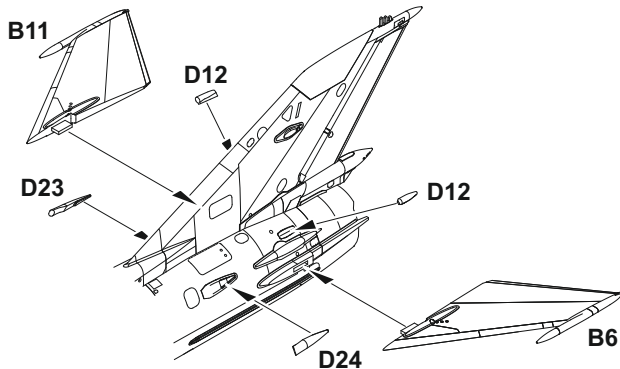

D

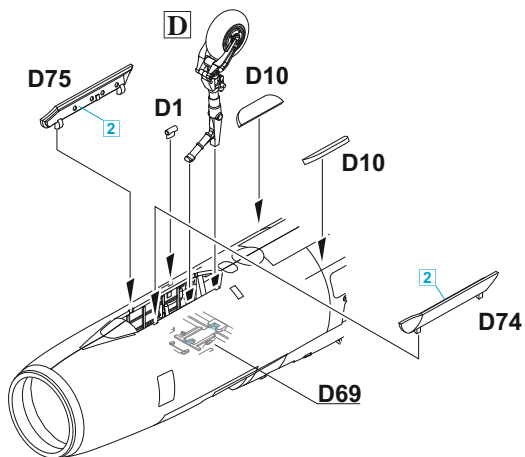

3 = H51 MMP C11 063 - MARKING B
LIGHT SILK GRAY
H338 MMP C338 116 - MARKING A
LIGHT GRAY

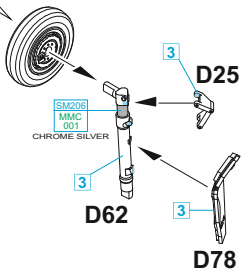
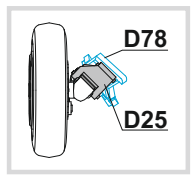
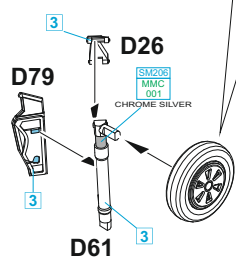
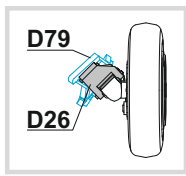
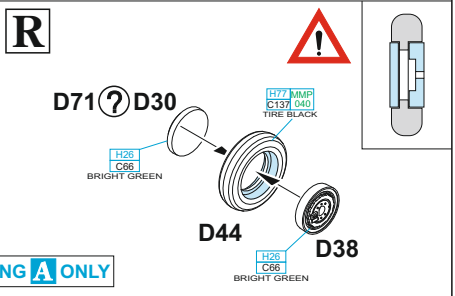
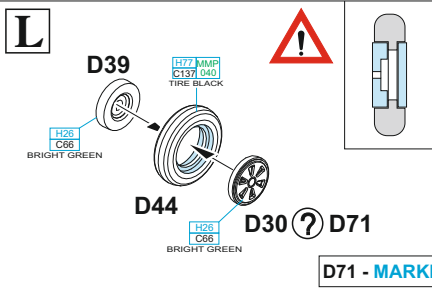
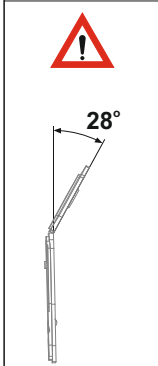
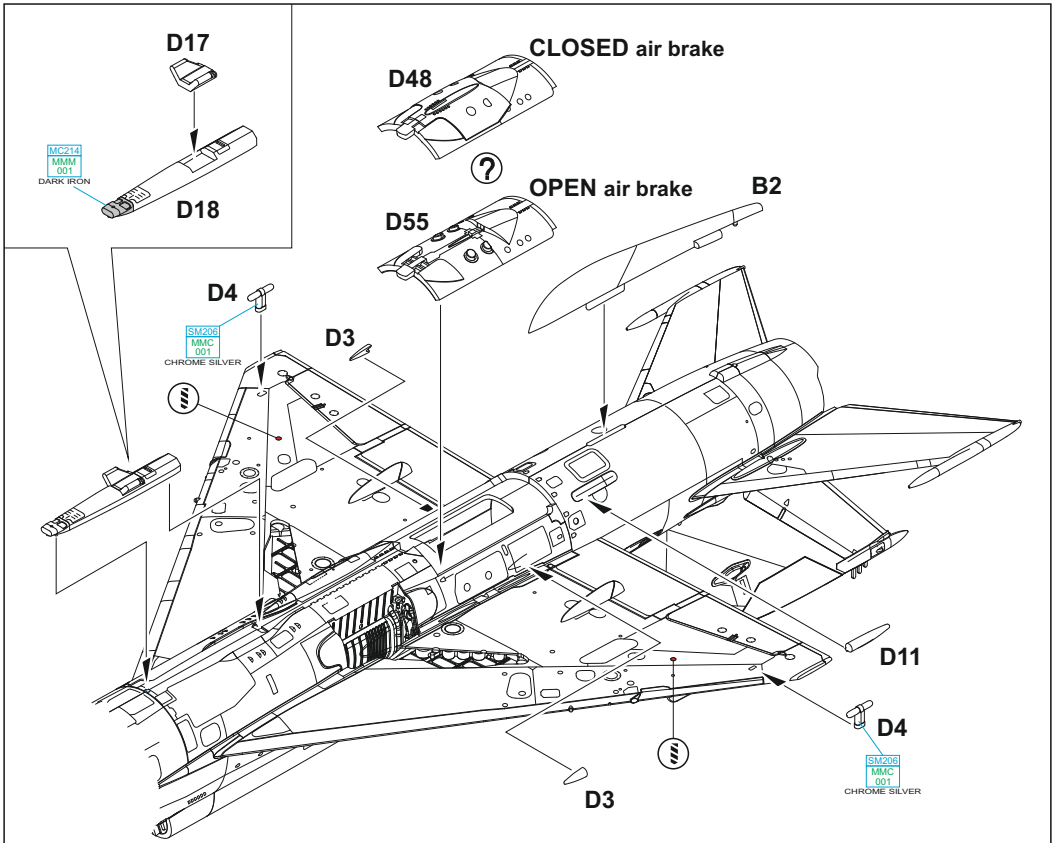

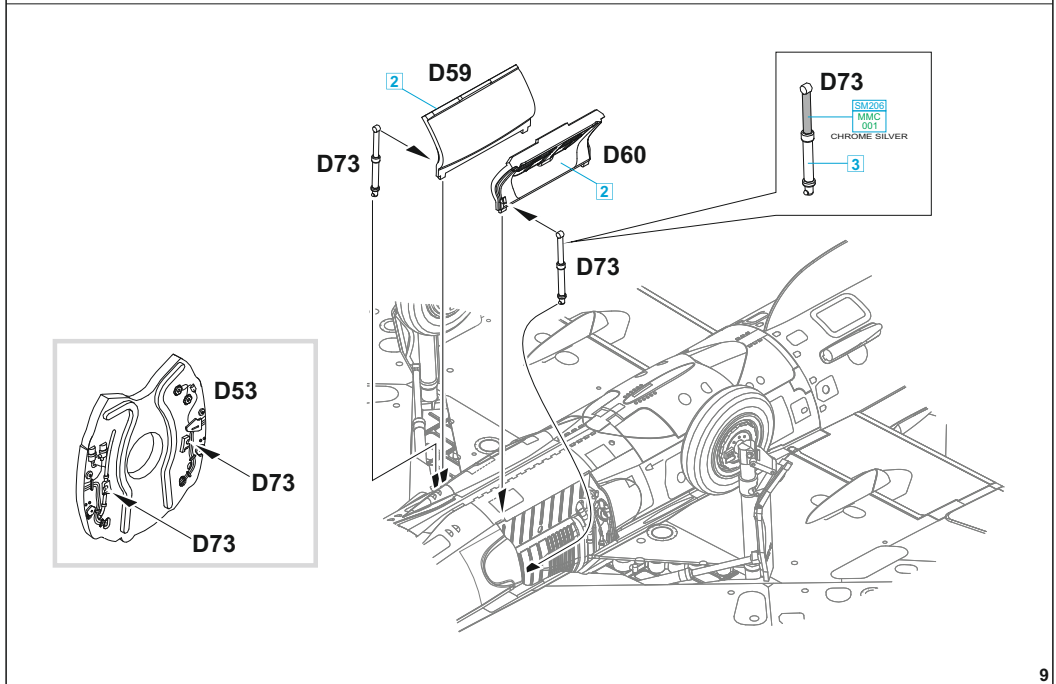
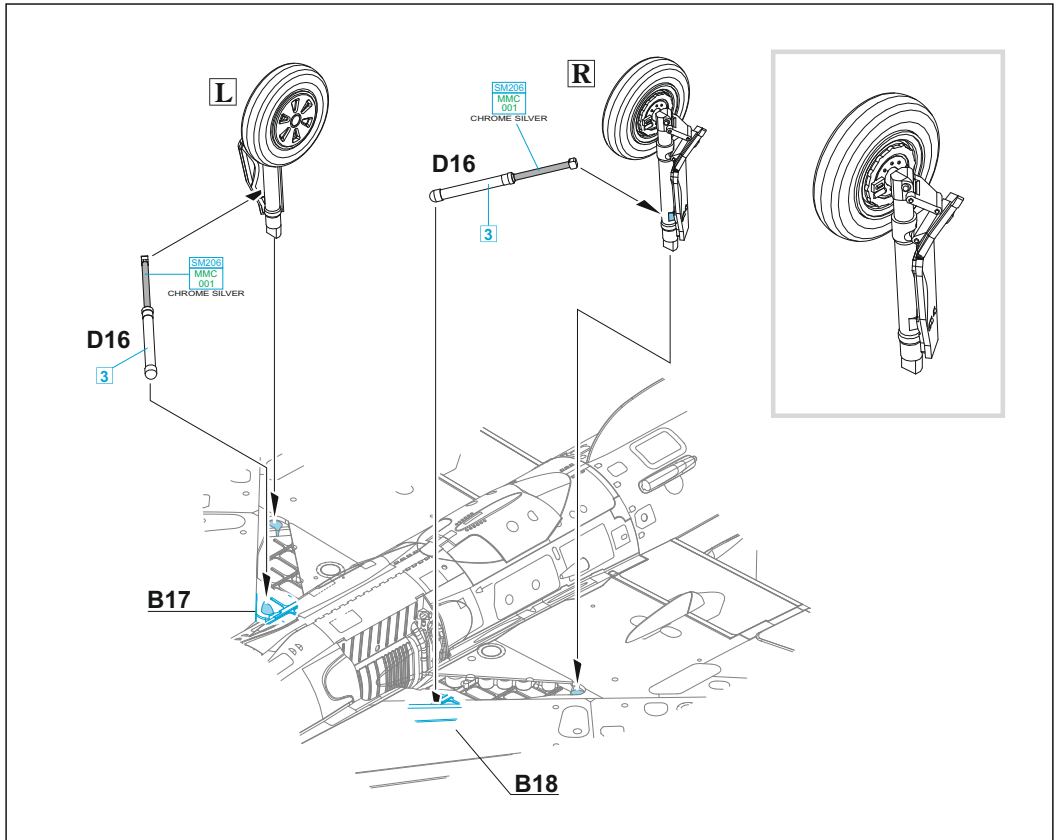

E 2 pcs.

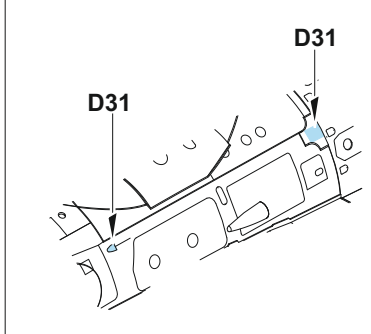
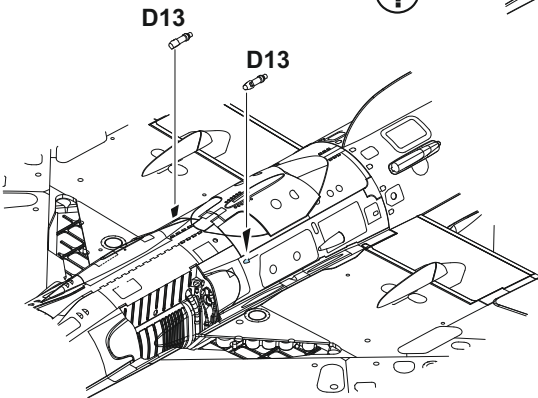
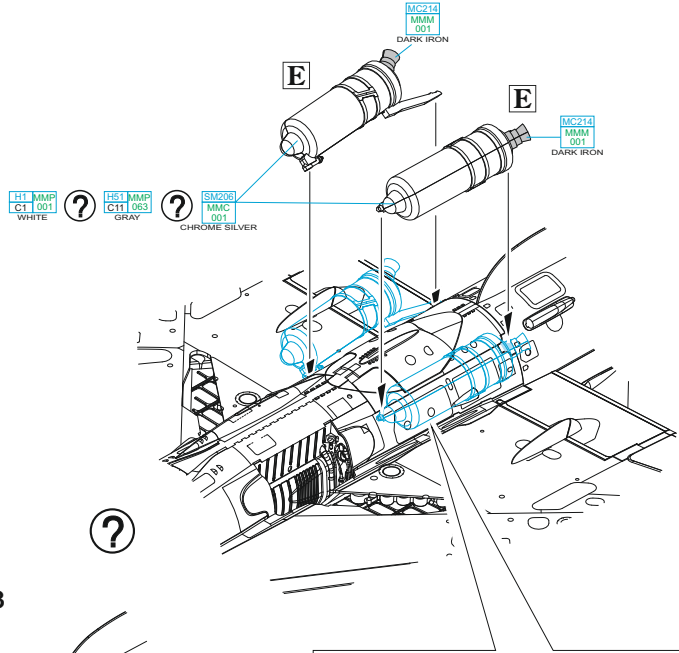
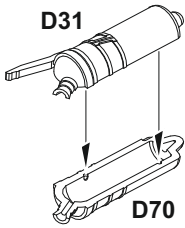

4 = **H26 C66** - MARKING **A**
BRIGHT GREEN
H418 MMP C11 055 - MARKING **B**
LIGHT BLUE

?

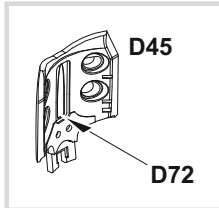

OPEN air brake

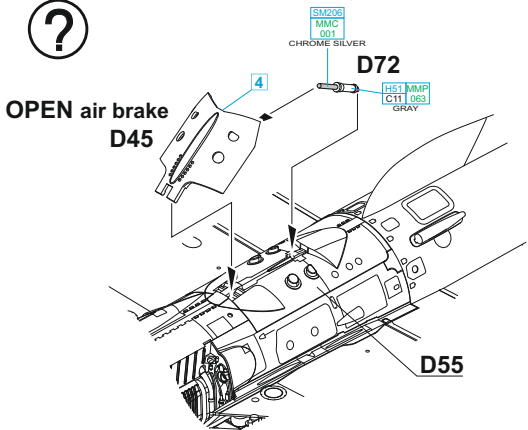

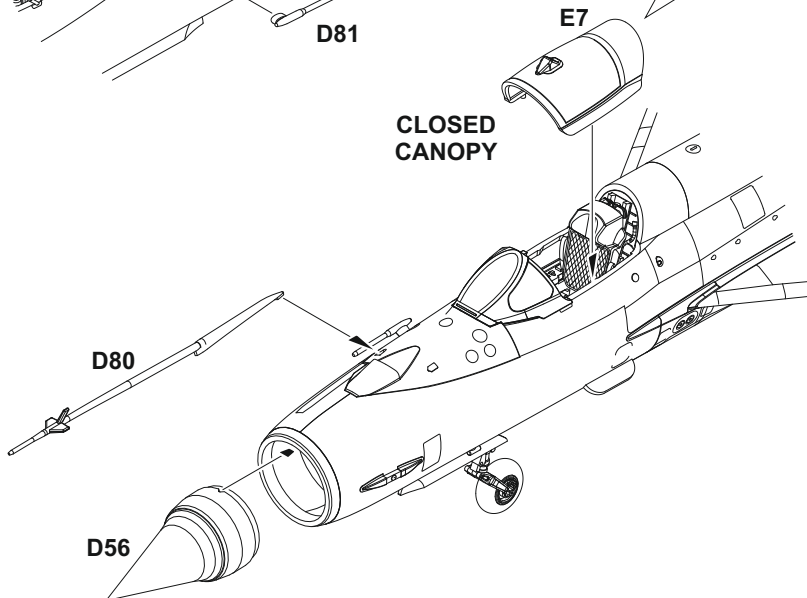
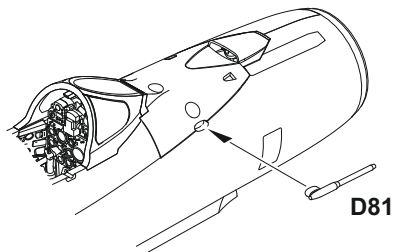
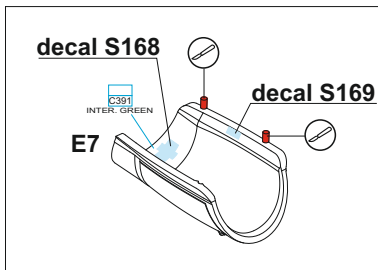
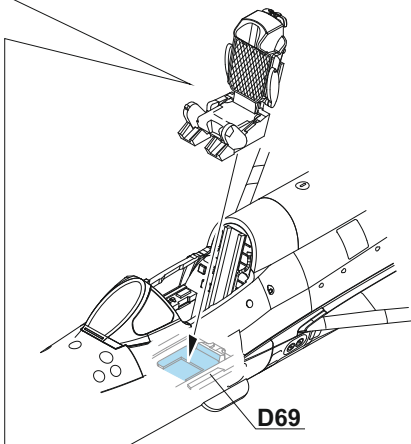
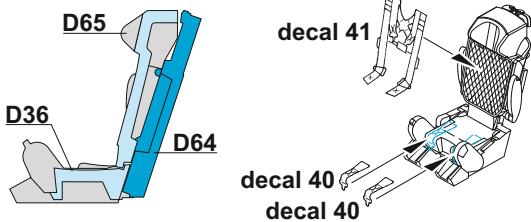
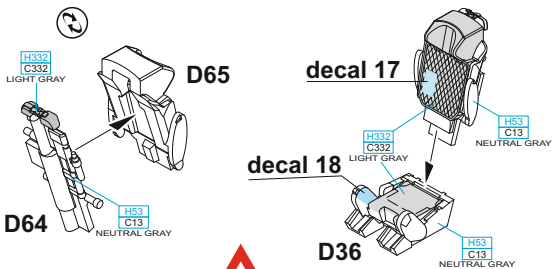

decal S168

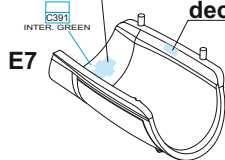

decal S169

**OPEN
CANOPY**

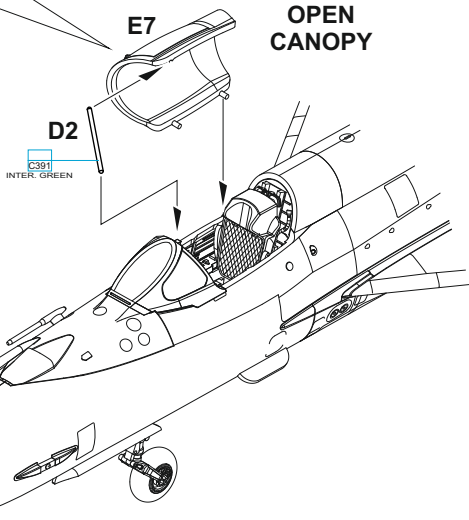

**EXTERNAL
FUEL TANK PYLONS
ZÁVĚSNÍK
PŘ. NÁDRŽE**

C30

UNDERSURFACE
COLOR



C21

UNDERSURFACE
COLOR



**EXTERNAL
FUEL TANK PYLONS
ZÁVĚSNÍK
PŘ. NÁDRŽE**

C40

UNDERSURFACE
COLOR

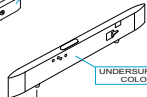

C10

UNDERSURFACE
COLOR



C41

UNDERSURFACE
COLOR

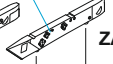

**EXTERNAL
FUEL TANK PYLONS
ZÁVĚSNÍK
PŘ. NÁDRŽE**

C11

UNDERSURFACE
COLOR

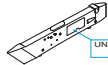

**WEAPON PYLONS
ZÁVĚSNÍK
VÝZBROJE**

C9

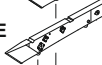

**WEAPON PYLONS
ZÁVĚSNÍK
VÝZBROJE**

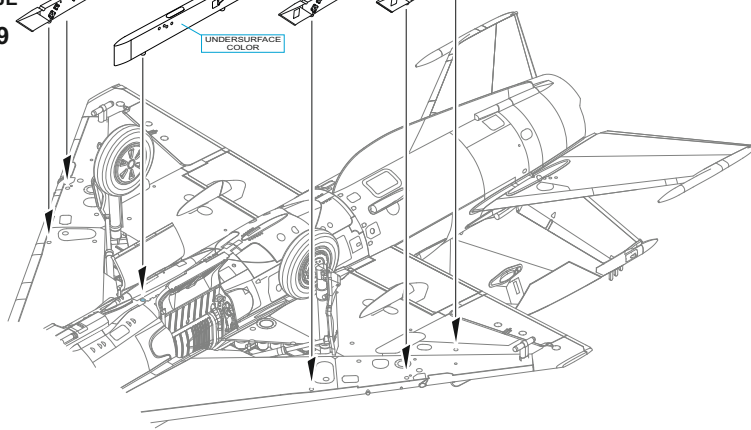

**EXTERNAL FUEL TANK 800 l
PŘÍDAVNÁ NÁDRŽ 800 l**

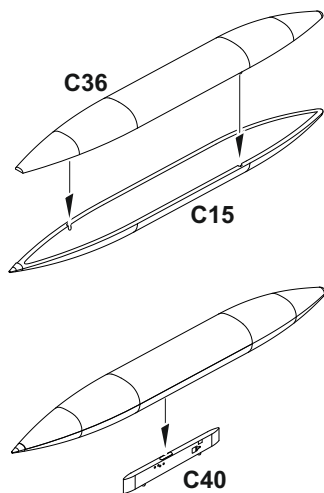

**EXTERNAL FUEL TANK 490 l
PŘÍDAVNÁ NÁDRŽ 490 l
2 pcs.**

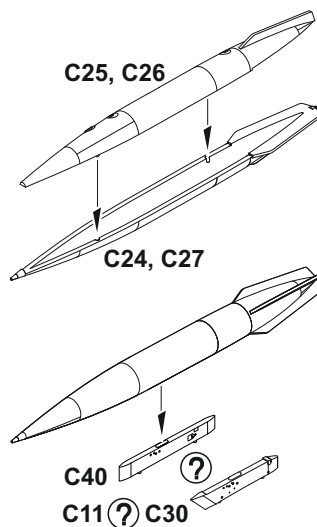

**R-13
2 pcs.**

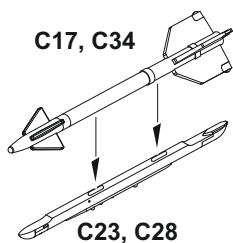

**R-3S
2 pcs.**

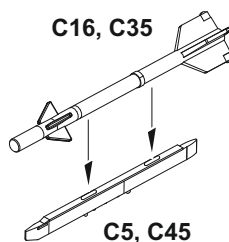

**UB-16
2 pcs.**

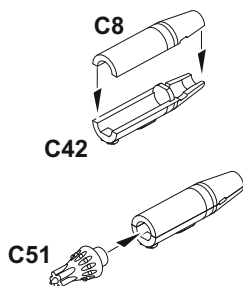

**FAB 250
2 pcs.**

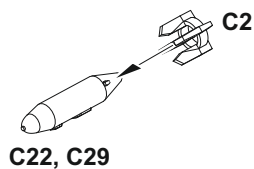

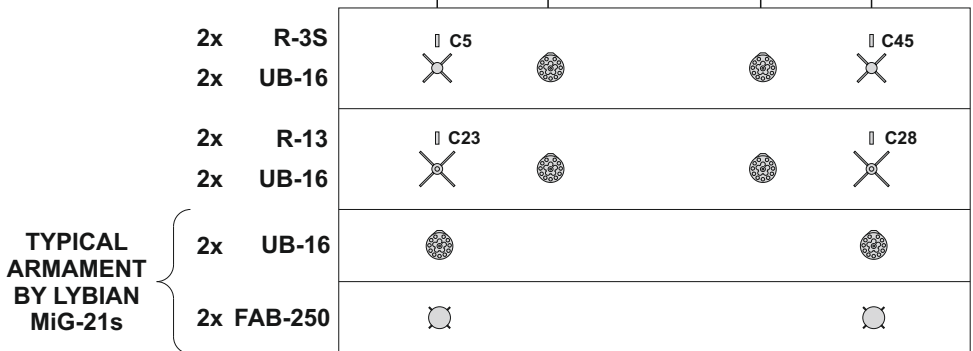
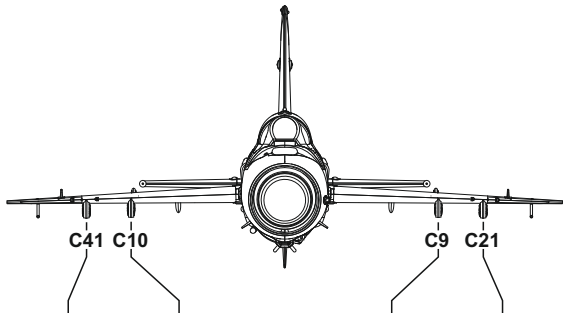
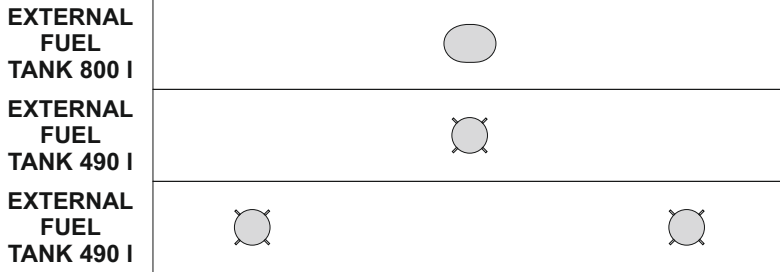
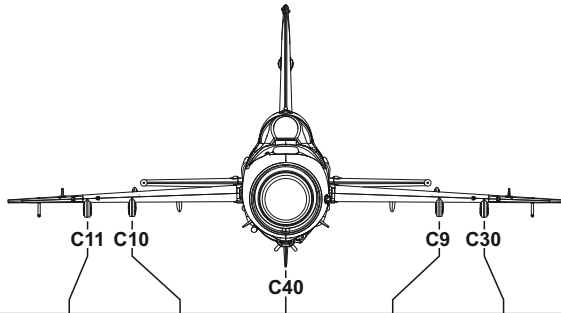

TO CHOOSE WEAPON AND EXTERNAL FUEL TANK OPTION PLEASE FOLLOW YOUR REFERENCE.
PRO VOLBU VÝZBROJE A PŘÍDAVNÝCH NÁDRŽÍ SE DRŽTE DOKUMENTACE KONKRÉTNÍHO STROJE.

A c/n 9668143, 3. Eskadra Lotnicza Taktycznego (3rd Squadron of the Tactical Aviation), Poznań-Krzesiny, 2002

3. ELT was formed on January 1st, 2001 in Poznan-Krzesiny and equipped with MiG-21MF, bis and UM versions. MiG-21MF were operated for 2 years only, their service with this unit ceased in 2002. Krzysztof Gladkij is the author of the swordfish artwork painted on the both sides of the fuselage and the tail surfaces on the occasion of the unit's 45th anniversary. He supplemented the artwork on the tail surfaces with the inscriptions "Fishbed" (NATO codename for MiG-21) and "45 lat" (45 years). In the coming years the artwork was subject to several modifications. Nowadays this aircraft can be seen in Aeroklub Poznański in Kobylnica.

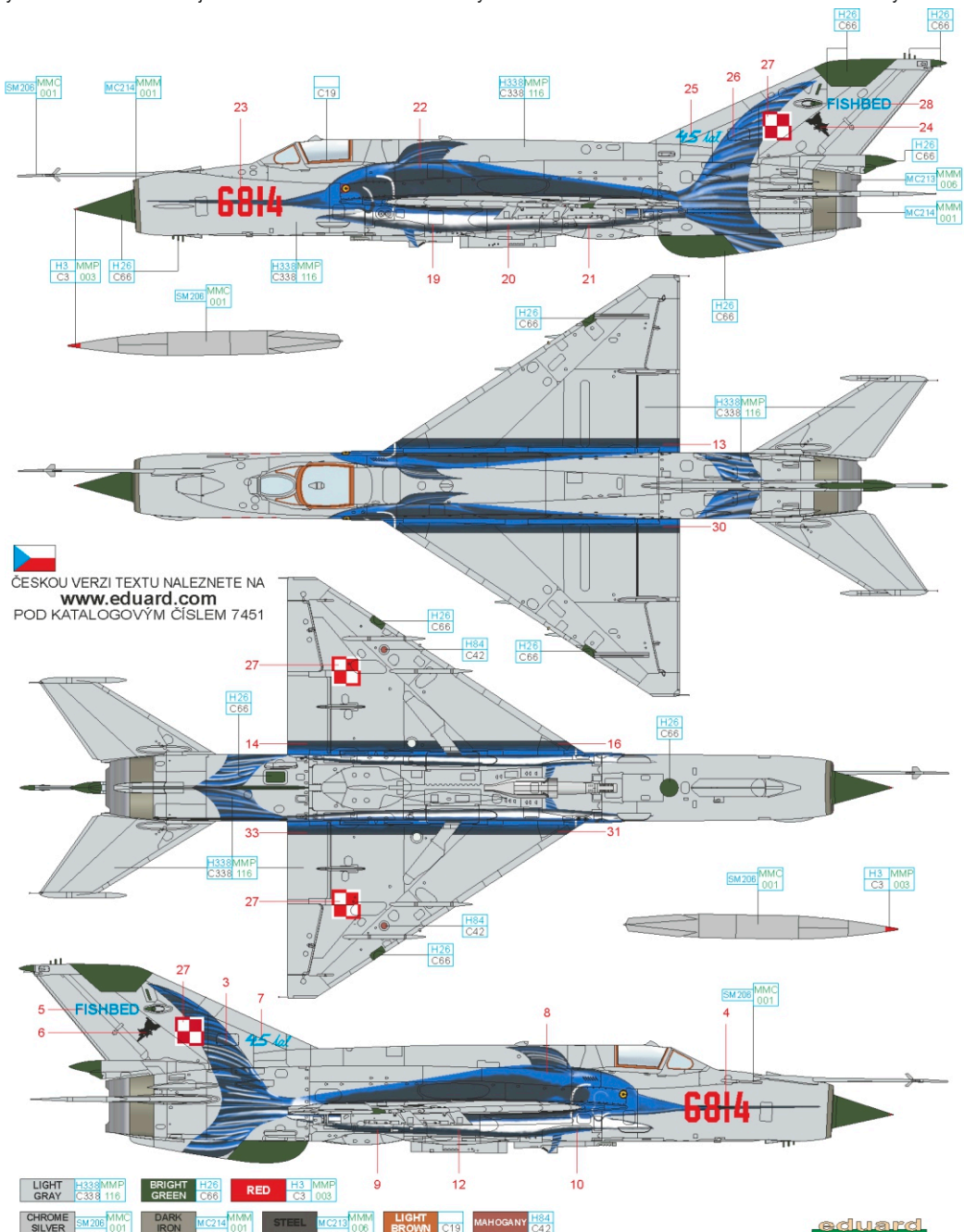

After its birth Libyan National Army commanded by general Khalifa Haftar captured several military airports abandoned by military loyal to Gaddafi where a couple of airworthy military aircraft were left behind. Under the command of general Haftar the army fleet was increased by the aircraft purchased abroad. In 2014 - 2016 period Egypt supplied Libyan National Army total of 11 MiG-21MF, bis and UM versions in 3 batches. On some of them the original Egyptian camouflage was overpainted, the aircraft number "38" retained its original colors supplemented by LNA markings on the lower surfaces and vertical stabilizer and the number 38 on the aircraft nose and on vertical stabilizer. The airplanes are mostly used in the ground attacks and carry the ordnance consisting of the bombs or rocket launchers.

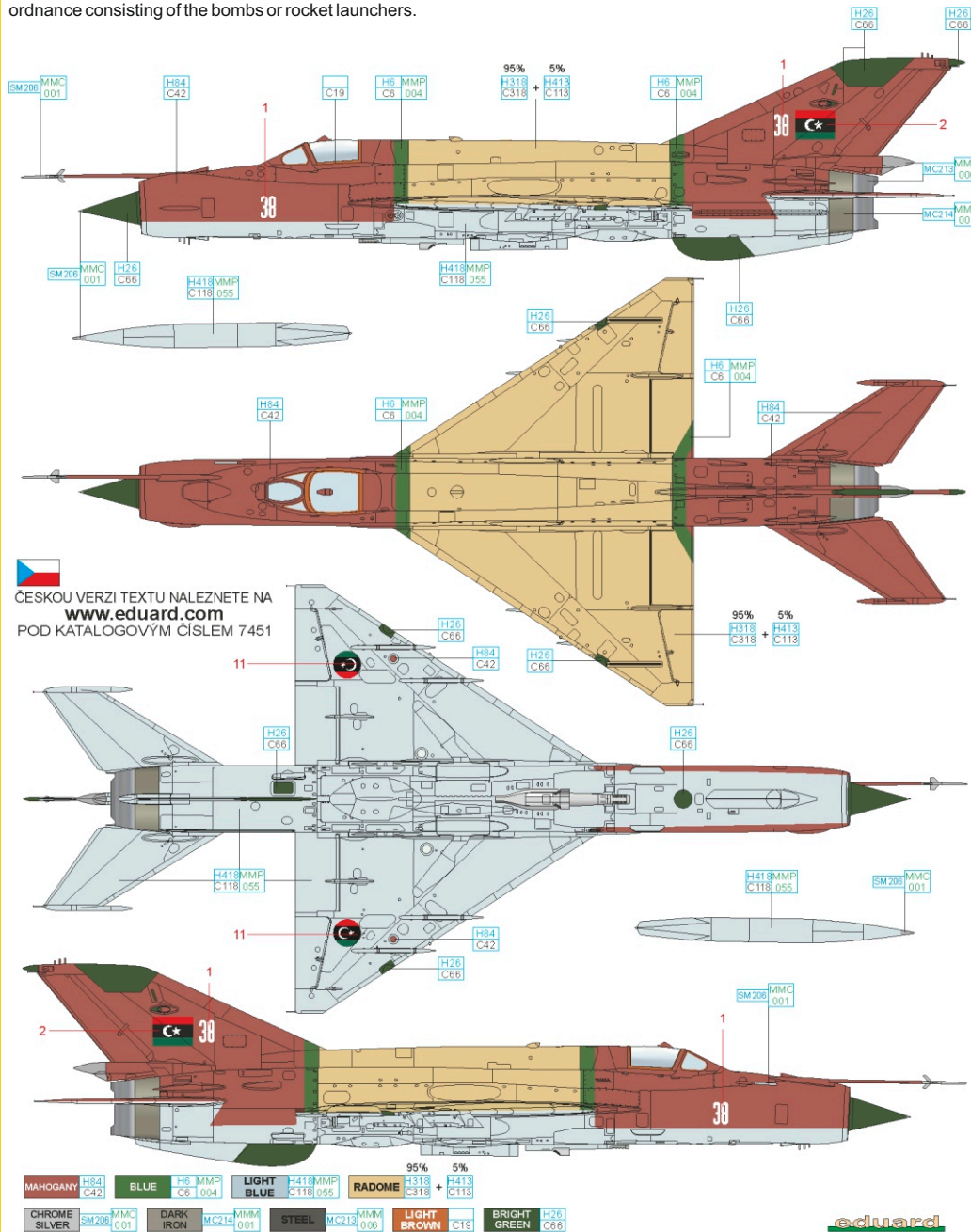

FOR MARKING **A** ONLY

LEVÝ VNĚJŠÍ PALIVOVÝ PYLON
LEFT OUTSIDE UNDERWING TANK PYLON

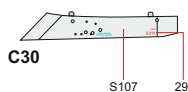

PODTRUPOVÝ PYLON
FUSELAGE PYLON

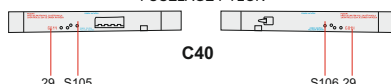

PRAVÝ VNĚJŠÍ PALIVOVÝ PYLON
RIGHT OUTSIDE UNDERWING TANK PYLON

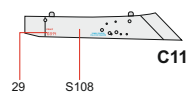

LEVÝ VNĚJŠÍ PYLON
LEFT OUTSIDE PYLON

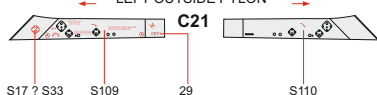

PRAVÝ VNĚJŠÍ PYLON
RIGHT OUTSIDE PYLON

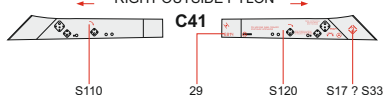

LEVÝ VNITŘNÍ PYLON
LEFT INSIDE PYLON

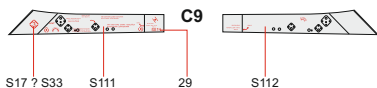

PRAVÝ VNITŘNÍ PYLON
RIGHT INSIDE PYLON

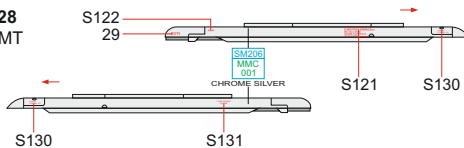
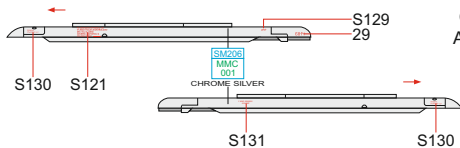
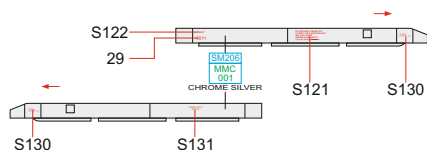
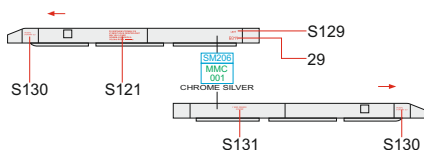
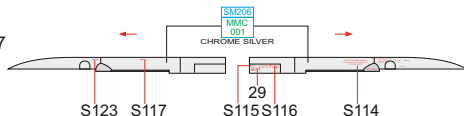
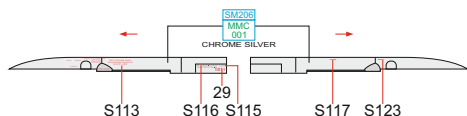
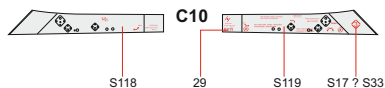

FOR MARKING **A** ONLY

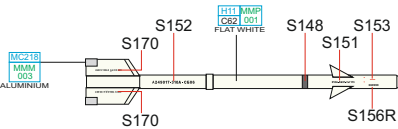
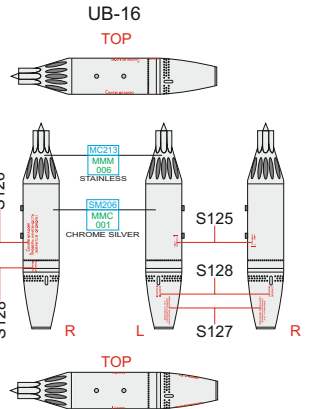
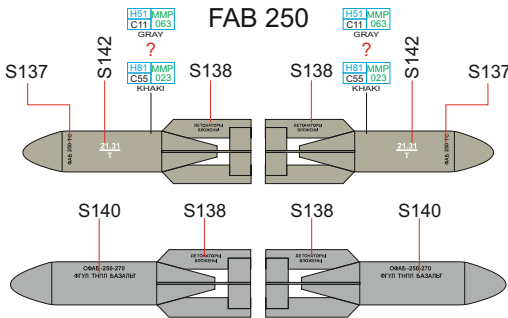
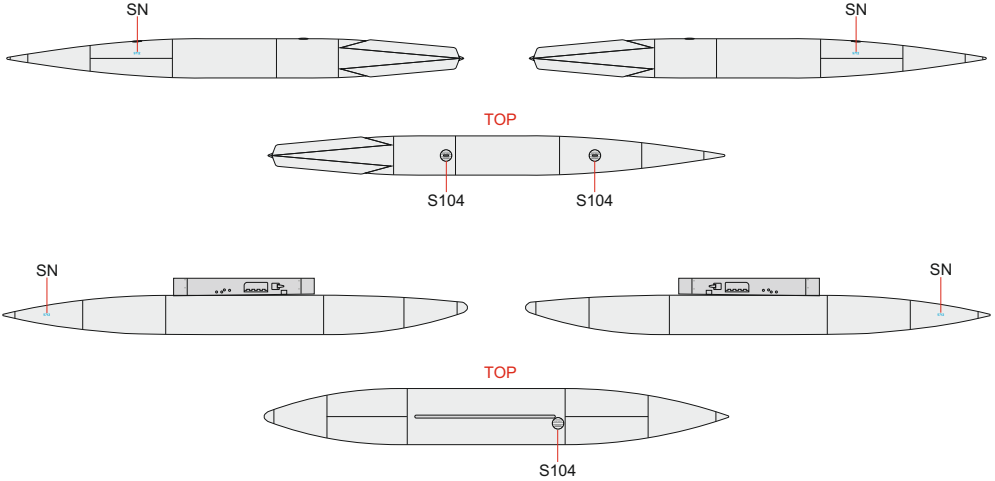

R-3S

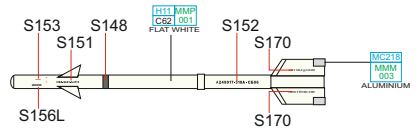

R-13

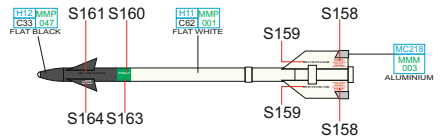
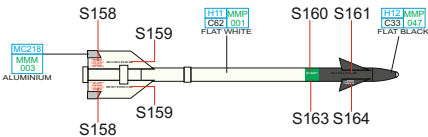

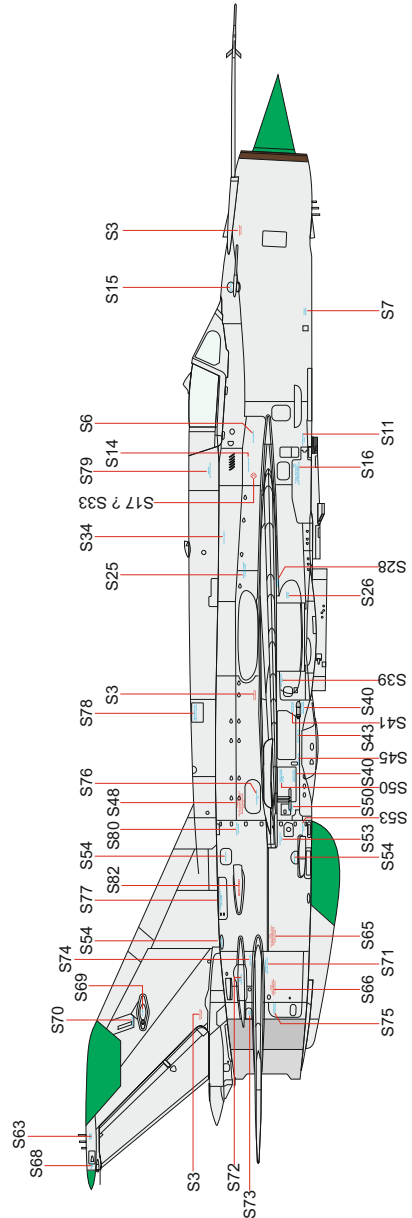
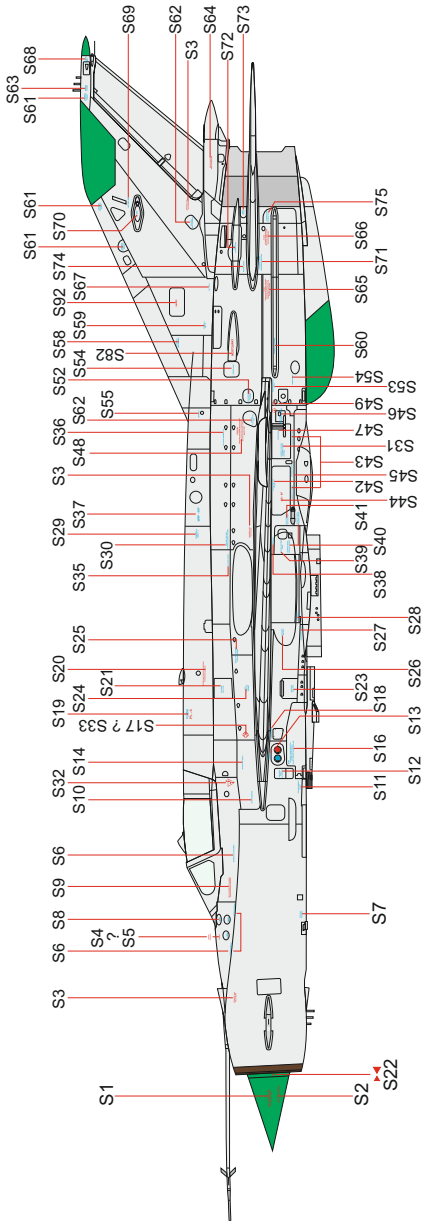

FOR MARKING **A** ONLY