

MG model art. 18.07 scala 1:18

Ferrari 550 Veloqx Prodrive

Le Mans 2003 WINNER Class GTS

General Notes

Detailed Multi-Media scale car model for adult collectors.

Modelling experience required.

Always read the instructions before assembling.

Use toolings, adhesives, paints etc. properly after careful reading of instructions given in each handling manual.

Dry fit all parts and sub-assemblies: measure twice and glue once!

Always wear eye protection when cutting or handling parts.

Use extreme caution when using sharp blades.

Work in well ventilated and lightened room.

Wash resin parts with antistatic degreaser and an old toothbrush.

Resin parts can be cleaned, sanded, drilled and engraved.

Use putty if necessary.

To make or enlarge holes, use a low speed drill or a hand drill.

Certain parts are delicate! Please be extremely careful with the Photo-Etched sheets and White Metal parts.

Do not inhale resin dust!

Resin parts are temperature sensitive. In case of distortion (warpage), original shape can be restored by dipping in hot water (not boiling) for a few seconds.

Gently bend back to the proper shape, then place the part into cold water to stabilize the shape.

Use super glue (cyanoacrylate) and fast drying epoxy cement for all parts, except clear parts.

Use white glue, vinyl glue or gum for all clear parts.

Decals softener solution recommended.

Resin body painting sequence

Wash body with antistatic degreaser and an old toothbrush.

Filler coat.

White coat.

Ferrari red coat/s.

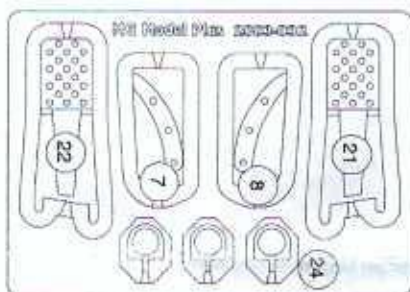

Parts not for use

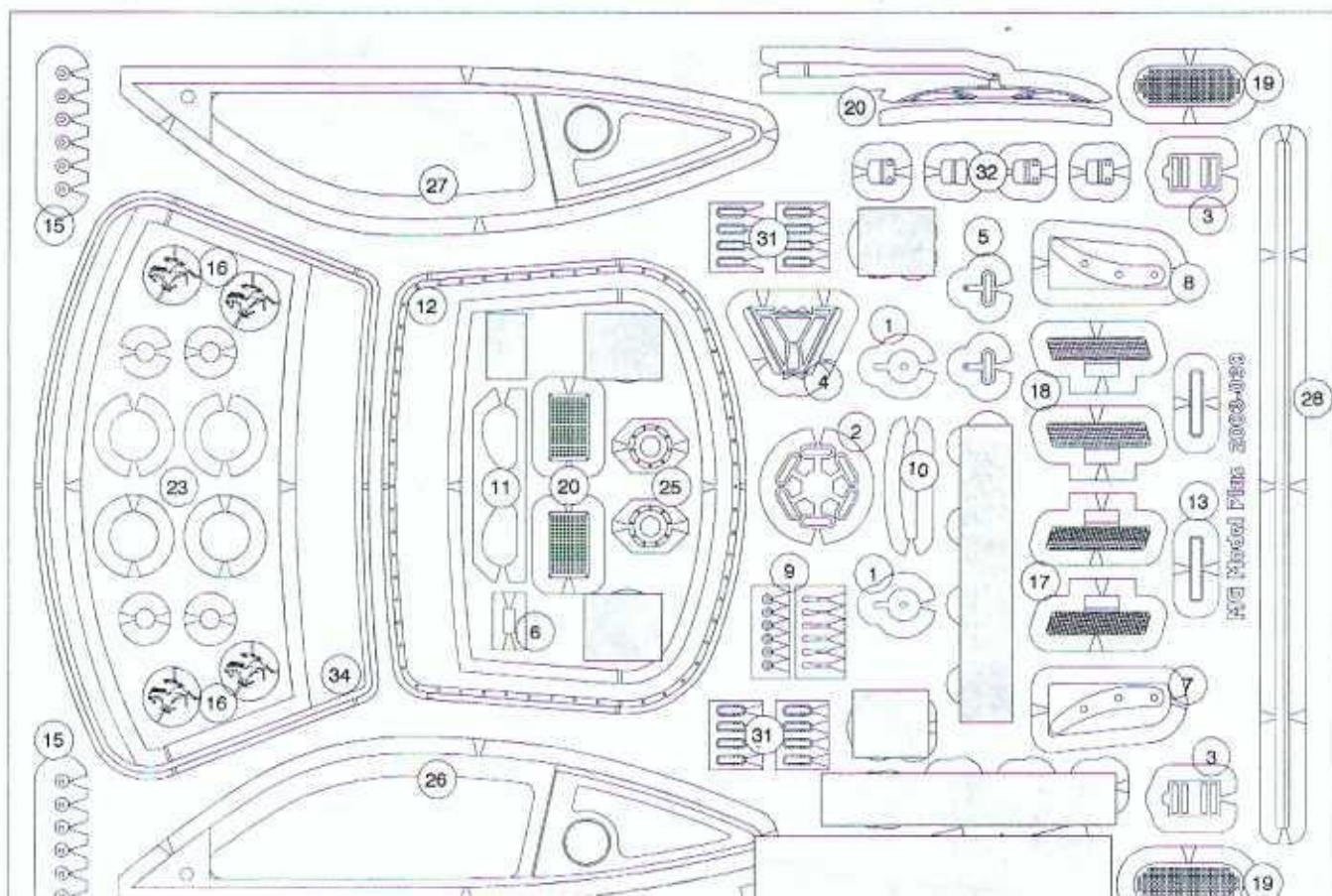

MG model

art. 18.07

