



U.S. BOMBER ESCORT

Span 37' Length 32'3" Speed 487 MPH
 This was probably the best all-round single seat fighter plane developed during World War II. Armament varied, but usually consisted of four 20 MM cannon or six 50 cal. machine guns, with rockets mounted on the underside of the wing.



CUT OUT YOUR TRADING CARD U.S. BOMBER ESCORT

EASY TO ASSEMBLE STEP BY STEP INSTRUCTIONS

USE ENAMEL OR PLASTIC PAINTS ONLY.
 DO NOT USE LACQUER PAINT
 MATERIALS AS THESE CRAZE THE PLASTIC.

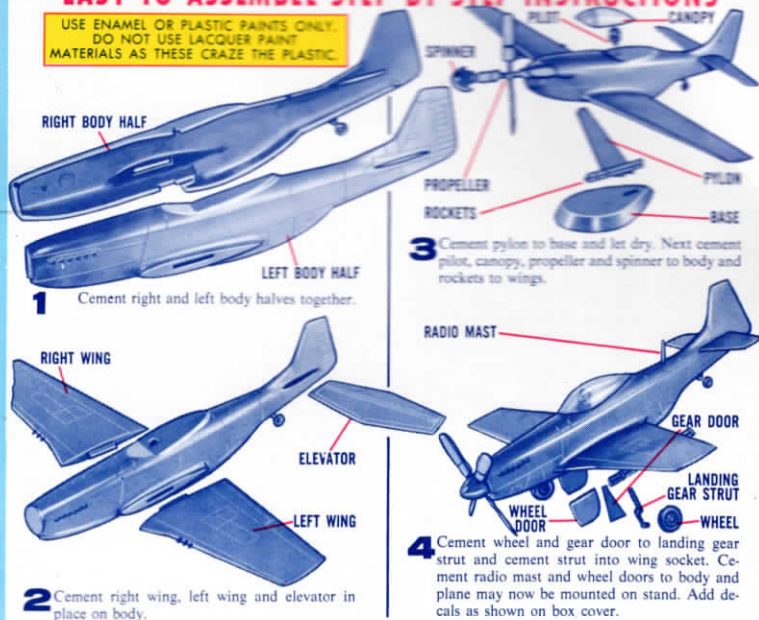

CUT ON DOTTED LINE AND FOLD BACK TO USE PACKAGE AS TRAY FOR PARTS WHILE ASSEMBLING



V F L V F L



317926 317926



INSTRUCTIONS

1. Cut each group of decals carefully from sheet as needed. 2. Place each portion in lukewarm water, one at a time, for about 10 seconds, to loosen decals. 3. Slide transfers off backing sheet into position on model. Refer to plan for correct location. 4. With moistened finger, smooth out carefully to remove excess water.

KIT NO.417 NORTH AMERICAN P-51 D MUSTANG